

STATE OF ILLINOIS
DEPARTMENT OF TRANSPORTATION
DIVISION OF HIGHWAYS

**PLANS FOR PROPOSED
FEDERAL AID HIGHWAY**

**FAU 1665 (WALTER ZIMNY DRIVE)
FAU 1602 (147TH ST) TO FAP 370 (WESTERN AVENUE)
ROADWAY RESURFACING
PROJECT NO.: M-9003(994)
L.A. SECTION NO.: 12-00004-00-RS
VILLAGE of POSEN
COOK COUNTY
C-91-346-12**

F. A. S. P. NO.	SECTION	COUNTY	TOTAL SHEETS	SHEET NO.
1665	12-00004-00-RS	COOK	12	1
STA. 0+39		TO STA. 29+16		
FED. ROAD DIST. NO. 1		ILLINOIS	FED. AID PROJECT M-9003(994)	

CONTRACT #63735

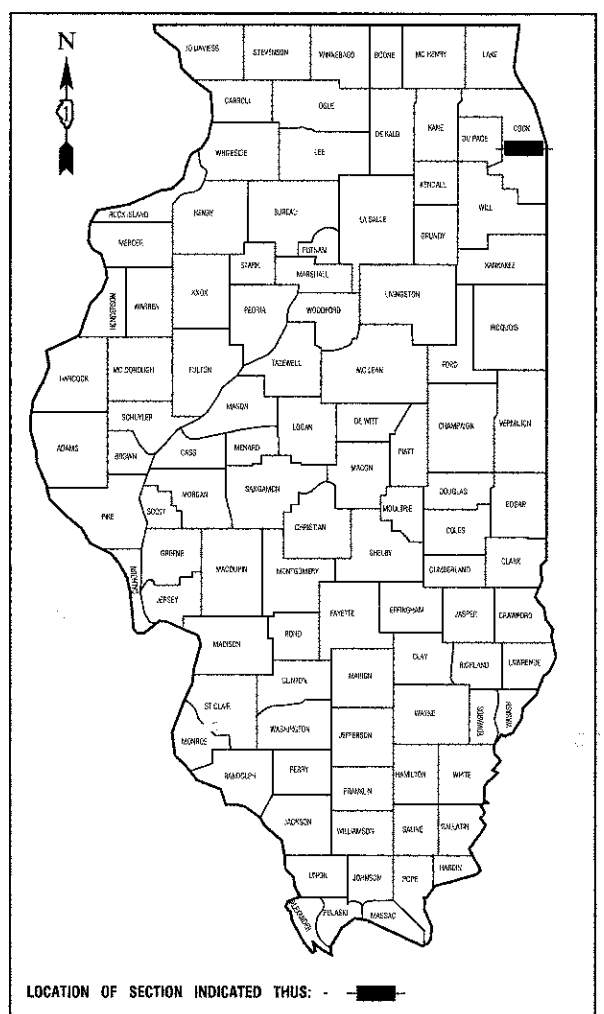

INDEX OF SHEETS

1. COVER SHEET, INDEX OF SHEETS & HIGHWAY STANDARDS
2. SUMMARY OF QUANTITIES & GENERAL NOTES
3. TYPICAL SECTIONS
- 4.-5. PAVEMENT PLAN
- 6.-7. PAVEMENT MARKING PLAN
- 8.-12. IDOT DISTRICT 1 STANDARD DETAILS

HIGHWAY STANDARDS

- 000001-06 STANDARD SYMBOLS, ABBREVIATIONS AND PATTERNS
- 424001-06 PERPENDICULAR CURB RAMPS
- 424011 CORNER PARALLEL CURB RAMPS FOR SIDEWALKS
- 424016 MID-BLOCK CURB AND RAMPS FOR SIDEWALKS
- 442201-03 CLASS C AND D PATCHES
- 602001-02 CATCH BASIN TYPE A
- 602301-03 INLET - TYPE A
- 606001-04 CONCRETE CURB TYPE B AND COMBINATION CONCRETE CURB AND GUTTER
- 701501-06 URBAN LANE CLOSURE, 2L, 2W, UNDIVIDED
- 701801-05 SIDEWALK, CORNER OR CROSSWALK CLOSURE
- 701901-02 TRAFFIC CONTROL DEVICES

	WALTER ZIMNY DRIVE
2012 ADT -	2500
2040 ADT -	2500
POSTED SPEED LIMIT -	20 mph
DESIGN PERIOD -	20 YEARS
DESIGN SPEED LIMIT -	25 mph
STREET CLASSIFICATION -	LOCAL COLLECTOR

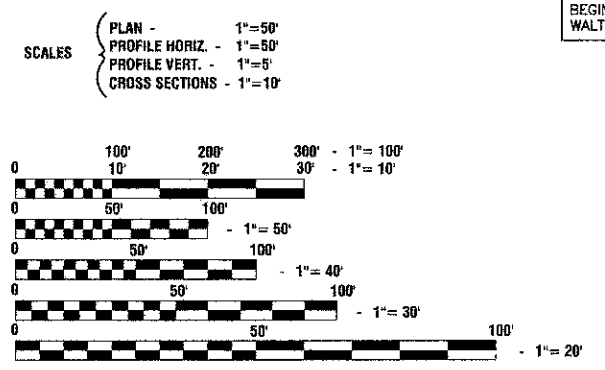

BEGINNING OF IMPROVEMENTS
WALTER ZIMNY DR STA 0+39

END OF IMPROVEMENTS
WALTER ZIMNY DR STA 29+16

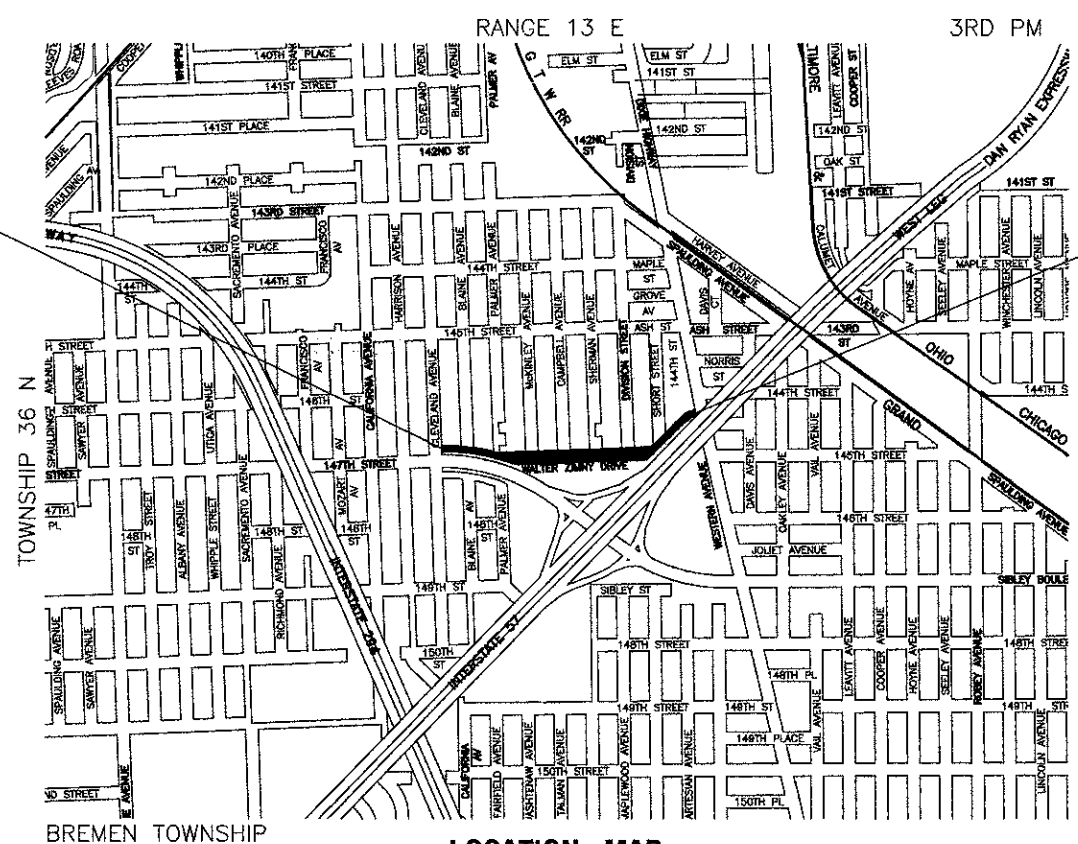

LOCATION MAP

GROSS LENGTH=2877 FEET=0.55 MILES
NET LENGTH=2877 FEET=0.55 MILES

STATE OF ILLINOIS DEPARTMENT OF TRANSPORTATION
DIVISION OF HIGHWAYS

Approved: 08/20/2012
Arnold J. Schupok
President, Village of Posen

Passed: August 23, 2012
C. Holt
District 1 Engineer of Local Roads & Streets

Released for Bid
Based on Limited
Review
August 23, 2012
John Furtmann
Deputy Director of Highways, Region 1 Engineer

PRINTED BY THE AUTHORITY OF
THE STATE OF ILLINOIS

PREPARED BY OR UNDER THE
DIRECT SUPERVISION OF:

Mary L. Lehman
08/20/2012

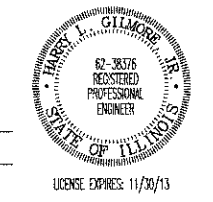

PROGRAM AND OFFICE ENGINEER: CHARLES F. RIDDLE, P.E. 847-705-4406, SCHAMBURG, IL
CONSULTANTS: ROBINSON ENGINEERING, LTD. 708-331-6700

CONTRACT NO. 63735