

QUANTITY
4 (100) LINE = 64.1 ft. (19.7 m)
21.1 sq. ft. (1.97 sq. m)

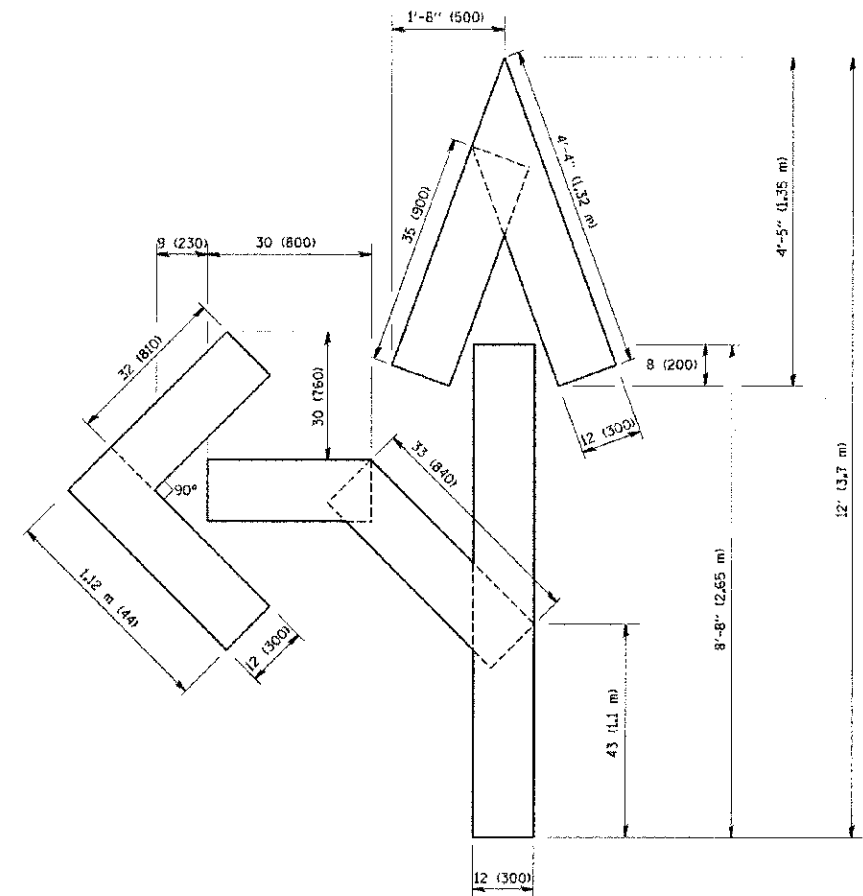

QUANTITY
4 (100) LINE = 82.5 ft. (25.3 m)
27.5 sq. ft. (2.53 sq. m)

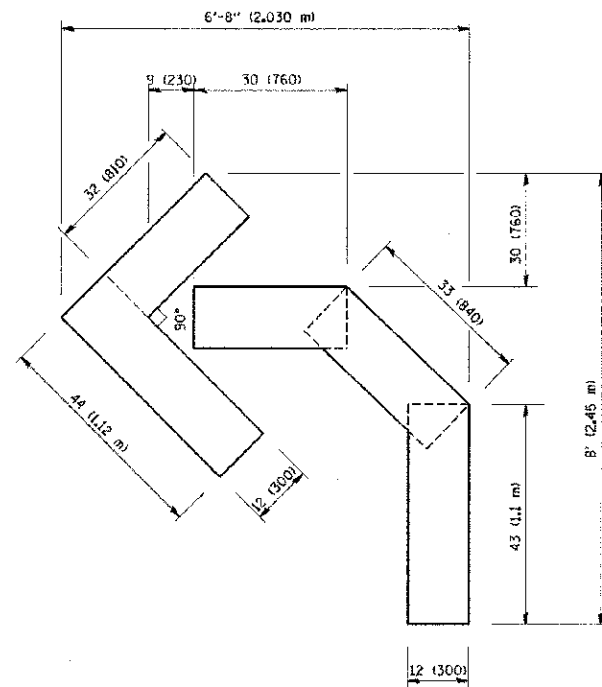

QUANTITY
4 (100) LINE = 45.5 ft. (13.9 m)
15.2 sq. ft. (1.39 sq. m)

All dimensions are in inches (millimeters) unless otherwise shown.

DESIGNED BY: JAMES A. WATSON, INC.
DRAWN BY: JAMES A. WATSON, INC.
CHECKED BY: JAMES A. WATSON, INC.
DATE: 09-18-94

FILE NAME - W:\vst\tr\27\34\1016.dgn	USER NAME - jgallant	DESIGNED - T. RAMMACHER 06-05-96	REVISED - T. RAMMACHER 06-05-96
		DRAWN - T. RAMMACHER 11-04-97	REVISED - T. RAMMACHER 11-04-97
		CHECKED - T. RAMMACHER 03-02-98	REVISED - T. RAMMACHER 03-02-98
		DATE - 09-18-94	REVISED - E. GOMEZ 08-28-00

STATE OF ILLINOIS
DEPARTMENT OF TRANSPORTATION

PAVEMENT MARKING LETTERS AND SYMBOLS
FOR TRAFFIC STAGING

SCALE: NONE SHEET NO. 1 OF 1 SHEETS STA. TO STA.

F.A.P. RTE. 537	SECTION 12-00040-00-R5	COUNTY KANE	TOTAL SHEETS 21	SHEET NO. 19
TC-16			CONTRACT NO. 63741	
FED. ROAD DIST. NO. 1 ILLINOIS FED. AID PROJECT M-9003(975)				

6-91-296-12