





LEGEND:

-  = WORK ZONE
-  = TEMPORARY PAVEMENT
-  = SIGN
-  = TYPE III BARRICADE
-  = DRUM WITH STEADY BURNING LIGHTS
-  = TRAFFIC SIGNAL

GENERAL NOTES:

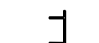
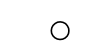
1. PLACEMENT OF TEMPORARY CONCRETE BARRIERS, TEMPORARY IMPACT ATTENUATORS, TEMPORARY SIGNALS, DRUMS WITH STEADY BURNING LIGHTS, AND STOP BARS SHALL BE AS SHOWN.
2. PLACEMENT OF OTHER TRAFFIC CONTROL ITEMS NOT SHOWN ON THE DRAWINGS SHALL BE DONE PER STANDARD 701321.
3. FROM STA. 944+40 TO STA. 945+00
4. THE BOTTOM 9" OF SUBBASE GRANULAR MATERIAL, TYPE A, 12" SHALL BE CA-2.

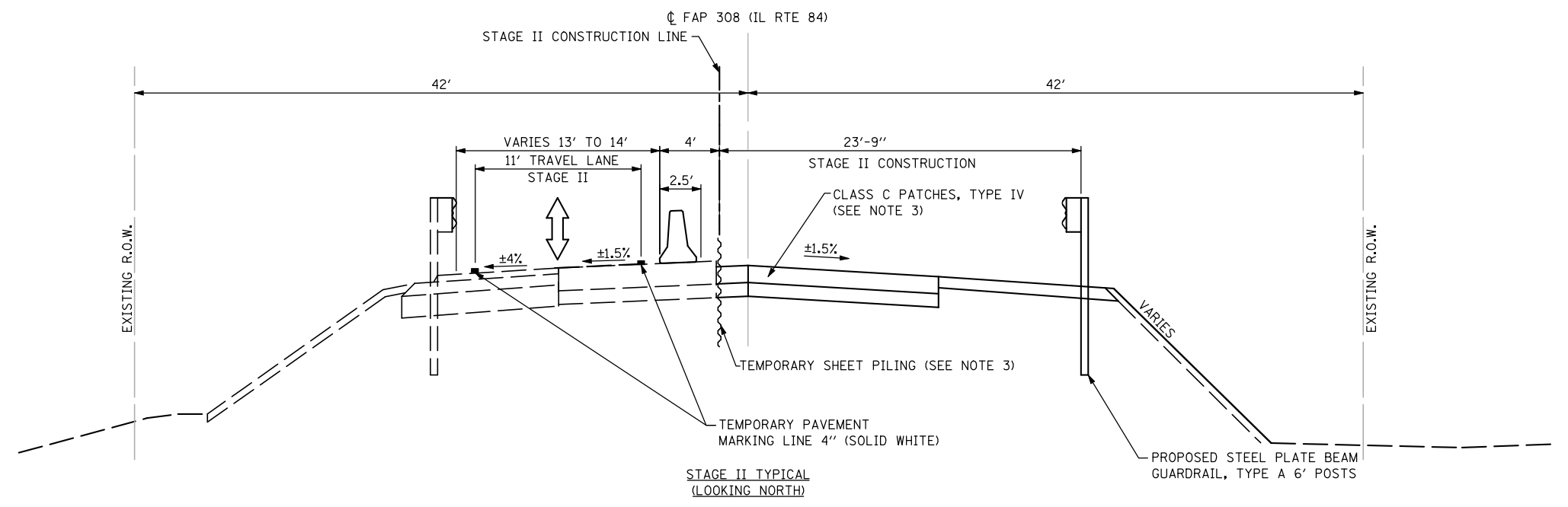
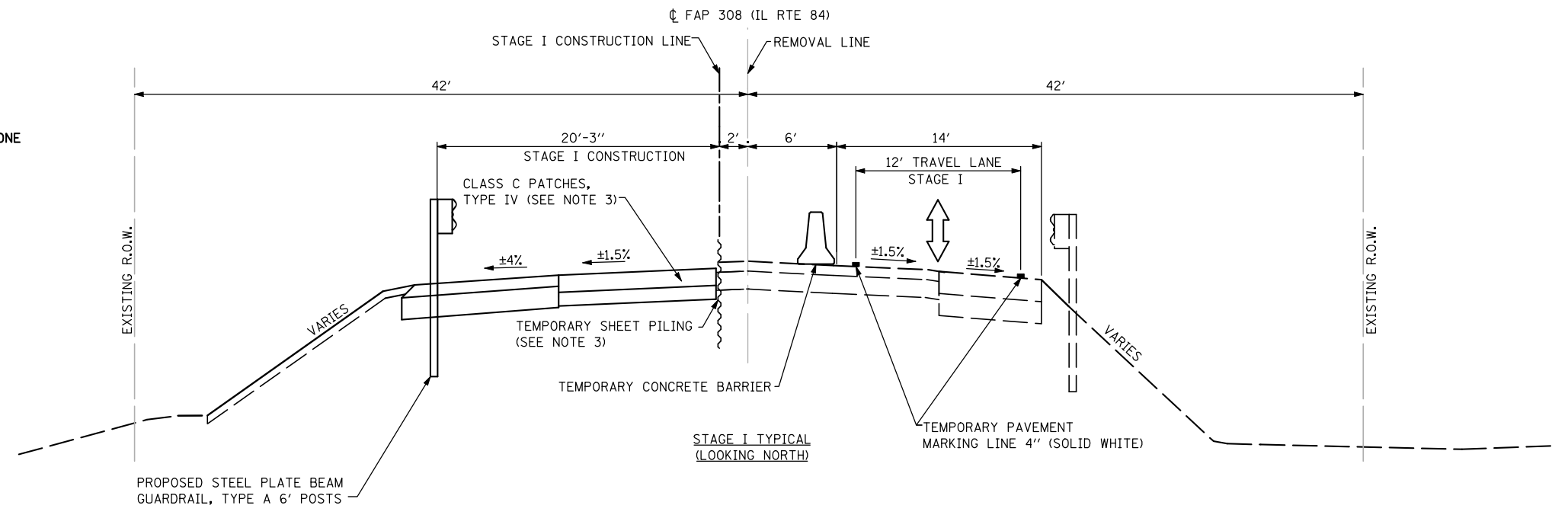
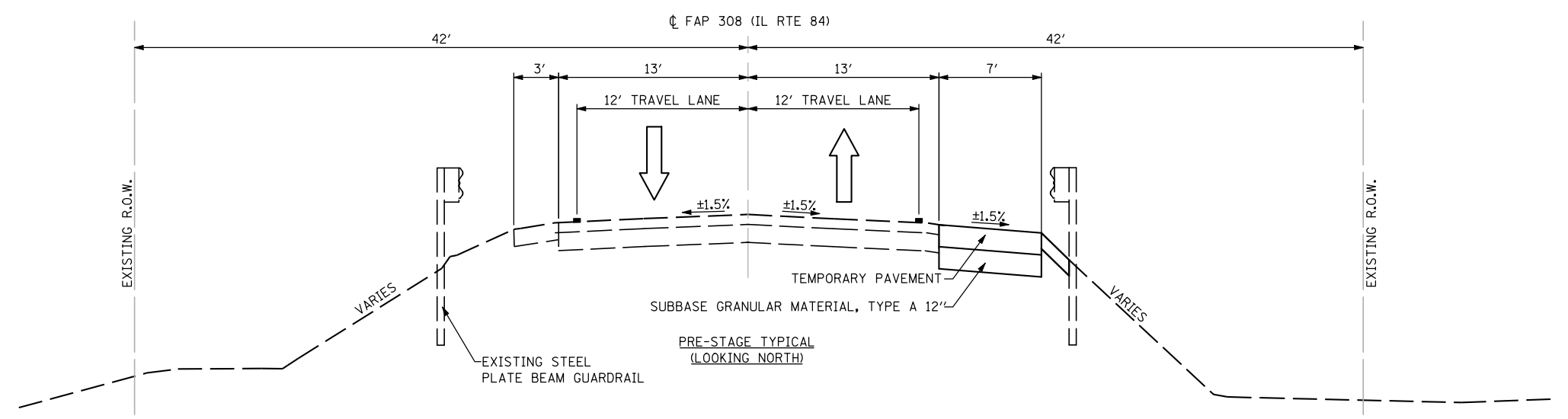

FILE NAME = s:\p1\6380--6395\6346\026\micro\cadd sheets\0264925-sh-t-typical4.dgn

SA STRAND ASSOCIATES
 1170 SOUTH HOUBOLT ROAD
 JOLIET, ILLINOIS 60431
 (815) 744-4200

USER NAME = brianf	DESIGNED -	REVISED -
PLOT SCALE = 40.0000' / IN.	DRAWN -	REVISED -
PLOT DATE = 8/15/2012	CHECKED -	REVISED -
	DATE -	REVISED -

**STATE OF ILLINOIS
 DEPARTMENT OF TRANSPORTATION**

STAGING TYPICAL SECTION

SCALE: AS SHOWN SHEET NO. OF SHEETS STA. TO STA.

F.A.P. RTE. 308	SECTION 110T	COUNTY ROCK ISLAND	TOTAL SHEETS 51	SHEET NO. 19
CONTRACT NO. 64925				
FED. ROAD DIST. NO. 2 ILLINOIS FED. AID PROJECT				