

STAGE 1

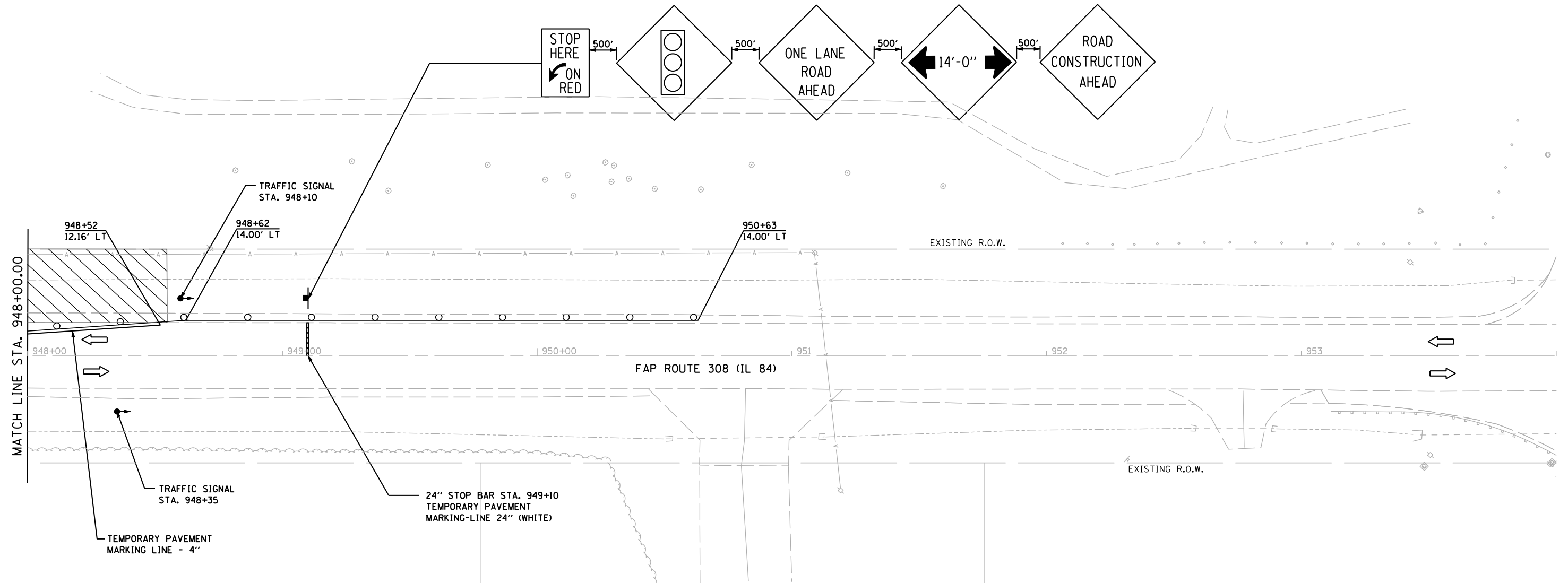





MATCH LINE STA. 948+00.00

STAGE 1 NOTES:

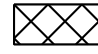
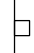
1. INSTALL TRAFFIC CONTROL AND TEMPORARY SIGNALS ACCORDING TO STANDARD 701321.
2. DRIVE TEMPORARY SHEET PILING AS NECESSARY.
3. REMOVE THE WEST SIDE OF THE CULVERT.
4. CONSTRUCT THE WEST SIDE OF THE CULVERT INCLUDING RIP-RAP, EARTHWORK, AND CLASS C PATCH.
5. REMOVE AND CONSTRUCT HMA DRIVEWAY INCLUDING PROPOSED PIPE CULVERT.
6. INSTALL PROPOSED HMA SHOULDERS ON SOUTHBOUND LANE.
7. INSTALL THE PROPOSED GUARDRAIL ON THE WEST SIDE.

LEGEND:

-  = WORK ZONE
-  = TEMPORARY PAVEMENT
-  = SIGN
-  = TYPE III BARRICADE
-  = DRUM WITH STEADY BURNING LIGHTS
-  = TRAFFIC SIGNAL

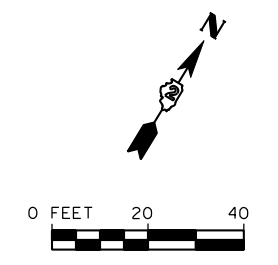

FILE NAME = s:\p1\6380--6395\6346\026\micro\cadd sheets\0264925-sh1-stage1.dgn

SA STRAND ASSOCIATES
 1170 SOUTH HOUBOLT ROAD
 JOLIET, ILLINOIS 60431
 (815) 744-4200

| | | |
|-----------------------------|------------|-----------|
| USER NAME = brianf | DESIGNED - | REVISED - |
| PLOT SCALE = 40.0000' / IN. | DRAWN - | REVISED - |
| PLOT DATE = 8/8/2012 | CHECKED - | REVISED - |
| | DATE - | REVISED - |

**STATE OF ILLINOIS
 DEPARTMENT OF TRANSPORTATION**

SUGGESTED MAINTENANCE OF TRAFFIC

| | | | | | |
|-----------------|-----------|----|--------|-------------|---------|
| SCALE: AS SHOWN | SHEET NO. | OF | SHEETS | STA. 948+00 | TO STA. |
|-----------------|-----------|----|--------|-------------|---------|

| | | | | |
|---|---------|-------------|--------------|-----------|
| F.A.P. RTE. | SECTION | COUNTY | TOTAL SHEETS | SHEET NO. |
| 308 | 110T | ROCK ISLAND | 51 | 23 |
| CONTRACT NO. 64925 | | | | |
| FED. ROAD DIST. NO. 2 ILLINOIS FED. AID PROJECT | | | | |