

STAGE 2

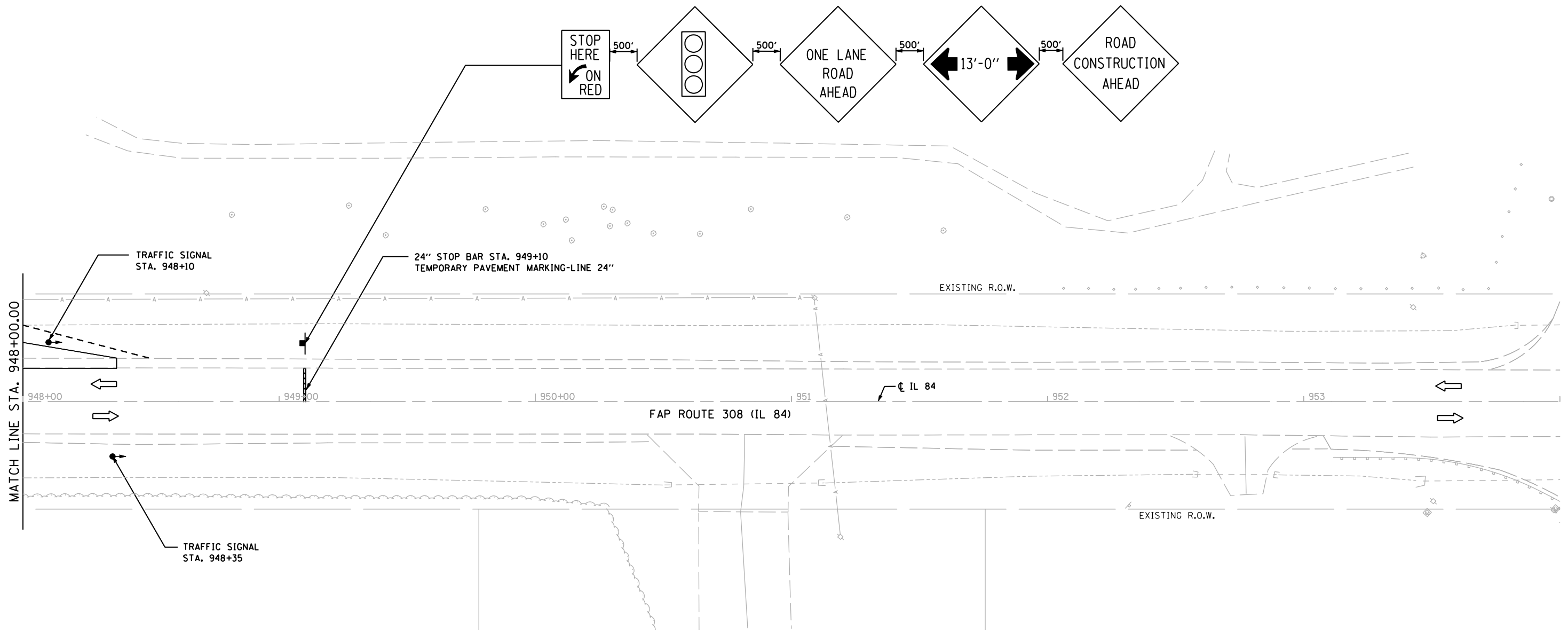

STAGE 2 NOTES:

1. RELOCATE TRAFFIC CONTROL AND TEMPORARY SIGNALS ACCORDING TO STAGE 2 MAINTENANCE OF TRAFFIC DETAILS AND STANDARD 701321.
2. REMOVE EAST SIDE OF CULVERT AND TEMPORARY PAVEMENT.
3. CONSTRUCT THE EAST SIDE OF THE CULVERT INCLUDING RIP-RAP, EARTHWORK, AND CLASS C PATCH.
4. REMOVE FIELD ENTRANCE AND CONSTRUCT PROPOSED AGGREGATE FIELD ENTRANCE AT STA. 941+70.
5. INSTALL PROPOSED HMA SHOULDERS ON NORTHBOUND LANE.
6. INSTALL THE PROPOSED GUARDRAIL ON THE EAST SIDE.

STAGE 3 NOTES:

1. REMOVE TRAFFIC CONTROL AND TEMPORARY TRAFFIC SIGNALS FROM PREVIOUS MAINTENANCE OF TRAFFIC DETAILS AND STANDARD 701321.
2. INSTALL HMA SURFACE COURSE MIX "C", N50
3. INSTALL PERMANENT PAVEMENT MARKINGS.

LEGEND:

	= WORK ZONE
	= TEMPORARY PAVEMENT
	= SIGN
	= TYPE III BARRICADE
	= DRUM WITH STEADY BURNING LIGHTS
	= TRAFFIC SIGNAL

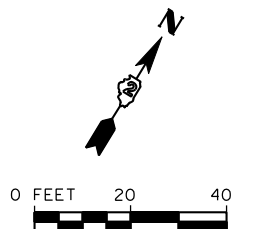

FILE NAME = s:\p1\6380--6395\6346\026\micro\cadd sheets\0264925-ah-stage2.dgn

SA STRAND ASSOCIATES
1170 SOUTH HOUBOLT ROAD
JOLIET, ILLINOIS 60431
(815) 744-4200

USER NAME = brianf	DESIGNED -	REVISED -
PLOT SCALE = 40.0000' / IN.	DRAWN -	REVISED -
PLOT DATE = 8/15/2012	CHECKED -	REVISED -
	DATE -	REVISED -

**STATE OF ILLINOIS
DEPARTMENT OF TRANSPORTATION**

SUGGESTED MAINTENANCE OF TRAFFIC

SCALE: AS SHOWN SHEET NO. OF SHEETS STA. TO STA. 948+00

F.A.P. RTE.	SECTION	COUNTY	TOTAL SHEETS	SHEET NO.
308	110T	ROCK ISLAND	51	26
CONTRACT NO. 64925				
FED. ROAD DIST. NO. 2 ILLINOIS FED. AID PROJECT				