

FILE NAME = s:\p1\6380--6395\6346\026\macro\cadd sheets\1264925-ah-eros.dgn

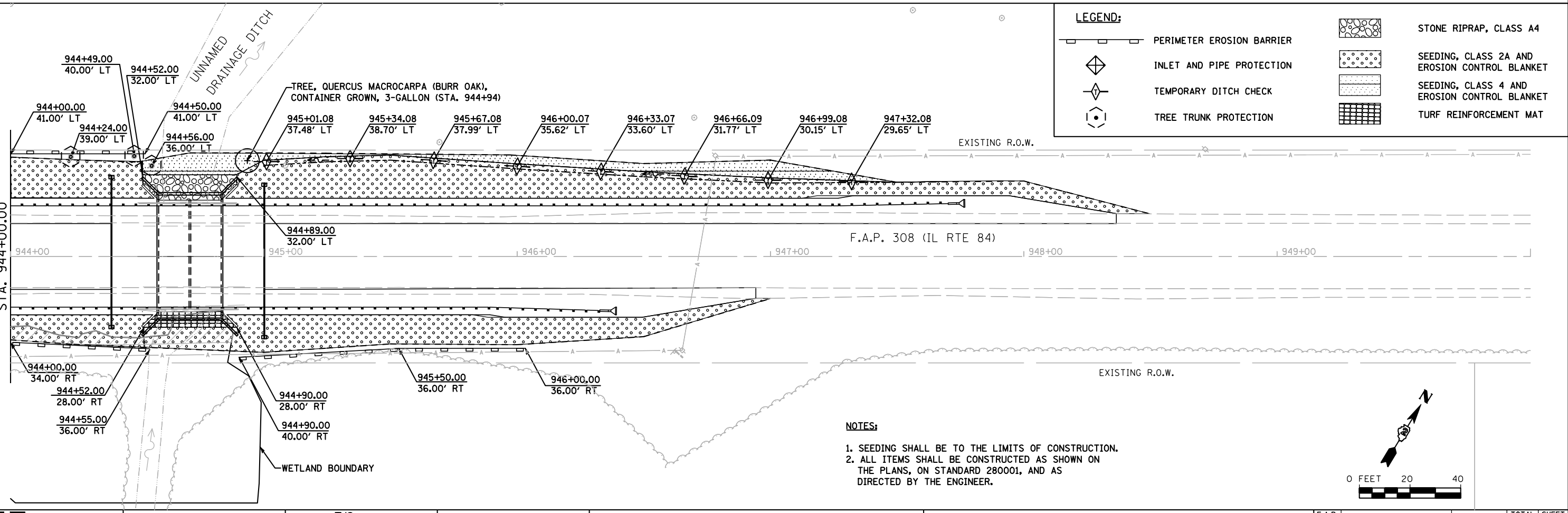
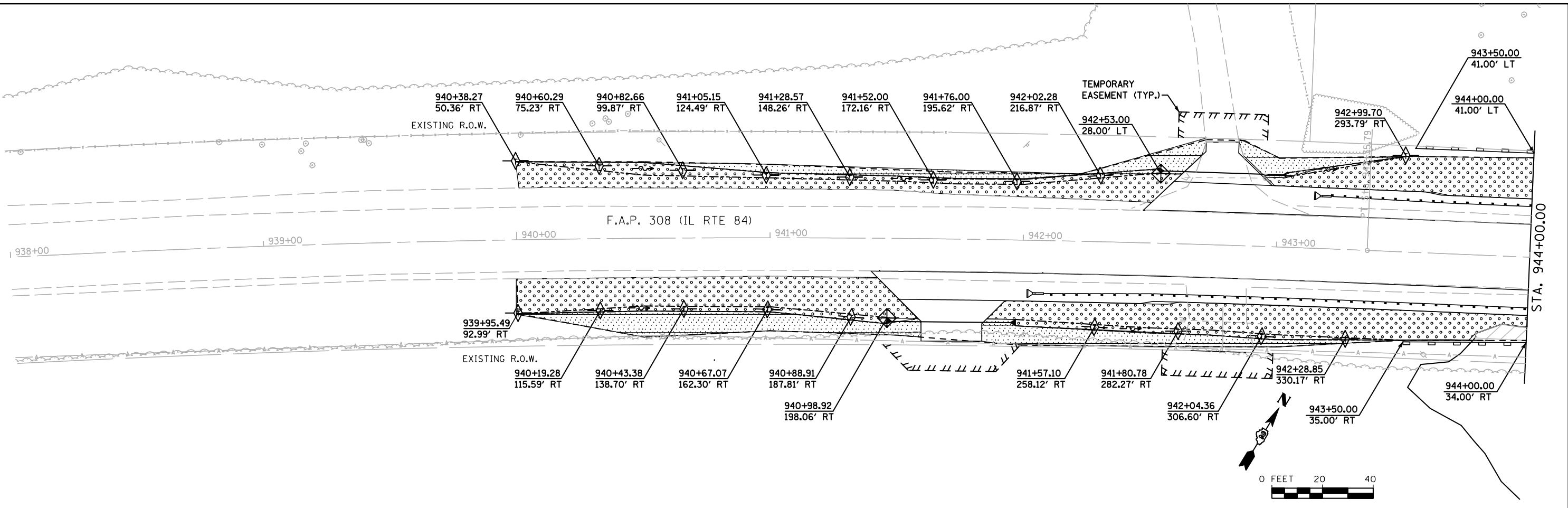

**LEGEND:**

	PERIMETER EROSION BARRIER		STONE RIPRAP, CLASS A4
	INLET AND PIPE PROTECTION		SEEDING, CLASS 2A AND EROSION CONTROL BLANKET
	TEMPORARY DITCH CHECK		SEEDING, CLASS 4 AND EROSION CONTROL BLANKET
	TREE TRUNK PROTECTION		TURF REINFORCEMENT MAT

**NOTES:**  
 1. SEEDING SHALL BE TO THE LIMITS OF CONSTRUCTION.  
 2. ALL ITEMS SHALL BE CONSTRUCTED AS SHOWN ON THE PLANS, ON STANDARD 280001, AND AS DIRECTED BY THE ENGINEER.

**SA STRAND ASSOCIATES**  
 1170 SOUTH HOUBOLT ROAD  
 JOLIET, ILLINOIS 60431  
 (815) 744-4200

USER NAME = briant	DESIGNED <i>TJS</i>	REVISED -
PLOT SCALE = 48.0000' / IN.	DRAWN <i>BJF</i>	REVISED -
PLOT DATE = 8/8/2012	CHECKED <i>VLF</i>	REVISED -
	DATE -	REVISED -

**STATE OF ILLINOIS  
 DEPARTMENT OF TRANSPORTATION**

**EROSION CONTROL**  
 SCALE: AS SHOWN | SHEET NO. 1 OF 1 SHEETS | STA. TO STA.

F.A.P. RTE. 308	SECTION 110T	COUNTY ROCK ISLAND	TOTAL SHEETS 51	SHEET NO. 27
CONTRACT NO. 64925				
FED. ROAD DIST. NO. 2   ILLINOIS FED. AID PROJECT				