

U.S. ROUTE 45/52
 STA 396+78.99 (P.O.T.)
 N = 1579970.022
 E = 1112809.749

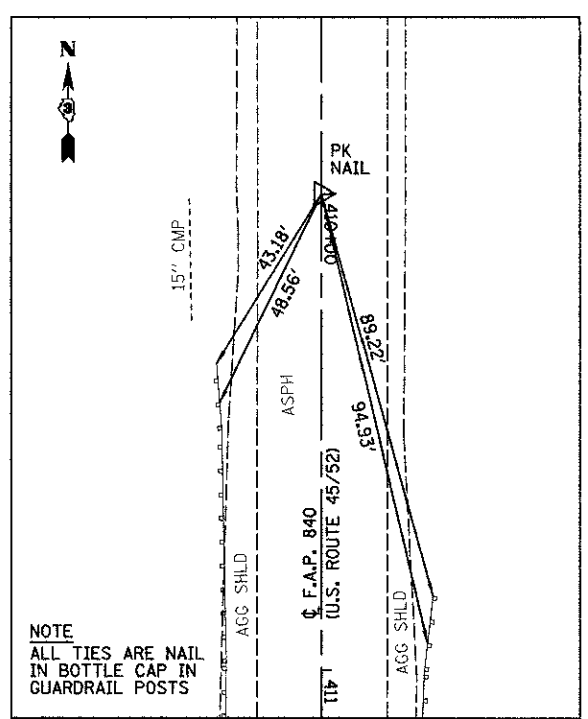

U.S. ROUTE 45/52
 STA 410+00.00 (P.O.T.)
 N = 1578649.194
 E = 1112831.705

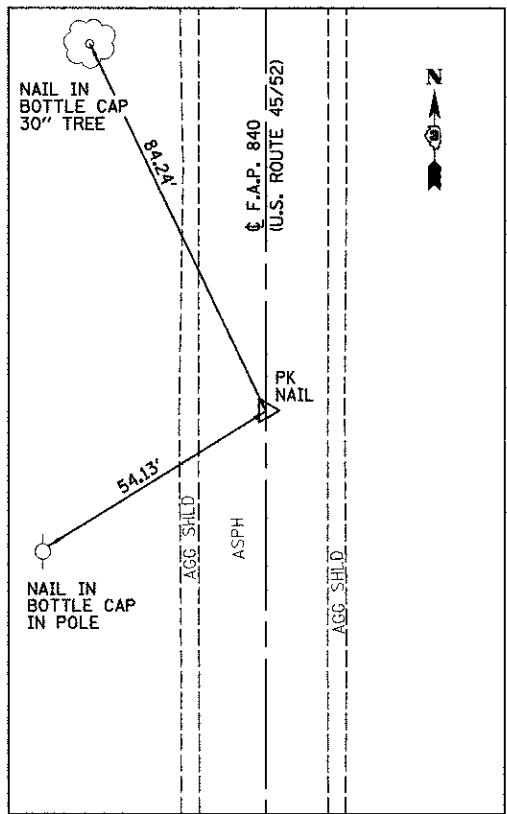

U.S. ROUTE 45/52
 STA 415+00.00 (P.O.T.)
 N = 1578149.263
 E = 1112840.016

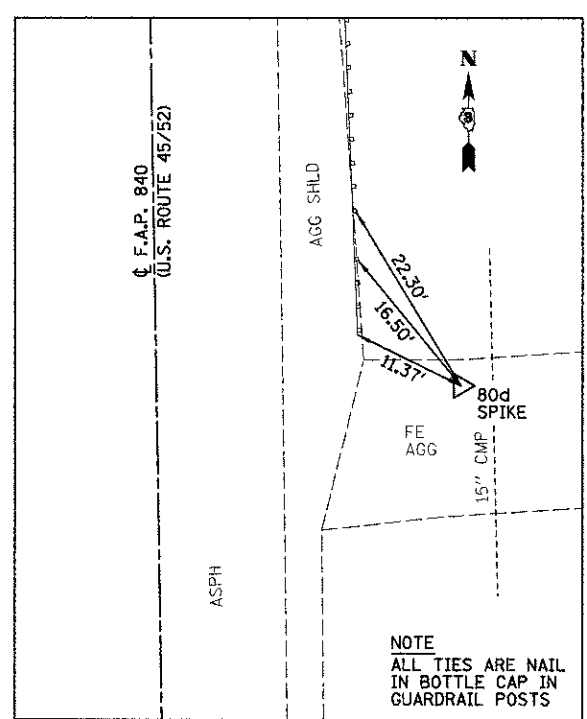

U.S. ROUTE 45/52
 CONTROL POINT
 STA 413+50.83, 28.22' LT
 N = 1578298.890
 E = 1112849.730

BENCHMARK #1
 STA 412+12, 51' RT
 RAILROAD SPIKE
 IN POWER POLE
 ELEV = 633.83

BENCHMARK #2
 STA 412+33, 21' LT
 BRASS DISK SET IN
 TOP OF S.E. WINGWALL
 ELEV = 633.89

BENCHMARK #3
 STA 413+51, 28' LT
 80d SPIKE IN FIELD
 ENTRANCE
 ELEV = 633.60

BENCHMARK #4
 STA 421+70, 38' RT
 RAILROAD SPIKE
 IN POWER POLE
 ELEV = 637.71

FILE NAME =	USER NAME = #USER#	DESIGNED - JML	REVISED -	STATE OF ILLINOIS DEPARTMENT OF TRANSPORTATION	ALIGNMENT, SURVEY TIES AND BENCHMARKS			F.A.P. RTE.	SECTION	COUNTY	TOTAL SHEETS	SHEET NO.
#FILE#	PLOT SCALE = #SCALE#	DRAWN - JJO/DJM	REVISED -					840	138 BR-3	IROQUOIS	28	8
	PLOT DATE = #DATE#	CHECKED - MSW	REVISED -					CONTRACT NO. 66971			FED. ROAD DIST. NO. ILLINOIS FED. AID PROJECT	
		DATE - 07-27-11	REVISED -					SCALE:	SHEET NO.	OF SHEETS	STA.	TO STA.