

PRE-STAGE

- 1.) REMOVE LEFT SHOULDER FROM STA. 858+20.00 TO STA. 859+46.60, STA. 860+06.83 TO STA. 861+76.05, AND STA. 862+51.16 TO STA. 866+20.00. REPLACE WITH HOT-MIX ASPHALT BASE COURSE WIDENING, 8" AT STATIONS SHOWN ABOVE USING STANDARD 701326.
- 2.) POUR CONTROLLED LOW-STRENGTH MATERIAL UNDER APPROACH SLAB IN SOUTH EAST QUADRANT.

STAGE I

- 1.) TRAFFIC CONTROL SHALL BE PROVIDED AS SHOWN HEREIN AND IN ACCORDANCE WITH TRAFFIC CONTROL STANDARD 701321 OR TRAFFIC CONTROL STANDARD BLR 21. THE COST OF TYPE III BARRICADES AND DRUMS WITH STEADY BURNING LIGHTS SHALL BE INCLUDED WITH STANDARD 701321 OR STANDARD BLR 21.
- 2.) THE WIDTH RESTRICTION SIGNING SHALL BE 9'-9".
- 3.) ADVANCED WARNING SIGNS SHALL BE PLACED ON N 300E ROAD. MOUNT THE "ROAD CONSTRUCTION AHEAD" SIGNS ON TYPE II BARRICADES WITH TWO FLASHING MONO-DIRECTIONAL LIGHTS FOR EACH SIGN.
- 4.) ADVANCED WARNING SIGNS SHALL BE PLACED ON S 300E ROAD. MOUNT THE "ROAD CLOSED" SIGNS ON TYPE II BARRICADES WITH TWO FLASHING MONO-DIRECTIONAL LIGHTS FOR EACH SIGN.
- 5.) ONE FLASHING MONO-DIRECTIONAL LIGHT SHALL BE ADDED TO ALL OF THE REMAINING ADVANCED WARNING SIGNS.
- 6.) PROVIDE TEMPORARY BRIDGE TRAFFIC SIGNALS.
- 7.) PROVIDE TEMPORARY CONCRETE BARRIER.
- 8.) ACTIVATE TEMPORARY BRIDGE TRAFFIC SIGNALS AND DIVERT TRAFFIC TO THE STAGE I TRAFFIC LANE.
- 9.) REMOVE THE PORTION OF THE EXISTING BRIDGE NORTH OF THE STAGE REMOVAL LINE. REMOVE THE PORTION OF THE EXISTING PAVEMENT REQUIRED TO CONSTRUCT THE FULL-DEPTH PAVEMENT, BRIDGE, APPROACH SLABS AND APPROACH SLAB FOOTINGS.
- 10.) CONSTRUCT THE PORTION OF THE BRIDGE NORTH OF STAGE CONSTRUCTION LINE. CONSTRUCT THE PORTION OF THE APPROACH SLABS AND APPROACH SLAB FOOTINGS NORTH OF THE STAGE CONSTRUCTION LINE.
- 11.) CONSTRUCT THE PORTION OF THE PROJECT (ROADWAY, DRAINAGE ELEMENTS, ETC.) NORTH OF THE STAGE CONSTRUCTION LINE. PROVIDE EMBANKMENT, EXCAVATION, LEVELING BINDER, HOT-MIX ASPHALT SHOULDERS AND GUARDRAIL NORTH OF THE STAGE CONSTRUCTION LINE.
- 12.) PLACE TEMPORARY RAMPS AT THE ENDS OF THE APPROACH SLAB PRIOR TO SWITCHING TO STAGE II.

NOTE:

- 1.) FOR DETAILS NOT SHOWN SEE HIGHWAY STANDARD 701321 OR BLR 21.

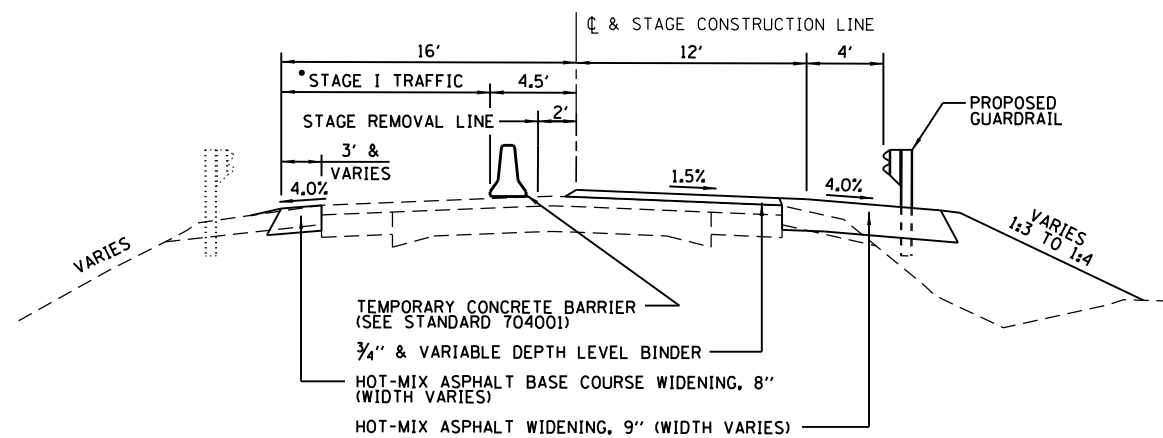

STAGE I ROADWAY OVERLAY TYPICAL SECTION - LOOKING WEST
 *STAGE I TRAFFIC WIDTH IS 11.5' AND VARIES.

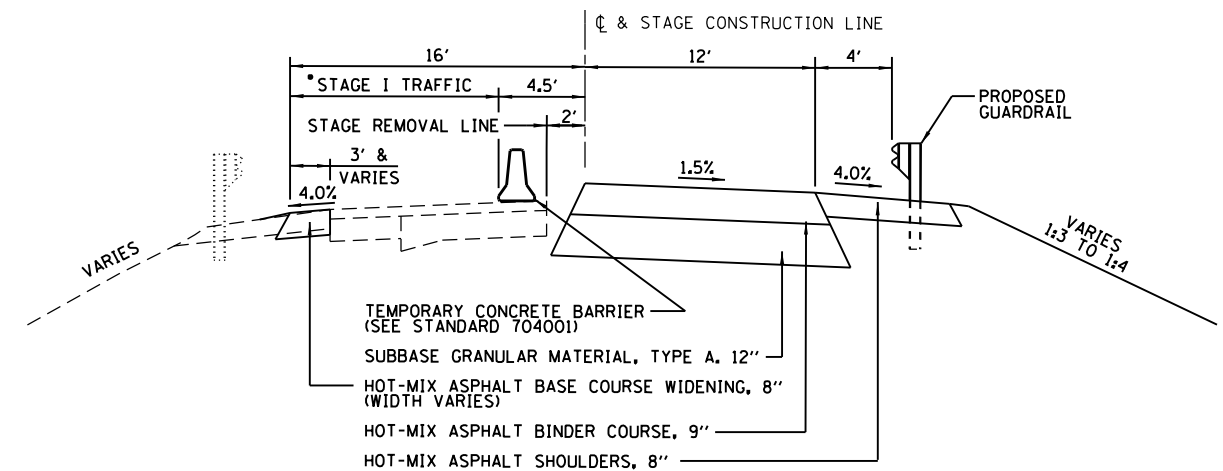

STAGE I ROADWAY FULL DEPTH TYPICAL SECTION - LOOKING WEST
 *STAGE I TRAFFIC WIDTH IS 11.5' AND VARIES.



USER NAME = dmeyer	DESIGNED - JJ0	REVISED -
PLOT SCALE = 48.0000' / in.	DRAWN - JJ0	REVISED -
PLOT DATE = 8/13/2012	CHECKED - JML	REVISED -
	DATE - 08/10/12	REVISED -

**STATE OF ILLINOIS
 DEPARTMENT OF TRANSPORTATION**

STAGE I CONSTRUCTION

SCALE: SHEET OF SHEETS STA. TO STA.

F.A.P. RTE.	SECTION	COUNTY	TOTAL SHEETS	SHEET NO.
693	19BR	FORD	61	18
CONTRACT NO. 66A12				
ILLINOIS FED. AID PROJECT				