

STATE OF ILLINOIS
DEPARTMENT OF TRANSPORTATION

ROUTE NO.	SECTION	COUNTY	TOTAL SHEETS	SHEET NO.
693	19B	FORD	42	27
8 SHEETS				

Bench Mark: #2 on S.E. Wingwall 15.7' Lt. Sta. 861+96.5 Elev. 200.0
Existing Structure No. 027-0005 - Built as S.O. Rec. 9
Sec. 19-B in 1928. R.C. Girder Superstructure with
R.C. Closed Abuts. The Bridge Contractor shall remove
existing superstructure and portions of substructure
before starting new construction. Traffic will be detoured
during construction. Broken concrete from
superstructure shall be disposed of as directed
by the Engineer.

GENERAL NOTES
A Calcium Nitrite Corrosion Inhibitor, as covered
the Special Provisions, shall be used in the concrete
for precast prestressed concrete deck beams.
All structural steel shall be shop primed with two coats of
basic lead silico chromate.
The top surface of the beams shall be finished in accordance
with Act. 505.06 of the Std. Specifications except that the surface
shall not be completed by booming. The finished surface shall
be free of depressions or high spots with sharp corners.
Expansion joints which are not cast in the precast unit shall
be fabricated and erected in accordance with Act. 503.07 (c) of
the Std. Specifications and are included in quantity of structure
steel.
Expansion bolts shall consist of 1/2" drilling expansion and
3/4" x 12" hooked bolts unless otherwise noted.
See Proposal for Zoning Data.
Reinforcement bars shall conform to the requirements of
AASHTO M31 Grade 60.
Plan dimensions and details relative to existing
structures have been taken from existing plans and
are subject to nominal construction variations. It
shall be the Contractor's responsibility to verify
such dimensions and details in the field and make
necessary approved adjustments prior to construction
or ordering of materials. Such variations shall
not be cause for additional compensation for a
change in the scope of the work, however, the
Contractor will be paid for the quantity actually
furnished at the unit price bid for the work.

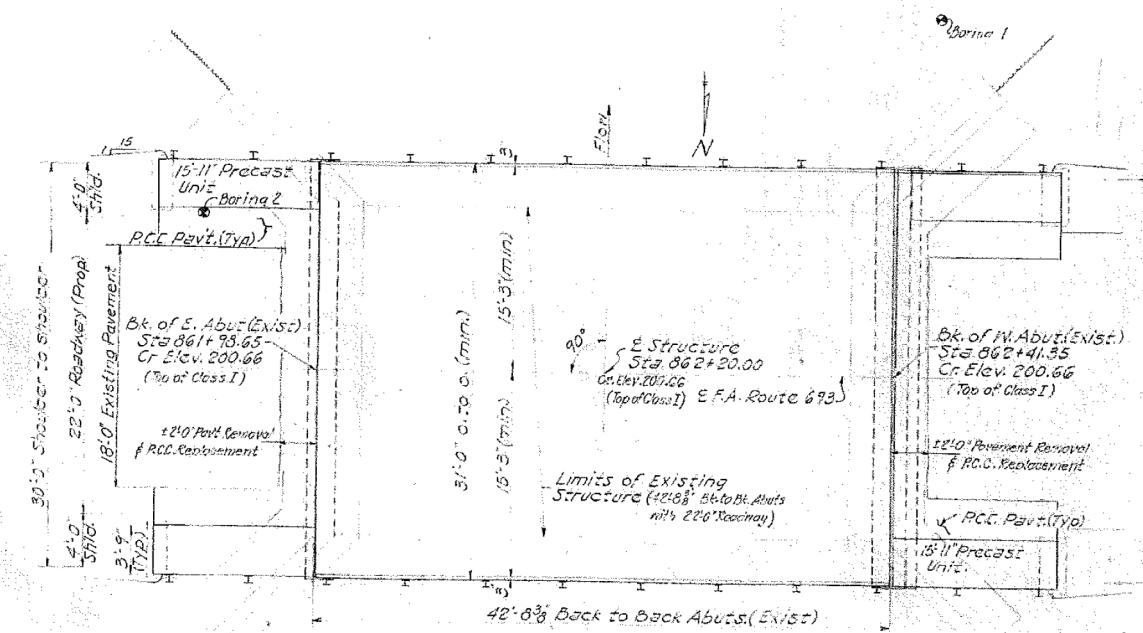
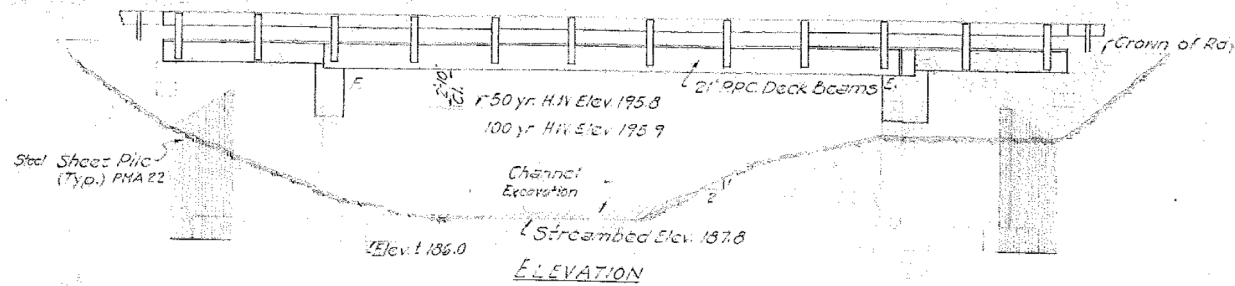

STATION 862+20
REBUILT 1977 BY
STATE OF ILLINOIS
F.A. RT. 693 SEC. 19 BR-1
LOADING HS 20
STR. NO. 027-0005

NAME PLATE
(See Std. 2113)

TOTAL BILL OF MATERIAL

Item	Unit	Super	Sub	Total
Removal of Existing Superstructures	Each			1
Channel Excavation	Cu.Yd.		44.27	44.27
Bitum. Concrete Surface Course, Class I	Ton	15		15
Concrete Removal	Cu.Yd.		11	11
Expansion Bolts (3/4" x 6")	Each	40	46	86
Class I Concrete	Cu.Yd.	2.3	20.3	22.6
Precast Prestressed Concrete Deck Bms. (21")	Sq. Ft.	1309		1309
Waterproofing Membrane System	Sq. Yd.	147		147
Structural Steel	Pound	2200		2200
Steel Rolling, Type 5	Lin. Ft.	150		150
Reinforcement Bars	Pound	100	1860	1960
Pavement Removal & RCC. Replacement	Sq. Ft.	10		10
Precast Concrete Bar-riar Slab	Sq. Ft.	239		239
Name Plates	Each			1
P.C. Machine Finishing Course	Lin. Ft.	338		338
Preformed Jt. Sealer (2 1/2")	Lin. Ft.	31		31
Sheet Steel Piling	Sq. Ft.		238	238
Portland Cement Concrete Pavement (18")	Sq. Yd.	20		20
Pavement Fabric	Sq. Yd.	20		20

PROFILE GRADE
F.A. Route 693

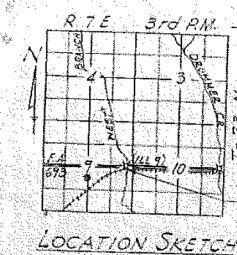

WATERWAY INFORMATION

Drainage Area 9.75 Sq. Mi.
Design Discharge (50 yr.) 1500 Sq. Ft.
Existing Discharge (below 50 yr. H.W. L.) 240 Sq. Ft.
Required Discharge (below 50 yr. H.W. L.) 240 Sq. Ft.
Created Head for Design Flood 1.0 Ft.
100 year Discharge 1780 C.F.S.
Created Head for 100 year flood 1.0 Ft.

Design Specifications 1977 AASHTO, 1978 & 1979
interim specifications as applicable.
Allow 25 Lbs per sq. ft. for future
wearing surface.

DESIGN STRESSES

FIELD UNITS PRECAST PRESTRESSED UNITS PRECAST UNITS
f_c = 3500 psi. f_c = 5000 psi. f_c = 4,500 psi.
f_y = 60,000 psi. (20 min) f_y = 40,000 psi. f_y = 1,300 psi.
f_s = 50,000 psi. (Struct.) f_s = 27,000 psi. (1/2" strands) f_s = 20,000 psi.

DESIGNED	Jimm. P. [Signature]	YIS	EXAMINED	[Signature]	JUN 16 1978
CHECKED	Michael K. [Signature]		PASSED		
DRAWN	S.L.	KHO.	APPROVED		
CHECKED	M.K.T.				

GENERAL PLAN AND ELEVATION
F.A. ROUTE 693 OVER WEST BRANCH DRUMMER CR.
F.A. ROUTE 693 SECTION 19 BR-1
FORD COUNTY
STATION 862+20.00

FOR INFORMATIONAL
USE ONLY

DESIGNED - TCR	REVISED
CHECKED - JML	REVISED
DRAWN - JWK	REVISED
CHECKED - MSW	REVISED

F.A.P. R.T.E.	SECTION	COUNTY	TOTAL SHEETS	SHEET NO.
693	19B	FORD	61	45
CONTRACT NO. 66A12				
ILLINOIS FED. AID PROJECT				