

NOTES:

UTILIZE TRAFFIC CONTROL STANDARD 701406 FOR THE PLACEMENT OF TEMPORARY CONCRETE BARRIER, (FLAGGER REQUIRED UNTIL BARRIER PLACEMENT COMPLETE).

TAPERED PORTION OF THE TEMPORARY CONCRETE BARRIER SHALL BE PLACED USING A 12:1 TAPER RATE AS SHOWN ON THE PLANS.

VERTICAL PANELS WITH MONODIRECTIONAL STEADY BURNING TYPE A LIGHTS SHALL BE MOUNTED ON THE TAPERED PORTIONS OF THE TEMPORARY CONCRETE BARRIER AT 25' CENTERS, FOR THE LAST 100' OF TAPER PRIOR TO THE TANGENT.

BARRIER WALL REFLECTORS, TYPE C, SHALL BE MOUNTED ON THE TANGENT PORTIONS OF THE TEMPORARY CONCRETE BARRIER AS SHOWN ON THE BARRIER WALL MARKERS DETAIL, AND INCLUDED IN THE COST OF TRAFFIC CONTROL AND PROTECTION (SPECIAL).

TEMPORARY CONCRETE BARRIER	FOOT
OUTSIDE SHOULDER	
WESTBOUND STA. 349+59.96 TO STA. 353+84.96	425.0
EASTBOUND STA. 346+84.96 TO STA. 351+09.96	425.0
MEDIAN SHOULDER	
WESTBOUND STA. 349+54.96 TO STA. 355+04.96	550.0
EASTBOUND STA. 345+64.96 TO STA. 351+14.96	550.0
TOTAL	= 1950.0

IMPACT ATTENUATORS, TEMPORARY (NON-REDIRECTIVE), TEST LEVEL 3 = 2 EACH
 IMPACT ATTENUATORS, TEMPORARY (FULLY-REDIRECTIVE, NARROW), TEST LEVEL 3 = 2 EACH

TRAFFIC CONTROL AND PROTECTION (SPECIAL)

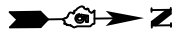

NOT TO SCALE

DATE	
BY	
PLAN	
NO.	
DATE	
BY	
PROFILE	
NO.	

DATE	
BY	
PROFILE	
NO.	
DATE	
BY	
PROFILE	
NO.	

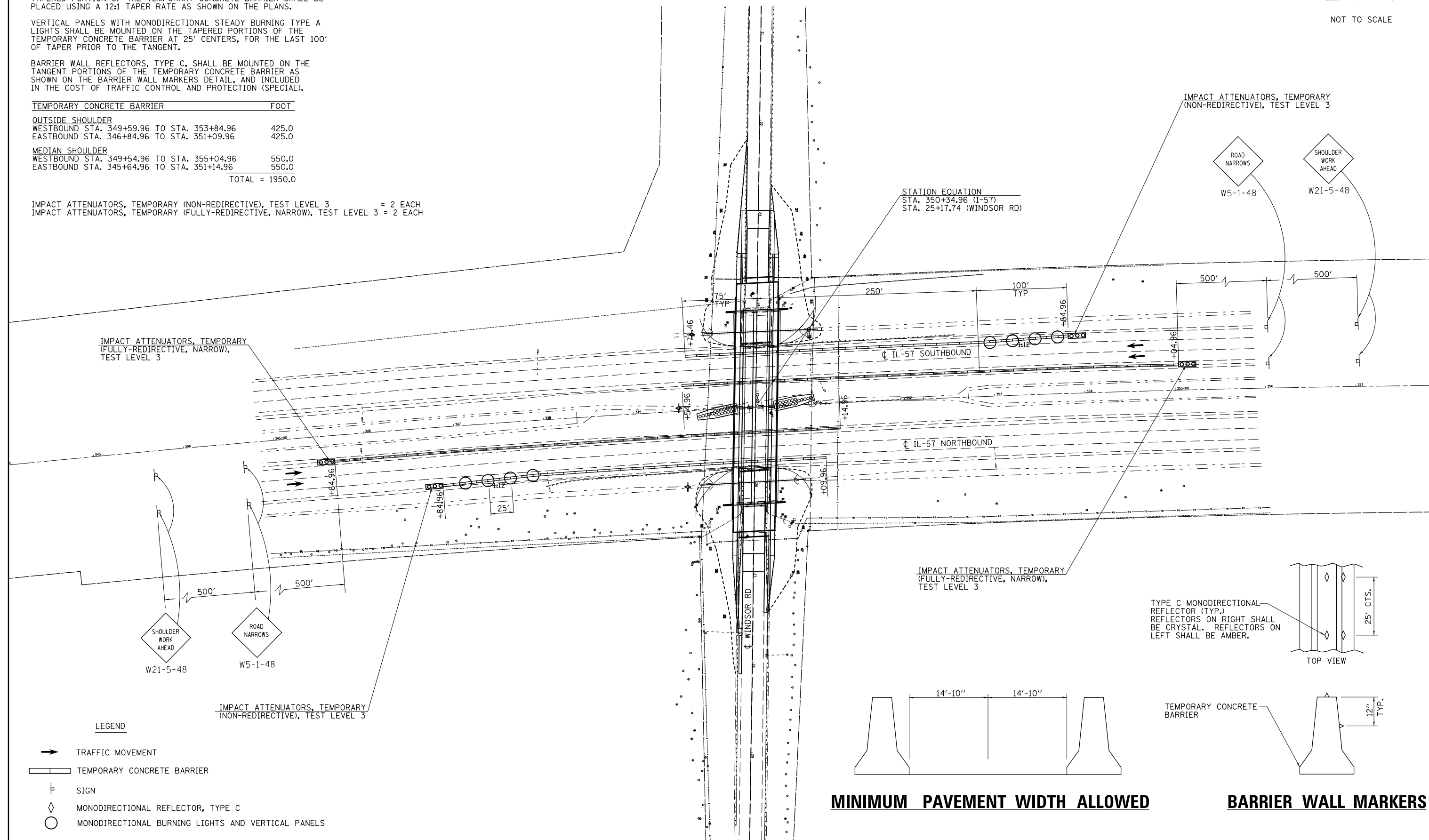

IMPACT ATTENUATORS, TEMPORARY (FULLY-REDIRECTIVE, NARROW), TEST LEVEL 3

STATION EQUATION
 STA. 350+34.96 (I-57)
 STA. 25+17.74 (WINDSOR RD)

IMPACT ATTENUATORS, TEMPORARY (NON-REDIRECTIVE), TEST LEVEL 3

IMPACT ATTENUATORS, TEMPORARY (FULLY-REDIRECTIVE, NARROW), TEST LEVEL 3

TYPE C MONODIRECTIONAL REFLECTOR (TYP.) REFLECTORS ON RIGHT SHALL BE CRYSTAL. REFLECTORS ON LEFT SHALL BE AMBER.

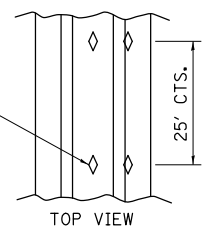

LEGEND

- TRAFFIC MOVEMENT
- ▬ TEMPORARY CONCRETE BARRIER
- ⊥ SIGN
- ◇ MONODIRECTIONAL REFLECTOR, TYPE C
- MONODIRECTIONAL BURNING LIGHTS AND VERTICAL PANELS

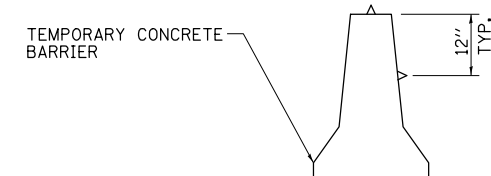
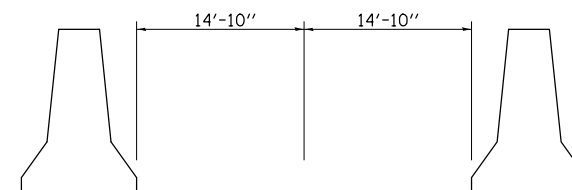

MINIMUM PAVEMENT WIDTH ALLOWED

BARRIER WALL MARKERS

FILE NAME =	USER NAME = keyarb	DESIGNED -	REVISED -
c:\pwork\pwork\keyarb\0152155\0570109	sh-t-TC&P.dgn	DRAWN -	REVISED -
	PLOT SCALE = 100.0020' / 1"	CHECKED -	REVISED -
	PLOT DATE = 8/17/2012	DATE -	REVISED -

STATE OF ILLINOIS
 DEPARTMENT OF TRANSPORTATION

TRAFFIC CONTROL AND PROTECTION (SPECIAL)

SCALE: SHEET NO. 1 OF 1 SHEETS STA. TO STA.

F.A.I. RTE.	SECTION	COUNTY	TOTAL SHEETS	SHEET NO.
57	(10-32HB-2)BY	CHAMPAIGN	81	24
FED. ROAD DIST. NO.			ILLINOIS FED. AID PROJECT	
			CONTRACT NO. 70109	