

INSIDE ELEVATION OF PARAPET

SUPERSTRUCTURE BILL OF MATERIAL

Bar	No.	Size	Length	Shape
a(E)	373	#5	20'-0"	—
a1(E)	259	#5	19'-6"	—
a2(E)	373	#5	27'-0"	—
a3(E)	259	#5	26'-6"	—
b(E)	336	#5	32'-11"	—
b1(E)	141	#6	25'-9"	—
b2(E)	504	#5	29'-3"	—
c(E)	430	#5	2'-4"	⌋
c1(E)	430	#5	5'-8"	⌋
d(E)	432	#4	4'-5"	L
d1(E)	432	#6	4'-4"	L
d2(E)	96	#4	2'-0"	⌋
e(E)	160	#4	17'-2"	—
e1(E)	32	#4	19'-8"	—
m(E)	10	#6	20'-3"	—
m1(E)	20	#6	8'-10"	—
m2(E)	14	#6	5'-2"	—
m3(E)	4	#6	1'-8"	—
m4(E)	10	#6	27'-3"	—
m5(E)	2	#6	3'-2"	—
m6(E)	12	#6	6'-3"	—
m7(E)	4	#6	7'-9"	—
s(E)	108	#5	6'-10"	⌋
s1(E)	92	#4	10'-6"	⌋
v(E)	96	#5	4'-0"	⌋
Reinforcement Bars, Epoxy Coated		Pound	76,220	
Concrete Superstructure		Cu. Yds.	400.5	

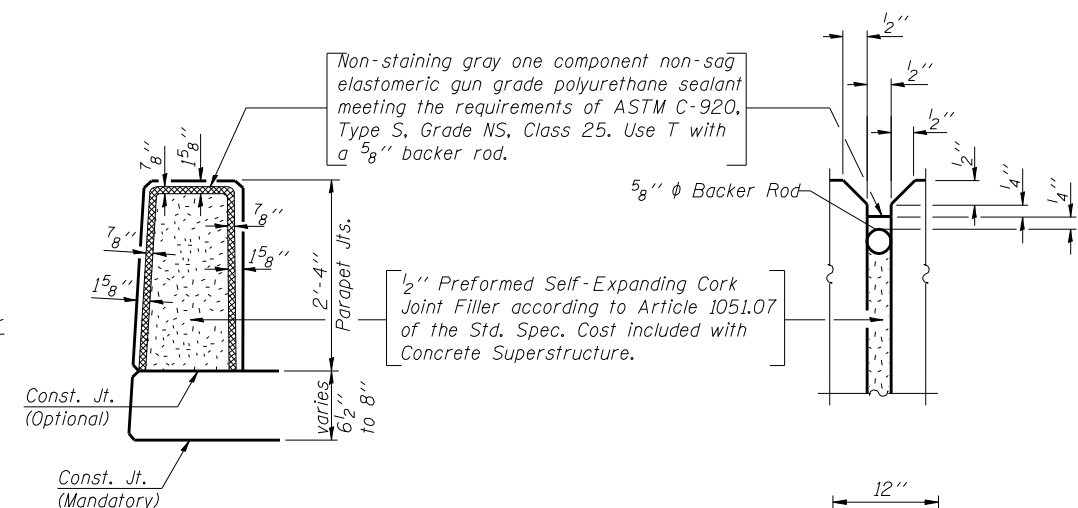
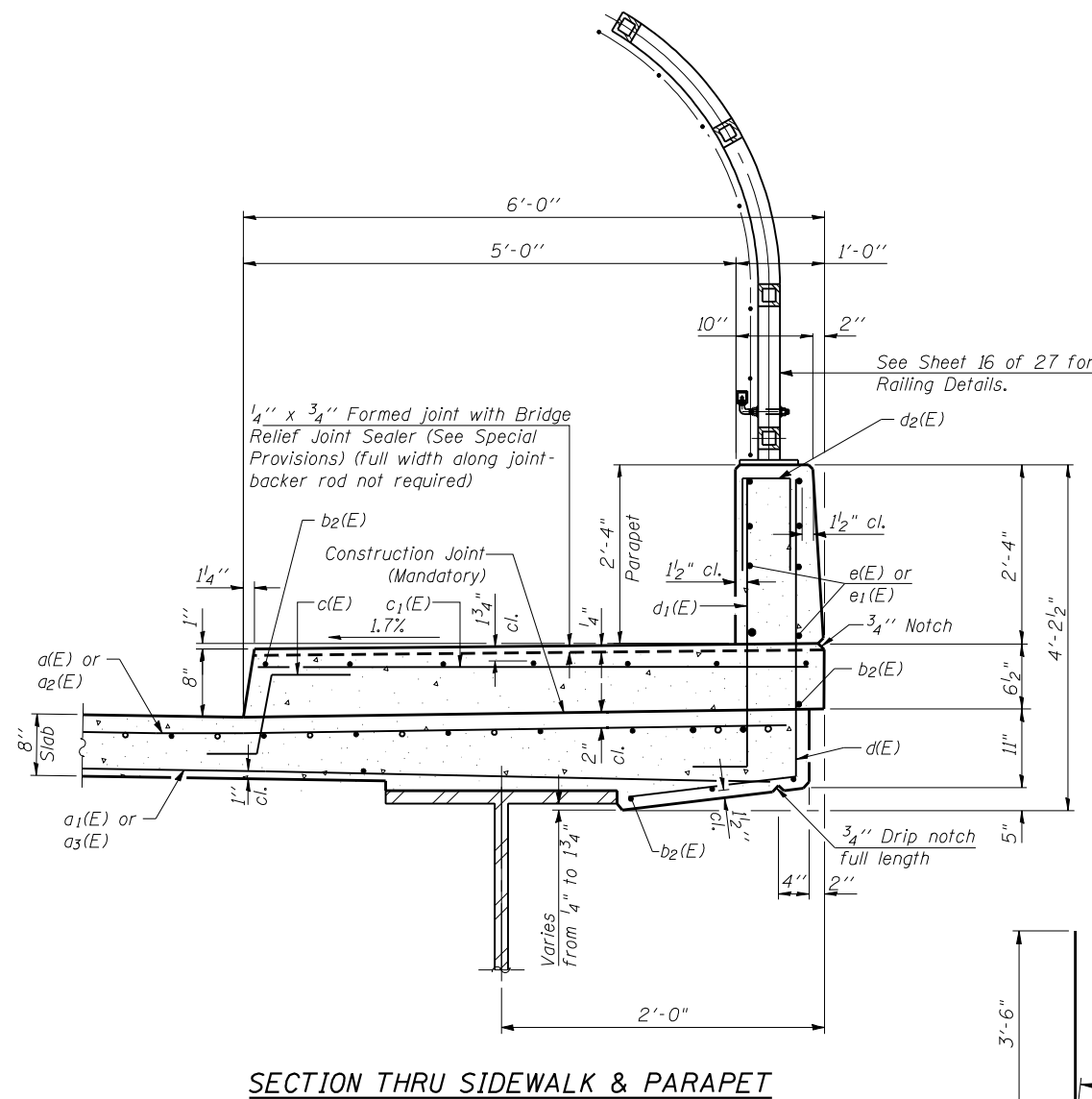

PARAPET JOINT DETAILS

\* In lieu of bottom leg, c(E) bars may be cored and set according to Article 509.06 of the Standard Specifications. Cored holes shall be roughened or scored per manufacturer's recommendations. Maximum depth of cored hole shall not exceed 6".

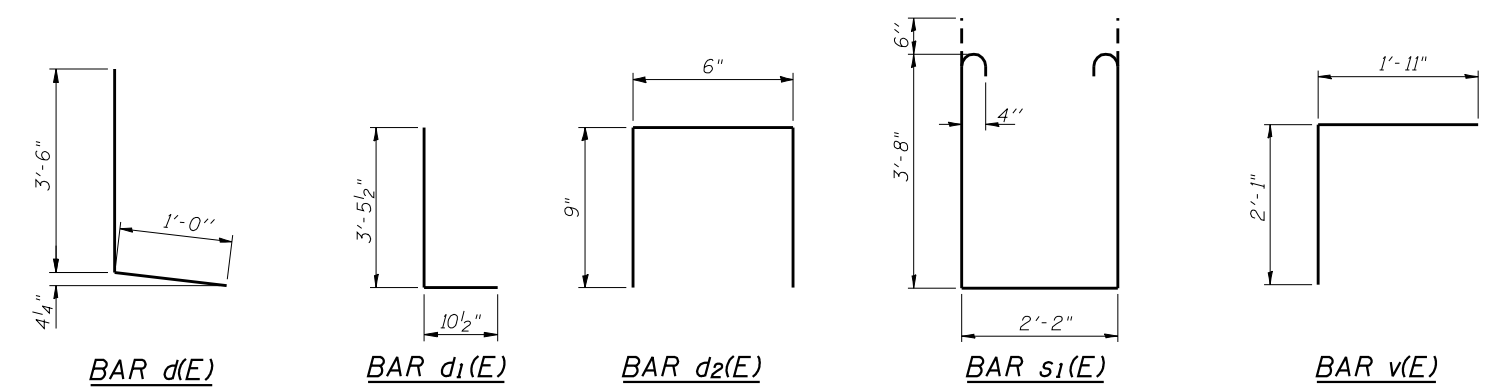
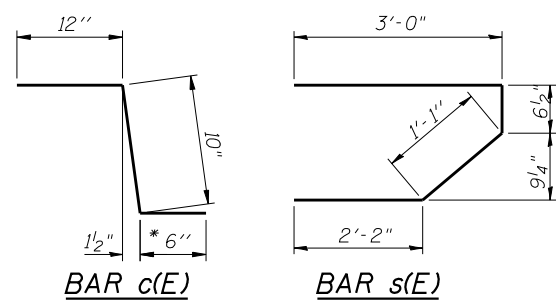

Bars indicated thus 1 x 6-#8 etc. indicates 1 line of bars with 6 lengths per line.

FILE NAME = 70109\_011-100-per-detail.dwg  
 CB PROJECT NO. 090707-7

S-D  
 1-27-12  
**Coombe-Bloxdorf P.C.**  
 CIVIL ENGINEERS-  
 STRUCTURAL ENGINEERS-  
 LAND SURVEYORS  
 Design Firm License No. 184-002703

USER NAME = .MML.	DESIGNED - GJB	REVISED -
PLOT SCALE = 0:2.000000 '1' / IN.	CHECKED - RKM	REVISED -
PLOT DATE = 8/10/2012	DRAWN - CFC	REVISED -
	CHECKED - RKM/MCB	REVISED -

STATE OF ILLINOIS  
 DEPARTMENT OF TRANSPORTATION

SUPERSTRUCTURE DETAILS  
 STRUCTURE NO. 010-0291  
 SHEET NO. 11 OF 27 SHEETS

F.A.I. RTE.	SECTION	COUNTY	TOTAL SHEETS	SHEET NO.
57	(10-32HB-2)BY	CHAMPAIGN	81	49
CONTRACT NO. 70109			ILLINOIS FED. AID PROJECT	