

Notes:
See sheet 15 of 27 for Sections C-C & D-D and View E-E.
a₄(E) thru a₇(E) bar spacings measured along \varnothing Rdwy.

** Cost included with Concrete Superstructure.

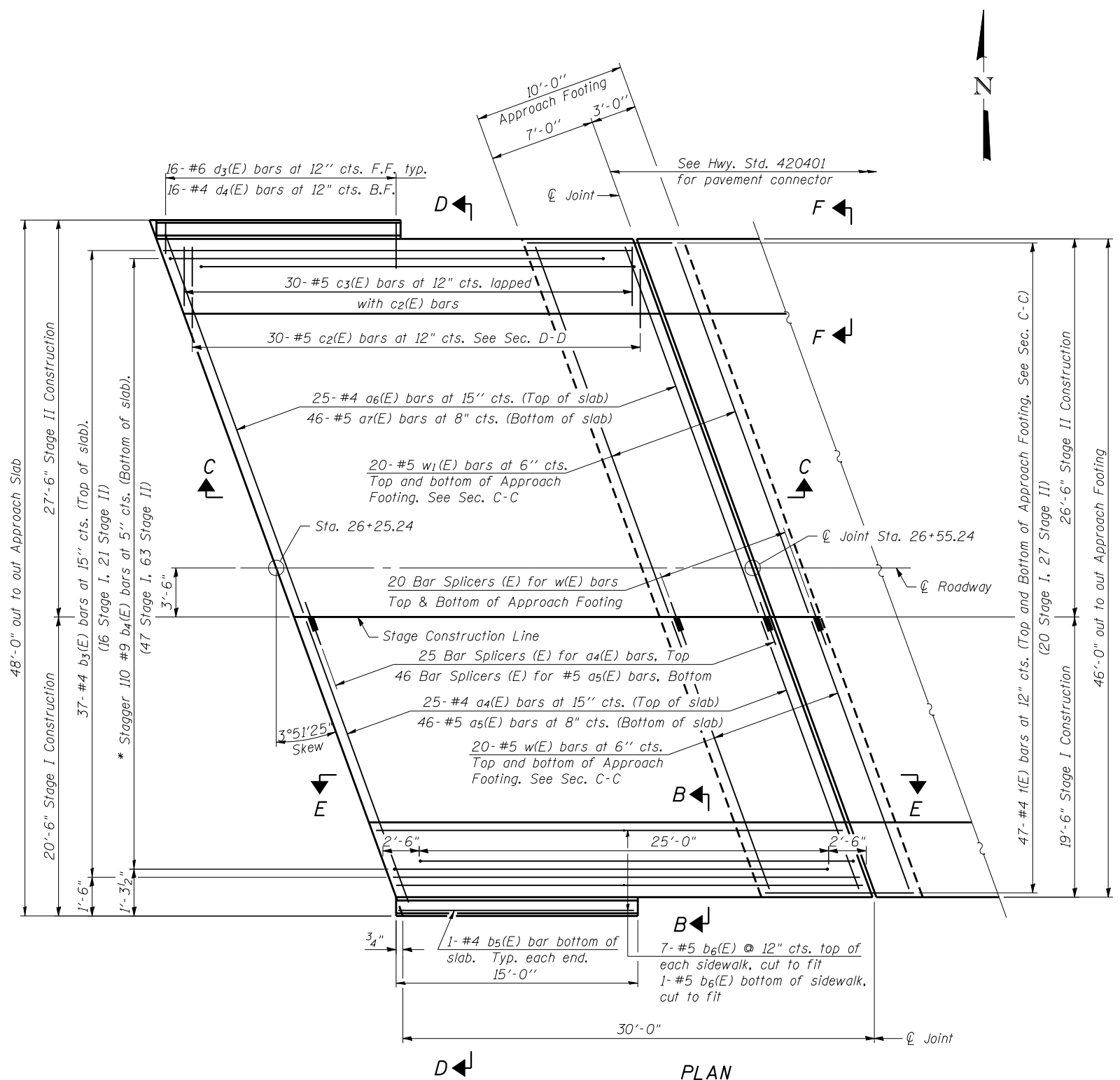

* Tilt #9 b₄(E) bars as required to maintain clearance.

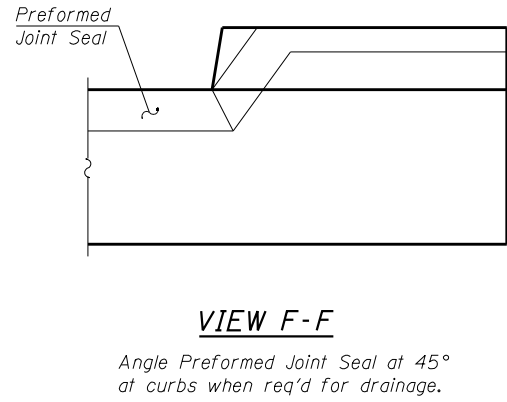
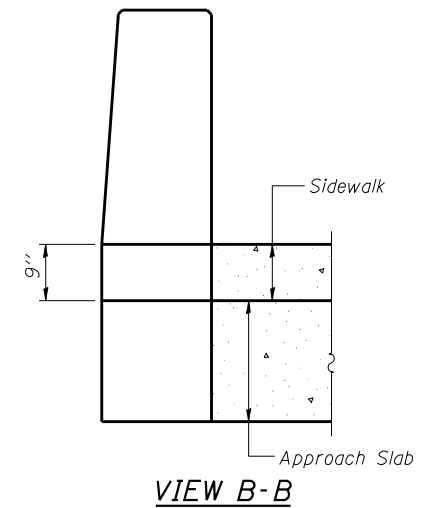
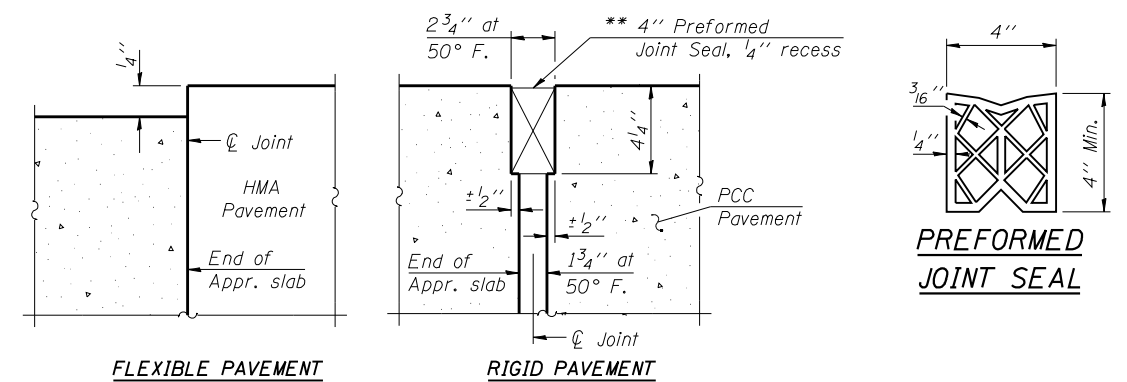

BA-R
1-27-12

Coombe-Bloxdorf P.C.
CIVIL ENGINEERS-
STRUCTURAL ENGINEERS-
LAND SURVEYORS
Design Firm License No. 184-002703

| | | |
|-----------------------------------|-------------------|-----------|
| USER NAME = .MML. | DESIGNED - GJB | REVISED - |
| PLOT SCALE = 0:2.000000 '1' / IN. | CHECKED - RKM | REVISED - |
| PLOT DATE = 8/10/2012 | DRAWN - CFC | REVISED - |
| | CHECKED - RKM/MCB | REVISED - |

STATE OF ILLINOIS
DEPARTMENT OF TRANSPORTATION

BRIDGE EAST APPROACH SLAB DETAILS
STRUCTURE NO. 010-0291

SHEET NO. 14 OF 27 SHEETS

| | | | | |
|--------------------|---------------|-----------|--------------|-----------|
| F.A.I. RTE. | SECTION | COUNTY | TOTAL SHEETS | SHEET NO. |
| 57 | (10-32HB-2)BY | CHAMPAIGN | 81 | 52 |
| CONTRACT NO. 70109 | | | | |

ILLINOIS FED. AID PROJECT

FILE NAME = 71095_014-es-ppr-slab-details.dgn
CB PROJECT NO. 09070-7

(Sheet 2 of 3)