

F.A.I. RTE.	SECTION	COUNTY	TOTAL SHEETS	SHEET NO.
74	MEDIAN CABLE 2012-2	VERMILION	120	1
ILLINOIS			CONTRACT NO. 70967	

D-95-004-12 X 120+1 = 121

FOR INDEX OF SHEETS AND LIST OF HIGHWAY STANDARDS, SEE SHEET NO. 2
FOR SUMMARY OF QUANTITIES, SEE SHEETS NO. 3 AND NO. 4

STATE OF ILLINOIS
DEPARTMENT OF TRANSPORTATION
DIVISION OF HIGHWAYS
PROPOSED HIGHWAY PLANS

FAI ROUTE 74 (I-74)
SECTION MEDIAN CABLE 2012-2
PROJECT ACHSIP-074-6(161)204
HIGHWAY SAFETY IMPROVEMENTS
VERMILION COUNTY
IL 49 NORTH TO 1.3 MILES E. OF OAKWOOD
C-95-004-12

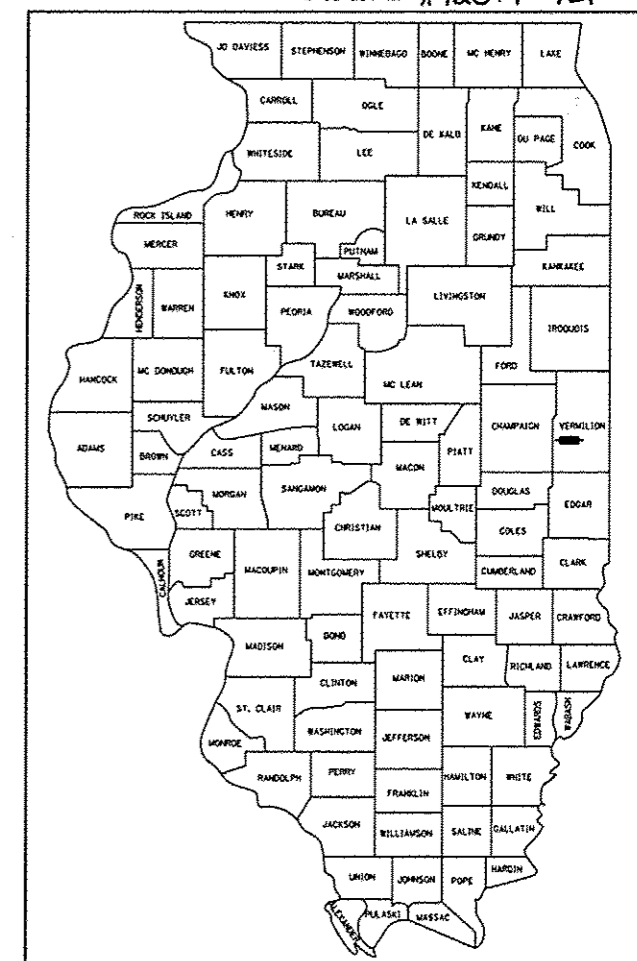

LOCATION OF SECTION INDICATED THUS: - [black box] -

DESIGN DESIGNATION
INTERSTATE

CURRENT TRAFFIC DATA
F.A.I. 74
SPEED LIMIT: 65 MPH

ADT = 24,100 (2009)

STATION EQUATION:
STA. 1224 + 77.59 (BK) =
STA. 1224 + 63.88 (AH)

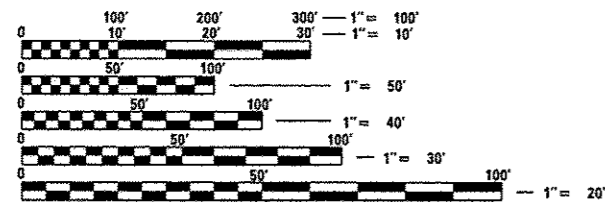

FULL SIZE PLANS HAVE BEEN PREPARED USING STANDARD ENGINEERING SCALES. REDUCED SIZED PLANS WILL NOT CONFORM TO STANDARD SCALES. IN MAKING MEASUREMENTS ON REDUCED PLANS, THE ABOVE SCALES MAY BE USED.

J.U.L.I.E.
JOINT UTILITY LOCATION INFORMATION FOR EXCAVATION
1-800-892-0123
OR 811
OAKWOOD TOWNSHIP

SURVEY BOOK NUMBER 4906

PROJECT ENGINEER: JASON STULTS
CONSULTANT LIAISON: RUSTIN KEYS
DISTRICT 5 PHONE NUMBER: (217) 465-4181

CONTRACT NO. 70967

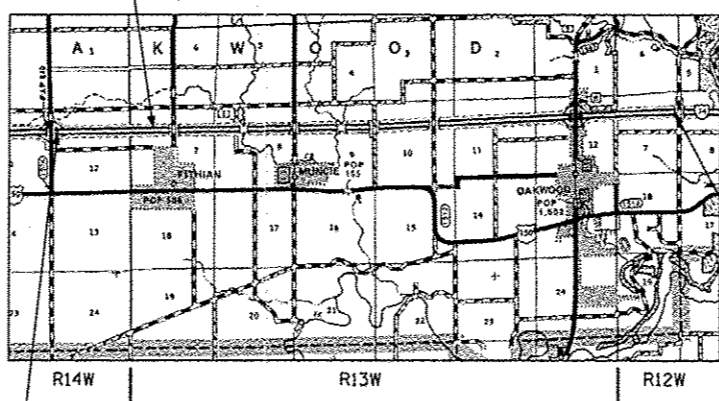

PROJECT BEGINS
STA. 1160 + 55.00

PROJECT ENDS
STA. 1573 + 23.67

LOCATION MAP

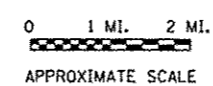

GROSS LENGTH = 41282.38 FT. = 7.818 MILE
NET LENGTH = 41282.38 FT. = 7.818 MILE

STATE OF ILLINOIS
DEPARTMENT OF TRANSPORTATION
DIVISION OF HIGHWAYS
SUBMITTED AUGUST 13 2012
Joseph E. Crowe
DEPUTY DIRECTOR OF HIGHWAYS, REGION ENGINEER
October 5 2012
John D. Baranzelli, P.E. /a
acting ENGINEER OF DESIGN AND ENVIRONMENT
October 5 2012
William R. Frey
acting DIRECTOR OF HIGHWAYS, CHIEF ENGINEER



Signature: [Signature] Date: 3-20-12

11/30/13 Expires

McDonough-Whitlow, P.C.
Consulting Engineers & Land Surveyors
138 East Wood Street
Hillsboro, IL 62049
Phone: 217.532.9233
Fax: 217.532.6300
PROFESSIONAL DESIGN NO. 164-002734

PRINTED BY THE AUTHORITY OF THE STATE OF ILLINOIS