

STA. 1274+97.03
EXISTING MEDIAN INLET BOX
EXISTING 30" PIPE LT (RCCP)
USFL 0' LT. = 647.05
DSFL 69' LT. = 647.16

STA. 1283+73.87
EXISTING MEDIAN INLET BOX
EXISTING 18" PIPE
USFL 9' LT. = 646.90

STA. 1284+94.85
EXISTING CATCH BASIN
EXISTING 18" PIPE (RCCP)
USFL 2' LT. = 645.67

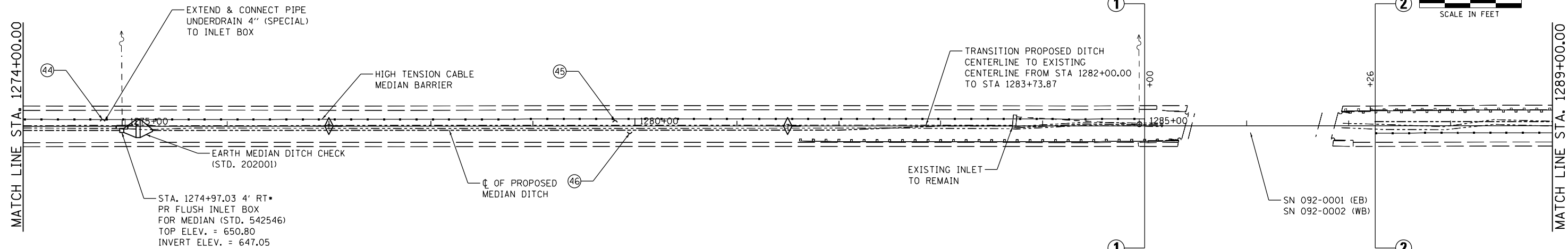

MEDIAN INLET BOX REMOVAL
STATION 1274+97.03 - 1 EACH
(SEE SCHEDULE)

• SAW CUT OR GRIND 0.5" OFF OF 30"
PIPE ENDS TO FIT INTO PR FLUSH
INLET BOX

⊕ INDICATES PIPE UNDERDRAINS, 4" (SPECIAL)
SEE SCHEDULE

McDonough-Whitlow, P.C.
Consulting Engineers & Land Surveyors
138 East Wood Street
Hillsboro, IL 62049
Phone: 217.532.9233
Fax: 217.532.6300
PROFESSIONAL DESIGN No. 184-002754

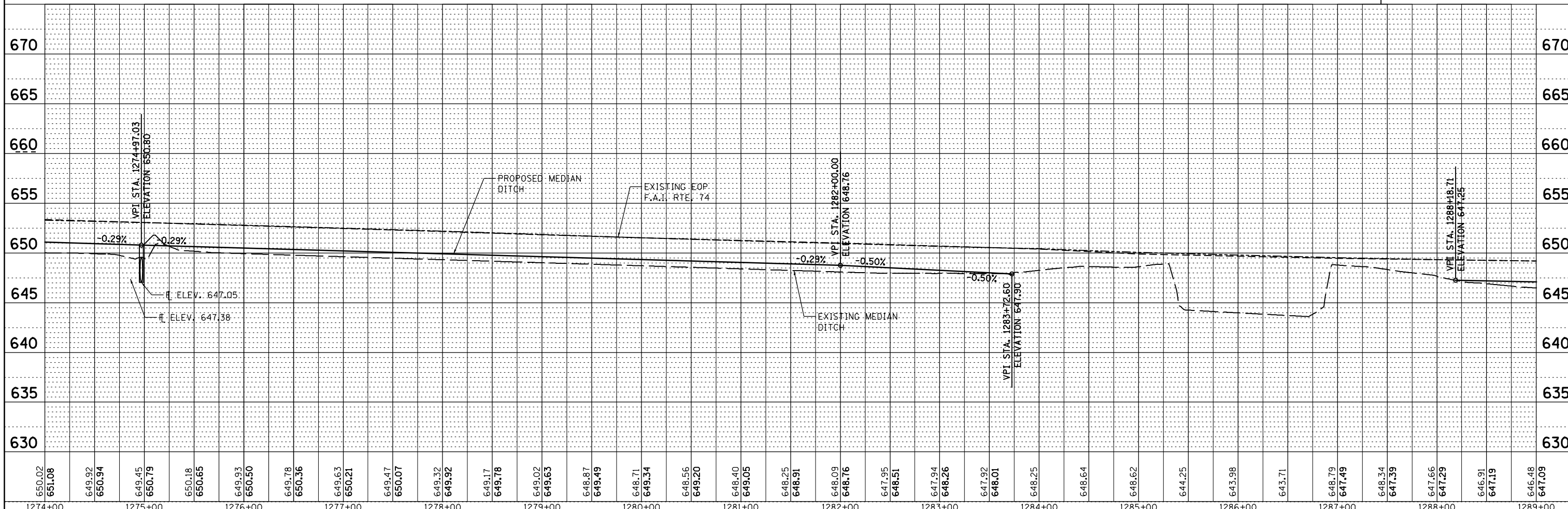

650.02	651.08	649.92	650.94	649.45	650.79	650.18	650.65	649.93	650.50	649.78	650.36	649.63	650.21	649.47	650.07	649.32	649.92	649.17	649.78	649.02	649.63	648.87	649.49	648.71	649.34	648.56	649.20	648.40	649.05	648.25	648.91	648.09	648.76	647.95	648.51	647.94	648.26	647.92	648.01	648.25	648.64	648.62	644.25	643.98	643.71	648.79	647.49	648.34	647.39	647.66	647.29	646.91	647.19	646.48	647.09
1274+00	1275+00	1276+00	1277+00	1278+00	1279+00	1280+00	1281+00	1282+00	1283+00	1284+00	1285+00	1286+00	1287+00	1288+00	1289+00																																								

DATE	
BY	
PLAN	
NO.	
NO.	
NO.	
NO.	
NO.	

DATE	
BY	
PROFILE	
NO.	
NO.	
NO.	
NO.	
NO.	

STATE OF ILLINOIS
DEPARTMENT OF TRANSPORTATION

PLAN & PROFILE
F.A.I. 74

SCALE: 1"=50' SHEET NO. 9 OF 28 SHEETS STA. 1274+00.00 TO STA. 1289+00.00

F.A.I. RTE.	SECTION	COUNTY	TOTAL SHEETS	SHEET NO.
74	MEDIAN CABLE 2012-2	VERMILION	120	21
CONTRACT NO. 70967			ILLINOIS FED. AID PROJECT	