

PLAN	SURVEYED	DATE
NOTE BOOK	BY	
NO.		
	CHECKED	
	FILE NAME	

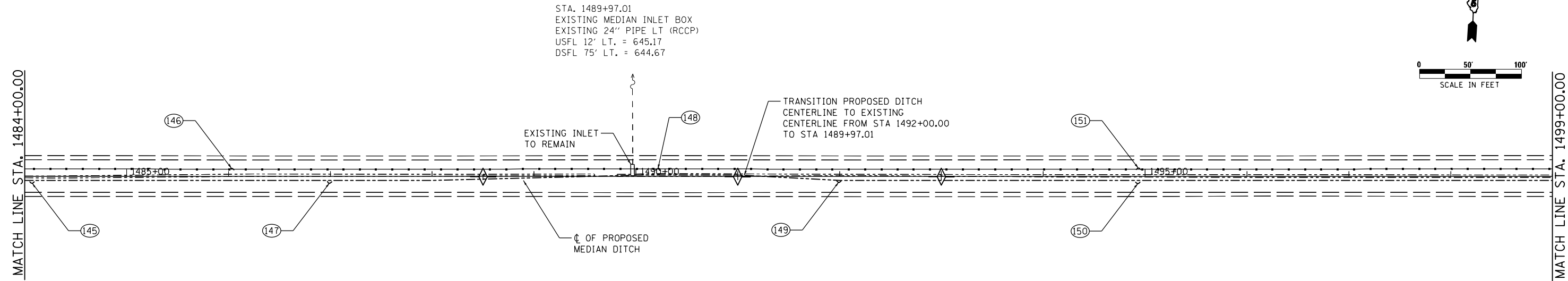

PROFILE	SURVEYED	DATE
NOTE BOOK	BY	
NO.		
	CHECKED	
	NOTATIONS	

McDonough-Whitlow, P.C.
 Consulting Engineers & Land Surveyors
 138 East Wood Street
 Hillsboro, IL 62049
 Phone: 217.532.9233
 Fax: 217.532.6300
 PROFESSIONAL DESIGN No. 184-002754

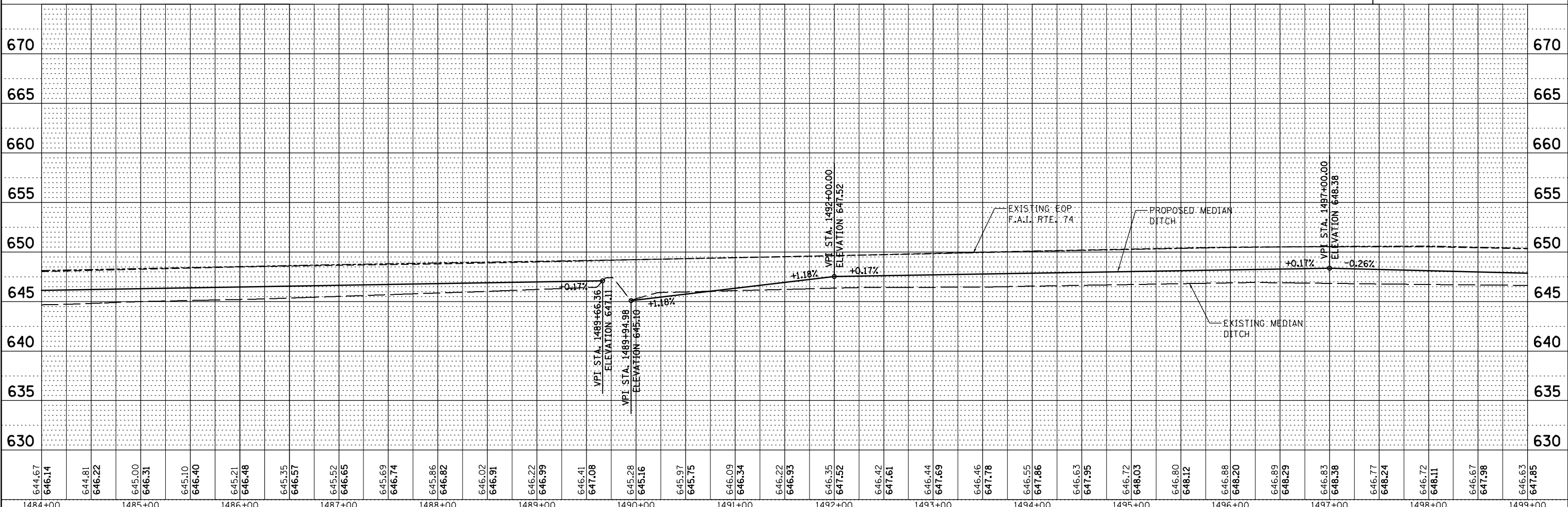

FILE NAME =	USER NAME = RNH	DESIGNED - JAH	REVISED -	STATE OF ILLINOIS DEPARTMENT OF TRANSPORTATION	PLAN & PROFILE F.A.I. 74		F.A.I. RTE. 74	SECTION	COUNTY	TOTAL SHEETS	SHEET NO.
D570967-XXX-PLNPRF23.dgn		DRAWN - RNH	REVISED -		74	MEDIAN CABLE 2012-2	VERMILION	120	35	CONTRACT NO. 70967	
PLOT SCALE = 50'		CHECKED - TMM	REVISED -		SCALE: 1"=50'	SHEET NO. 23 OF 28 SHEETS	STA. 1484+00.00 TO STA. 1499+00.00	ILLINOIS FED. AID PROJECT			
PLOT DATE =		DATE -	REVISED -								