

ORIGINAL SURVEY	SURVEYED	BY	DATE
NOTE BOOK	PLOTTED		
	TEMPLATE		
	AREAS		
	AREAS CHECKED		

FINAL SURVEY	SURVEYED	BY	DATE
NOTE BOOK	PLOTTED		
	TEMPLATE		
	AREAS		
	AREAS CHECKED		

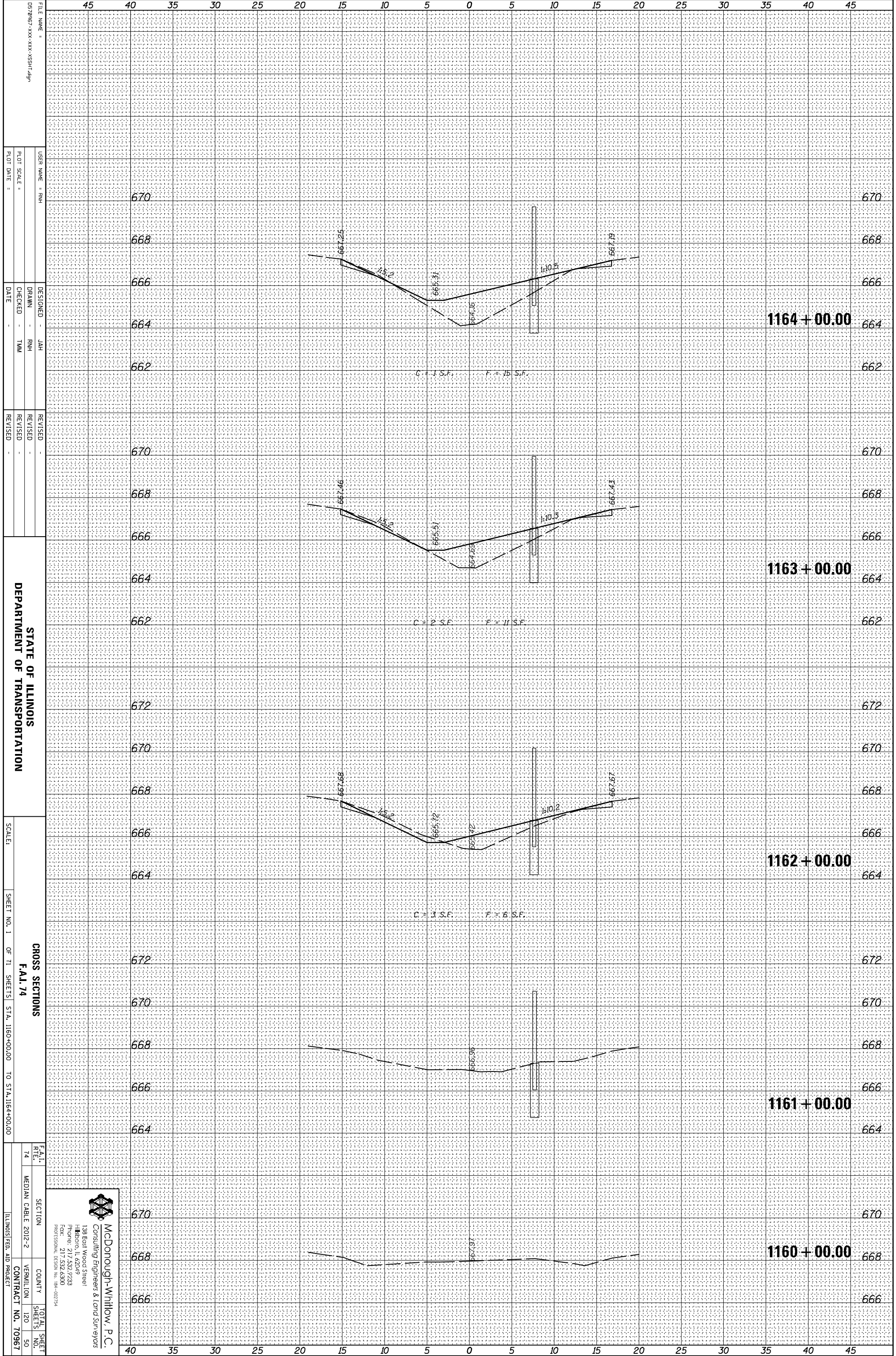

FILE NAME =	0570967-XXX-XXX-XXX-SSHT-09
USER NAME =	RNH
DESIGNED =	JAH
DRAWN =	RNH
CHECKED =	TMM
DATE =	
REVISOR =	
REVISION =	
REVISION =	
REVISION =	

STATE OF ILLINOIS
DEPARTMENT OF TRANSPORTATION

SCALE:	
SHEET NO. 1	OF 71 SHEETS
STA. 1160+00.00	TO STA. 1164+00.00

F.A.I. SECTION	74	MEDIAN CABLE 2012-2	COUNTY	VERMILION	TOTAL SHEET NO.	50
CONTRACT NO. 70967			ILLINOIS FED. AID PROJECT			

McDonough-Whitlow, P.C.
Consulting Engineers & Land Surveyors
138 East Wood Street
Hickory, IL 62549
Phone: 217.532.7233
Fax: 217.532.6300
PROFESSIONAL DESIGN NO. 194-002734