

FINAL SURVEY NO.	SURVEYED PLOTTED AREAS CHECKED	BY	DATE
NOTE BOOK NO.	TEMPLATE AREAS CHECKED		

ORIGINAL SURVEY NO.	SURVEYED PLOTTED AREAS CHECKED	BY	DATE
NOTE BOOK NO.	TEMPLATE AREAS CHECKED		

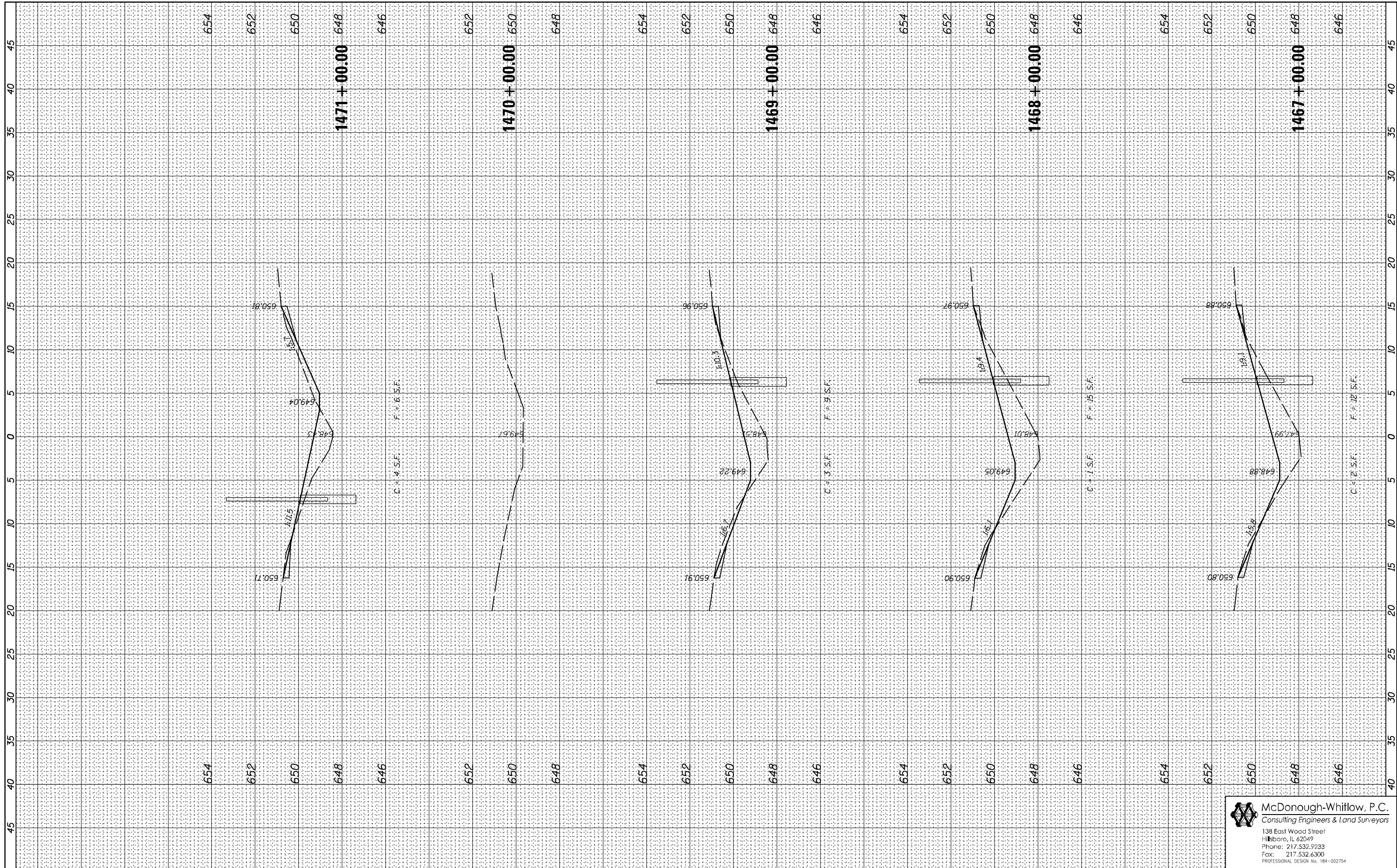

FILE NAME = D570967-XXX-XXX-XSHT.dgn

USER NAME = RNH
 DESIGNED - JAH
 DRAWN - RNH
 CHECKED - TMM
 DATE -

REVISED -
 REVISED -
 REVISED -
 REVISED -

**STATE OF ILLINOIS
 DEPARTMENT OF TRANSPORTATION**

**CROSS SECTIONS
 F.A.I. 74**

SCALE: SHEET NO. 63 OF 71 SHEETS STA. 1467+00.00 TO STA. 1471+00.00

F.A.I. RTE.	SECTION	COUNTY	TOTAL SHEETS	SHEET NO.
74	MEDIAN CABLE 2012-2	VERMILION	120	112
			CONTRACT NO. 70967	
ILLINOIS FED. AID PROJECT				

McDonough-Whitlow, P.C.
 Consulting Engineers & Land Surveyors
 138 East Wood Street
 Hillsboro, IL 62049
 Phone: 217.532.9233
 Fax: 217.532.6300
 PROFESSIONAL DESIGN NO. 184-002754