

| | | | |
|------------------|--------------------------------|----|------|
| FINAL SURVEY NO. | SURVEYED PLOTTED AREAS CHECKED | BY | DATE |
| | | | |
| | | | |
| | | | |

| | | | |
|---------------------|--------------------------------|----|------|
| ORIGINAL SURVEY NO. | SURVEYED PLOTTED AREAS CHECKED | BY | DATE |
| | | | |
| | | | |
| | | | |

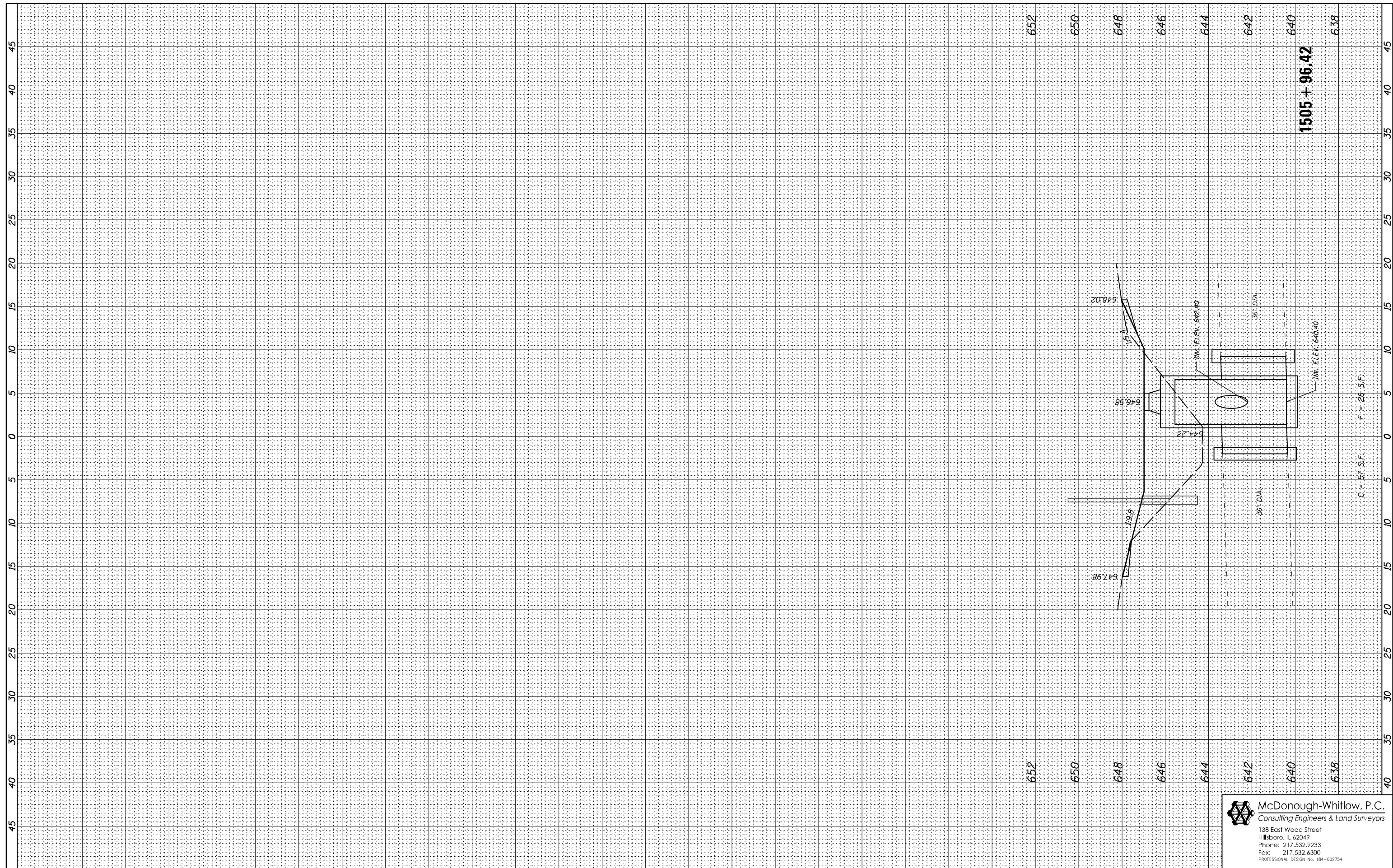

FILE NAME = D570967-XXX-XXX-XSSH.dgn

USER NAME = RNH
 DESIGNED - JAH
 DRAWN - RNH
 CHECKED - TMM
 DATE -

REVISED -
 REVISED -
 REVISED -
 REVISED -

**STATE OF ILLINOIS
 DEPARTMENT OF TRANSPORTATION**

**CROSS SECTIONS
 F.A.I. 74**

SCALE: SHEET NO. 71 OF 71 SHEETS STA. 1505+96.42 TO STA. 1505+96.42

| F.A.I. RTE. | SECTION | COUNTY | TOTAL SHEETS | SHEET NO. |
|--------------------|---------------------|-----------|---------------------------|-----------|
| 74 | MEDIAN CABLE 2012-2 | VERMILION | 120 | 120 |
| CONTRACT NO. 70967 | | | ILLINOIS FED. AID PROJECT | |

McDonough-Whitlow, P.C.
 Consulting Engineers & Land Surveyors
 138 East Wood Street
 Hillsboro, IL 62049
 Phone: 217.532.9233
 Fax: 217.532.6300
 PROFESSIONAL DESIGN NO. 184-002754