

**JANE ADDAMS  
MEMORIAL TOLLWAY  
I-90**

**IL RTE 58 (GOLF ROAD)**

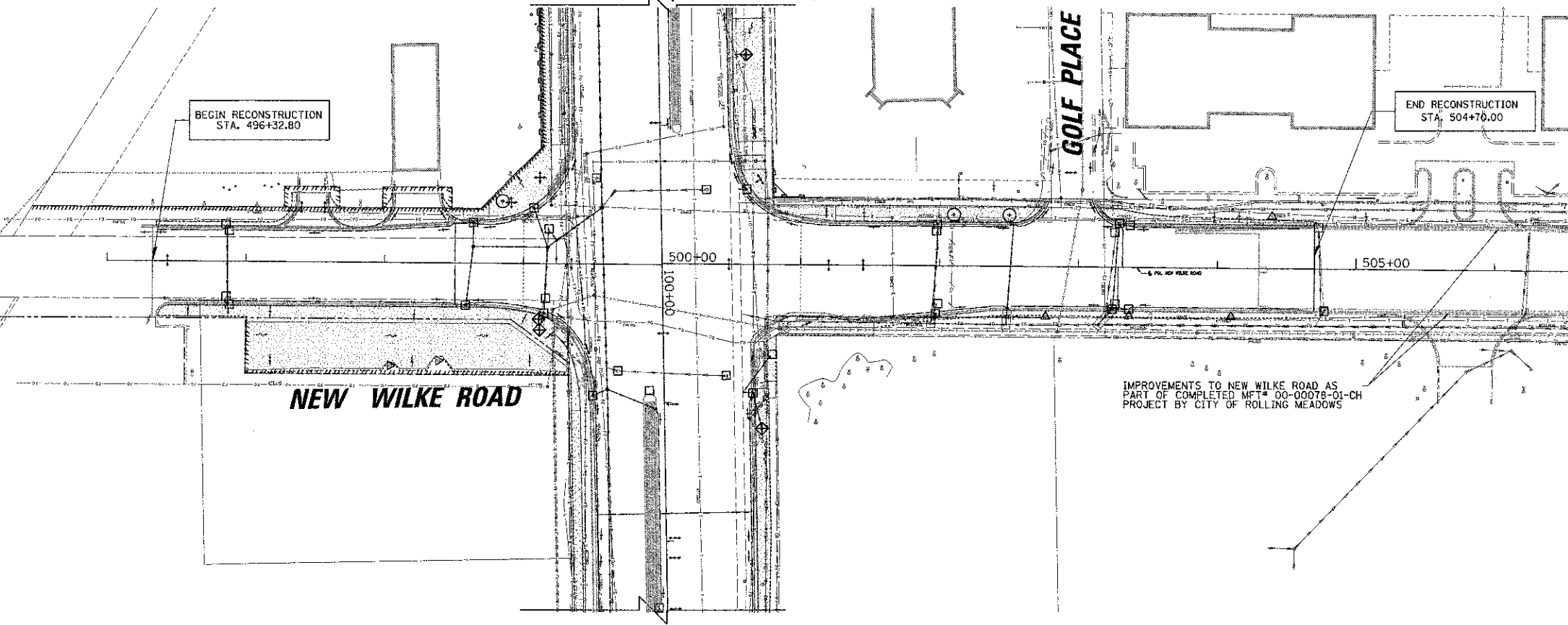

- LEGEND**
- INLET FILTER
  - ⊕ PARKWAY INLET PROTECTION (SEE DETAIL SHEET 89)
  - LIMITS OF CONSTRUCTION
  - ▨ EROSION CONTROL BLANKET SEEDING CLASS 2A FERTILIZER NUTRIENTS TOPSOIL FURNISH AND PLACE 4"
  - ▩ EROSION CONTROL BLANKET SEEDING, CLASS 2A FERTILIZER NUTRIENTS TOPSOIL FURNISH AND PLACE, 24"
  - PERIMETER EROSION BARRIER
  - PR TREE
  - △ TEMPORARY FENCE (SEE DETAIL, SHEET 89)
  - EX SUMMIT --- PR SUMMIT
  - EX SWALE --- PR SWALE
  - EX FLOW --- PR FLOW

**NOTE:**  
 1. SEE SHEET 89 FOR TREE PLANTING DETAILS.  
 2. SEE SHEETS 89 FOR TREE SPECIES AND LOCATION.  
 3. SEE SHEET 60 FOR EROSION CONTROL GENERAL NOTES.

IMPROVEMENTS TO NEW WILKE ROAD AS PART OF COMPLETED MFT# 00-00078-01-CH PROJECT BY CITY OF ROLLING MEADOWS

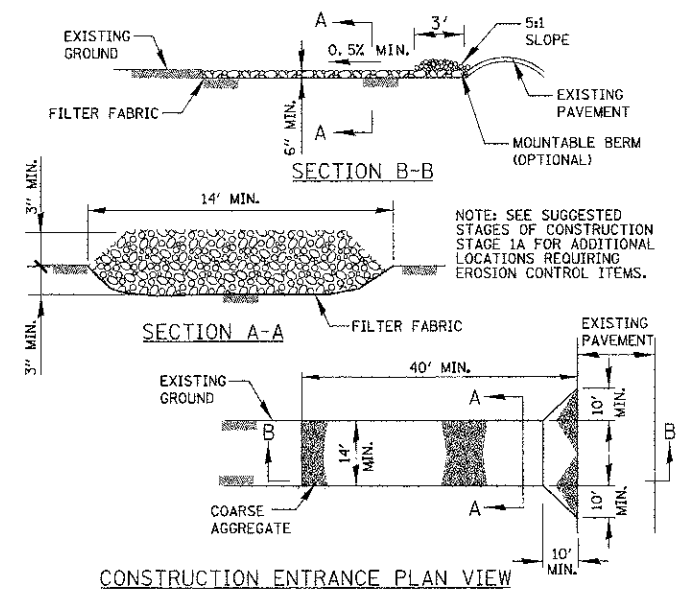

**NOTE:** SEE SUGGESTED STAGES OF CONSTRUCTION STAGE 1A FOR ADDITIONAL LOCATIONS REQUIRING EROSION CONTROL ITEMS.

**STABILIZED CONSTRUCTION ENTRANCE**  
N.T.S.

FILE NAME =	USER NAME = mgoldenorg	DESIGNED - BLL	REVISED - 10-22-12	<b>STATE OF ILLINOIS DEPARTMENT OF TRANSPORTATION</b>	<b>IL RTE 58 (GOLF ROAD) AND NEW WILKE ROAD IMPROVEMENTS LANDSCAPING AND EROSION CONTROL PLANS NEW WILKE ROAD</b>	F.A.P. RTE. 0559	SECTION 00-00078-00-CH	COUNTY COOK	TOTAL SHEETS 116	SHEET NO. 61
DRAWN - PMM	CHECKED - JGS	DATE - 8/06/12	REVISED - 10/16/12 ELIM. PR ROW AT NE CORNER GOLF / NEW WILKE. IMPROVEMENTS REVISED TO FIT WITHIN EX ROW.			SCALE: 50'	SHEET NO. 3 OF 3 SHEETS	STA. 496+36.30 TO STA. 515+25	FED. ROAD DIST. NO.	ILLINOIS FED. AID PROJECT