

ALIGNMENT POINTS				
STATION	OFFSET	NORTHING (Y)	EASTING (X)	DESCRIPTION
106+05.76	C	1,961,545.13	1,074,614.34	PT
106+37.87	C	1,961,544.27	1,074,646.45	PC
109+57.14	C	1,961,544.65	1,074,965.67	PT
125+26.87	C	1,961,590.15	1,076,534.75	POT

CONTROL POINTS				
STATION	OFFSET	NORTHING (Y)	EASTING (X)	DESCRIPTION
2				CP-IP
1322	113+37.44	123.45 RT	1,961,432.27	CP
12031	118+62.85	78.19 RT	1,961,492.75	CP-IP

PGL POINTS - LEFT					
STATION	OFFSET	NORTHING (Y)	EASTING (X)	DESCRIPTION	
L5	106+06.67	C	1,961,558.28	1,074,908.26	PT
L6	106+38.79	C	1,961,559.27	1,074,646.85	PC
L7	109+00.23	C	1,961,558.28	1,074,908.26	PT
L8	112+00.16	C	1,961,560.12	1,075,208.18	POT
L9	112+30.66	C	1,961,560.80	1,075,238.68	POT
L10	113+74.24	C	1,961,571.65	1,075,382.20	POT
L11	115+99.95	C	1,961,554.59	1,075,607.81	POT
L12	117+24.57	C	1,961,574.53	1,075,732.39	POT
L13	118+00.16	C	1,961,576.92	1,075,807.95	POT

PGL POINTS - RIGHT					
STATION	OFFSET	NORTHING (Y)	EASTING (X)	DESCRIPTION	
R7	109+96.41	C	1,961,537.78	1,075,005.33	POT
R8	112+30.32	C	1,961,544.56	1,075,239.15	POT
R9	113+73.92	C	1,961,549.01	1,075,382.67	POT
R10	113+99.83	C	1,961,549.76	1,075,408.57	POT
R11	115+99.63	C	1,961,555.29	1,075,608.30	POT
R12	117+99.83	C	1,961,561.01	1,075,808.41	POT

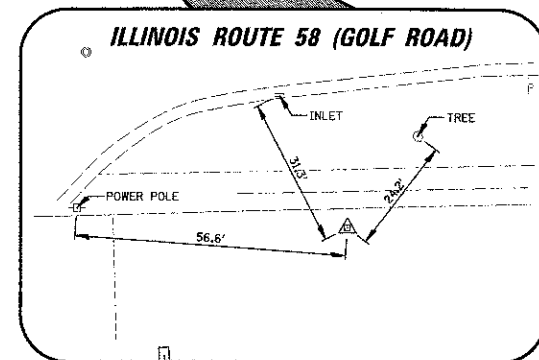
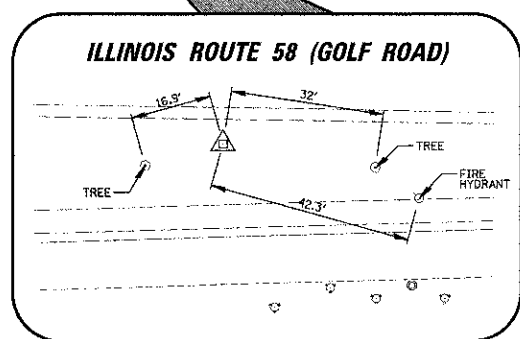
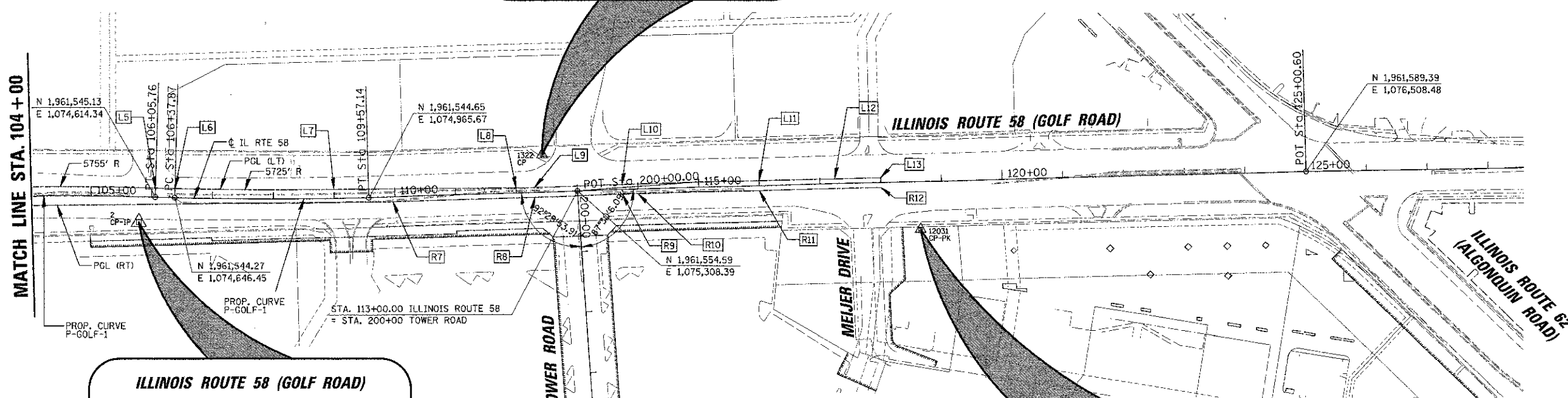
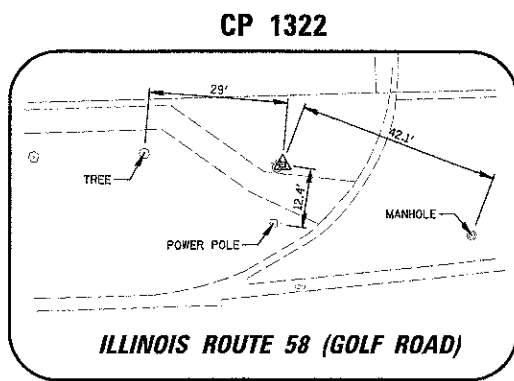

PROP. CURVE P-GOLF-1  
 PI STA. = 104+47.09  
 $\Delta = 3^\circ 10' 06''$  (RT)  
 D = 0° 59' 53"  
 R = 5,740.00'  
 T = 158.75'  
 L = 317.42'  
 E = 2.19'  
 P.C. STA = 102+88.34  
 P.T. STA = 106+05.76

PROP. CURVE P-GOLF-2  
 PI STA. = 107+97.55  
 $\Delta = 3^\circ 11' 13''$  (LT)  
 D = 0° 59' 53"  
 R = 5,740.00'  
 T = 159.67'  
 L = 319.27'  
 E = 2.22'  
 P.C. STA = 106+37.87  
 P.T. STA = 109+57.14