

DATE	
BY	
DESIGNED	
CHECKED	
ALIGNED	
PLANNED	
NOTE BOOK	
NO.	

DATE	
BY	
DESIGNED	
CHECKED	
ALIGNED	
PLANNED	
NOTE BOOK	
NO.	

MATCHLINE STA. 1711+50.00

MATCHLINE STA. 1716+70.23

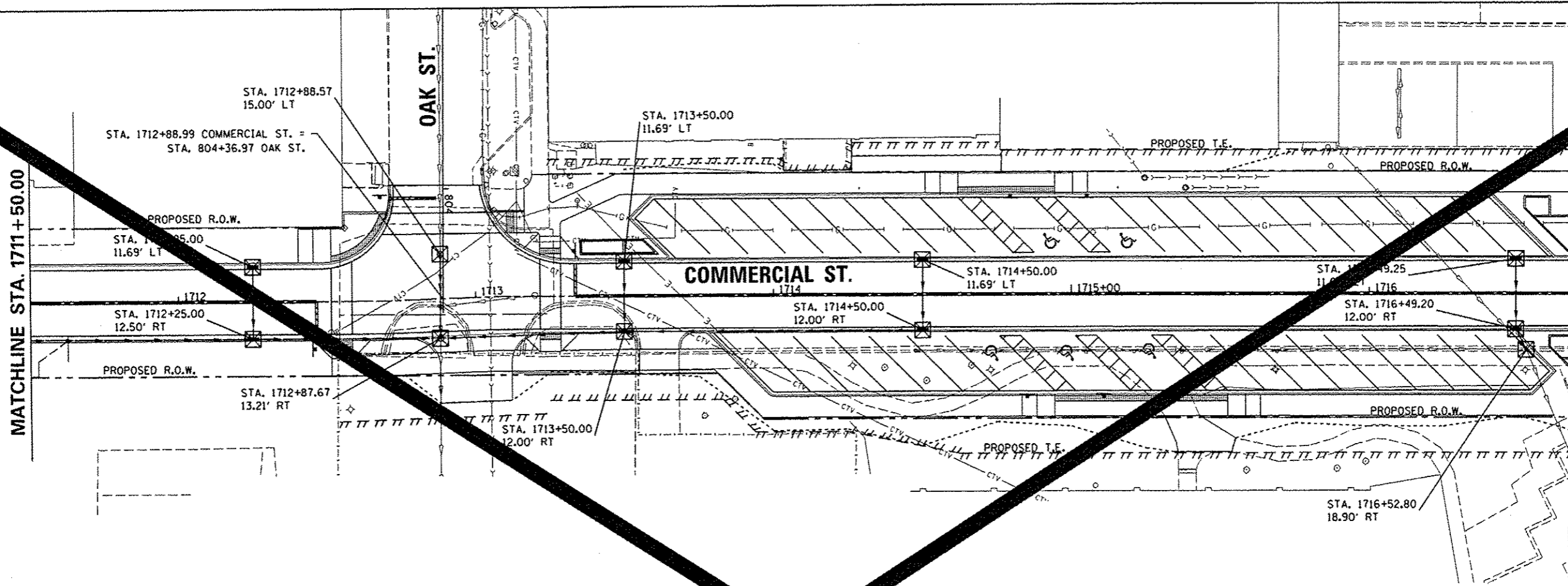

SEE STATE STREET EROSION CONTROL PLAN

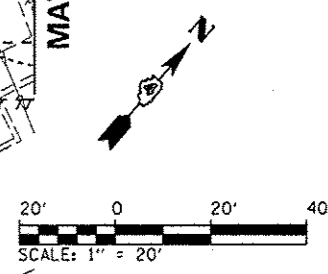

LEGEND

INLET FILTERS X

- NOTES:**
1. INLET FILTERS SHALL BE PROVIDED AT ALL EXISTING STORM SEWER STRUCTURE LOCATIONS.
 2. SEE STORM WATER POLLUTION PREVENTION PLAN AND PROVISIONS OF THE NPDES PERMIT ILR10 FOR DUST CONTROL CLEANING OF PAVEMENT REQUIREMENTS.



1711+50	1712+00	1712+50	1713+00	1713+50	1714+00	1714+50	1715+00	1715+50	1716+00	1716+50																																									
466.21	465.57	465.04	465.46	465.93	465.35	465.84	465.24	465.72	465.13	465.46	465.02	464.77	464.90	464.57	464.72	464.09	464.55	464.38	464.44	464.47	464.41	464.38	464.44	464.42	464.53	464.55	464.63	464.71	464.73	464.72	464.83	464.86	464.93	464.80	465.03	464.62	465.11	464.70	465.15	464.73	465.15	464.62	465.11	464.63	465.03	464.71	464.95	464.78	464.88	464.79	464.88

USER NAME : kovan01511	DESIGNED - LNF	REVISOR -
FILE NAME : \\s:\work\da\proj\del\del\75322\041080155-shr-eros-304.dgn	DRAWN - LNF	REVISOR -
PLOT SCALE : 39.9999 / 1	CHECKED - MCH	REVISOR -
PLOT DATE : 07/23/2012	DATE - 7/18/12	REVISOR -

STATE OF ILLINOIS
DEPARTMENT OF TRANSPORTATION

COMMERCIAL STREET
EROSION CONTROL PLAN

F.A.U. RTE.	SECTION	COS	TOTAL SHEETS	SHEET NO.
12-00356-01-PV	PEORIA	207		
CONTRACT NO. 12-00356-01-PV			26	
ILLINOIS FED. AID PROJECT			TIG-50931	

SCALE: 1"=20' SHEET NO. OF SHEETS STA. 1711+50 TO STA. 1716+70.23