

| BENCHMARK | ELEVATION | DESCRIPTION   |
|-----------|-----------|---|
| BM "J"    | 475.94'   | NORTH CAP BOLT IN S.E. QUAD OF INTERSECTION OF STATE AND WASHINGTON.                                    |
| BM "K"    | 463.50'   | N.E. BOLT ON R.R. CROSSING ON WEST SIDE OF STATE AND WATER.   |
| BM "Q"    | 460.02'   | WEST CAP BOLT (BETWEEN MEULLER) AT SOUTH ENTRANCE OF POST OFFICE.                                       |
| BM "R"    | 466.43'   | CUT SQUARE IN THE S.W. CORNER OF ELEC. JUNCTION BOX AT N.E. QUAD OF INTERSECTION OF OAK AND COMMERCIAL. |

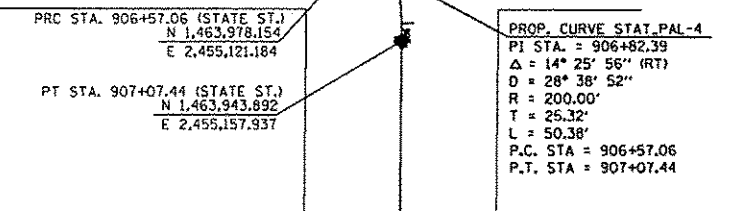
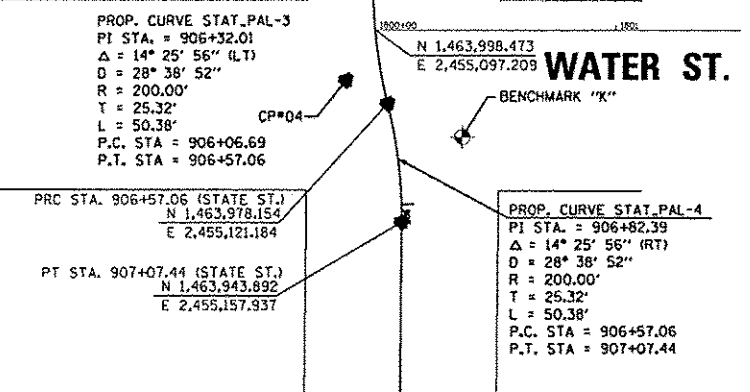
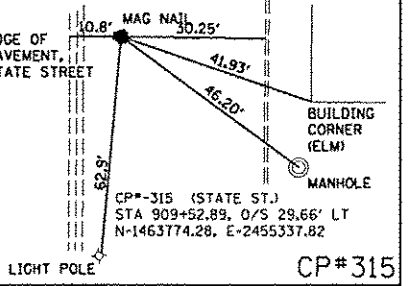
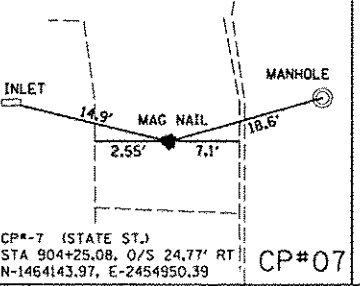

**MILLENNIA PROFESSIONAL SERVICES**  
 450 North Main Street, Merton, IL 61550  
 309.321.8141 voice, 309.321.8143 fax  
 www.mps-ll.com

| FILE NAME                              | USER NAME            | DESIGNED | DRAWN | CHECKED | DATE    |
|--|----------------------|----------|-------|---------|---------|
| atb03e-work\do-not-delete\des\90379\04 | manak81398           | DE       | DE    | TVN     | 7/18/12 |
|  | ALBISS-ehc-ATB03.dgn | DE       | DJE   | DASH    |         |
|  |                      | TVN      | DASH  |         |         |
|  |                      | DATE     |       |         |         |

**STATE OF ILLINOIS  
 DEPARTMENT OF TRANSPORTATION**

| SCALE  | SHEET NO. | OF | SHEETS | STA. | TO | STA. |
|--------|-----------|----|--------|------|----|------|
| 1"=40' |           |    |        |      |    |      |

**TIGER II - WAREHOUSE DISTRICT  
 ALIGNMENT, BENCHMARKS AND TIES**

| F.A.U. RTE.    | SECTION | COUNTY | TOTAL SHEETS | SHEET NO. | CONTRACT NO. |
|----------------|---------|--------|--------------|-----------|--------------|
| 12-00356-01-PV | PEORIA  | 519    | 42           | NO.89626  |              |

ATB03