

PLAN	DATE
BY	
CHECKED	
DATE	
NOTE BOOK	
NO.	

PROFILE	DATE
BY	
CHECKED	
DATE	
NOTE BOOK	
NO.	

RADIUS POINTS			
STATION	OFFSET	ELEV.	
①	598+34.93	11.0' RT	498.32
②	598+55.85	19.5' RT	496.82
③	598+95.80	19.5' RT	494.54
④	599+16.77	11.0' RT	493.78
⑤	599+59.71	11.0' RT	491.65
⑥	599+74.71	26.0' RT	490.88
⑦	598+25.55	11.0' LT	498.98
⑧	599+46.48	19.5' LT	497.53
⑨	599+09.48	19.5' LT	494.01
⑩	595+30.40	11.0' LT	493.16
⑪	595+49.25	11.0' LT	492.10
⑫	599+64.25	26.1' LT	491.00

SEE ADAMS STREET
PLAN SHEET

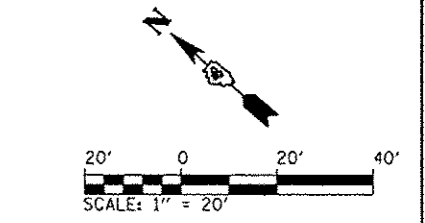
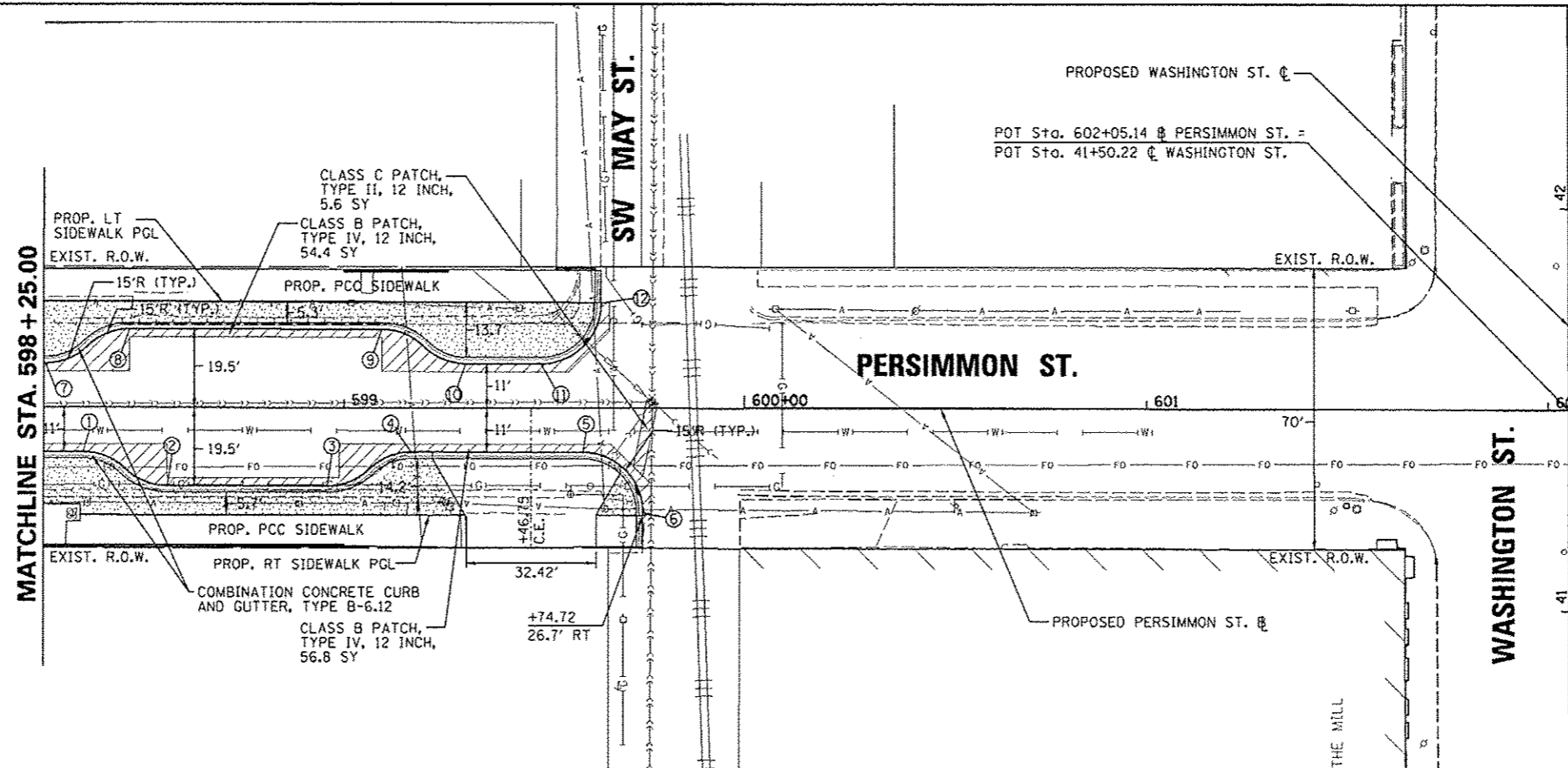

SEE STREETSCAPE PLANS FOR PROPOSED
IMPROVEMENTS BEHIND CURB LINES

CMT
CRAWFORD, MURPHY & TILLY, INC.
CONSULTING ENGINEERS
License No. 184-000613

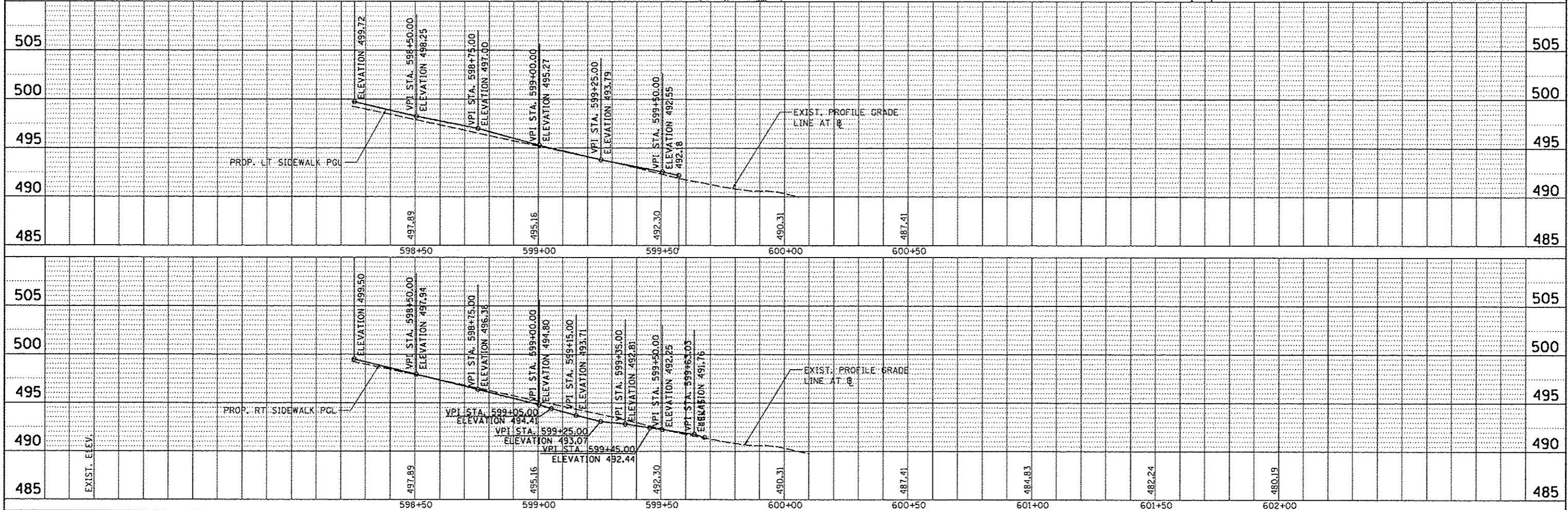

FILE NAME	USER NAME	DESIGNED	REVISED	STATE OF ILLINOIS DEPARTMENT OF TRANSPORTATION	PERSIMMON STREET PLAN AND PROFILE	F.A. RTE. NO.	SECTION	COUNTY	TOTAL SHEETS	SHEET NO.
al\p\work\do_no_del\sta\cma73328\0410	mansk11398	- RMM/EMM	-							
0105-ehz-gmp-802.dgn		- RJE	-							
PLOT SCALE = 3/4" = 1' @ 11"		- EJM	-							
PLOT DATE = 07/23/2012		- 7/18/12	-	SCALE: 1" = 20'	SHEET OF SHEETS	STA. 598+25.00 TO STA. 599+74.71	12-00356-01-PV	PEORIA	519	75
							CONTRACT NO. 89626		ILLINOIS FED. AID PROJECT TIG-5093(158)	