

SEE SIDEWALK RAMP
DETAILS FOR GRADING
BEHIND THE CURB

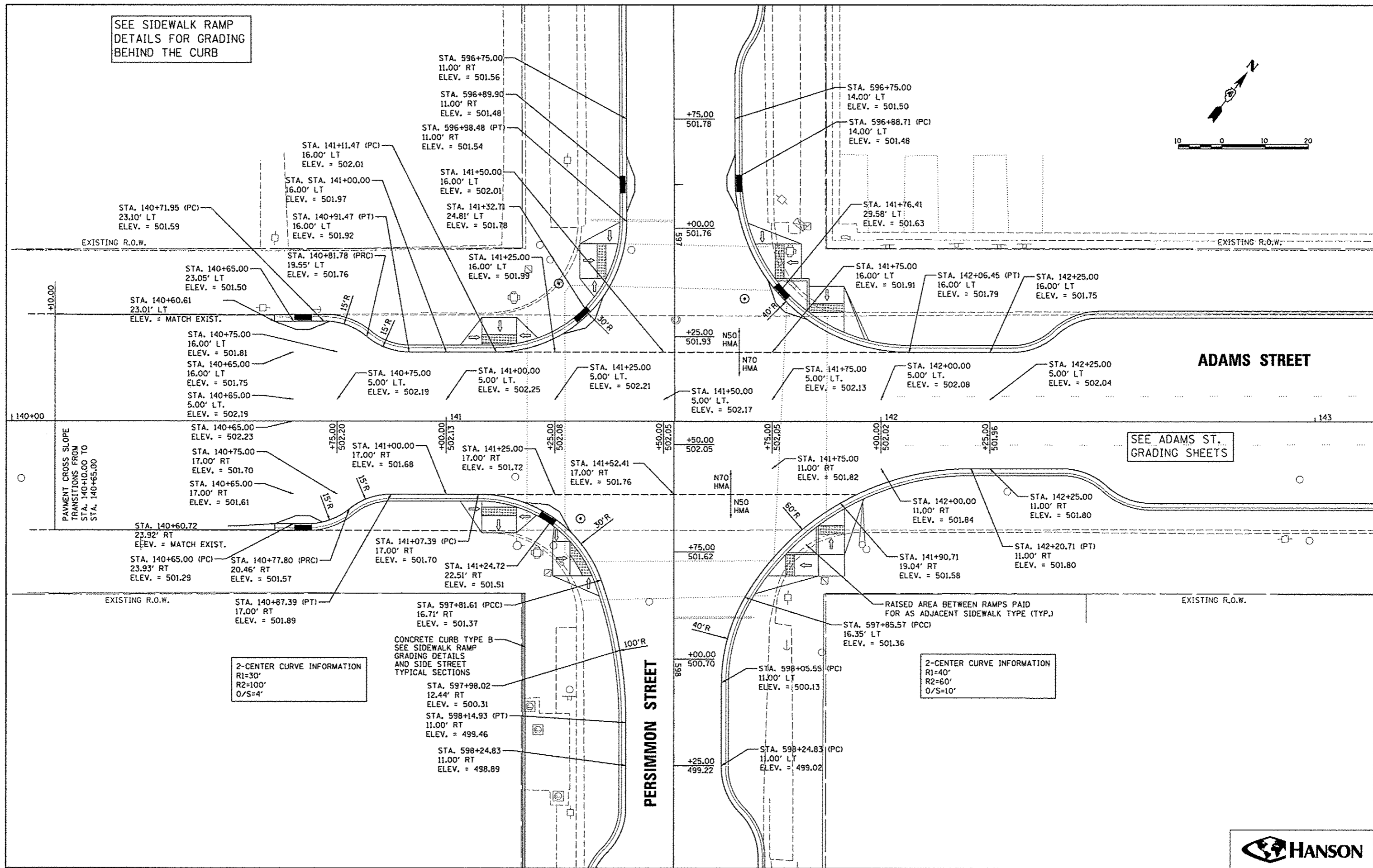
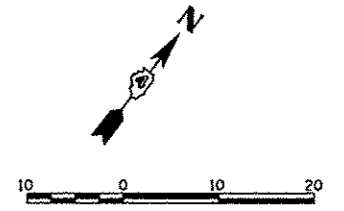

SEE ADAMS ST.
GRADING SHEETS

2-CENTER CURVE INFORMATION
R1=30'
R2=100'
O/S=4'

2-CENTER CURVE INFORMATION
R1=40'
R2=60'
O/S=10'

CONCRETE CURB TYPE B
SEE SIDEWALK RAMP
GRADING DETAILS
AND SIDE STREET
TYPICAL SECTIONS

RAISED AREA BETWEEN RAMPS PAID
FOR AS ADJACENT SIDEWALK TYPE (TYP.)

STATE OF ILLINOIS
DEPARTMENT OF TRANSPORTATION

ADAMS STREET AND PERSIMMON STREET
INTERSECTION DETAIL



FILE NAME =	USER NAME = mank01398	DESIGNED - MPB	REVISED -
o:\pwise\work\do_no_delete\dm73388\ND4	o:\pwise\work\do_no_delete\dm73388\ND4	DRAWN - RLA	REVISED -
PLOT SCALE = 20.0000 / 1 in.		CHECKED - KNB	REVISED -
PLOT DATE = 07/23/2012		DATE - 7/18/12	REVISED -

SCALE: 1"=10'	SHEET NO. OF SHEETS	STA. TO STA.
---------------	---------------------	--------------

F.A.U. RTE.	SECTION	COUNTY	TOTAL SHEETS	SHEET NO.
	12-00356-01-PV	PEORIA	519	108
CONTRACT NO. 89626				
ILLINOIS FED. AID PROJECT T10-50931(50)				