

DATE	
BY	
REVISIONS	
PLANNED	
ALIGNED	
CHECKED	
NO. OF SHEETS	
NO. OF SHEETS	
NO. OF SHEETS	
NO. OF SHEETS	

DATE	
BY	
REVISIONS	
PLANNED	
ALIGNED	
CHECKED	
NO. OF SHEETS	
NO. OF SHEETS	
NO. OF SHEETS	
NO. OF SHEETS	

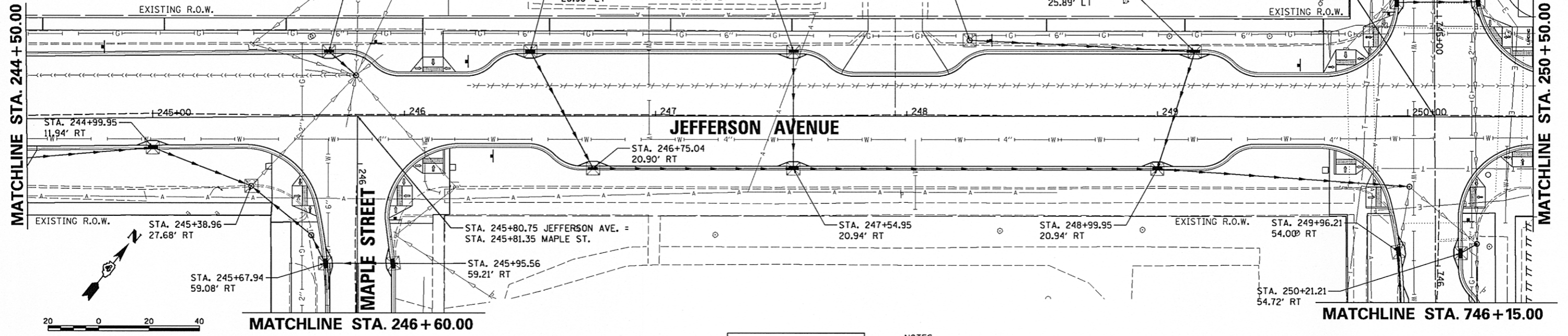

SEE MAPLE STREET
EROSION CONTROL PLAN

LEGEND
INLET FILTERS X

- NOTES:**
1. INLET FILTERS SHALL BE PROVIDED AT ALL EXISTING STORM SEWER STRUCTURE LOCATIONS.
 2. SEE STORM WATER POLLUTION PREVENTION PLAN AND PROVISIONS OF THE NPDES PERMIT ILR10 FOR DUST CONTROL CLEANING OF PAVEMENT REQUIREMENTS.

SEE ELM STREET
EROSION CONTROL PLAN

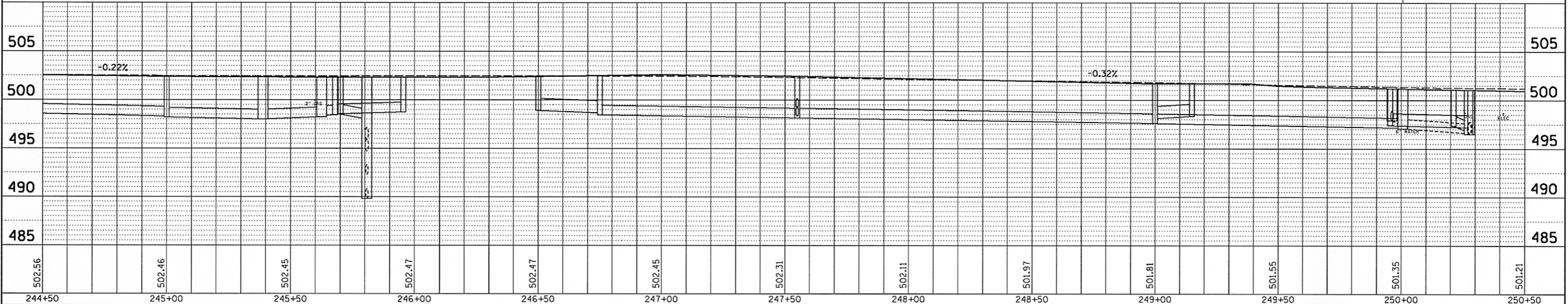

FILE NAME =	USER NAME = kovan01511	DESIGNED - VLK	REVISED -	STATE OF ILLINOIS DEPARTMENT OF TRANSPORTATION	JEFFERSON AVENUE EROSION CONTROL PLAN			F.A.U. RTE. 12	SECTION 12-00356-01-PV	COUNTY PEORIA	TOTAL SHEETS 519	SHEET NO. 196
c:\pwise_work\do_not_delete\dms73308\0418\0155-shc-eros007.dgn	PLOT SCALE = 39.9999' / 1" / 1"	DRAWN - RLA	REVISED -		SCALE: N/A	SHEET NO. OF SHEETS	STA. 244+50 TO STA. 250+50	CONTRACT NO. 89626				
	PLOT DATE = 07/23/2012	CHECKED - KNB	REVISED -		ILLINOIS FED. AID PROJECT TIG-50931(58)							
		DATE - 7/18/12	REVISED -									