

- 851 STA. 904+15.09, 14.7' RT.
INLET TY G-1
RIM = 466.12
INV (SW) = 459.81 (EX.)
INV (NE) = 459.70 (EX.)
- 852 STA. 904+00.76, 27.1' LT.
INLET TY G-1
RIM = 466.42
INV (S) = 463.02
INV (N) = 463.82
- 307 STA. 904+07.37, 11.5' LT.
EX. MH, 6' DIA., T-1 F. CL
RIM = 466.23
INV (N) = 462.75
INV (SW) = 458.58 (EX.)
INV (NW) = 454.88 (EX.)
INV (SE) = 453.58 (EX.)
- 853 STA. 905+38.17, 37.6' LT.
INLET TY G-1
RIM = 462.92
INV (SE) = 460.03
INV (N) = 460.42
- 854 STA. 905+67.29, 19.5' RT.
INLET TY G-1
RIM = 463.15
INV (W) = 457.02 (EX.)
INV (E) = 456.92
- 855 STA. 905+76.59, 11.4' RT.
INLET TYPE B, TY-1 F. CL
RIM = 462.79
INV (W) = 456.73
INV (NE) = 453.27 (EX.)
- 315 STA. 905+83.81, 21.9' LT.
EX. MH, 6' DIA., T-1 F. CL
TO BE ADJUSTED
RIM = 463.04
INV (NE) = 458.19 (EX.)
INV (SW) = 453.82 (EX.)
INV (NW) = 452.47 (EX.)
INV (SE) = 452.47 (EX.)
- 6 STA. 905+82.85, 32.8' LT.
INLET TYPE B, TY-1 F. CL
RIM = 463.04
INV (NW) = 459.19
INV (SW) = 458.70 (EX.)
INV (NE) = 460.54

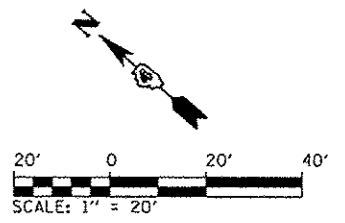
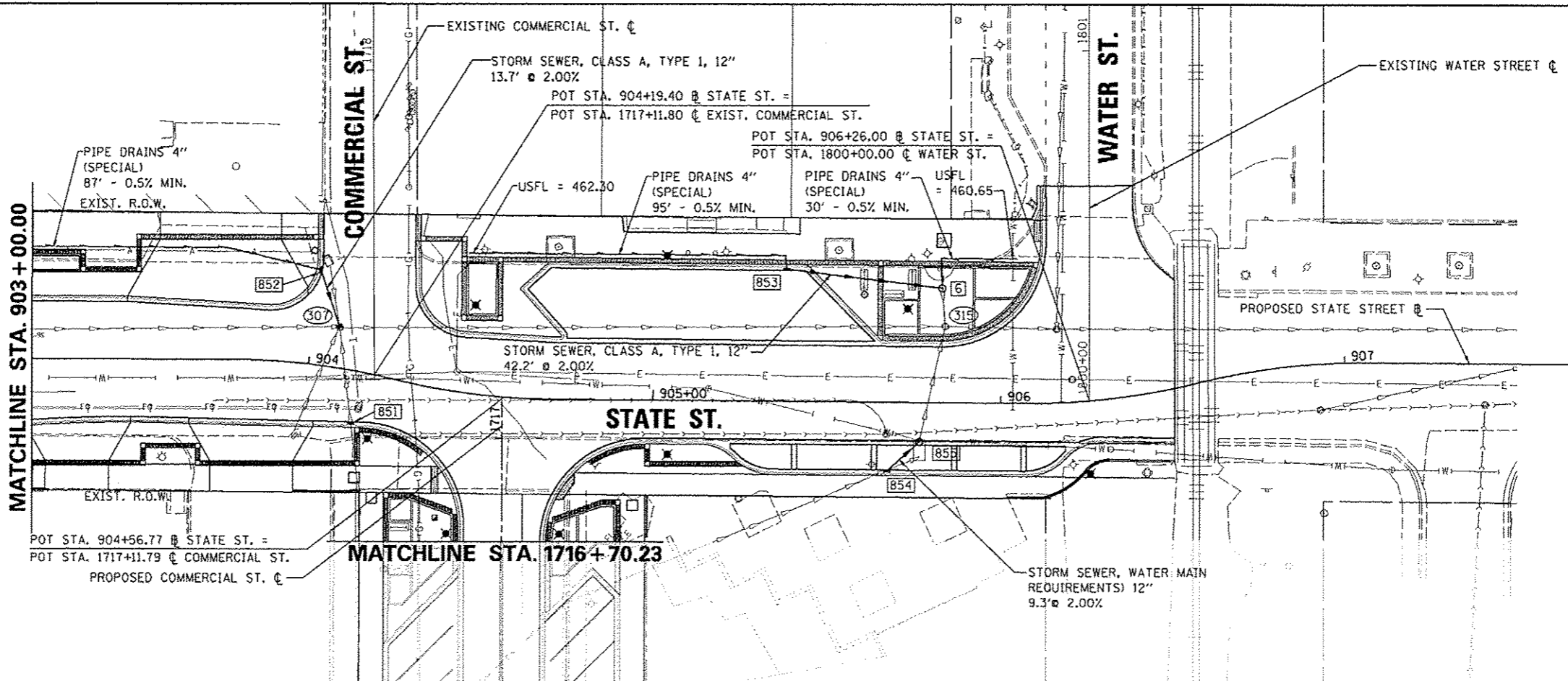

DATE	
BY	
REVISIONS	
NOTED	
GRADES CHECKED	
PLAN CHECKED	
DATE PLOTTED	
SCALE	
NO.	

DATE	
BY	
REVISIONS	
NOTED	
GRADES CHECKED	
PLAN CHECKED	
DATE PLOTTED	
SCALE	
NO.	

CMT
CRAWFORD, MURPHY & TILLY, INC.
CONSULTING ENGINEERS
License No. 184-000613

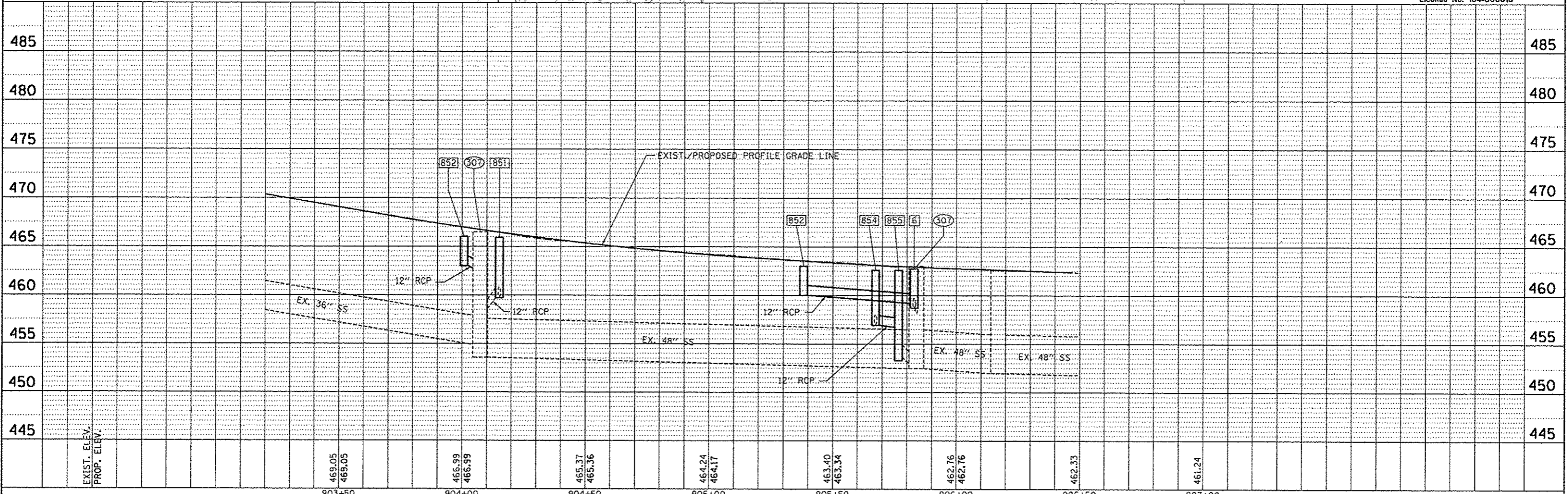

FILE NAME * c:\pwise\work\do_no_delete\des73472\0410	USER NAME * kovan01511	DESIGNED - RMM	REVISED -	STATE OF ILLINOIS DEPARTMENT OF TRANSPORTATION	STATE STREET DRAINAGE PLAN AND PROFILE			F.A.U. RTE.	SECTION 12-00356-01-PV	COUNTY PEORIA	TOTAL SHEETS 519	SHEET NO. 234
	0155-ah-t-drain-prpl01.dgn	DRAWN - RJE	REVISED -		SCALE: 1" = 20'			SHEET NO. OF	SHEETS	STA. 903+15.00 TO STA. 906+46.43	CONTRACT NO. 89626	
	PLOT SCALE * 39.9999' / in.	CHECKED - EJH	REVISED -		ILLINOIS FED. AID PROJECT TIG-50931(58)							
	PLOT DATE = 07/23/2012	DATE - 7/18/12	REVISED -									