

ALL KEYED NOTES APPLY TO THIS SHEET ONLY.

KEYED NOTES:

- 2" CONDUIT, 2\*6 AND 1\*6 GND FOR CIRCUIT LC5-5.
- 2" CONDUIT, 2\*6 AND 1\*6 GND FOR CIRCUIT LC6-2.

NOTES:

- STATIONS AND OFFSETS SHOWN ON THIS SHEET ARE TO THE CENTER OF HANDHOLE AND LIGHT POLE FOUNDATIONS.
- COORDINATE INSTALLATION OF UNDERGROUND CONDUIT AND LIGHT FIXTURES WITH ALL EXISTING UNDERGROUND SYSTEMS AND PROPOSED LANDSCAPE FEATURES AND PLANTINGS.
- SEE IRRIGATION PLANS FOR UNDERGROUND CONDUIT AND PIPING. COORDINATE INSTALLATION OF UNDERGROUND FACILITIES.
- 'F' DESIGNATIONS OF LIGHT FIXTURES SHOWN ON LIGHTING DETAILS SHEET.

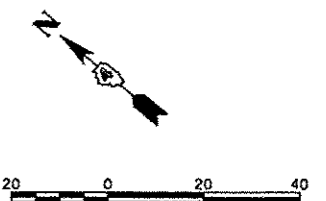
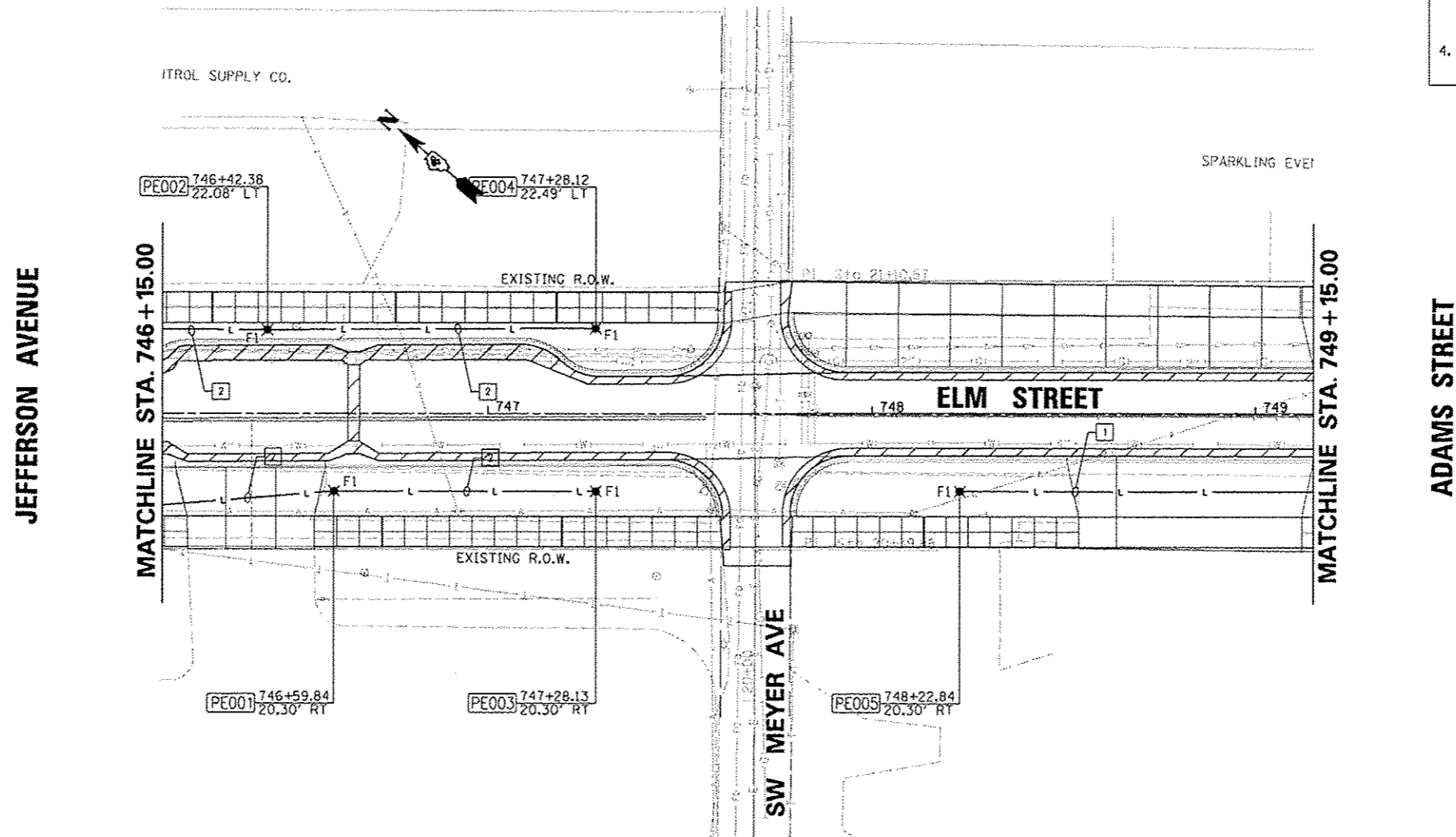

FILE NAME * c:\pwise_work\do_not_delete\dm273316\04	USER NAME = manak01378	DESIGNED = JDE	REVISED =	<b>STATE OF ILLINOIS DEPARTMENT OF TRANSPORTATION</b>	<b>ELM STREET LIGHTING PLAN</b>	F.A.U. RTE. 12	SECTION	COUNTY	TOTAL SHEETS	SHEET NO.
	LO159-eh-11gh-1038.dgn	DRAWN = TMT	REVISED =			12-00356-01-PV	PEORIA	519	365	
	PLOT SCALE = 3/4"=20' / in.	CHECKED = BMS	REVISED =			CONTRACT NO. 89626				
	PLOT DATE = 07/20/2012	DATE = 7/18/12	REVISED =			ILLINOIS FED. AID PROJECT TIG-5093158				
					SCALE: 1"=20'	SHEET NO. OF SHEETS		STA. 746+15.00 TO STA. 749+15.00		

**Farnsworth GROUP**  
 7707 N. KNOXVILLE AVE, SUITE 100  
 PEORIA, ILLINOIS 61614  
 (309) 693-9859 / (309) 693-9820 Fax  
 www.fw.com