

ALL KEYED NOTES APPLY TO THIS SHEET ONLY.

KEYED NOTES:

1. INTERCEPT EXISTING 2" CONDUIT FOR CIRCUIT EXTENSION.
2. 2" CONDUIT, 2#6 AND 1#6 GND FOR CIRCUIT LC2-14 AND 2#6 AND 1#6 GND FOR CIRCUIT LC2-16. EXTEND WIRE IN EXISTING CONDUIT BACK TO HANDHOLE.
3. 2" CONDUIT, 2#6 AND 1#6 GND FOR CIRCUIT LC2-8. EXTEND WIRE BACK TO EXISTING POLE AND SPLICE WIRE IN POLE HANDHOLE.
4. 2" CONDUIT, 2#6 AND 1#6 GND FOR CIRCUIT LC2-11, EXTEND WIRE BACK TO EXISTING POLE AND SPLICE.
5. EXISTING POLE, SPLICE CIRCUIT CONDUCTORS IN POLE HANDHOLE.
6. 2" CONDUIT, 2#6 AND 1#6 GND FOR CIRCUIT LC4-8.
7. EXISTING HANDHOLE - SPLICE AND EXTEND 2#6 AND 1#6 GND FOR CIRCUIT LC2-14 AND 2#6 AND 1#6 GND FOR CIRCUIT LC2-16.
8. 2" CONDUIT, 2#6 AND 1#6 GND FOR CIRCUIT LC2-12. EXTEND WIRE BACK TO EXISTING POLE AND SPLICE WIRE IN POLE HANDHOLE.

NOTES:

1. STATIONS AND OFFSETS SHOWN ON THIS SHEET ARE TO THE CENTER OF HANDHOLE AND LIGHT POLE FOUNDATIONS.
2. COORDINATE INSTALLATION OF UNDERGROUND CONDUIT AND LIGHT FIXTURES WITH ALL EXISTING UNDERGROUND SYSTEMS AND PROPOSED LANDSCAPE FEATURES AND PLANTINGS.
3. SEE IRRIGATION PLANS FOR UNDERGROUND CONDUIT AND PIPING. COORDINATE INSTALLATION OF UNDERGROUND FACILITIES.
4. 'F' DESIGNATIONS OF LIGHT FIXTURES SHOWN ON LIGHTING DETAILS SHEET.

ADAMS STREET

MATCHLINE STA. 898 + 45.00

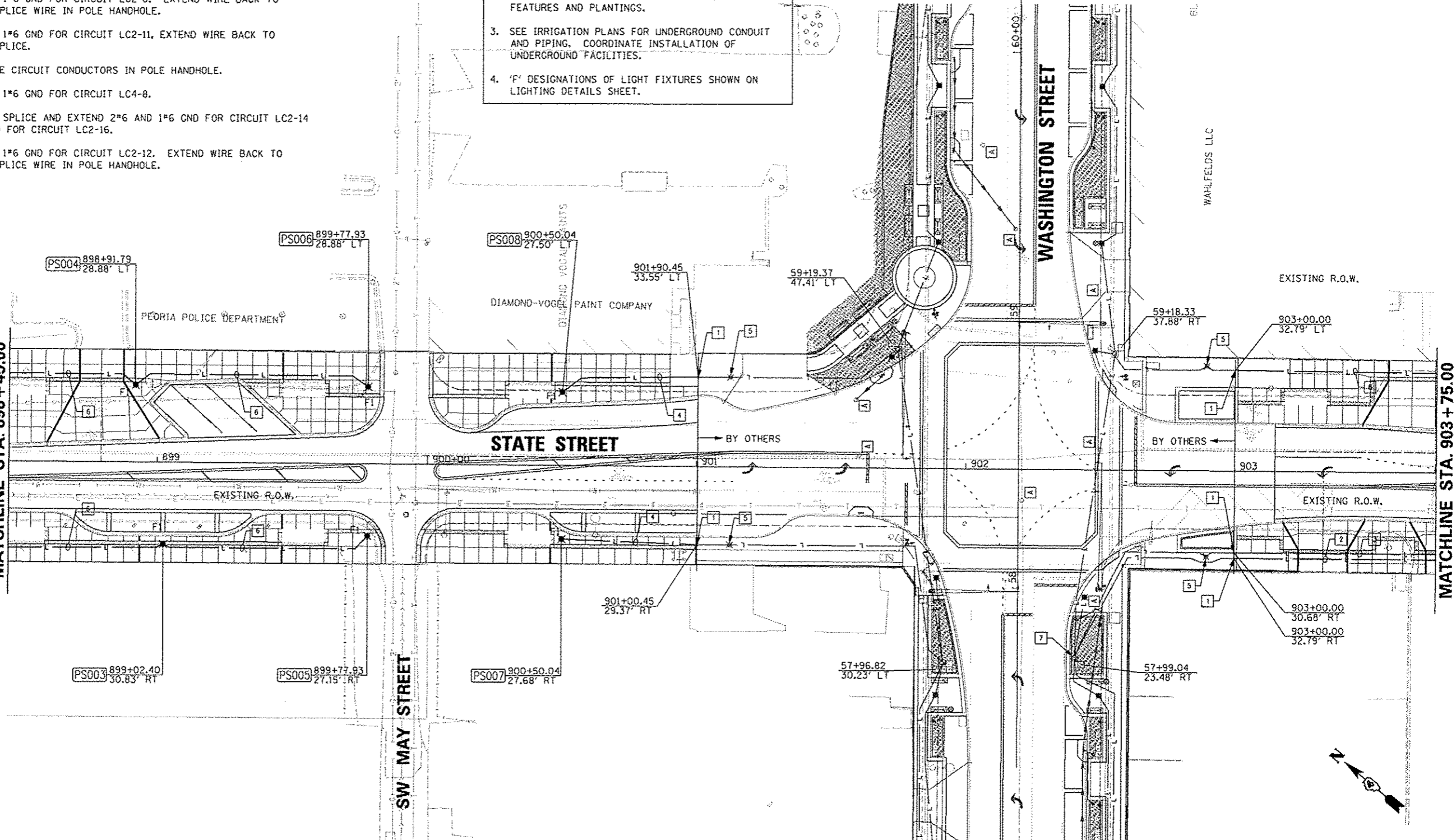

MATCHLINE STA. 903 + 75.00

FILE NAME *	USER NAME = monsk01398	DESIGNED - JDE	REVISED -
c:\pwise_work\do_not_delete\dms73318\041	KL0155-eh1-light833.dgn	DRAWN - TMT	REVISED -
	PLOT SCALE = 3/8" = 1' in.	CHECKED - BMS	REVISED -
	PLOT DATE = 07/23/2012	DATE - 7/18/12	REVISED -

STATE OF ILLINOIS  
DEPARTMENT OF TRANSPORTATION

STATE STREET  
LIGHTING PLAN

SCALE: 1"=20' SHEET NO. OF SHEETS STA. 898+45.00 TO STA. 903+75.00

F.A.U. R.T.E.	SECTION	COUNTY	TOTAL SHEETS	SHEET NO.
12	12-00356-01-PV	PEORIA	519	368
CONTRACT NO. 89626			ILLINOIS FED. AID PROJECT T10-50931581	

**Farnsworth GROUP**  
7707 N. KNOXVILLE AVE, SUITE 100  
PEORIA, ILLINOIS 61614  
(309) 699-4626 / (309) 699-4620 Fax  
www.fw.com