

037

11-09-2018 LETTING ITEM 5 037

STATE OF ILLINOIS
DEPARTMENT OF TRANSPORTATION

HSB RTE.	SECTION	COUNTY	TOTAL SHEETS	SHEET NO.
0275	2018-057-R5	WILL	17	1
ILLINOIS			CONTRACT NO. 62G91	

FOR INDEX OF SHEETS, SEE SHEET NO. 2

THE IMPROVEMENT LOCATED IN
UNINCORPORATED WILMINGTON TWP.

PROPOSED HIGHWAY PLANS

HSB 275 : BLODGETT ROAD
KELLY ROAD TO I-55 W. FRONTAGE ROAD
SECTION: 2018-057-R5
PROJECT: STP-WW45(397)
RESURFACING (3P)

WILL COUNTY
C-91-278-18

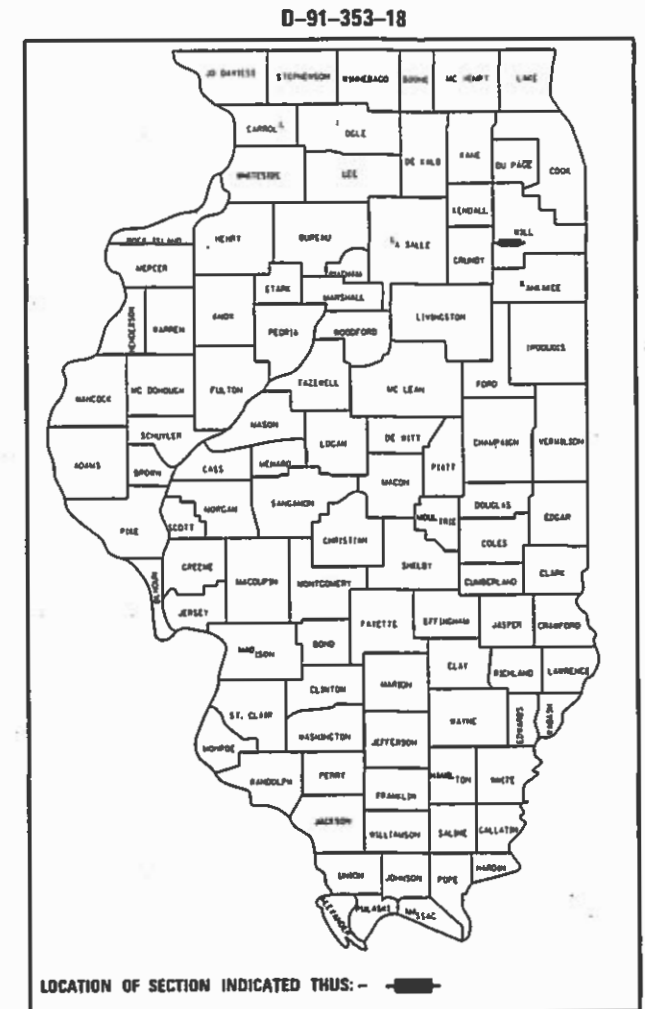

TRAFFIC DATA:
2017 ADT = 525
POSTED SPEED LIMIT = 45 MPH

IMPROVEMENT BEGINS
STA. 5 + 15.5

IMPROVEMENT ENDS
STA. 101 + 73.9

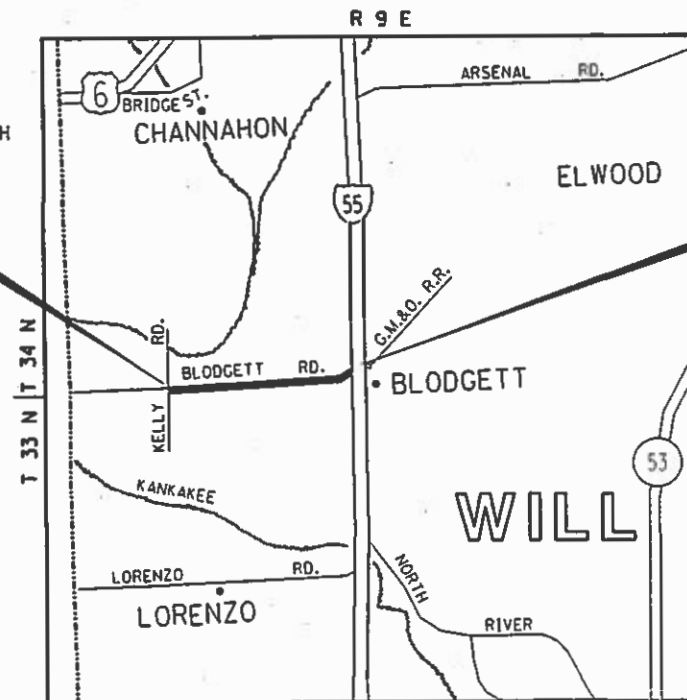

WILMINGTON TOWNSHIP

GROSS & NET LENGTH OF IMPROVEMENT = 9,658 LINEAL FT = 1.83 MILES

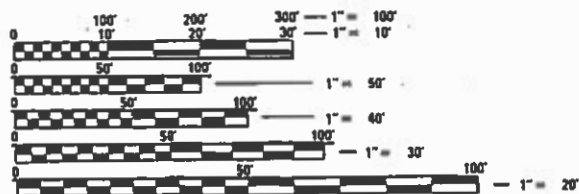

FULL SIZE PLANS HAVE BEEN PREPARED USING STANDARD
ENGINEERING SCALES. REDUCED SIZED PLANS WILL NOT
CONFORM TO STANDARD SCALES. IN MAKING MEASUREMENTS
ON REDUCED PLANS, THE ABOVE SCALES MAY BE USED.

J.U.L.I.E.
JOINT UTILITY LOCATION INFORMATION FOR EXCAVATION
1-800-892-0123
OR 811

PROJECT MANAGER FAWAD AQUEEL (847) 705-4247
PROJECT ENGINEER DANIEL WILGREEN (847) 705-4240

CONTRACT NO. 62G91

STATE OF ILLINOIS
DEPARTMENT OF TRANSPORTATION

SUBMITTED August 16, 2018

Anthony A. Deming REGIONAL ENGINEER

Oct 5, 2018

as E.A.E.T.C.

ENGINEER OF DESIGN AND ENVIRONMENT

Oct 5, 2018

Paul J. Chaf

DIRECTOR OF HIGHWAYS PROJECT IMPLEMENTATION

PRINTED BY THE AUTHORITY
OF THE STATE OF ILLINOIS

INDEX OF SHEETS

SHEET NO.	DESCRIPTION
1	TITLE SHEET
2	INDEX OF SHEETS, HIGHWAY STANDARDS, AND GENERAL NOTES
3-4	SUMMARY OF QUANTITIES
5	TYPICAL SECTIONS
6-9	ROADWAY AND PAVEMENT MARKING PLANS
10	PAVEMENT PATCHING FOR HMA SURFACE PAVEMENT (BD-22)
11	BUTT JOINT AND HMA TAPER DETAILS (BD-32)
12	TRAFFIC CONTROL AND PROTECTION FOR SIDE ROADS, INTERSECTIONS, AND DRIVEWAYS (TC-10)
13	TYPICAL APPLICATIONS RAISED REFLECTIVE PAVEMENT MARKERS (TC-11)
14	DISTRICT ONE TYPICAL PAVEMENT MARKINGS (TC-13)
15	TRAFFIC CONTROL AND PROTECTION AT TURN BAYS (TO REMAIN OPEN TO TRAFFIC) (TC-14)
16	SHORT TERM PAVEMENT MARKING LETTERS AND SYMBOLS (TC-16)
17	ARTERIAL ROAD INFORMATION SIGN (TC-22)

HIGHWAY STANDARDS

STANDARD NO.	DESCRIPTION
000001-06	STANDARD SYMBOLS, ABBREVIATIONS AND PATTERNS
442201-03	CLASS C AND D PATCHES
482011-03	HMA SHLD. STRIPS/SHLDS. WITH RESURFACING OR WIDENING AND RESURFACING PROJECTS
701006-05	OFF-ROAD OPERATIONS 2-LANE, 2-WAY 4.5 M (15') TO PAVEMENT EDGE FOR SPEEDS > 45 MPH
701011-04	OFF-RD MOVING OPERATIONS, 2L, 2W, DAY ONLY
701201-04	LANE CLOSURE, 2L, 2W, DAY ONLY, FOR SPEEDS > 45 MPH
701301-04	LANE CLOSURE, 2L, 2W, SHORT TIME OPERATIONS
701306-04	LANE CLOSURE, 2L, 2W, SLOW MOVING OPERATIONS DAY ONLY, FOR SPEEDS > 45 MPH
701311-03	LANE CLOSURE, 2L, 2W, MOVING OPERATIONS - DAY ONLY
701336-06	LANE CLOSURE, 2L, 2W, WORK AREAS IN SERIES, FOR SPEEDS > 45 MPH
701901-07	TRAFFIC CONTROL DEVICES
780001-05	TYPICAL PAVEMENT MARKINGS

GENERAL NOTES

BEFORE STARTING ANY EXCAVATION, THE CONTRACTOR SHALL CALL "J.U.L.I.E." AT (800) 892-0123 OR 811 FOR FIELD LOCATIONS OF BURIED ELECTRIC, TELEPHONE AND GAS UTILITIES. 48 HOUR NOTIFICATION IS REQUIRED.

THE CONTRACTOR SHALL COORDINATE CONSTRUCTION ACTIVITIES WITH UTILITY COMPANIES AND WILMINGTON TOWNSHIP.

THE CONTRACTOR SHALL CONTACT THE DISTRICT ONE TRAFFIC CONTROL SUPERVISOR AT (847) 705-4470 A MINIMUM OF 72 HOURS IN ADVANCE OF BEGINNING WORK.

THE CONTRACTOR WILL NOT BE ALLOWED TO SET UP A YARD OR FIELD OFFICE ON STATE PROPERTY WITHOUT WRITTEN PERMISSION FROM THE DEPARTMENT.

ALL DAMAGE TO EXISTING PAVEMENT MARKINGS OR RAISED REFLECTIVE PAVEMENT MARKERS OUTSIDE THE REMOVAL LINE SHOWN ON THE PLANS SHALL BE REPLACED AT NO ADDITIONAL COST TO THE DEPARTMENT.

BEFORE BEGINNING ANY WORK, THE CONTRACTOR SHALL RETAIN AND RECORD FOR FUTURE REFERENCE, ALL EXISTING PAVEMENT MARKING LINES (AND RAISED REFLECTIVE PAVEMENT MARKERS) IN ORDER THAT THESE LOCATIONS CAN BE RE-ESTABLISHED FOR STRIPING. EXACT LOCATIONS OF ALL PAVEMENT MARKINGS SHALL BE AS DIRECTED BY THE ENGINEER.

ALL PAVEMENT PATCHING LOCATIONS WILL BE DETERMINED IN THE FIELD BY THE RESIDENT ENGINEER.

IT SHALL BE THE CONTRACTOR'S RESPONSIBILITY TO VERIFY ALL DIMENSIONS AND CONDITIONS EXISTING IN THE FIELD PRIOR TO CONSTRUCTION AND ORDERING OF MATERIALS.

THE RESIDENT ENGINEER SHALL CONTACT ERIC CAMPOS, IDOT'S AREA TRAFFIC FIELD ENGINEER FOR WILL COUNTY, VIA E-MAIL AT ERIC.CAMPOS@ILLINOIS.GOV AND AT (815) 485-6475, A MINIMUM OF TWO (2) WEEKS PRIOR TO THE PLACEMENT OF PERMANENT PAVEMENT MARKINGS.

THE CONTRACTOR SHALL BE REQUIRED TO PROVIDE ACCESS TO ABUTTING PROPERTY AT ALL TIMES DURING THE CONSTRUCTION OF THIS PROJECT.

DO NOT SCALE PLANS FOR CONSTRUCTION DIMENSIONS.

PAVEMENT MARKING TAPE, TYPE III SHALL BE USED FOR SHORT TERM PAVEMENT MARKINGS ON ALL FINAL SURFACES.

WHEN THE MILLED PAVEMENT IS OPEN TO TRAFFIC THE MAXIMUM GRADE DIFFERENTIAL BETWEEN PASSES OF THE MILLING MACHINE SHALL NOT EXCEED 1/2 INCHES (40 mm) WHERE THE SPEED LIMIT IS 40 MPH (80 km/h) OR LESS AND 1 INCH (25 mm) WHERE THE SPEED LIMIT IS GREATER THAN 40 MPH (80 km/h). WITH WRITTEN APPROVAL OF THE ENGINEER, A MAXIMUM GRADE DIFFERENTIAL OF 3 INCHES (75 mm) MAY BE ALLOWED IF THE EDGE OF THE MILLING IS SLOPED A MINIMUM 1:3 (v:h).

BUTT JOINTS WILL BE INSTALLED AT THE ENDS OF ALL RESURFACING (WHERE RESURFACING MEETS EXISTING PAVEMENT) ACCORDING TO THE "BUTT JOINT AND HOT-MIX ASPHALT TAPER DETAILS" SHEET INCLUDED IN THE PLANS, UNLESS OTHERWISE SPECIFIED.

SUMMARY OF QUANTITIES			TOTAL QUANTITIES URBAN	CONSTRUCTION TYPE CODE				
CODE NO	ITEM	UNIT		80% FED 20% STATE 0005				
40600290	BITUMINOUS MATERIALS (TACK COAT)	POUND	14506	14506				
40600400	MIXTURE FOR CRACKS, JOINTS, AND FLANGEWAYS	TON	33	33				
40600827	POLYMERIZED LEVELING BINDER (MACHINE METHOD), IL-4, 75, N50	TON	903	903				
40600982	HOT-MIX ASPHALT SURFACE REMOVAL - BUTT JOINT	SO YD	75	75				
40603335	HOT-MIX ASPHALT SURFACE COURSE, MIX "D", N50	TON	1805	1805				
44000158	HOT-MIX ASPHALT SURFACE REMOVAL, 2 1/4"	SO YD	21491	21491				
44201692	CLASS D PATCHES, TYPE II, 4 INCH	SO YD	200	200				
44201694	CLASS D PATCHES, TYPE III, 4 INCH	SO YD	330	330				
44201696	CLASS D PATCHES, TYPE IV, 4 INCH	SO YD	2675	2675				
48102100	AGGREGATE WEDGE SHOULDER, TYPE B	TON	392	392				
67000400	ENGINEER'S FIELD OFFICE, TYPE A	CAL MO	6	6				
67100100	MOBILIZATION	L SUM	1	1				
70100450	TRAFFIC CONTROL AND PROTECTION, STANDARD 701201	L SUM	1	1				

SUMMARY OF QUANTITIES			TOTAL QUANTITIES URBAN	CONSTRUCTION TYPE CODE				
CODE NO	ITEM	UNIT		80% FED 20% STATE 0005				
70100460	TRAFFIC CONTROL AND PROTECTION, STANDARD 701306	L SUM	1	1				
70100600	TRAFFIC CONTROL AND PROTECTION, STANDARD 701336	L SUM	1	1				
70300100	SHORT TERM PAVEMENT MARKING	FOOT	4110	4110				
70300150	SHORT TERM PAVEMENT MARKING REMOVAL	SO FT	1370	1370				
70300210	TEMPORARY PAVEMENT MARKING LETTERS AND SYMBOLS	SO FT	123	123				
70300220	TEMPORARY PAVEMENT MARKING - LINE 4"	FOOT	29635	29635				
70300280	TEMPORARY PAVEMENT MARKING - LINE 24"	FOOT	66	66				
70300520	PAVEMENT MARKING TAPE, TYPE III 4"	FOOT	1370	1370				
* 78000100	THERMOPLASTIC PAVEMENT MARKING - LETTERS AND SYMBOLS	SO FT	123	123				
* 78000200	THERMOPLASTIC PAVEMENT MARKING - LINE 4"	FOOT	29635	29635				
* 78000650	THERMOPLASTIC PAVEMENT MARKING - LINE 24"	FOOT	66	66				
* 78100100	RAISED REFLECTIVE PAVEMENT MARKER	EACH	443	443				
*	SPECIALTY ITEMS							

FILE NAME =	USER NAME = shtanisb	DESIGNED -	REVISED -	STATE OF ILLINOIS DEPARTMENT OF TRANSPORTATION	SUMMARY OF QUANTITIES BLODGETT ROAD (KELLY ROAD TO I-55 W. FRONTAGE ROAD)	HSB	SECTION	COUNTY	TOTAL	SHEET	
pw:\N\LOB\EBID\INT\EG\Illinois.gov\PW\DOT\Documents\DOT	Offices\District\Projects\DI353\B\CADData\Design\DI353\B	DRAWN -	REVISED -			0275	2018-057-RS	WILL	17	3	
	PLOT SCALE = 100,0000' / 1in.	CHECKED -	REVISED -			CONTRACT NO. 62G91					
	PLOT DATE = 8/15/2018	DATE -	REVISED -			FED. ROAD DIST. NO. 1 ILLINOIS FED. AID PROJECT					

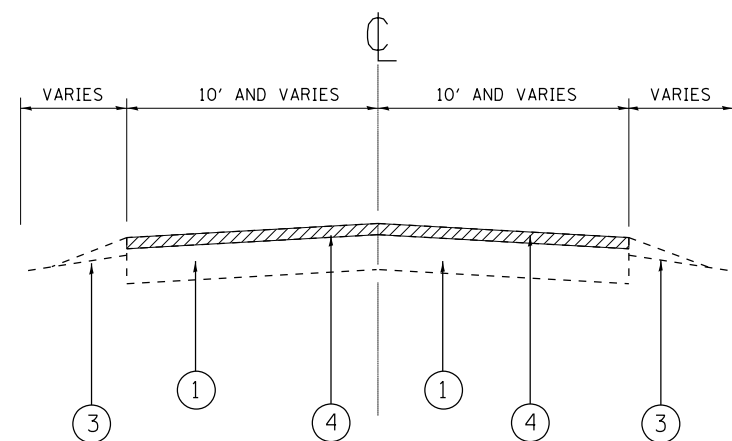

EXISTING TYPICAL SECTIONS
STA. 5+15.5 TO STA. 101+73.9

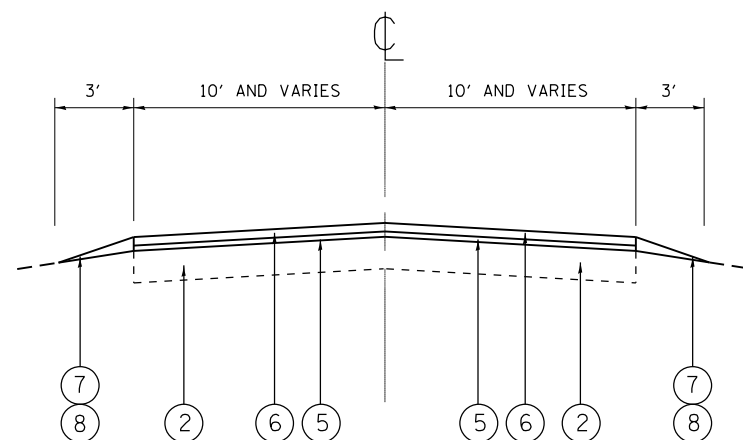

PROPOSED TYPICAL SECTIONS
STA. 5+15.5 TO STA. 101+73.9

LEGEND

- ① EXISTING HMA PAVEMENT ±6"
- ② EXISTING HMA SURFACE AFTER MILLING, ±4"
- ③ EXISTING AGGREGATE SHOULDERS
- ④ PROPOSED HMA SURFACE REMOVAL, 2 1/4"
- ⑤ PROPOSED POLYMERIZED LEVELING BINDER (MACHINE METHOD), IL-4.75, N50, 3/4"
- ⑥ PROPOSED HMA SURFACE COURSE, MIX "D", N50, 1 1/2 "
- ⑦ PROPOSED AGGREGATE WEDGE SHOULDERS, TYPE B
- ⑧ PROPOSED GRADING & SHAPING SHOULDERS

NOTES:

FOR THE EXISTING HMA SURFACE, THE CONTRACTOR SHALL DO PAVEMENT MILLING FIRST, THEN PATCHING THE ROADWAY PER BD-22 DETAIL.

HOT-MIX ASPHALT MIXTURE REQUIREMENTS		
MIXTURE USES	DESIGN AIR Voids @ N _{DGS}	OMP
PAVEMENT RESURFACING		
POLYMERIZED LEVELING BINDER (MACHINE METHOD), IL-4.75, N50	3.5% AT 50 GYR.	QC/OA
HMA SURFACE COURSE, MIX "D", N50, (IL-9.5 mm)	4% AT 50 GYR.	QCP
PAVEMENT PATCHING		
CLASS D PATCH (HMA BINDER IL-19 mm)	4% AT 70 GYR.	QC/OA
OMP DESIGNATION: QUALITY CONTROL/QUALITY ASSURANCE (QC/OA); QUALITY CONTROL FOR PERFORMANCE (QCP); PAY FOR PERFORMANCE (PFP)		

NOTES:

THE UNIT WEIGHT USED TO CALCULATE ALL HMA SURFACE MIXTURES QUANTITIES IS 112 LBS/SQ YD/IN.
THE "AC TYPE FOR POLYMERIZED HMA MIXES SHALL BE "SBS/SBR PG 76-22" AND FOR NON-POLYMERIZED HMA THE "AC TYPE" SHALL BE "PG 64-22" UNLESS MODIFIED BY DISTRICT ONE SPECIAL PROVISIONS.
FOR USE OF RECYCLED MATERIALS SEE DISTRICT ONE SPECIAL PROVISIONS.
QUALITY MANAGEMENT PROGRAM (OMP) IDENTIFIES THE PARTICULAR QUALITY CONTROL SPECIFICATION THAT APPLIES TO THE HMA MIXTURE.

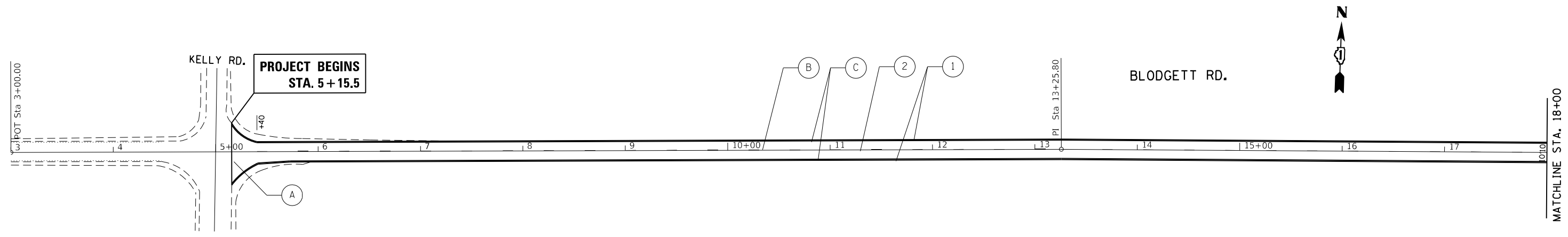

ROADWAY LEGEND

(A)	HMA SURFACE REMOVAL BUTT JOINT, 4.5' (TYP.)
(B)	PROP. HMA SURFACE REMOVAL, 2 1/4" PROP. POLYMERIZED LEVELING BINDER (MACHINE METHOD), IL-4.75, N50, 3/4" PROP. HMA SURFACE COURSE, MIX "D", N50, 1 1/2"
(C)	PROP. AGGREGATE WEDGE SHOULDERS, TYPE B PROP. GRADING AND SHAPING SHOULDERS

PAVEMENT MARKING LEGEND

①	PROP. THERMOPLASTIC PAVEMENT MARKING LINE, 4" EDGE LINE, WHITE (TYP.)
②	PROP. THERMOPLASTIC PAVEMENT MARKING LINE, 4" CENTER LINE @ 30' SKIP & 10' DASH, YELLOW (TYP.)
③	PROP. THERMOPLASTIC PAVEMENT MARKING LINE, 4" DOUBLE LINE @ 11" C-C, YELLOW (TYP.)
④	PROP. THERMOPLASTIC PAVEMENT MARKING LINE, 4" NO PASSING ZONE LINES, 5.5" C-C FROM SKIP DASH CENTER LINE, YELLOW (TYP.)
⑤	PROP. THERMOPLASTIC PAVEMENT MARKING LINE, 24" STOP BAR, WHITE (TYP.)

PLAN NOTES

ALL PAVEMENT MARKINGS OBLITERATED BY MILLING WITHIN PROJECT LIMITS ARE TO BE REPLACED ACCORDING TO THE "DISTRICT ONE TYPICAL PAVEMENT MARKINGS" DETAIL (TC-13).
RAISED REFLECTIVE PAVEMENT MARKERS ARE TO BE INSTALLED THROUGHOUT PROJECT LIMITS ACCORDING TO "TYPICAL APPLICATIONS RAISED REFLECTIVE PAVEMENT MARKERS (SNOW-PLOW RESISTANT) DETAIL (TC-11).

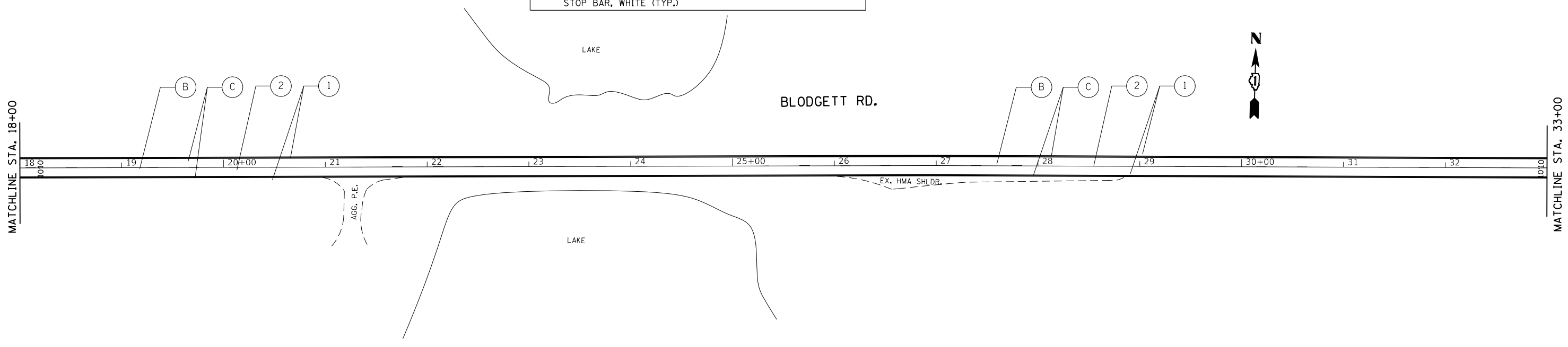

MODEL: Default
 FILE NAME: p:\u0000\B&E\BID\NTEC\Illinois\gov\p\W\DOT\Documents\1\DOT\Office\Bldg\1\Projects\1353\B\CADD\data\Drawn\135318-dhr-plan.dgn

USER NAME = shiraniib	DESIGNED -	REVISED -
PLOT SCALE = 100.0000' / in.	DRAWN -	REVISED -
PLOT DATE = 8/15/2018	CHECKED -	REVISED -
	DATE -	REVISED -

**STATE OF ILLINOIS
DEPARTMENT OF TRANSPORTATION**

**ROADWAY PLAN BLODGETT AVE.
KELLY RD. TO I-55 WEST FRONTAGE RD.**

SCALE: 1"=50' SHEET OF SHEETS STA. 4+46.9 TO STA. 35+00

H.S.B. RTE.	SECTION	COUNTY	TOTAL SHEETS	SHEET NO.
275	2018-057-RS	WILL	17	6
CONTRACT NO. 62G91				
ILLINOIS FED. AID PROJECT				

MODEL: Default
 FILE NAME: p:\u0008\BID\NTEC\Illinois\gov\PIV\DOT\Documents\DOT_Offices\Bldgett_1\Projects\135318\CADD\Drawings\135318-ahr-pln.dgn

MATCHLINE STA. 33+00

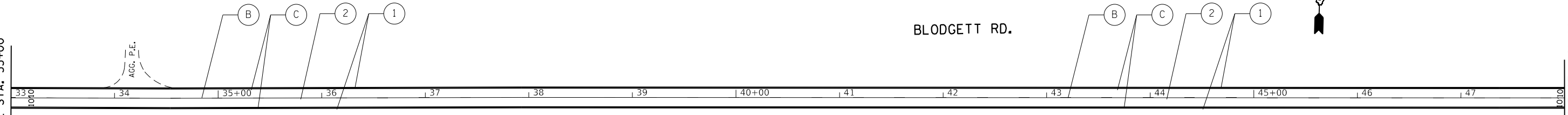

MATCHLINE STA. 48+00

ROADWAY LEGEND

- (A) HMA SURFACE REMOVAL BUTT JOINT, 4.5' (TYP.)
- (B) PROP. HMA SURFACE REMOVAL, 2 1/4" PROP. POLYMERIZED LEVELING BINDER (MACHINE METHOD), IL-4.75, N50, 3/4" PROP. HMA SURFACE COURSE, MIX "D", N50, 1 1/2"
- (C) PROP. AGGREGATE WEDGE SHOULDERS, TYPE B PROP. GRADING AND SHAPING SHOULDERS

PAVEMENT MARKING LEGEND

- (1) PROP. THERMOPLASTIC PAVEMENT MARKING LINE, 4" EDGE LINE, WHITE (TYP.)
- (2) PROP. THERMOPLASTIC PAVEMENT MARKING LINE, 4" CENTER LINE @ 30' SKIP & 10' DASH, YELLOW (TYP.)
- (3) PROP. THERMOPLASTIC PAVEMENT MARKING LINE, 4" DOUBLE LINE @ 11" C-C, YELLOW (TYP.)
- (4) PROP. THERMOPLASTIC PAVEMENT MARKING LINE, 4" NO PASSING ZONE LINES, 5.5" C-C FROM SKIP DASH CENTER LINE, YELLOW (TYP.)
- (5) PROP. THERMOPLASTIC PAVEMENT MARKING LINE, 24" STOP BAR, WHITE (TYP.)

PLAN NOTES

ALL PAVEMENT MARKINGS OBLITERATED BY MILLING WITHIN PROJECT LIMITS ARE TO BE REPLACED ACCORDING TO THE "DISTRICT ONE TYPICAL PAVEMENT MARKINGS" DETAIL (TC-13). RAISED REFLECTIVE PAVEMENT MARKERS ARE TO BE INSTALLED THROUGHOUT PROJECT LIMITS ACCORDING TO "TYPICAL APPLICATIONS RAISED REFLECTIVE PAVEMENT MARKERS (SNOW-PLOW RESISTANT) DETAIL (TC-11).

MATCHLINE STA. 48+00

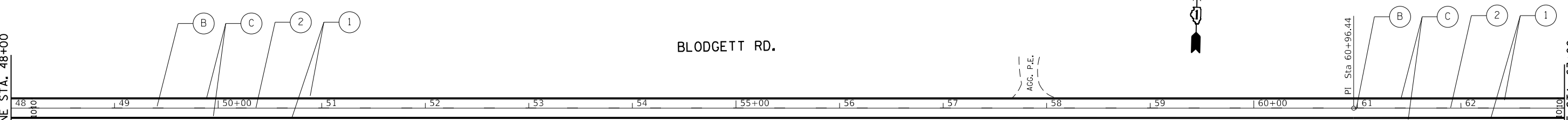

MATCHLINE STA. 63+00

USER NAME = shiraniib	DESIGNED -	REVISED -
	DRAWN -	REVISED -
PLOT SCALE = 100.0000' / in.	CHECKED -	REVISED -
PLOT DATE = 8/15/2018	DATE -	REVISED -

**STATE OF ILLINOIS
 DEPARTMENT OF TRANSPORTATION**

**ROADWAY PLAN BLODGETT AVE.
 KELLY RD. TO I-55 WEST FRONTAGE RD.**

SCALE: 1"=50' SHEET OF SHEETS STA. 33+00 TO STA. 63+00

H.S.B. RTE.	SECTION	COUNTY	TOTAL SHEETS	SHEET NO.
275	2018-057-RS	WILL	17	7
CONTRACT NO. 62G91				
ILLINOIS FED. AID PROJECT				

MATCHLINE STA. 63+00

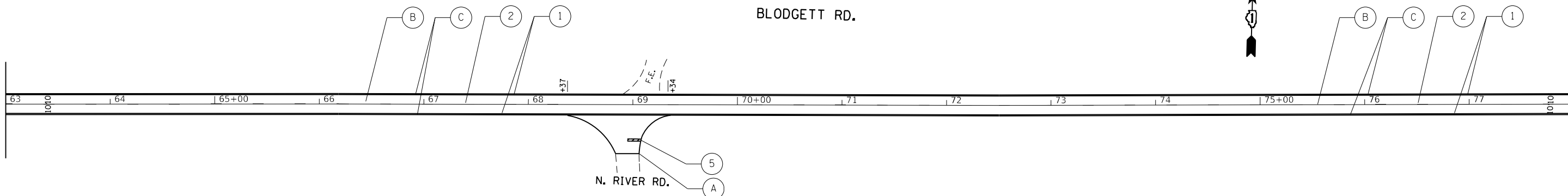

ROADWAY LEGEND

- (A) HMA SURFACE REMOVAL BUTT JOINT, 4.5' (TYP.)
- (B) PROP. HMA SURFACE REMOVAL, 2 1/4"
PROP. POLYMERIZED LEVELING BINDER (MACHINE METHOD),
1L-4.75, N50, 3/4"
PROP. HMA SURFACE COURSE, MIX "D", N50, 1 1/2"
- (C) PROP. AGGREGATE WEDGE SHOULDERS, TYPE B
PROP. GRADING AND SHAPING SHOULDERS

PAVEMENT MARKING LEGEND

- (1) PROP. THERMOPLASTIC PAVEMENT MARKING LINE, 4"
EDGE LINE, WHITE (TYP.)
- (2) PROP. THERMOPLASTIC PAVEMENT MARKING LINE, 4"
CENTER LINE @ 30' SKIP & 10' DASH, YELLOW (TYP.)
- (3) PROP. THERMOPLASTIC PAVEMENT MARKING LINE, 4"
DOUBLE LINE @ 11" C-C, YELLOW (TYP.)
- (4) PROP. THERMOPLASTIC PAVEMENT MARKING LINE, 4"
NO PASSING ZONE LINES, 5.5" C-C FROM SKIP DASH
CENTER LINE, YELLOW (TYP.)
- (5) PROP. THERMOPLASTIC PAVEMENT MARKING LINE, 24"
STOP BAR, WHITE (TYP.)

PLAN NOTES

ALL PAVEMENT MARKINGS OBLITERATED BY MILLING WITHIN PROJECT LIMITS ARE TO BE REPLACED ACCORDING TO THE "DISTRICT ONE TYPICAL PAVEMENT MARKINGS" DETAIL (TC-13).
RAISED REFLECTIVE PAVEMENT MARKERS ARE TO BE INSTALLED THROUGHOUT PROJECT LIMITS ACCORDING TO "TYPICAL APPLICATIONS RAISED REFLECTIVE PAVEMENT MARKERS (SNOW-PLOW RESISTANT) DETAIL (TC-11).

MATCHLINE STA. 78+00

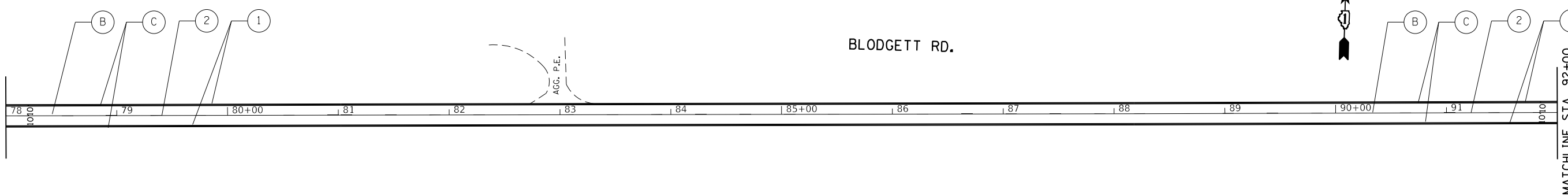

MATCHLINE STA. 92+00

MODEL: Default
 FILE: \\blm\c:\pwworking\illinois.gov\pwworking\DOT\Documents\135318\CADD\Blodgett\Blodgett.dwg
 PROJECT: 135318\Blodgett.dwg
 USER: shiraniib

USER NAME = shiraniib	DESIGNED -	REVISED -
PLOT SCALE = 100,0000' / in.	DRAWN -	REVISED -
PLOT DATE = 8/15/2018	CHECKED -	REVISED -
	DATE -	REVISED -

**STATE OF ILLINOIS
DEPARTMENT OF TRANSPORTATION**

**ROADWAY PLAN BLODGETT AVE.
KELLY RD. TO I-55 WEST FRONTAGE RD.**

SCALE: 1"=50' SHEET OF SHEETS STA. 63+00 TO STA. 92+00

H.S.B. RTE.	SECTION	COUNTY	TOTAL SHEETS	SHEET NO.
275	2018-057-RS	WILL	17	8
CONTRACT NO. 62G91				
ILLINOIS FED. AID PROJECT				

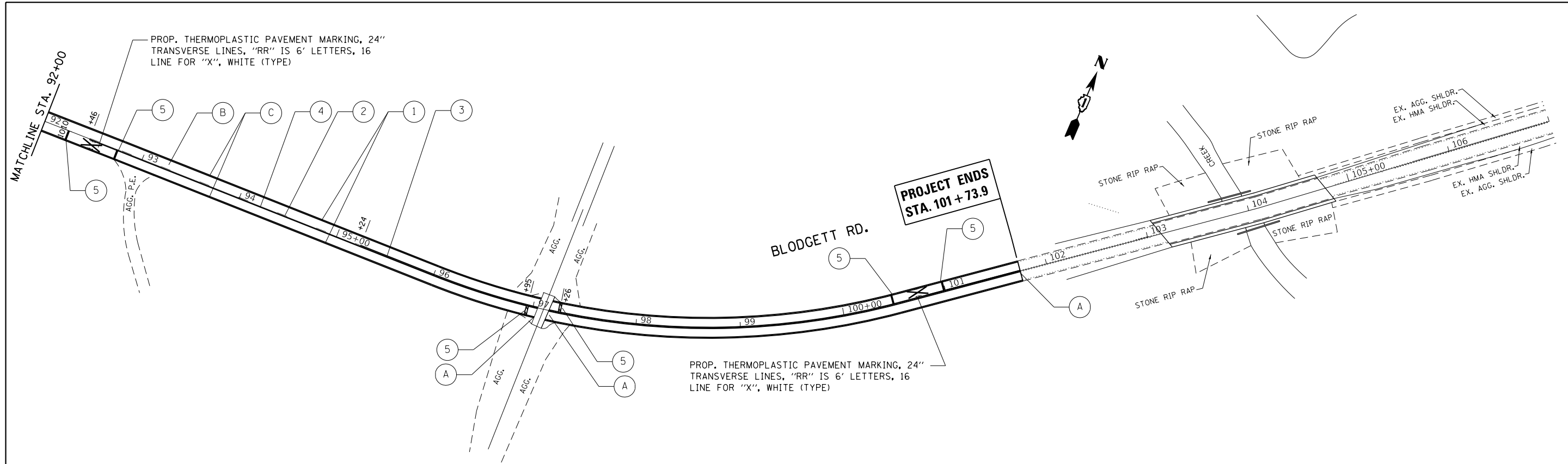

ROADWAY LEGEND

(A)	HMA SURFACE REMOVAL BUTT JOINT, 4.5' (TYP.)
(B)	PROP. HMA SURFACE REMOVAL, 2 1/4" PROP. POLYMERIZED LEVELING BINDER (MACHINE METHOD), IL-4.75, N50, 3/4" PROP. HMA SURFACE COURSE, MIX "D", N50, 1 1/2"
(C)	PROP. AGGREGATE WEDGE SHOULDERS, TYPE B PROP. GRADING AND SHAPING SHOULDERS

PAVEMENT MARKING LEGEND

(1)	PROP. THERMOPLASTIC PAVEMENT MARKING LINE, 4" EDGE LINE, WHITE (TYP.)
(2)	PROP. THERMOPLASTIC PAVEMENT MARKING LINE, 4" CENTER LINE @ 30' SKIP & 10' DASH, YELLOW (TYP.)
(3)	PROP. THERMOPLASTIC PAVEMENT MARKING LINE, 4" DOUBLE LINE @ 11" C-C, YELLOW (TYP.)
(4)	PROP. THERMOPLASTIC PAVEMENT MARKING LINE, 4" NO PASSING ZONE LINES, 5.5" C-C FROM SKIP DASH CENTER LINE, YELLOW (TYP.)
(5)	PROP. THERMOPLASTIC PAVEMENT MARKING LINE, 24" STOP BAR, WHITE (TYP.)

PLAN NOTES

ALL PAVEMENT MARKINGS OBLITERATED BY MILLING WITHIN PROJECT LIMITS ARE TO BE REPLACED ACCORDING TO THE "DISTRICT ONE TYPICAL PAVEMENT MARKINGS" DETAIL (TC-13).
RAISED REFLECTIVE PAVEMENT MARKERS ARE TO BE INSTALLED THROUGHOUT PROJECT LIMITS ACCORDING TO "TYPICAL APPLICATIONS RAISED REFLECTIVE PAVEMENT MARKERS (SNOW-PLOW RESISTANT) DETAIL (TC-11).

MODEL: Default
 FILE: h:\mhc\p\1108\B&E\BIDD\ITEC\Illinois.gov\RW\DOT\Documents\1\DOT\Projects\1353\B\CADD\Drawings\135318-shr-plan.dgn

USER NAME = shiraniib	DESIGNED -	REVISED -
PLOT SCALE = 100.0000' / in.	DRAWN -	REVISED -
PLOT DATE = 8/15/2018	CHECKED -	REVISED -
	DATE -	REVISED -

**STATE OF ILLINOIS
DEPARTMENT OF TRANSPORTATION**

**ROADWAY PLAN BLODGETT AVE.
KELLY RD. TO I-55 WEST FRONTAGE RD.**

SCALE: 1"=50'	SHEET	OF	SHEETS	STA. 92+00	TO STA. 114+84.3
---------------	-------	----	--------	------------	------------------

H.S.B. RTE.	SECTION	COUNTY	TOTAL SHEETS	SHEET NO.
275	2018-057-RS	WILL	17	9
CONTRACT NO. 62G91				
ILLINOIS FED. AID PROJECT				

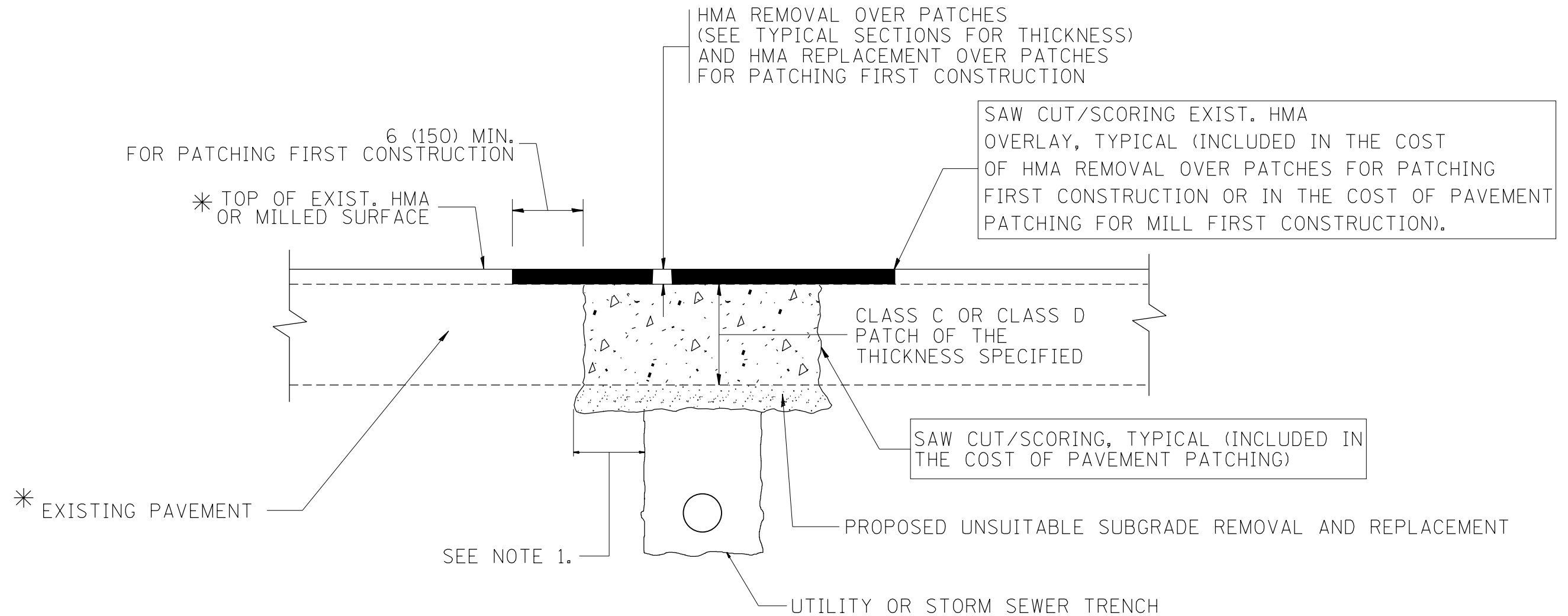

* SEE TYPICAL SECTIONS FOR THICKNESS AND MATERIALS

NOTES:

1. THE WIDTH OF THE FULL DEPTH PATCH OVER A TRENCH SHALL BE 12 (300) WIDER ON EACH SIDE OF THE TRENCH.
2. FOR METHOD OF MEASUREMENT AND BASIS OF PAYMENT, SEE RECURRING SPECIAL PROVISION "PATCHING WITH HOT-MIX ASPHALT OVERLAY REMOVAL".

SEQUENCE OF CONSTRUCTION (PATCHING FIRST)

1. REMOVE THE EXISTING HMA MATERIAL OVER THE AREA TO BE PATCHED.
2. REMOVE AND REPLACE WITH CLASS C OR D PATCH.
3. REPLACE HMA MATERIAL OVER THE AREA TO BE PATCHED.

SEQUENCE OF CONSTRUCTION (MILLING FIRST)

1. MILL HMA FIRST IF THERE IS AT LEAST 4 1/2 INCHES OR MORE OF HMA MATERIAL ON TOP OF THE EXISTING PAVEMENT OR IF THE PAVEMENT IS FULL DEPTH HMA. A MINIMUM OF 2 INCHES OF HMA MATERIAL SHALL BE IN PLACE AFTER MILLING.
2. REMOVE AND REPLACE WITH FULL DEPTH CLASS D PATCHES TO TOP OF MILLED SURFACE.

ALL DIMENSIONS ARE IN INCHES (MILLIMETERS) UNLESS OTHERWISE SHOWN.

FILE NAME =	USER NAME = shiranisb	DESIGNED - R. SHAH	REVISED - A. ABBAS 04-27-98	STATE OF ILLINOIS DEPARTMENT OF TRANSPORTATION	PAVEMENT PATCHING FOR HMA SURFACED PAVEMENT			HSB	SECTION	COUNTY	TOTAL	SHEET
pw\11084EBIDINTEG.illinois.gov\PIWIDOT\Documents\DOT Offices\District 1\Projects\DI383\Drawings\Design\DistStd.dgn	PLOT SCALE = 100.0000' / 1in.	CHECKED -	REVISED - R. BORO 01-01-07					0275	2018-057-RS	WILL	17	10
PLOT DATE = 8/15/2018	DATE - 10-25-94	REVISED - R. BORO 09-04-07	REVISED - K. ENG 10-27-08		SCALE: NONE SHEET NO. 1 OF 1 SHEETS STA. TO STA.			BD400-04 (BD-22) CONTRACT NO. 62G91				
								FED. ROAD DIST. NO. 1 ILLINOIS FED. AID PROJECT				

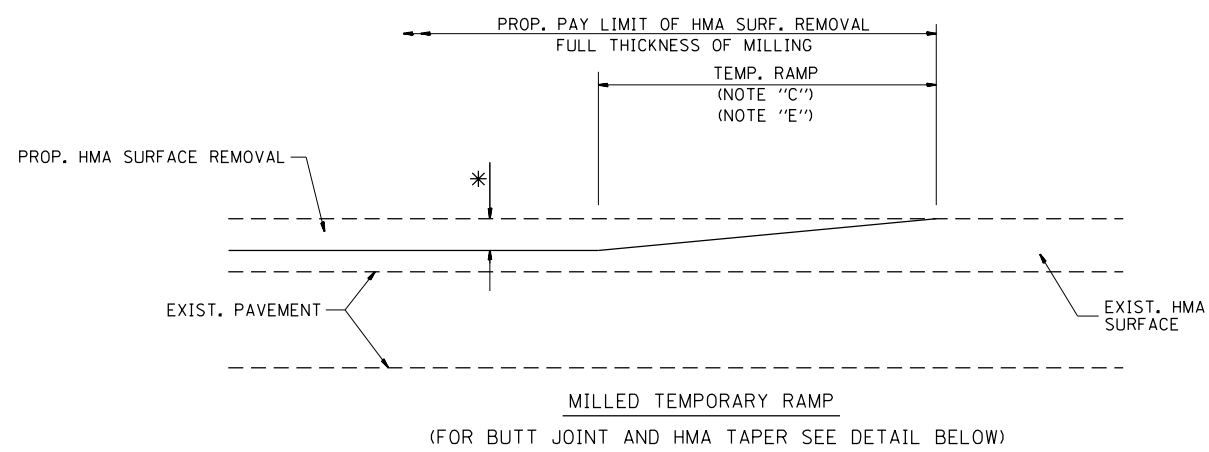

OPTION 1

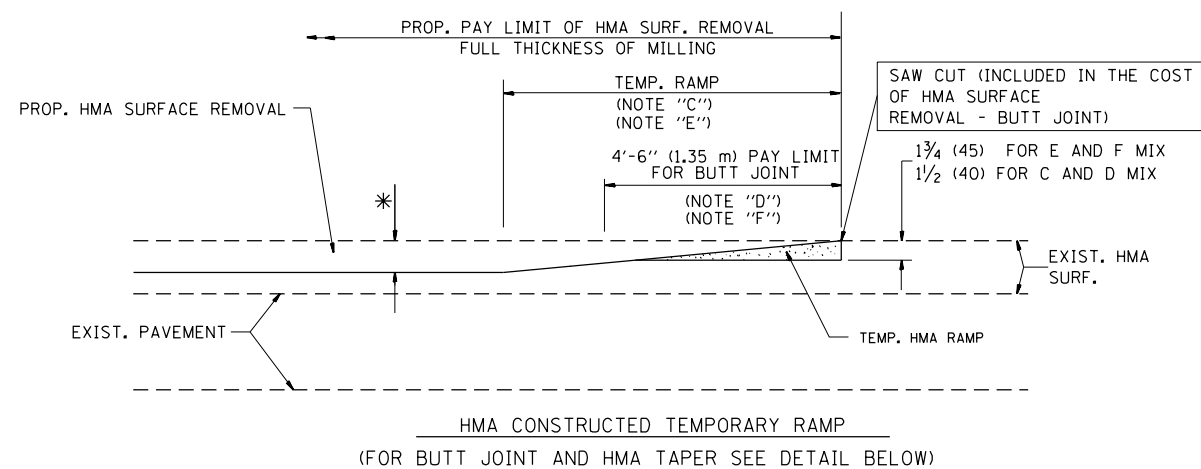

OPTION 2

TYPICAL TEMPORARY RAMP

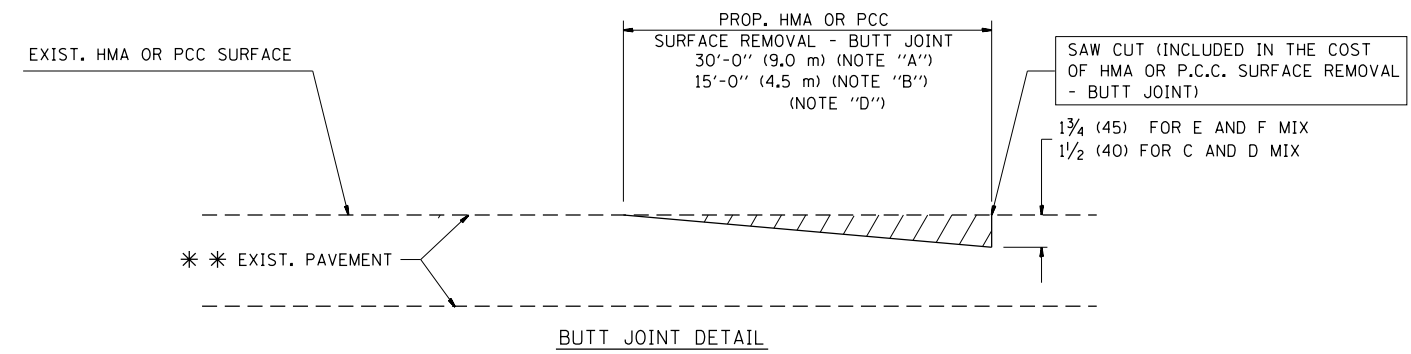

BUTT JOINT DETAIL

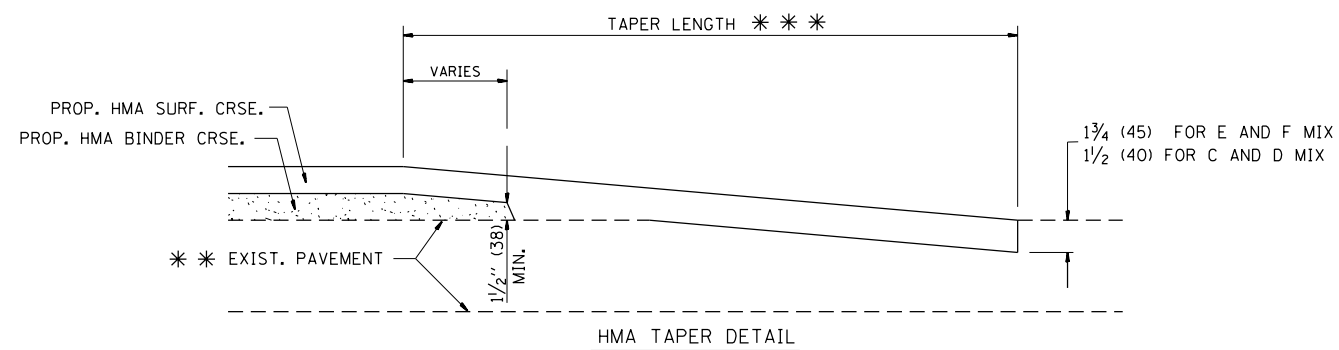

HMA TAPER DETAIL

TYPICAL BUTT JOINT AND HMA TAPER FOR RESURFACING ONLY

*** PC CONCRETE, HMA OR HMA RESURFACED PAVEMENT.

NOTES

- A: MAINLINE ROADWAYS AND MAJOR SIDE ROADS.
 - B: MINOR SIDE ROADS.
 - C: THE TEMP. RAMP SHALL BE CONSTRUCTED IMMEDIATELY UPON REMOVAL OF THE EXISTING HMA SURFACE.
 - D: THE BUTT JOINT SHALL BE CONSTRUCTED IMMEDIATELY PRIOR TO PLACING THE PROPOSED HMA COURSES.
 - E: TAPER THE TEMP. RAMP AT A RATE OF 3'-0" (900 mm) PER 1 INCH (25 mm) OF MILLING THICKNESS.
 - F: INSTALLATION AND REMOVAL OF THE 4'-6" (1.35 m) TEMP. RAMP IS INCLUDED IN COST OF HMA SURFACE REMOVAL - BUTT JOINT
 - G: SEE ARTICLE 406.08 AND 406.14 OF THE STANDARD SPECIFICATIONS FOR "HMA AND/OR PCC SURFACE REMOVAL, BUTT JOINT".
- * SEE TYPICAL SECTIONS FOR MILLING THICKNESS.
- *** 20'-0" (6.1 m) PER 1 (25) RESURFACING (NOTE "A")
10'-0" (3.0 m) PER 1 (25) RESURFACING (NOTE "B")

BASIS OF PAYMENT:

THE BUTT JOINT WILL BE PAID FOR AT THE CONTRACT UNIT PRICE PER SQUARE YARD (SQUARE METER) FOR "HOT-MIX ASPHALT SURFACE REMOVAL - BUTT JOINT" OR FOR "PORTLAND CEMENT CONCRETE SURFACE REMOVAL - BUTT JOINT".

ALL DIMENSIONS ARE IN INCHES (MILLIMETERS) UNLESS OTHERWISE SHOWN.

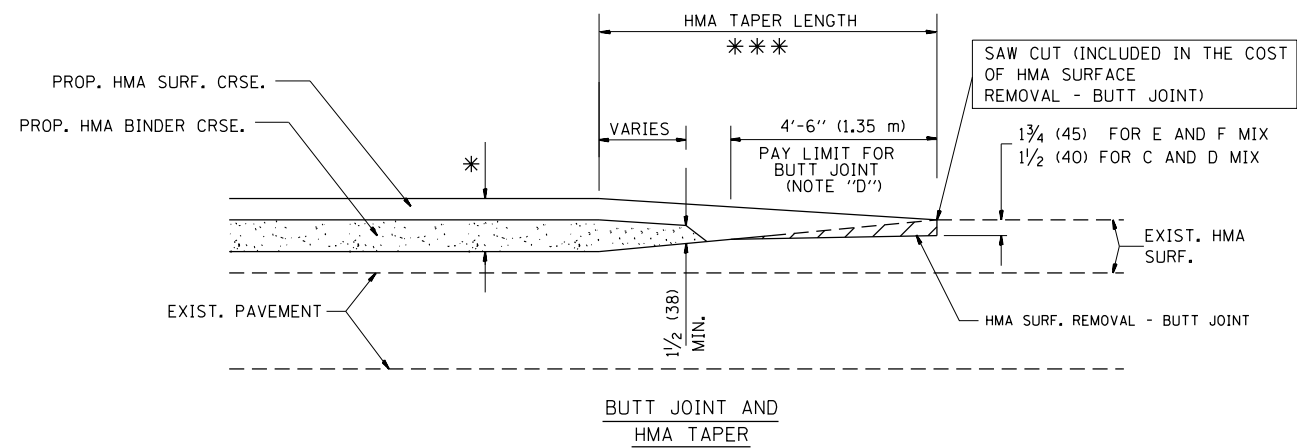

TYPICAL BUTT JOINT AND HMA TAPER FOR MILLING AND RESURFACING

FILE NAME =	USER NAME = shiranisb	DESIGNED - M. DE YONG	REVISED - R. SHAH 10-25-94	STATE OF ILLINOIS DEPARTMENT OF TRANSPORTATION	BUTT JOINT AND HMA TAPER DETAILS			HSB	SECTION	COUNTY	TOTAL SHEETS	SHEET NO.
pw\1\084EBIDINTEG.illinois.gov\PIWIDOT\Documents\IDOT Offices\District 1\Projects\DI353\BROWNS\Design\DistStd.dgn	PLotted SCALE = 100.0000' / in.	CHECKED -	REVISED - A. ABBAS 03-21-97					0275	2018-057-RS	WILL	17	11
PLotted DATE = 8/15/2018	DATE - 06-13-90	REVISED - M. GOMEZ 04-06-01	REVISED - R. BORO 01-01-07					BD400-05 BD32			CONTRACT NO. 62G91	
								SCALE: NONE		SHEET NO. 1 OF 1 SHEETS		STA. TO STA.

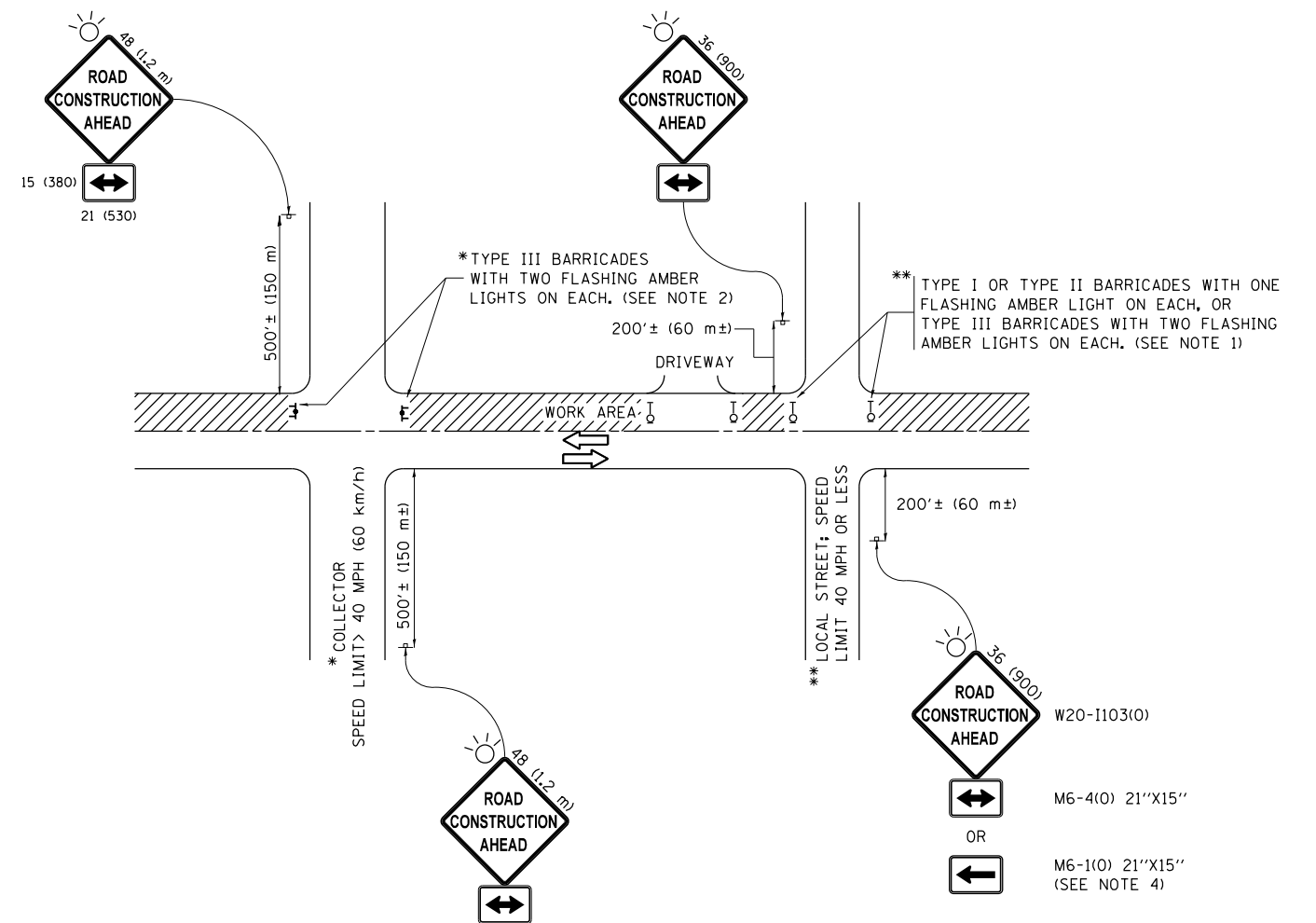

NOTES:

1. SIDE ROAD WITH A SPEED LIMIT OF 40 MPH (60 km/h) OR LESS AS SHOWN ON THE DRAWING AND AS DIRECTED BY THE ENGINEER:
 - a) ONE "ROAD CONSTRUCTION AHEAD" SIGN 36 x 36 (900x900) WITH A FLASHER MOUNTED ON IT APPROXIMATELY 200' (60 m) IN ADVANCE OF THE MAIN ROUTE.
 - b) THE CLOSED PORTION OF THE MAIN ROUTE SHALL BE PROTECTED BY BLOCKING WITH TYPE I, TYPE II OR TYPE III BARRICADES, 1/3 OF THE CROSS SECTION OF THE CLOSED PORTION.
2. SIDE ROAD WITH A SPEED LIMIT GREATER THAN 40 MPH (60 km/h) AS SHOWN ON THE DRAWING AND AS DIRECTED BY THE ENGINEER:
 - a) ONE "ROAD CONSTRUCTION AHEAD" SIGN 48 x 48 (1.2 m x 1.2 m) WITH A FLASHER MOUNTED ON IT APPROXIMATELY 500' (150 m) IN ADVANCE OF THE MAIN ROUTE.
 - b) THE CLOSED PORTION OF THE MAIN ROUTE SHALL BE PROTECTED BY BLOCKING WITH TYPE III BARRICADES, 1/2 OF THE CROSS SECTION OF THE CLOSED PORTION.
3. CONES MAY BE SUBSTITUTED FOR BARRICADES OR DRUMS AT HALF THE SPACING DURING DAY OPERATIONS. CONES SHALL BE A MINIMUM OF 28 (710) IN HEIGHT.
4. WHEN THE SIDE ROAD LIES BETWEEN THE BEGINNING OF THE MAINLINE SIGNING AND THE WORK ZONE, A SINGLE HEADED ARROW (M6-1) SHALL BE USED IN LIEU OF THE DOUBLE HEADED ARROW (M6-4).
5. WHEN WORK IS BEING PERFORMED ON A SIDE ROAD OR DRIVEWAY, FOLLOW THE APPLICABLE STANDARD(S). THE DIRECTIONAL ARROW (M6-1 OR M6-4) SHALL BE COVERED OR REMOVED WHEN NO LONGER CONSISTENT WITH THE TRAFFIC CONTROL SET-UP.
6. ADVANCE WARNING SIGNS ARE TO BE OMITTED ON DRIVEWAYS UNLESS OTHERWISE SPECIFIED IN THE PLANS OR BY THE ENGINEER.
7. THE TRAFFIC CONTROL AND PROTECTION FOR SIDE ROADS, INTERSECTIONS, AND DRIVEWAYS SHALL BE INCLUDED IN THE COST OF SPECIFIED TRAFFIC CONTROL STANDARDS OR ITEMS.

All dimensions are in inches (millimeters) unless otherwise shown.

FILE NAME =	USER NAME = shiranisb	DESIGNED - L.H.A.	REVISED - A. HOUSEH 10-15-96
p:\11084EBIDINTEG\Illinois.gov\PIWIDOT\Documents\IDOT Offices\District 1\Projects\DI353\Drawings\Design\DistStd.dgn			REVISED - T. RAMMACHER 01-06-00
Default	PLOT SCALE = 100.0000' / in.	CHECKED -	REVISED - A. SCHUETZE 07-01-13
	PLOT DATE = 8/15/2018	DATE - 06-89	REVISED - A. SCHUETZE 09-15-16

**STATE OF ILLINOIS
DEPARTMENT OF TRANSPORTATION**

**TRAFFIC CONTROL AND PROTECTION FOR
SIDE ROADS, INTERSECTIONS, AND DRIVEWAYS**

SCALE: NONE SHEET 1 OF 1 SHEETS STA. TO STA.

HSB RTE.	SECTION	COUNTY	TOTAL SHEETS	SHEET NO.
0275	2018-057-RS	WILL	17	12
TC-10			CONTRACT NO. 62G91	
ILLINOIS FED. AID PROJECT				

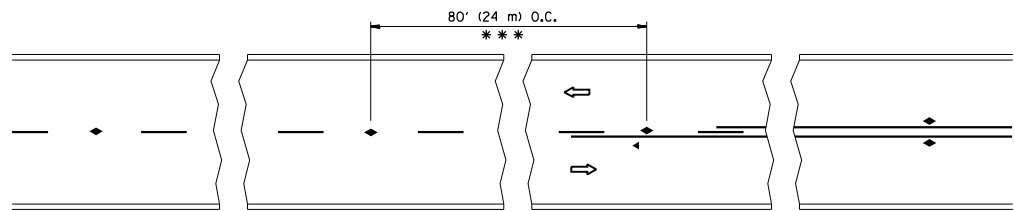

*** REDUCE TO 40' (12 m) O.C. ON CURVES WITH POSTED OR ADVISORY SPEED 45 M.P.H. (70 km/h) OR LESS.

TWO-LANE/TWO-WAY

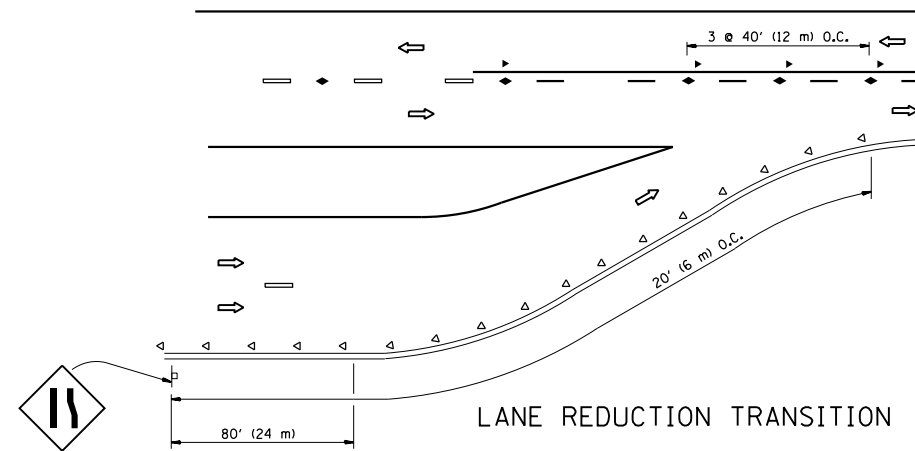

LANE REDUCTION TRANSITION

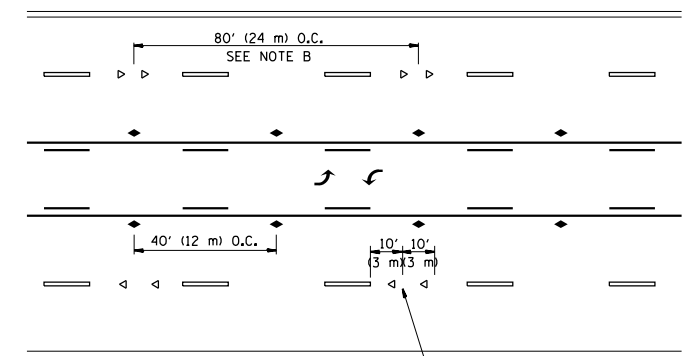

TWO-WAY LEFT TURN

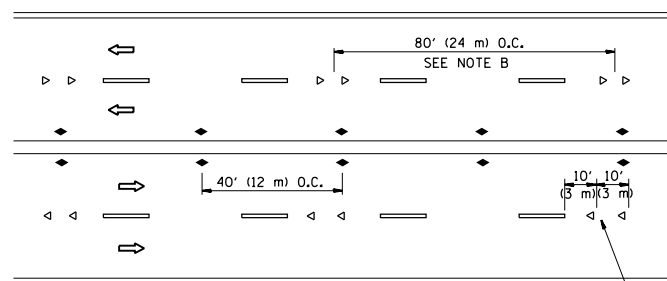

MULTI-LANE/UNDIVIDED

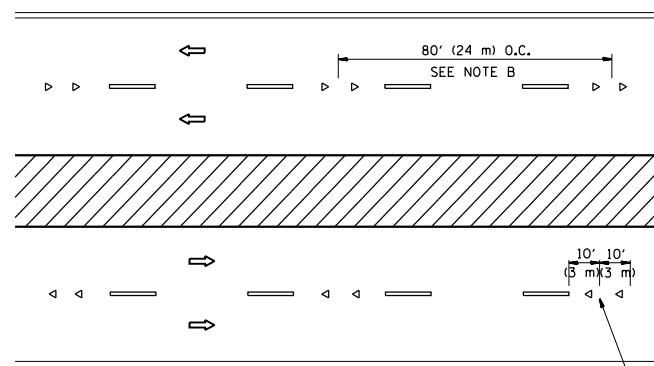

MULTI-LANE/DIVIDED

GENERAL NOTES

1. MARKERS USED WITH DASHED LINES SHALL BE CENTERED IN THE GAP BETWEEN SEGMENTS.
2. MARKERS USED ADJACENT TO SOLID LINES SHALL BE OFFSET 2 TO 3 (50 TO 75) TOWARD TRAFFIC AS SHOWN.
3. MARKERS THROUGH TANGENTS LESS THAN 500' (150 m) IN LENGTH BETWEEN CURVES SHALL BE INSTALLED AT THE LESSER OF THE TWO CURVE SPACINGS.

SYMBOLS

- YELLOW STRIPE
- WHITE STRIPE
- ◀ ONE-WAY AMBER MARKER
- ◁ ONE-WAY CRYSTAL MARKER (W/O)
- ◆ TWO-WAY AMBER MARKER

LANE MARKER NOTES

- A. USE DOUBLE LANE LINE MARKERS SPACED AS SHOWN.
- B. REDUCE TO 40' (12 m) O.C. ON CURVES WHERE ADVISORY SPEEDS ARE 10 M.P.H (20 km/h) LOWER THAN POSTED SPEEDS.

DESIGN NOTES

1. DOUBLE LANE LINE MARKERS SHALL BE USED UNLESS SPECIFIED OTHERWISE.
2. EXCEPT AS SHOWN ON THE LANE REDUCTION TRANSITION AND FREEWAY EXIT RAMP DETAIL, MARKERS ARE NOT TO BE SPECIFIED ON RIGHT EDGE LINES.
3. THE EXACT MARKER LIMITS, SPACING, AND COLOR SHALL BE INCLUDED IN THE PLANS WHEN STANDARD SPECIFICATIONS ARE NOT BEING USED.
4. MARKERS SHOULD NOT BE USED ALONGSIDE CURBS EXCEPT FOR EXTREMELY SHORT SECTIONS OF CURBS WHERE NOT MORE THAN TWO MARKERS WOULD BE INVOLVED.

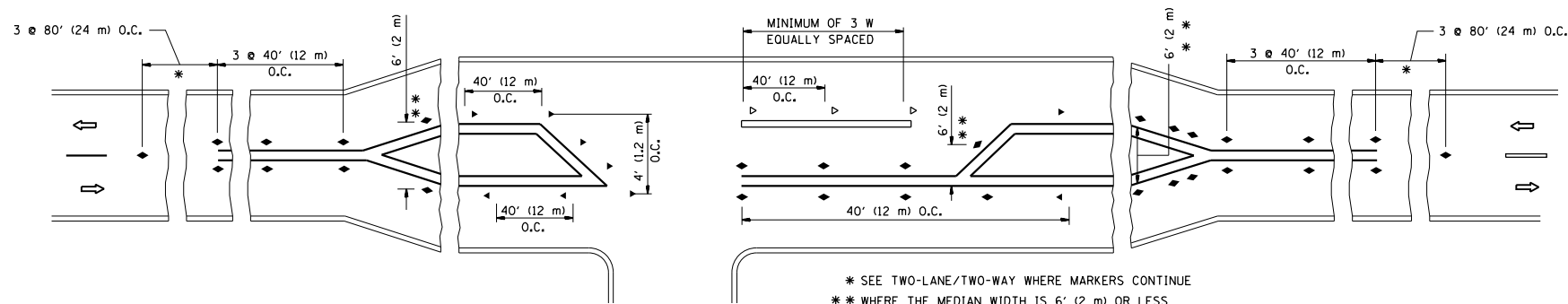

LEFT TURN

* SEE TWO-LANE/TWO-WAY WHERE MARKERS CONTINUE
 ** WHERE THE MEDIAN WIDTH IS 6' (2 m) OR LESS USE TWO-WAY MARKERS.

All dimensions are in inches (millimeters) unless otherwise shown.

FILE NAME =	USER NAME = shiranisb	DESIGNED -	REVISED - T. RAMMACHER 09-19-94
pw:\IL\084EBIDINTEG\illinois.gov\PIWIDOT\Documents\IDOT Offices\District 1\Projects\DI353\Browns\Design\DistStd.dgn		CHECKED -	REVISED - T. RAMMACHER 03-12-99
		DATE -	REVISED - T. RAMMACHER 01-06-00
			REVISED - C. JUCIUS 09-09-09

STATE OF ILLINOIS
 DEPARTMENT OF TRANSPORTATION

TYPICAL APPLICATIONS			
RAISED REFLECTIVE PAVEMENT MARKERS (SNOW-PLOW RESISTANT)			
SCALE: NONE	SHEET NO. 1 OF 1 SHEETS	STA.	TO STA.

HSB RTE.	SECTION	COUNTY	TOTAL SHEETS	SHEET NO.
0275	2018-057-RS	WILL	17	13
TC-11			CONTRACT NO. 62G91	
FED. ROAD DIST. NO. 1 ILLINOIS FED. AID PROJECT				

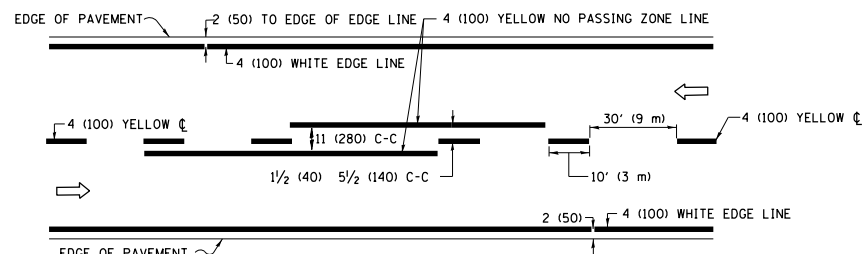

2-LANE ROADWAY

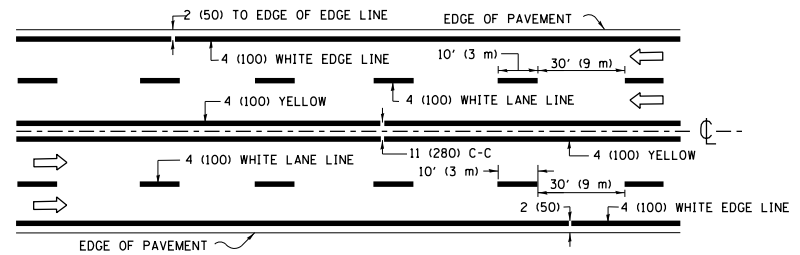

MULTI-LANE UNDIVIDED

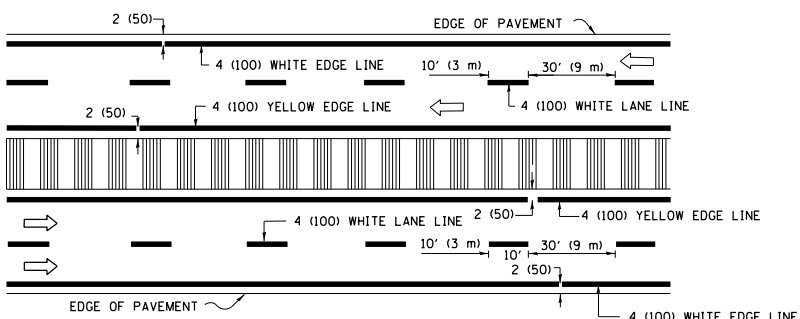

MULTI-LANE DIVIDED WITH MEDIAN

TYPICAL LANE AND EDGE LINE MARKING

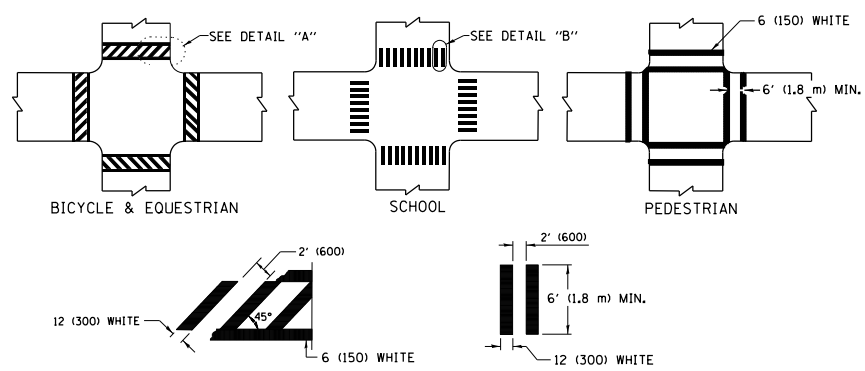

TYPICAL CROSSWALK MARKING

* MARKINGS SHALL BE INSTALLED PARALLEL TO THE CENTERLINE OF THE ROAD WHICH IT CROSSES

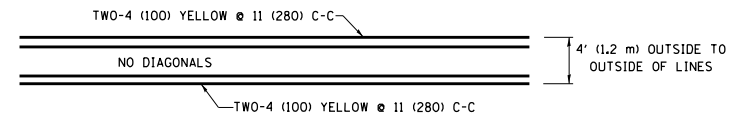

4' (1.2 m) WIDE MEDIANS ONLY

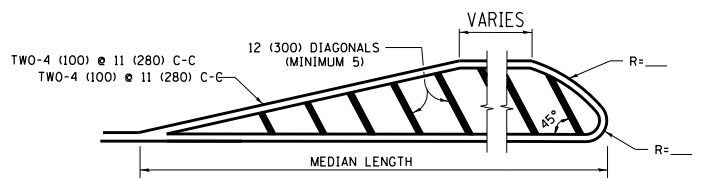

MEDIANS OVER 4' (1.2 m) WIDE

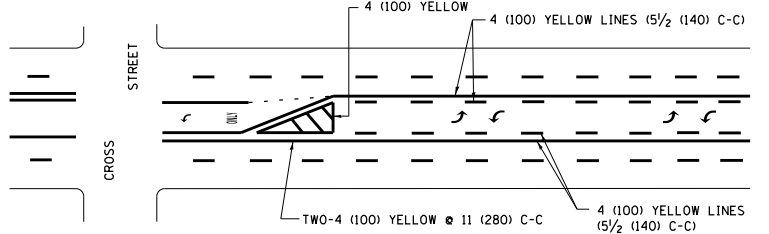

MEDIAN WITH TWO-WAY LEFT TURN LANE TYPICAL PAINTED MEDIAN MARKING

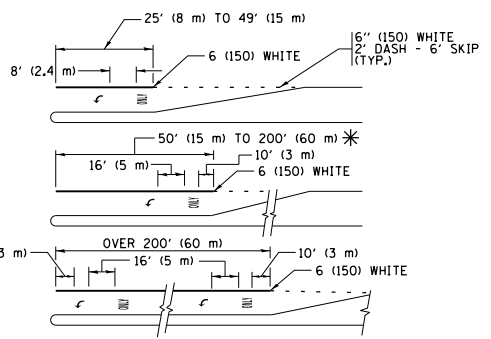

TYPICAL LEFT (OR RIGHT) TURN LANE TYPICAL TURN LANE MARKING

FULL SIZE LETTERS 8' (2.4 m) AND ARROWS SHALL BE USED. AREA = 15.6 SQ. FT. (1.5 m²) ONLY AREA = 20.8 SQ. FT. (1.9 m²)

* TURN LANES IN EXCESS OF 400' (120 m) IN LENGTH MAY HAVE AN ADDITIONAL SET OF ARROW - "ONLY" INSTALLED MIDWAY BETWEEN THE OTHER TWO SETS OF ARROW - "ONLY".

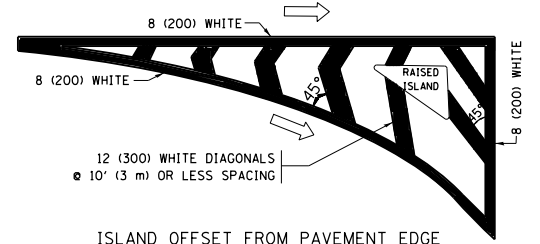

ISLAND OFFSET FROM PAVEMENT EDGE

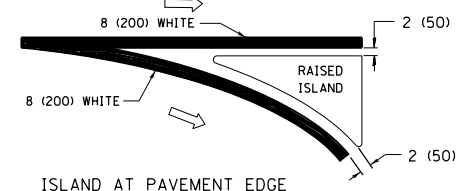

ISLAND AT PAVEMENT EDGE TYPICAL ISLAND MARKING

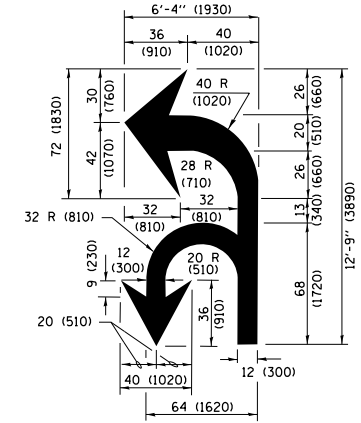

COMBINATION LEFT AND U-TURN

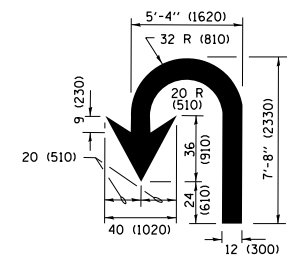

U-TURN

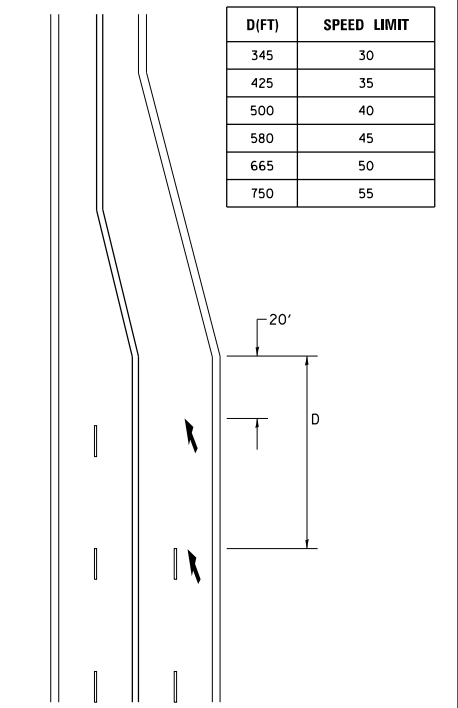

LANE REDUCTION TRANSITION
* LANE REDUCTION ARROWS REQUIRED AT SPEEDS OF 45 MPH OR GREATER OR WHEN SPECIFIED IN PLANS.

TYPE OF MARKING	WIDTH OF LINE	PATTERN	COLOR	SPACING /REMARKS
CENTERLINE ON 2 LANE PAVEMENT	4 (100)	SKIP-DASH	YELLOW	10' (3 m) LINE WITH 30' (9 m) SPACE
CENTERLINE ON MULTI-LANE UNDIVIDED PAVEMENT	2 @ 4 (100)	SOLID	YELLOW	11 (280) C-C
NO PASSING ZONE LINES FOR ONE DIRECTION FOR BOTH DIRECTIONS	4 (100) 2 @ 4 (100)	SOLID SOLID	YELLOW YELLOW	5 1/2 (140) C-C FROM SKIP-DASH CENTERLINE 11 (280) C-C OMIT SKIP-DASH CENTERLINE BETWEEN
LANE LINES	4 (100) 5 (125) ON FREEWAYS	SKIP-DASH SKIP-DASH	WHITE WHITE	10' (3 m) LINE WITH 30' (9 m) SPACE
DOTTED LINES (EXTENSIONS OF CENTER, LANE OR TURN LANE MARKINGS)	SAME AS LINE BEING EXTENDED	SKIP-DASH	SAME AS LINE BEING EXTENDED	2' (600) LINE WITH 6' (1.8 m) SPACE
EDGE LINES	4 (100)	SOLID	YELLOW-LEFT WHITE-RIGHT	OUTLINE MEDIANS IN YELLOW
TURN LANE MARKINGS	6 (150) LINE; FULL SIZE LETTERS & SYMBOLS (8' (2.4m))	SOLID	WHITE	SEE TYPICAL TURN LANE MARKING DETAIL
TWO WAY LEFT TURN MARKING	2 @ 4 (100) EACH DIRECTION 8' (2.4m) LEFT ARROW	SKIP-DASH AND SOLID IN PAIRS	YELLOW WHITE	10' (3 m) LINE WITH 30' (9 m) SPACE FOR SKIP-DASH 5 1/2 (140) C-C BETWEEN SOLID LINE AND SKIP-DASH LINE SEE TYPICAL TWO-WAY LEFT TURN MARKING DETAIL
CROSSWALK LINES (PEDESTRIAN) A. DIAGONALS (BIKE & EQUESTRIAN) B. LONGITUDINAL BARS (SCHOOL)	2 @ 6 (150) 12 (300) @ 45° 12 (300) @ 90°	SOLID SOLID SOLID	WHITE WHITE WHITE	NOT LESS THAN 6' (1.8 m) APART 2' (600) APART 2' (600) APART SEE TYPICAL CROSSWALK MARKING DETAILS.
STOP LINES	24 (600)	SOLID	WHITE	PLACE 4' (1.2 m) IN ADVANCE OF AND PARALLEL TO CROSSWALK, IF PRESENT, OTHERWISE, PLACE AT DESIRED STOPPING POINT, PARALLEL TO CROSSROAD CENTERLINE, WHERE POSSIBLE.
PAINTED MEDIANS	2 @ 4 (100) WITH 12 (300) DIAGONALS @ 45° NO DIAGONALS USED FOR 4' (1.2 m) WIDE MEDIANS	SOLID	YELLOW; TWO WAY TRAFFIC WHITE; ONE WAY TRAFFIC	11 (280) C-C FOR THE DOUBLE LINE SEE TYPICAL PAINTED MEDIAN MARKING.
GORE MARKING AND CHANNELIZING LINES	8 (200) WITH 12 (300) DIAGONALS @ 45°	SOLID	WHITE	DIAGONALS: 15' (4.5 m) C-C (LESS THAN 30MPH (50 km/h)) 20' (6 m) C-C 30MPH (50 km/h) TO 45MPH (70 km/h) 30' (9 m) C-C (OVER 45MPH (70 km/h))
RAILROAD CROSSING	24 (600) TRANSVERSE LINES; "RR" IS 6' (1.8 m) LETTERS; 16 (400) LINE FOR "X"	SOLID	WHITE	SEE STATE STANDARD 780001 AREA OF: "R"=3.6 SQ. FT. (0.33 m ²) EACH "X"=54.0 SQ. FT. (5.0 m ²)
SHOULDER DIAGONALS (REQUIRED FOR SHOULDERS ≥ 8')	12 (300) @ 45°	SOLID	WHITE - RIGHT YELLOW - LEFT	50' (15 m) C-C (LESS THAN 30MPH (50 km/h)) 75' (25 m) C-C (30 MPH (50 km/h) TO 45MPH (70 km/h)) 150' (45 m) C-C (OVER 45MPH (70 km/h))
U TURN ARROW	SEE DETAIL	SOLID	WHITE	16.3 SF
2 ARROW COMBINATION LEFT AND U TURN	SEE DETAIL	SOLID	WHITE	30.4 SF

FOR FURTHER DETAILS ON PAVEMENT MARKING REFER TO STANDARD SPECIFICATIONS FOR ROAD AND BRIDGE CONSTRUCTION AND STATE STANDARD 780001.

All dimensions are in inches (millimeters) unless otherwise shown.

FILE NAME =	USER NAME = shiranisb	DESIGNED - EVERS	REVISED - C. JUCIUS 09-09-09
p:\1\084EBIDINTEG\Illinois.gov\PIW001\Documents\DOT Offices\District 1\Projects\01353\01353\01353\01353\Design\DistStd.dgn		CHECKED -	REVISED - C. JUCIUS 07-01-13
Default	PLOT SCALE = 100.0000' / in.	DATE - 03-19-90	REVISED - C. JUCIUS 12-21-15
	PLOT DATE = 8/15/2018		REVISED - C. JUCIUS 04-12-16

STATE OF ILLINOIS DEPARTMENT OF TRANSPORTATION

DISTRICT ONE		HSB RTE.	SECTION	COUNTY	TOTAL SHEETS	SHEET NO.
TYPICAL PAVEMENT MARKINGS		0275	2018-057-RS	WILL	17	14
SCALE: NONE		TC-13		CONTRACT NO. 62G91		
SHEET 1	OF 1 SHEETS	STA.	TO STA.	ILLINOIS FED. AID PROJECT		

TURN BAY ENTRANCE AT START OF LANE CLOSURE TAPER

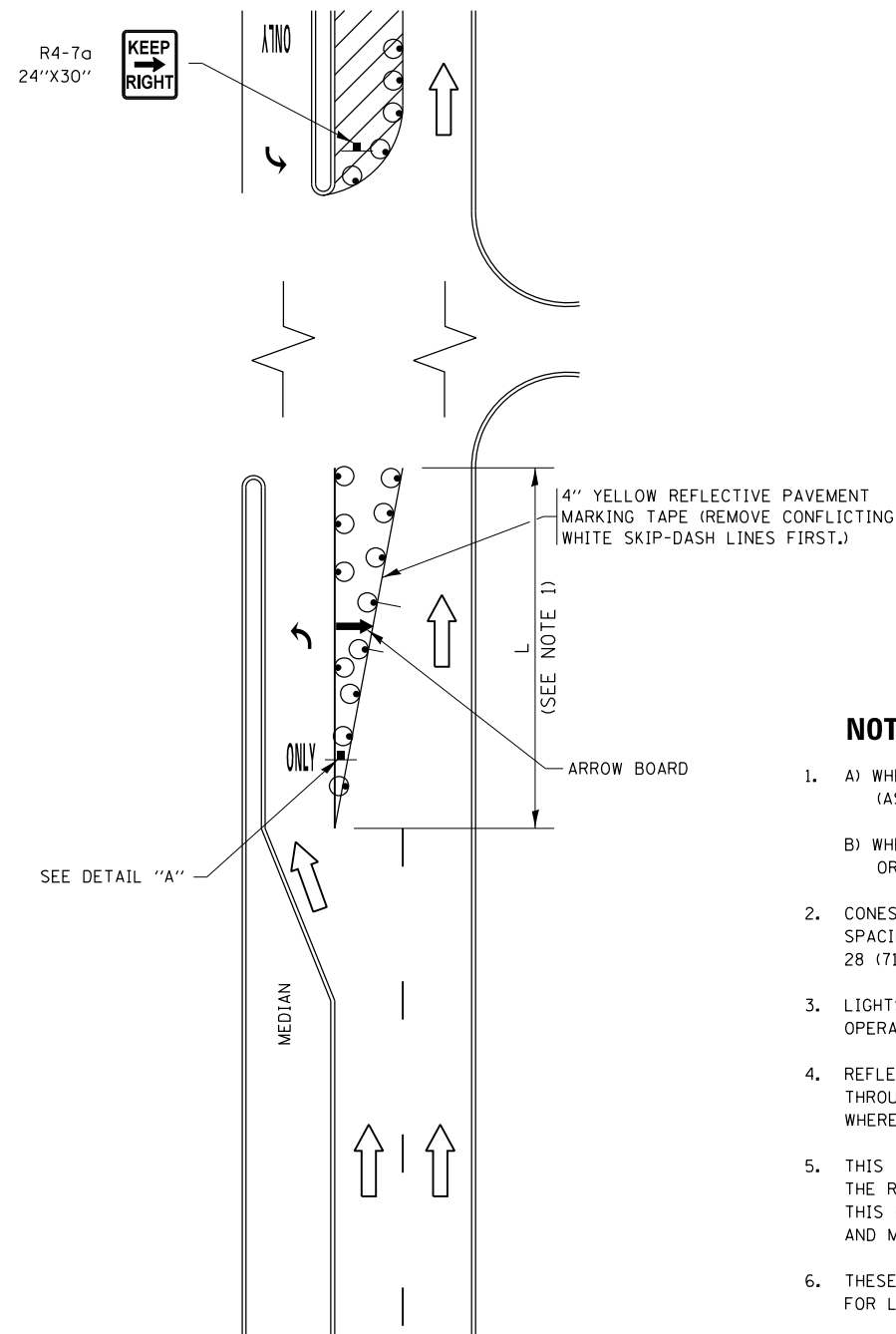

FIGURE 1

TURN BAY ENTRANCE WITHIN A LANE CLOSURE

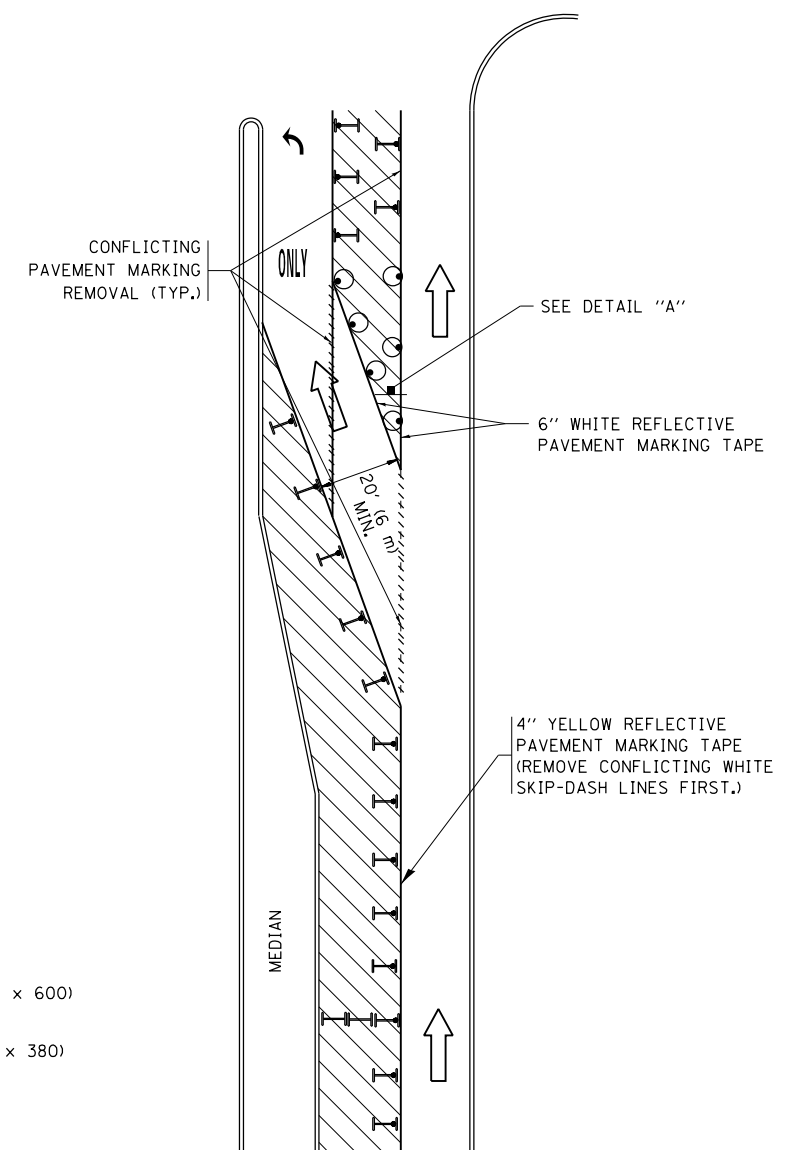
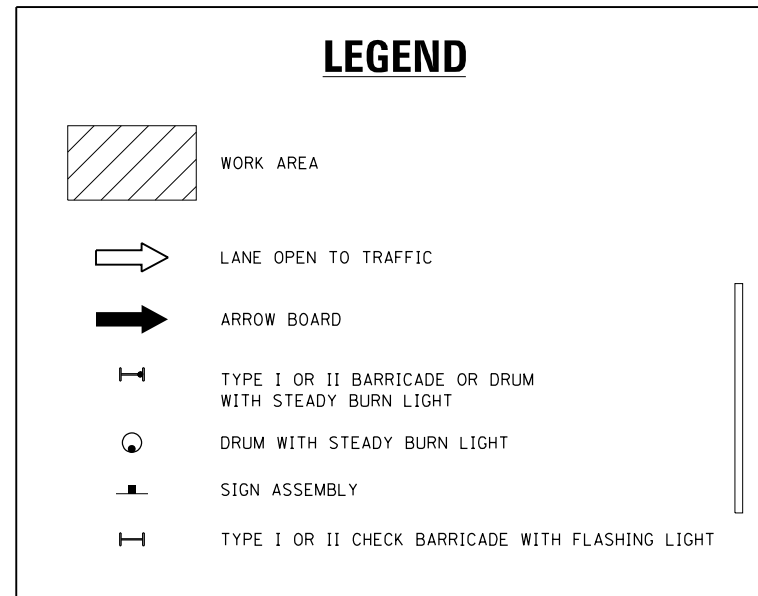
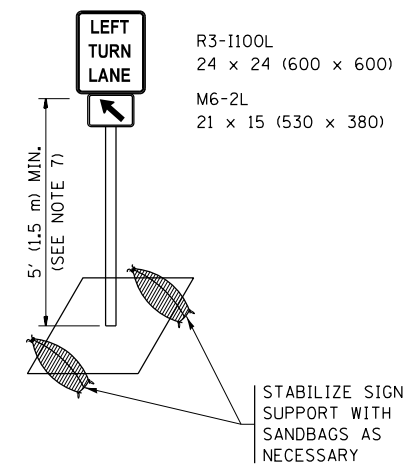

FIGURE 2



NOTES:

1. A) WHEN "L" IS \leq THE STORAGE LENGTH OF THE TURN LANE (AS SHOWN IN FIG. 1), USE FIGURE 1.
B) WHEN "L" IS $>$ THE STORAGE LENGTH OF THE TURN LANE OR THE TURN LANE IS WITHIN THE LANE CLOSURE, USE FIGURE 2.
2. CONES MAY BE SUBSTITUTED FOR BARRICADES OR DRUMS AT HALF THE SPACING DURING DAY OPERATIONS. CONES SHALL BE A MINIMUM OF 28 (710) IN HEIGHT.
3. LIGHTS WILL NOT BE REQUIRED ON BARRICADES OR DRUMS FOR DAY OPERATIONS. ALL LIGHTS SHALL BE MONODIRECTIONAL.
4. REFLECTIVE TEMPORARY PAVEMENT MARKINGS SHALL BE PLACED THROUGHOUT THE BARRICADED AREAS OF EACH TURN BAY AS SHOWN WHERE THE CLOSURE TIME IS GREATER THAN FOURTEEN (14) DAYS.
5. THIS APPLICATION ALSO APPLIES WHEN WORK IS BEING PERFORMED IN THE RIGHT LANE(S) AND THE RIGHT TURN BAY IS TO REMAIN OPEN. UNDER THIS CONDITION, "RIGHT TURN LANE" R3-I100R 24 x 24 (600 x 600) AND M6-2R 21 x 15 (530 x 380) SHALL BE USED.
6. THESE CONTROLS SHALL SUPPLEMENT MAINLINE TRAFFIC CONTROL FOR LANE CLOSURES.
7. THE SIGNS SHALL BE MOUNTED ABOVE THE BARRICADES/DRUMS ON SEPARATE SIGN SUPPORTS THAT MEET NCHRP 350 OR MASH PRE REQUIREMENTS.
8. TRAFFIC CONTROL AND PROTECTION AT TURN BAYS (TO REMAIN OPEN TO TRAFFIC) SHALL BE INCLUDED IN THE COST OF SPECIFIED TRAFFIC CONTROL STANDARDS OR ITEMS.



DETAIL A

All dimensions are in inches (millimeters) unless otherwise shown.

FILE NAME =	USER NAME = shiranisb	REVISED - T. RAMMACHER 09-08-94	REVISED - R. BORO 09-14-09	STATE OF ILLINOIS DEPARTMENT OF TRANSPORTATION	TRAFFIC CONTROL AND PROTECTION AT TURN BAYS (TO REMAIN OPEN TO TRAFFIC)	HSB RTE.	SECTION	COUNTY	TOTAL SHEETS	SHEET NO.
Default	PLOT SCALE = 100.0000' / 1in.	REVISED - A. HOUSEH 11-07-95	REVISED - A. SCHUETZE 07-01-13			0275	2018-057-RS	WILL	17	15
	PLOT DATE = 8/15/2018	REVISED - A. HOUSEH 10-12-96	REVISED - A. SCHUETZE 09-15-16			TC-14		CONTRACT NO. 62G91		
						ILLINOIS FED. AID PROJECT				

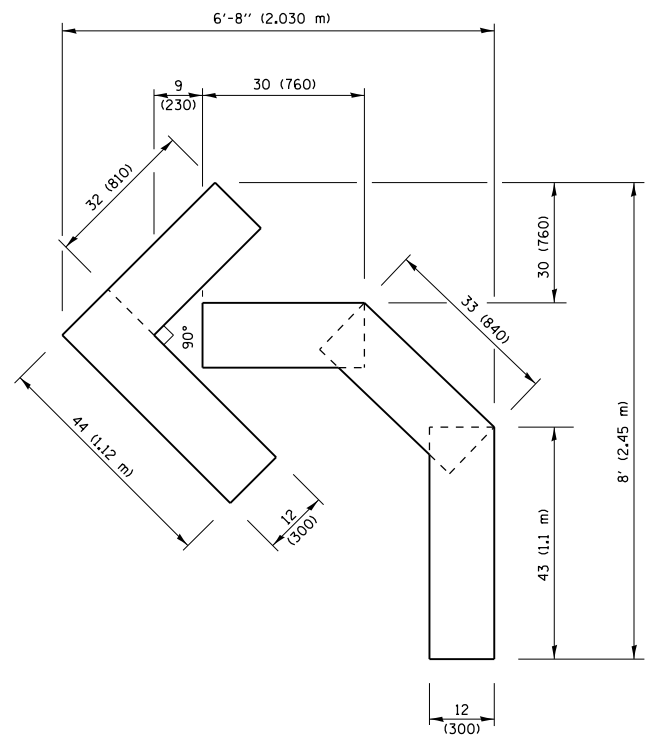

QUANTITY
 4 (100) LINE = 45.5 ft. (13.9 m)
 15.2 sq. ft. (1.41 sq. m)

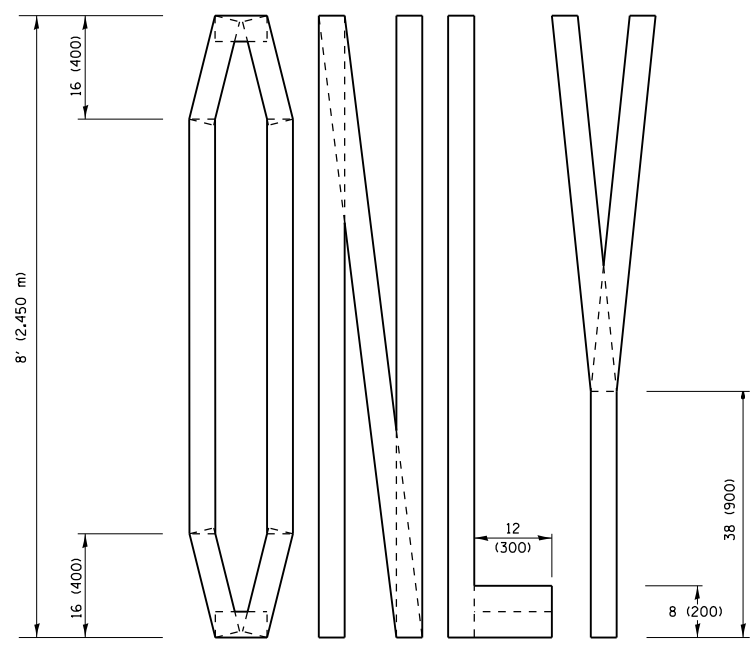
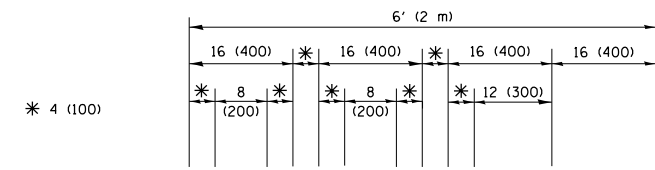

QUANTITY
 4 (100) LINE = 64.1 ft. (19.5 m)
 21.4 sq. ft. (1.99 sq. m)

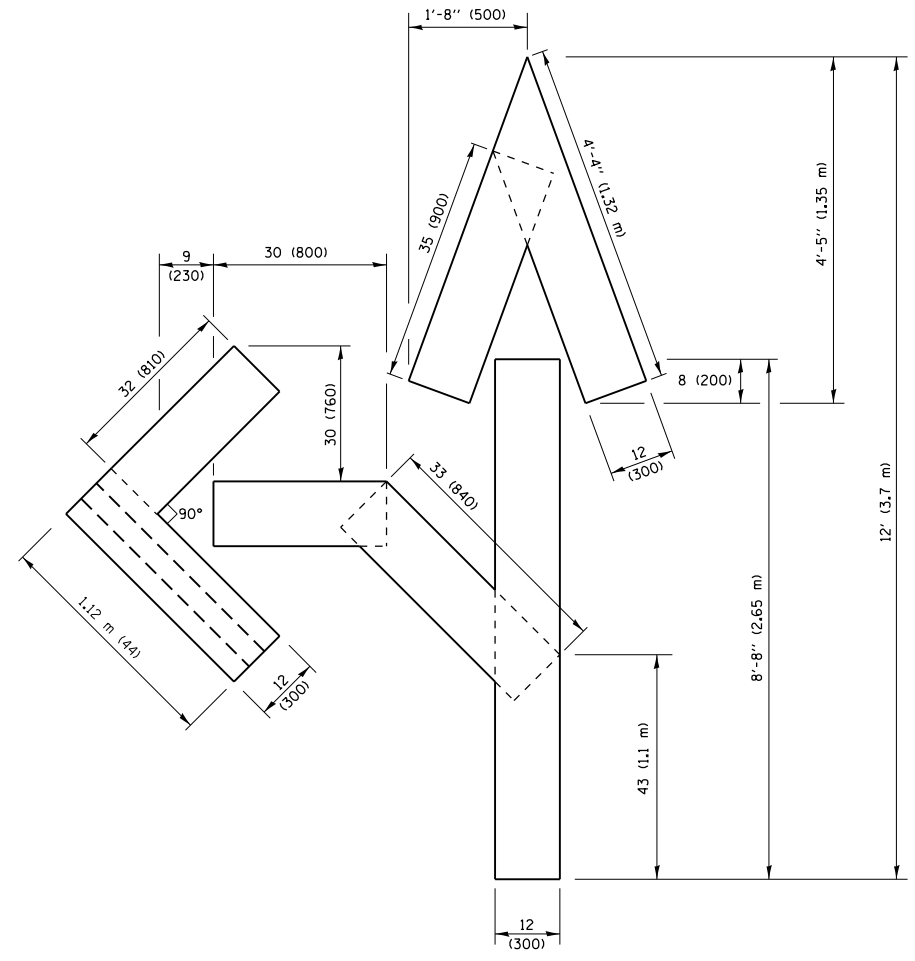

QUANTITY
 4 (100) LINE = 82.5 ft. (25.1 m)
 27.5 sq. ft. (2.53 sq. m)

NOTE:
 ALL QUANTITIES OF PLACEMENT ARE REPRESENTED IN LINEAR FEET OF 4" LINES TO MATCH THE 4" TEMPORARY TAPE PAY ITEM AND REPRESENTS THE TOTAL QUANTITY OF 4" TAPE REQUIRED.

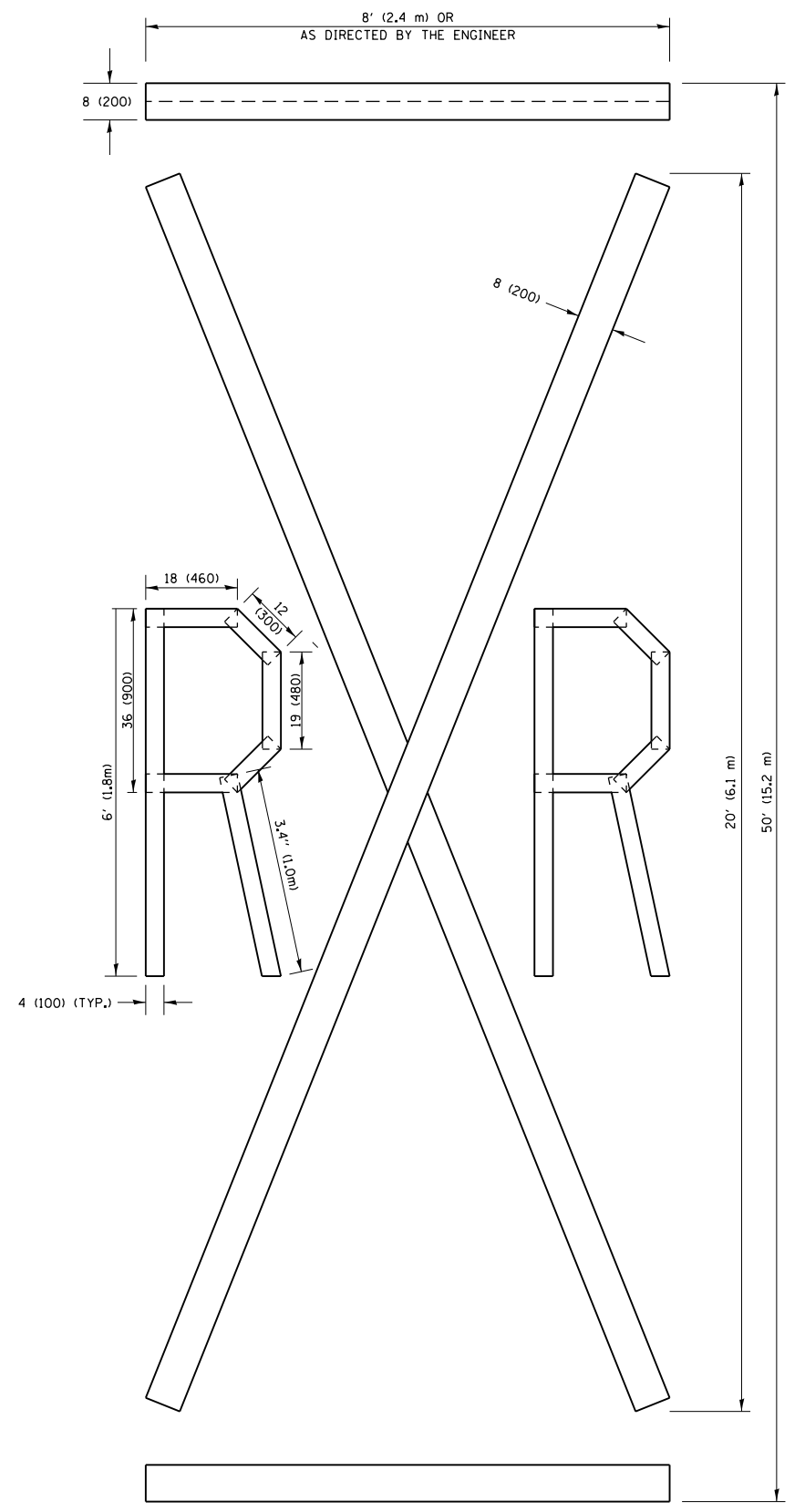

QUANTITY
 4 (100) LINE = 225.9 ft. (68.9 m)
 75.3 sq. ft. (6.99 sq. m)

All dimensions are in inches (millimeters) unless otherwise shown.

FILE NAME =	USER NAME = shiranisb	DESIGNED -	REVISED -T. RAMMACHER 03-02-98
p:\1\084EBIDINTEG.illinois.gov\PIWDDT\Documents\DOT Offices\District 1\Projects\01353\Drawings\Design\DistStd.dgn		CHECKED -	REVISED -E. GOMEZ 08-28-00
		DATE -	REVISED -E. GOMEZ 08-28-00
			REVISED -A. SCHUETZE 09-15-16

**STATE OF ILLINOIS
 DEPARTMENT OF TRANSPORTATION**

SHORT TERM PAVEMENT MARKING LETTERS AND SYMBOLS			
SCALE: NONE	SHEET NO. 1 OF 1 SHEETS	STA.	TO STA.

HSB RTE.	SECTION	COUNTY	TOTAL SHEETS	SHEET NO.
0275	2018-057-RS	WILL	17	16
TC-16		CONTRACT NO.	62G91	
FED. ROAD DIST. NO. 1 ILLINOIS FED. AID PROJECT				



NOTES:

1. USE BLACK LETTERING ON ORANGE BACKGROUND.
2. ERECT SIGNS IN ADVANCE OF THE LOCATION FOR THE "ROAD CONSTRUCTION AHEAD" SIGN AT LOCATIONS AS DIRECTED BY THE ENGINEER.
3. ERECT SIGN ① WITH INSTALLED PANEL ② ONE WEEK PRIOR TO THE START OF CONSTRUCTION.
4. REMOVE PANEL ② SOON AFTER THE START OF CONSTRUCTION.
5. SEE SPECIAL PROVISION FOR "TEMPORARY INFORMATION SIGNING" FOR ADDITIONAL INFORMATION.
6. ONE SIGN ASSEMBLY EQUALS 25.70 SQ. FT. (2.3 SQ. M.)
7. SHALL BE PAID FOR AS TEMPORARY INFORMATION SIGNING.

ALL DIMENSIONS ARE IN INCHES (MILLIMETERS) UNLESS OTHERWISE SHOWN.

FILE NAME =	USER NAME = shiranisb	DESIGNED -	REVISED - R. MIRS 09-15-97	STATE OF ILLINOIS DEPARTMENT OF TRANSPORTATION	ARTERIAL ROAD INFORMATION SIGN	SCALE: NONE	SHEET NO. 1 OF 1 SHEETS	STA.	TO STA.	HSB RTE.	SECTION	COUNTY	TOTAL SHEETS	SHEET NO.
p:\11\084EBIDINTEG.illinois.gov\PIWIDOT\Documents\DOT Offices\District 1\Projects\DI333\Drawings\Design\DistStd.dgn		CHECKED -	REVISED - R. MIRS 12-11-97			0275	2018-057-RS	WILL	17	17				
PLOT SCALE = 100.0000' / in.		DATE -	REVISED - T. RAMMACHER 02-02-99			TC-22		CONTRACT NO. 62G91						
PLOT DATE = 8/15/2018		REVISED - C. JUCIUS 01-31-07	<small>FED. ROAD DIST. NO. 1 ILLINOIS FED. AID PROJECT</small>											