

CONTRACT NO. 60C19

FAP NO.	SECTION	COUNTY	TOTAL SHEETS	SHEET NO.
338	114 BY-R-1	WILL	139	38A
STA.	3207+70	TO STA.	3213+30	
FED. ROAD DIST. NO.	ILLINOIS	FAP 338 (IL RTE. 59)		

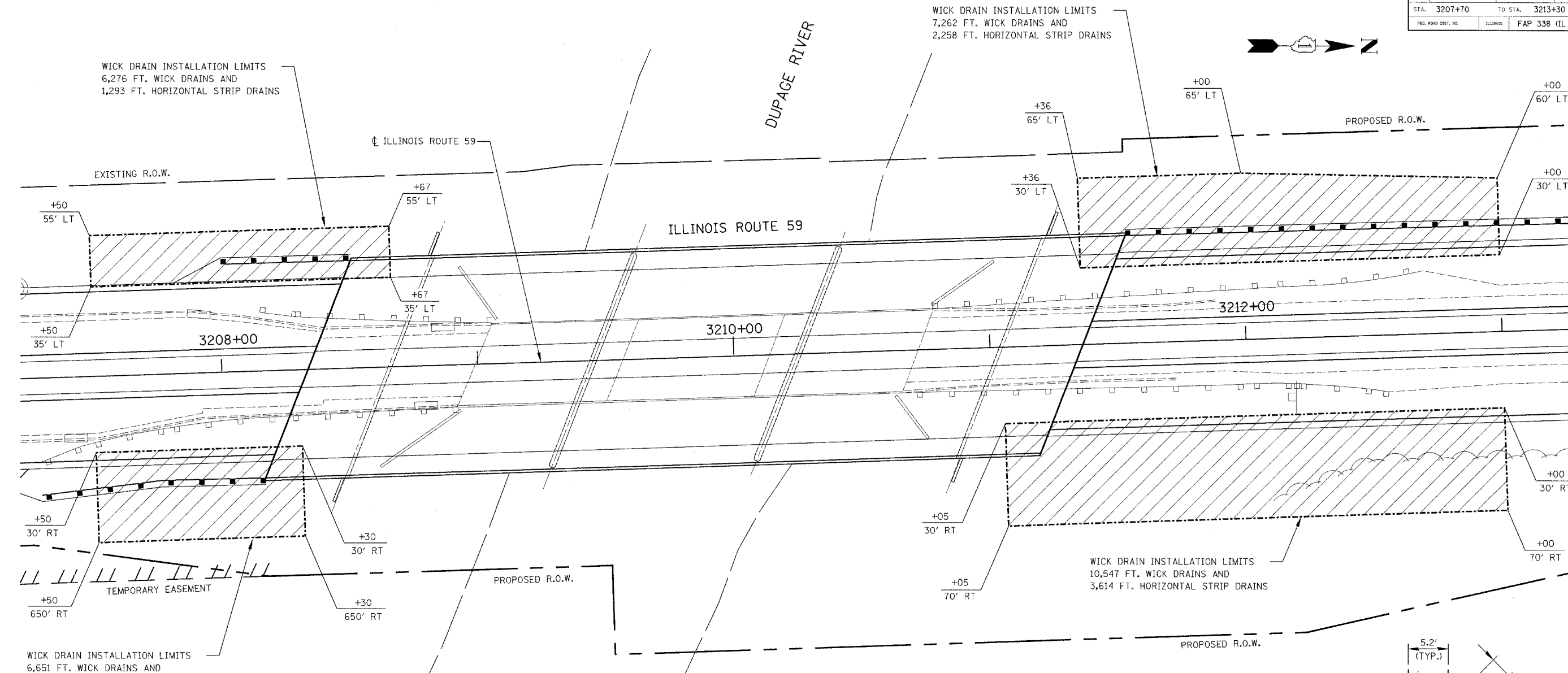

**NOTES:**

- VERTICAL WICK DRAINS SHALL BE INSTALLED IN AN EQUILATERAL TRIANGLE PATTERN AT THE SPACING SHOWN WITHIN THE LIMITS IDENTIFIED ON THIS SHEET. SEE WICK DRAIN LAYOUT ON THIS SHEET.
- A HORIZONTAL STRIP DRAIN SHALL BE INSTALLED PERPENDICULAR TO THE ILLINOIS ROUTE 59 CENTERLINE BETWEEN EVERY PAIR OF VERTICAL DRAIN ROWS TO CONVEY DISCHARGE TO THE DITCH AT THE TOE OF THE PROPOSED EMBANKMENT. STRIP DRAINS SHALL BE INSTALLED IN A MANNER AS TO PROVIDE FOR POSITIVE DRAINAGE AWAY FROM THE VERTICAL DRAIN.
- THE FIRST LIFT OF EMBANKMENT PLACED OVER THE HORIZONTAL STRIP DRAINS SHALL CONSIST OF FA-1 OR FA-2 SAND. THE SAND BLANKET SHALL BE INCLUDED IN THE COST FOR EMBANKMENT.
- EMBANKMENT MATERIAL MAY BE USED TO BUILD A CONSTRUCTION PLATFORM OVER SOFT SOILS IN THE GROUND IMPROVEMENT ZONE BEFORE INSTALLATION OF WICK DRAINS, HORIZONTAL STRIP DRAINS, AND SAND LAYER. EMBANKMENT MUST BE COMPACTED IN ACCORDANCE WITH ARTICLE 205.06 OF THE STANDARD SPECIFICATIONS.

EXCAVATION REQUIRED TO ESTABLISH CONSTRUCTION PLATFORM SHALL BE INCLUDED IN THE COST OF EXCAVATION.

- EXCAVATION REQUIRED TO ESTABLISH CONSTRUCTION PLATFORM SHALL BE INCLUDED IN THE COST OF EXCAVATION.
- VERTICAL WICK DRAIN INSTALLATION SHALL BE COORDINATED WITH STORM SEWER INSTALLATION.
- PAVING OF ILLINOIS ROUTE 59 SHALL NOT COMMENCE UNTIL INSTALLATION OF WICK DRAIN SYSTEM, COMPLETION OF EMBANKMENT AND SUBGRADE CONSTRUCTION, AND COMPLETION OF SETTLEMENT WAITING PERIOD OF 59 CALANDER DAYS.
- EACH WICK DRAIN SHALL BE INSTALLED TO ELEVATION 578.00 AFTER TOPSOIL AND VEGETATION REMOVAL, OR AS DIRECTED BY THE ENGINEER.

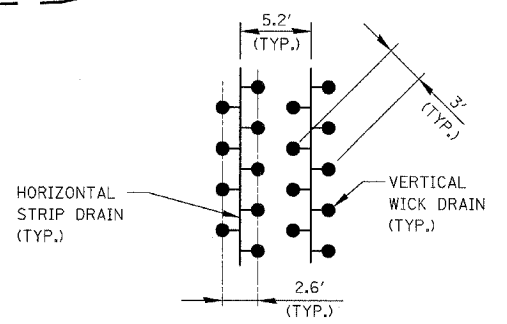
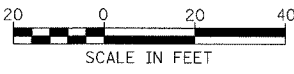

**WICK DRAIN LAYOUT**  
N.T.S.

REVISIONS	
NAME	DATE
ADDENDUM A	10-26-07

ILLINOIS DEPARTMENT OF TRANSPORTATION  
DISTRICT NO. 1 SCHAUMBURG

**WICK DRAIN PLAN**

SCALE AS SHOWN  
DATE OCTOBER 26, 2007  
DRAWN BY REW  
CHECKED BY JCM