

ILLINOIS ROUTE 59
PRE-STAGE 1

PA NO.	SECTION	COUNTY	TOTAL SHEETS	SHEET NO.
338	114 BY-R-1	WILL	139	119
STA. 3212+00		TO STA. 3215+00		
FED. ROAD DIST. NO.		ILLINOIS	FED. AID PROJECT	
CONTRACT NO. 60C19				

CROSS SECTION	SURVEYED	BY	DATE
SECTION	PLOTTED		
NOTE BOOK	RT. OF WAY CHECKED		
NO.	ADD FILE NAME		

CROSS SECTION	SURVEYED	BY	DATE
SECTION	PLOTTED		
NOTE BOOK	RT. OF WAY CHECKED		
NO.	ADD FILE NAME		

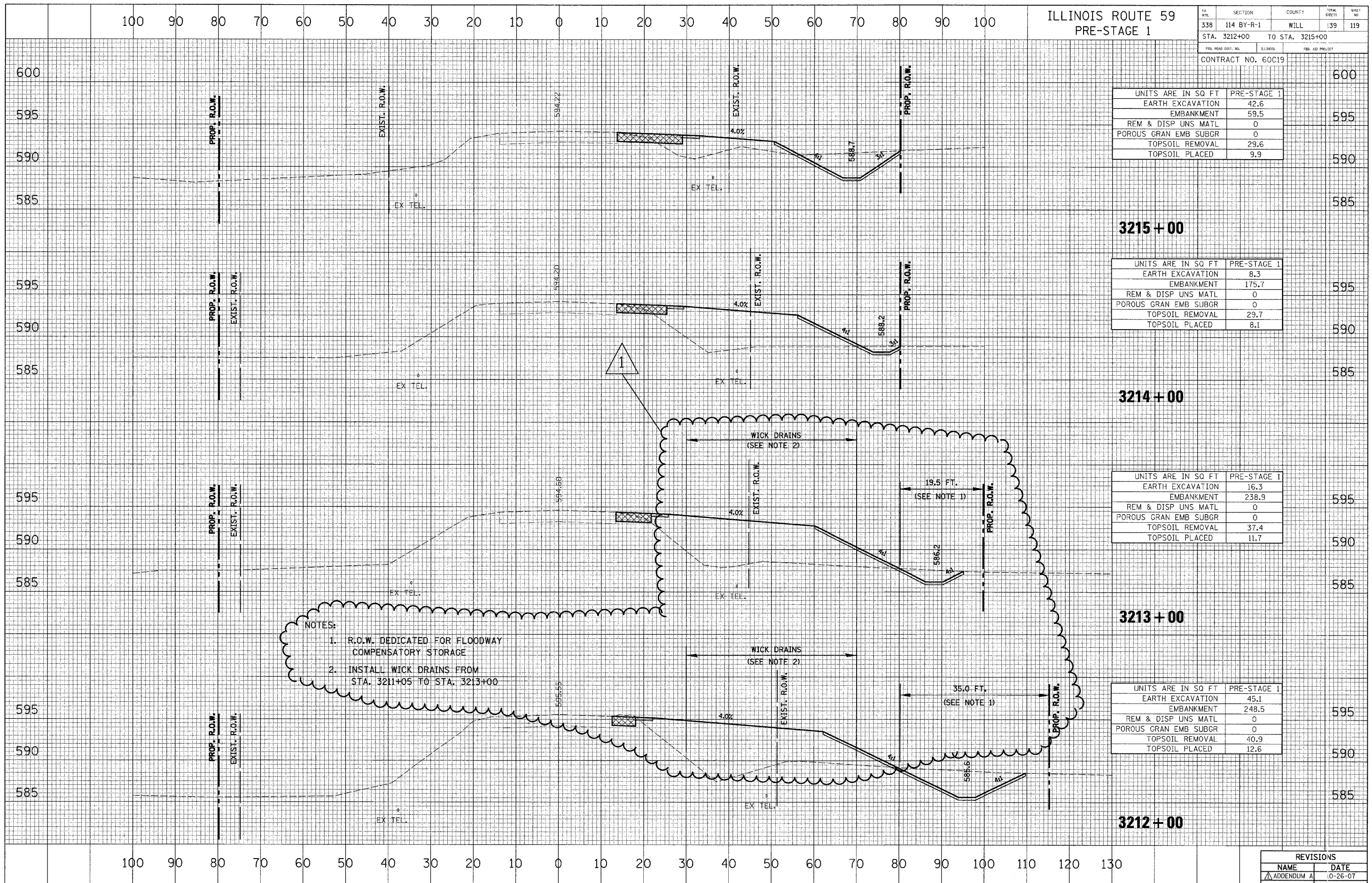

NOTES:
 1. R.O.W. DEDICATED FOR FLOODWAY COMPENSATORY STORAGE
 2. INSTALL WICK DRAINS FROM STA. 3211+05 TO STA. 3213+00

UNITS ARE IN SQ FT	PRE-STAGE 1
EARTH EXCAVATION	42.6
EMBANKMENT	59.5
REM & DISP UNS MATL	0
POROUS GRAN EMB SUBGR	0
TOPSOIL REMOVAL	29.6
TOPSOIL PLACED	9.9

UNITS ARE IN SQ FT	PRE-STAGE 1
EARTH EXCAVATION	8.3
EMBANKMENT	175.7
REM & DISP UNS MATL	0
POROUS GRAN EMB SUBGR	0
TOPSOIL REMOVAL	29.7
TOPSOIL PLACED	8.1

UNITS ARE IN SQ FT	PRE-STAGE 1
EARTH EXCAVATION	16.3
EMBANKMENT	238.9
REM & DISP UNS MATL	0
POROUS GRAN EMB SUBGR	0
TOPSOIL REMOVAL	37.4
TOPSOIL PLACED	11.7

UNITS ARE IN SQ FT	PRE-STAGE 1
EARTH EXCAVATION	45.1
EMBANKMENT	248.5
REM & DISP UNS MATL	0
POROUS GRAN EMB SUBGR	0
TOPSOIL REMOVAL	40.9
TOPSOIL PLACED	12.6

REVISIONS	
NAME	DATE
ADDENDUM A	10-26-07