

ROUTE	SECTION	COUNTY	TOTAL SHEETS	SHEET NUMBER
FAP 344	540 R-PCC-PP-1	COOK	19	1

FOR INDEX OF SHEETS SEE SHEET 2

STATE OF ILLINOIS
DEPARTMENT OF
TRANSPORTATION
DIVISION OF HIGHWAYS
DISTRICT ONE

$\frac{-5}{14}$

CONTRACT 60C41

D-91-210-07

PROPOSED HIGHWAY PLANS

FAP ROUTE 344: IL 83 (OAKTON ST.) *EASTBOUND LANES*
IL 72 (HIGGINS RD.) TO ELMHURST RD.
SECTION 540 R-PCC-PP-1
PCC PAVEMENT PATCHING
COOK COUNTY
C-91-210-07

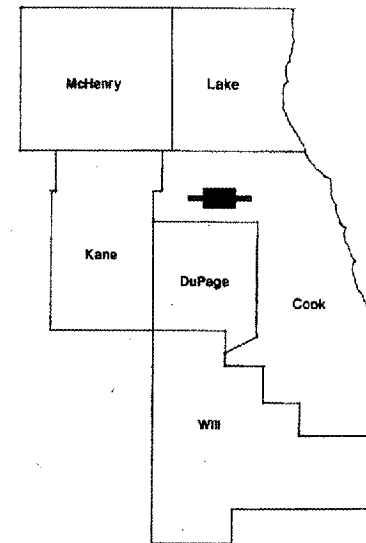

IMPROVEMENTS ARE
LOCATED IN THE VILLAGE OF
ELK GROVE

TRAFFIC DATA:
2006 ADT = 26900
SPEED LIMIT = 40 MPH

LOCATION OF IMPROVEMENT INDICATED THUS:

R11 E

IMPROVEMENT
BEGINS:
STATION 720+50 (EB)

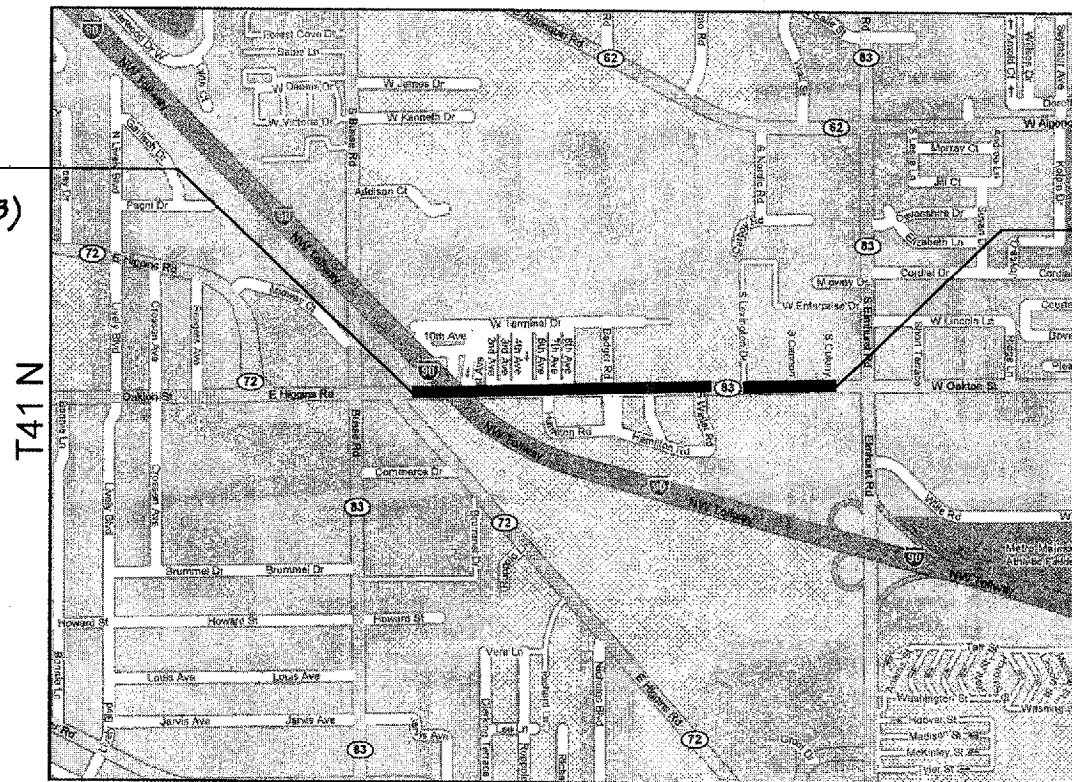

IMPROVEMENT
ENDS:
STATION 760+99 (EB)

T41 N

ELK GROVE TOWNSHIP

GROSS LENGTH OF IMPROVEMENT = 4049 FT = 0.77 MILES
NET LENGTH OF IMPROVEMENT = 4049 FT = 0.77 MILES

STATE OF ILLINOIS
DEPARTMENT OF TRANSPORTATION
DIVISION OF HIGHWAYS
SUBMITTED: August 29, 2007
Diane O'Keefe
DEPUTY DIRECTOR OF HIGHWAY, REGION ENGINEER
October 12, 2007
Eric E. Harm
INTERIM ENGINEER OF DESIGN AND ENVIRONMENT
October 12, 2007
Milton R. Sees P.E.
DIRECTOR, DIVISION OF HIGHWAYS

PRINTED BY THE AUTHORITY
OF THE STATE OF ILLINOIS

J.U.L.I.E.: JOINT UTILITY LOCATION
INFORMATION FOR EXCAVATION
(800) 892-0123

DISTRICT ONE BUREAU OF DESIGN
PLANPREP ENGINEER: KEN ENGR. BORO (847)705-4178

CONTRACT NO. 60C41

Rev.

ROUTE	SECTION	COUNTY	TOTAL SHEETS	SHEET NUMBER
FAP 344	540 R-PCC-PP-1	COOK	19	2

- 5
14

Contract 60C41

INDEX OF SHEETS

STATE STANDARDS

1	TITLE SHEET	420001-06 PAVEMENT JOINTS
2	INDEX OF SHEETS, STATE STANDARDS AND GENERAL NOTES	420101-03 7.2 M (24') JOINTED PCC PAVEMENT
3	GENERAL NOTES	420701-01 PAVEMENT FABRIC
4	SUMMARY OF QUANTITIES	442101-06 CLASS B PATCHING
5	TYPICAL SECTION	606306-02 CORRUGATED CONCRETE MEDIANS
*6-12	PAVEMENT PATCHING SCHEDULE	701301-02 LANE CLOSURE, 2L, 2W, SHORT TIME OPERATIONS
13	<i>DELETED</i>	701606-04 URBAN LANE CLOSURE, MULTILANE, 2W WITH MOUNTABLE MEDIAN
14	<i>DELETED</i>	702001-06 TRAFFIC CONTROL DEVICES
15	DISTRICT ONE TYPICAL PAVEMENT MARKINGS	
16	TRAFFIC CONTROL AND PROTECTION FOR SIDE ROADS INTERSECTIONS AND DRIVEWAYS	
17	TRAFFIC CONTROL AND PROTECTION AND TURNBAYS (TO REMAIN OPEN TO TRAFFIC)	
18	RAISED REFLECTIVE PAVEMENT MARKERS (SNOW PLOW RESISTANT)	
19	CURB OR CURB AND GUTTER REMOVAL AND REPLACEMENT	

** 6, 7, 8 DELETED*

ILLINOIS DEPARTMENT OF TRANSPORTATION

IL ROUTE 83 (OAKTON ST.)
TYPICAL SECTION

Rev 1

ROUTE	SECTION	COUNTY	TOTAL SHEETS	SHEET NUMBER
FAP 344	540 R-PCC-PP-1	COOK	19	3

CONTRACT 60C41

GENERAL NOTES

BEFORE STARTING ANY EXCAVATION, THE CONTRACTOR SHALL CALL "J.U.L.I.E." AT (800) 892-0123 FOR FIELD LOCATIONS OF BURIED ELECTRIC, TELEPHONE AND GAS UTILITIES. 48 HOUR NOTIFICATION IS REQUIRED.

THE CONTRACTOR SHALL COORDINATE CONSTRUCTION ACTIVITIES WITH UTILITY COMPANIES.

THE CONTRACTOR WILL NOT BE ALLOWED TO SET UP A YARD OR FIELD OFFICE ON STATE PROPERTY WITHOUT WRITTEN PERMISSION FROM THE DEPARTMENT.

USE #8 EPOXY-COATED TIE BARS, CONFORMING TO ART. 1006.10 OF THE STANDARD SPECIFICATIONS, FOR ALL TIE BARS. USE THE "LONGITUDINAL CONSTRUCTION JOINT (TIE BAR GROUTED IN PLACE)" DETAIL SHOWN ON HIGHWAY STANDARD 420001 FOR ALL LONGITUDINAL JOINTS.

BEFORE BEGINNING ANY WORK, THE CONTRACTOR SHALL RETAIN AND RECORD (FOR FUTURE REFERENCES) OF ALL EXISTING PAVEMENT MARKING LINES AND RAISED REFLECTIVE PAVEMENT MARKERS IN ORDER THAT THESE LOCATIONS CAN BE RE-ESTABLISHED FOR STRIPING. EXACT LOCATION OF ALL PAVEMENT MARKINGS SHALL BE AS DIRECTED BY THE ENGINEER.

ALL DAMAGE TO EXISTING PAVEMENT MARKINGS OR RAISED REFLECTIVE PAVEMENT MARKERS OUTSIDE THE REMOVAL LINE SHOWN ON THE PLANS SHALL BE REPLACED AT NO ADDITIONAL COST TO THE DEPARTMENT.

LOCATION OF COMBINATION CONCRETE CURB AND GUTTER REMOVAL AND COMBINATION CURB AND GUTTER (THE TYPE SPECIFIED ON THE PLANS), WILL BE DETERMINED IN THE FIELD BY THE ENGINEER.

THE ENGINEER SHALL CONTACT WALTER CZARNY, TRAFFIC FIELD ENGINEER, AT (773) 685-8386 A MINIMUM OF TWO (2) WEEKS PRIOR TO THE PLACEMENT OF PERMANENT PAVEMENT MARKINGS.

IT SHALL BE THE CONTRACTOR'S RESPONSIBILITY TO VERIFY ALL DIMENSIONS AND CONDITIONS EXISTING IN THE FIELD PRIOR TO CONSTRUCTION AND ORDERING OF MATERIALS.

THE CONTRACTOR SHALL CONTACT THE DISTRICT ONE TRAFFIC CONTROL SUPERVISOR AT (847) 705-4470 A MINIMUM OF 72 HOURS IN ADVANCE OF BEGINNING WORK.

EXISTING BROKEN FRAMES AND LIDS SHALL BE REMOVED AND DISPOSED OF BY THE CONTRACTOR AND SHALL BE REPLACED AS DIRECTED BY THE ENGINEER. REPLACEMENT FRAMES AND LIDS WILL BE PAID FOR IN ACCORDANCE WITH ARTICLE 109.04 OF THE STANDARD SPECIFICATIONS UNLESS A SEPARATE PAY ITEM HAS BEEN PROVIDED.

THESE PLANS HAVE BEEN PREPARED FROM NOTES RECEIVED FROM THE BUREAU OF MAINTENANCE.

THE CONTRACTOR SHALL BE REQUIRED TO PROVIDE ACCESS TO ABUTTING PROPERTY AT ALL TIMES DURING THE CONSTRUCTION OF THIS PROJECT.

THE ENGINEER SHALL OBTAIN APPROVAL FROM THE DISTRICT ONE BUREAU CHIEF OF MAINTENANCE FOR ANY PROPOSED REVISIONS IN THE SCHEDULED PAVEMENT PATCHING LOCATIONS.

DO NOT SCALE PLANS FOR CONSTRUCTION DIMENSIONS.

ILLINOIS DEPARTMENT OF TRANSPORTATION

GENERAL NOTES

ROUTE	SECTION	COUNTY	TOTAL SHEETS	SHEET NUMBER
FAP 344	540 R-PCC-PP-1	COOK	19	4

URBAN

SUMMARY OF QUANTITIES

CONTRACT 60C41

100% STATE
CONSTRUCTION
TYPE CODE
J000

CODE NUMBER.	DESCRIPTION	UNIT	TOTAL
42001300	PROTECTIVE COAT	SQ YD	1810
44001700	COMBINATION CONCRETE CURB AND GUTTER REMOVAL AND REPLACEMENT	FOOT	500
44003100	MEDIAN REMOVAL	SQ FT	1396
44200966	CLASS B PATCHES, TYPE I, 10 INCH	SQ YD	4
44200970	CLASS B PATCHES, TYPE II, 10 INCH	SQ YD	296
44200974	CLASS B PATCHES, TYPE III, 10 INCH	SQ YD	580
44200976	CLASS B PATCHES, TYPE IV, 10 INCH	SQ YD	846
44213100	PAVEMENT FABRIC	SQ YD	1426
44213200	SAW CUTS	FOOT	6475
60624600	CORRUGATED MEDIAN	SQ FT	1396
67000400	ENGINEER'S FIELD OFFICE, TYPE A	CAL MO	2
67100100	MOBILIZATION	L SUM	1
70102625	TRAFFIC CONTROL AND PROTECTION, STANDARD 701606	LSUM	1
* 78008210	POLYUREA PAVEMENT MARKING TYPE I - LINE 4"	FOOT	800
* 78100100	RAISED REFLECTIVE PAVEMENT MARKER	EACH	10
X0322467	TEMPORARY INFORMATION SIGNING FOR LANE CLOSURE	SQ FT	48
Z0017202	DOWEL BARS 1 1/2"	EACH	1720
Z0075325	TIE BARS 1"	EACH	1190

* SPECIALTY ITEMS

Rev.

ILLINOIS DEPARTMENT OF TRANSPORTATION

SUMMARY OF QUANTITIES

ROUTE	SECTION	COUNTY	TOTAL SHEETS	SHEET NUMBER
FAP 344	540 R-PCC-PP-1	COOK	19	5

CONTRACT 60C41

IL ROUTE 83
EXISTING AND PROPOSED
TYPICAL SECTION

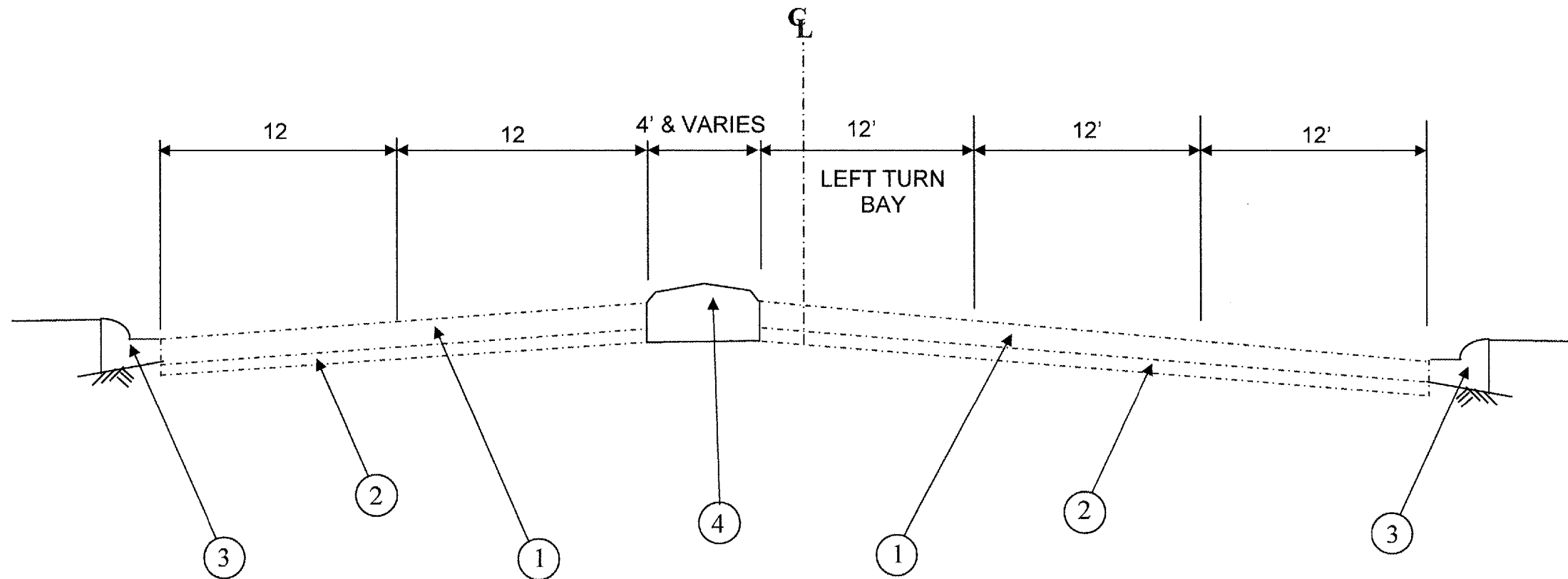

1. EXISTING P.C.C. PAVEMENT, 10"
2. EXISTING SUB-BASE, 6"
3. EXISTING CURB AND GUTTER, TYPE B-6.24
4. EXISTING CORRUGATED MEDIAN

ILLINOIS DEPARTMENT OF TRANSPORTATION
IL ROUTE 83 (OAKTON ST.)
TYPICAL SECTION

* PAGES 6, 7, 8 have been DELETED

ROUTE	SECTION	COUNTY	TOTAL SHEETS	SHEET NUMBER
FAP 344	540 R-PCC-PP-1	COOK	19	9

CONTRACT 60C41

EASTBOUND IL 83

PATCH LOCATION NUMBER	STATION	LANE 1			LANE 2		
		SIZE (L X W)	AREA (SQ. YD.)	TYPE	SIZE (L X W)	AREA (SQ. YD.)	TYPE
1	720+77	x			21 x 12	28.0	TYPE IV
2	721+83	21 x 12	28.0	TYPE IV	12 x 12	16.0	TYPE III
3	722+37	12 x 12	16.0	TYPE III	9 x 12	12.0	TYPE II
4	722+54	x			9 x 12	12.0	TYPE II
5	723+40	15 x 12	20.0	TYPE III	x		
6	723+50	x			12 x 12	16.0	TYPE III
7	723+71	13 x 12	17.3	TYPE III	x		
8	726+47	6 x 12	8.0	TYPE II	6 x 12	8.0	TYPE II
9	726+61	x			7 x 12	9.3	TYPE II
10	726+89	16 x 12	21.3	TYPE III	14 x 12	18.7	TYPE III
11	727+15	21 x 12	28.0	TYPE IV	18 x 12	24.0	TYPE III
12	727+32	4 x 12	5.3	TYPE II	4 x 12	5.3	TYPE II
13	729+12	16 x 12	21.3	TYPE III	18 x 12	24.0	TYPE III
14	729+98	x			21 x 2	4.7	TYPE I
15	731+08	24 x 12	32.0	TYPE IV	x		
16	731+35	x			12 x 12	16.0	TYPE III
17	731+90	x			72 x 12	96.0	TYPE IV
18	732+35	19 x 12	25.3	TYPE IV	x		
19	732+80	6 x 12	8.0	TYPE II	6 x 12	8.0	TYPE II
20	732+95	x			6 x 12	8.0	TYPE II
21	733+42	9 x 12	12.0	TYPE II	9 x 12	12.0	TYPE II
22	734+04	9 x 12	12.0	TYPE II	9 x 12	12.0	TYPE II
23	735+36	x			15 x 12	20.0	TYPE III
24	735+69	x			21 x 12	28.0	TYPE IV
25	735+92	3 x 12	4.0	TYPE I	9 x 12	12.0	TYPE II

1. CENTERLINE OF HIGGINS RD:
STA. 718+76
2. CENTERLINE OF I-90 BRIDGE:
STA. 725+33
3. CENTERLINE OF ELMHURST RD:
STA. 768+05

ILLINOIS DEPARTMENT OF TRANSPORTATION
**IL ROUTE 83 (OAKTON ST.)
PAVEMENT PATCHING SCHEDULE**

ROUTE	SECTION	COUNTY	TOTAL SHEETS	SHEET NUMBER
FAP 344	540 R-PCC-PP-1	COOK	19	10

CONTRACT 60C41

EASTBOUND IL 83

PATCH LOCATION NUMBER	STATION	LANE 1			LANE 2			MEDIAN CROSSOVER*	
		SIZE (L X W)	AREA (SQ. YD.)	TYPE	SIZE (L X W)	AREA (SQ. YD.)	TYPE	SIZE (L X W)	AREA (SQ. YD.)
26	736+30	10 x 12	13.3	TYPE II	10 x 12	13.3	TYPE II	x	
27	736+50	28 x 12	37.3	TYPE IV	12 x 12	16.0	TYPE III	x	
28	737+10	x			16 x 12	21.3	TYPE III	x	
29	737+97	x			6 x 12	8.0	TYPE II	x	
30	739+16	12 x 12	16.0	TYPE III	x			x	
31	740+84	10 x 12	13.3	TYPE II	12 x 12	16.0	TYPE III	x	
32	741+34	11 x 12	14.7	TYPE II	12 x 12	16.0	TYPE III	x	
33	741+74	x			6 x 12	8.0	TYPE II	x	
34	743+50	6 x 12	8.0	TYPE II	6 x 12	8.0	TYPE II	x	
35	746+50	36 x 12	48.0	TYPE IV	36 x 12	48.0	TYPE IV	x	
36	746+83	x			12 x 12	16.0	TYPE III	x	
37	748+16	16 x 12	21.3	TYPE III	12 x 12	16.0	TYPE III	x	
38	748+18	12 x 12	16.0	TYPE III	12 x 12	16.0	TYPE III	x	
39	748+38	x			38 x 12	50.7	TYPE IV	x	
40	748+96	x			12 x 12	16.0	TYPE III	x	
41	749+27	5 x 12	6.7	TYPE II	15 x 12	20.0	TYPE III	x	
42	749+44	x			8 x 12	10.7	TYPE II	x	
43	749+85	10 x 12	13.3	TYPE II	10 x 12	13.3	TYPE II	x	
44	750+38	x			9 x 12	12.0	TYPE II	x	
45	750+59	21 x 12	28.0	TYPE IV	21 x 12	28.0	TYPE IV	x	
46	750+72	x						90 x 4	40.0
47	750+86	15 x 12	20.0	TYPE III	18 x 12	24.0	TYPE III	x	
48	753+50	21 x 12	28.0	TYPE IV	21 x 12	28.0	TYPE IV	x	
49	755+13	x			x			10 x 4	4.4
50	755+25	21 x 12	28.0	TYPE IV	18 x 12	24.0	TYPE III	x	

1. CENTERLINE OF HIGGINS RD: STA. 718+76

* MEDIAN REMOVAL, CORRUGATED MEDIAN

2. CENTERLINE OF I-90 BRIDGE: STA. 725+33

3. CENTERLINE OF ELMHURST RD: STA. 768+05

ILLINOIS DEPARTMENT OF TRANSPORTATION

**IL ROUTE 83 (OAKTON ST.)
PAVEMENT PATCHING SCHEDULE**

ROUTE	SECTION	COUNTY	TOTAL SHEETS	SHEET NUMBER
FAP 344	540 R-PCC-PP-1	COOK	19	11

CONTRACT 60C41

EASTBOUND IL 83

PATCH LOCATION NUMBER	STATION	LANE 1			LANE 2		
		SIZE (L X W)	AREA (SQ. YD.)	TYPE	SIZE (L X W)	AREA (SQ. YD.)	TYPE
51	756+00	14 x 12	18.7	Type III	12 x 12	16.0	Type III
52	756+26	7 x 12	9.3	Type II	12 x 12	16.0	Type III
53	756+50	21 x 12	28.0	Type IV	21 x 12	28.0	Type IV
54	756+72	21 x 12	28.0	Type IV	21 x 12	28.0	Type IV
55	758+26	18 x 12	24.0	Type III	20 x 12	26.7	Type IV
56	758+65	20 x 12	26.7	Type IV	20 x 12	26.7	Type IV
57	760+50	27 x 12	36.0	Type IV	x		

1. CENTERLINE OF HIGGINS RD: STA. 718+76
2. CENTERLINE OF I-90 BRIDGE: STA. 725+33
3. CENTERLINE OF ELMHURST RD: STA. 768+05

ILLINOIS DEPARTMENT OF TRANSPORTATION
**IL ROUTE 83 (OAKTON ST.)
PAVEMENT PATCHING SCHEDULE**

ROUTE	SECTION	COUNTY	TOTAL SHEETS	SHEET NUMBER
FAP 344	540 R-PCC-PP-1	COOK	19	12

CONTRACT 60C41

PATCHING SCHEDULE NOTES AND INFORMATION

IL ROUTE 83

NOTES

THE ENGINEER SHALL CONTACT MATT MARA, MAINTENANCE ENGINEER, AT THE ARLINGTON HEIGHTS MAINTENANCE YARD (847)439-0100, REGARDING PATCHING LOCATIONS.

THE ENGINEER SHALL OBTAIN APPROVAL FROM THE DISTRICT ONE BUREAU CHIEF OF MAINTENANCE FOR ANY PROPOSED REVISIONS IN THE SCHEDULED PAVEMENT PATCHING LOCATIONS.

PAVEMENT PATCHING SUMMARY

Pavement Patching (sq. yd.): IL 83/OAKTON ST Eastbound

	LANE 1	LANE 2	Subtotal
Class B Patches, Type I 10"	4.0	0.0	4.0
Class B Patches, Type II 10"	124.0	172.0	296.0
Class B Patches, Type III 10"	212.0	368.0	580.0
Class B Patches, Type IV 10"	401.3	444.0	845.3

~~Pavement Patching (sq. yd.): IL 83/OAKTON ST Westbound~~

	LANE 1	LANE 2	Subtotal
Class B Patches, Type I 10"	0.0	0.0	0.0
Class B Patches, Type II 10"	142.7	138.7	281.3
Class B Patches, Type III 10"	454.7	417.3	872.0
Class B Patches, Type IV 10"	609.3	693.3	1302.7

Total Pavement Patching (sq. yd.): IL 83/OAKTON ST

	Eastbound	Westbound	TOTAL
Class B Patches, Type I 10"	4.0	0.0	4.0
Class B Patches, Type II 10"	296.0	281.3	577.3
Class B Patches, Type III 10"	580.0	872.0	1452.0
Class B Patches, Type IV 10"	845.3	1302.7	2148.0
<i>TOTAL</i>	<i>1725.3</i>		<i>4181.3</i>

ILLINOIS DEPARTMENT OF TRANSPORTATION

**IL ROUTE 83 (OAKTON ST.)
PAVEMENT PATCHING SCHEDULE**

Rev.

* PAGES 13 + 14 have been

F.A.P. RTE.	SECTION	COUNTY	TOTAL SHEETS	SHEET NO.
311	540 R-PCC-PP-1	COOK	19	15
STA.	TO STA.			
FED. ROAD DIST. NO.	ILLINOIS FED. AID PROJECT			

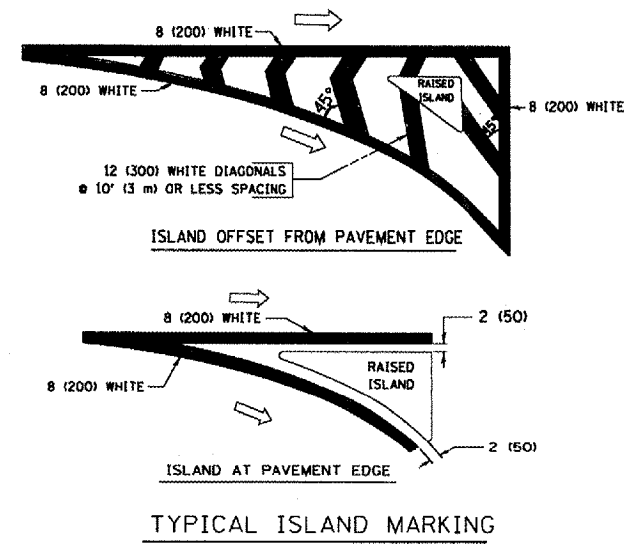

TYPICAL ISLAND MARKING

TYPE OF MARKING	WIDTH OF LINE	PATTERN	COLOR	SPACING / REMARKS
CENTERLINE ON 2 LANE PAVEMENT	4 (100)	SKIP-DASH	YELLOW	10' (3 m) LINE WITH 30' (9 m) SPACE
CENTERLINE ON MULTI-LANE UNDIVIDED PAVEMENT	2 @ 4 (100)	SOLID	YELLOW	11 (280) C-C
NO PASSING ZONE LINES FOR ONE DIRECTION FOR BOTH DIRECTIONS	4 (100) 2 @ 4 (100)	SOLID SOLID	YELLOW YELLOW	5 1/2 (140) C-C FROM SKIP-DASH CENTERLINE 11 (280) C-C OMIT SKIP-DASH CENTERLINE BETWEEN
LANE LINES	4 (100) 5 (125) ON FREEWAYS	SKIP-DASH SKIP-DASH	WHITE WHITE	10' (3 m) LINE WITH 30' (9 m) SPACE
DOTTED LINES (EXTENSIONS OF CENTER, LANE OR TURN LANE MARKINGS)	SAME AS LINE BEING EXTENDED	SKIP-DASH	SAME AS LINE BEING EXTENDED	2' (600) LINE WITH 6' (1.8 m) SPACE
EDGE LINES	4 (100)	SOLID	YELLOW-LEFT WHITE-RIGHT	OUTLINE MOUNTABLE MEDIANS IN YELLOW; EDGE LINES ARE NOT USED NEXT TO BARRIER CURB
TURN LANE MARKINGS	6 (150) LINE; FULL SIZE LETTERS & SYMBOLS (8' (2.4m))	SOLID	WHITE	SEE TYPICAL TURN LANE MARKING DETAIL
TWO WAY LEFT TURN MARKING	2 @ 4 (100) EACH DIRECTION 8' (2.4m) LEFT ARROW	SKIP-DASH AND SOLID IN PAIRS	YELLOW WHITE	10' (3 m) LINE WITH 30' (9 m) SPACE FOR SKIP-DASH; 5 1/2 (140) C-C BETWEEN SOLID LINE AND SKIP-DASH LINE SEE TYPICAL TWO-WAY LEFT TURN MARKING DETAIL
CROSSWALK LINES (PEDESTRIAN) A. DIAGONALS (BIKE & EQUESTRIAN) B. LONGITUDINAL BARS (SCHOOL)	2 @ 6 (150) 12 (300) @ 45° 12 (300) @ 90°	SOLID SOLID SOLID	WHITE WHITE WHITE	NOT LESS THAN 6' (1.8 m) APART 2' (600) APART SEE TYPICAL CROSSWALK MARKING DETAILS.
STOP LINES	24 (600)	SOLID	WHITE	PLACE 4' (1.2 m) IN ADVANCE OF AND PARALLEL TO CROSSWALK, IF PRESENT. OTHERWISE, PLACE AT DESIRED STOPPING POINT, PARALLEL TO CROSSROAD CENTERLINE, WHERE POSSIBLE
PAINTED MEDIANS	2 @ 4 (100) WITH 12 (300) DIAGONALS @ 45° NO DIAGONALS USED FOR 4' (1.2 m) WIDE MEDIANS	SOLID	YELLOW; TWO WAY TRAFFIC WHITE; ONE WAY TRAFFIC	11 (280) C-C FOR THE DOUBLE LINE SEE TYPICAL PAINTED MEDIAN MARKING.
GORE MARKING AND CHANNELIZING LINES	8 (200) WITH 12 (300) DIAGONALS @ 45°	SOLID	WHITE	DIAGONALS: 15' (4.5 m) C-C (LESS THAN 30MPH (50 km/h)) 20' (6 m) C-C 30MPH (50 km/h) TO 45MPH (70 km/h) 30' (9 m) C-C (OVER 45MPH (70 km/h))
RAILROAD CROSSING	24 (600) TRANSVERSE LINES; "RR" 15 6' (1.8 m) LETTERS; 16 (400) LINE FOR "X"	SOLID	WHITE	SEE STATE STANDARD 780001 AREA OF: "R"=3.6 SQ. FT. (0.33 m ²) EACH "X"=54.0 SQ. FT. (5.0 m ²)
SHOULDER DIAGONALS	12 (300) @ 45°	SOLID	WHITE - RIGHT YELLOW - LEFT	50' (15 m) C-C (LESS THAN 30MPH (50 km/h)) 75' (25 m) C-C 30 MPH (50 km/h) TO 45MPH (70 km/h) 150' (45 m) C-C (OVER 45MPH (70 km/h))

FOR FURTHER DETAILS ON PAVEMENT MARKING REFER TO STANDARD SPECIFICATIONS FOR ROAD AND BRIDGE CONSTRUCTION AND STATE STANDARD 780001.

All dimensions are in inches (millimeters) unless otherwise shown.

REVISIONS	
NAME	DATE
EVERS	03-19-90
T. RAMMACHER	10-27-94
ALEX HOUSEH	10-09-96
ALEX HOUSEH	10-17-96
T. RAMMACHER	01-06-00

ILLINOIS DEPARTMENT OF TRANSPORTATION
DISTRICT ONE
TYPICAL PAVEMENT MARKINGS

SCALE: NONE
DRAWN BY CADD
CHECKED BY
TC-13

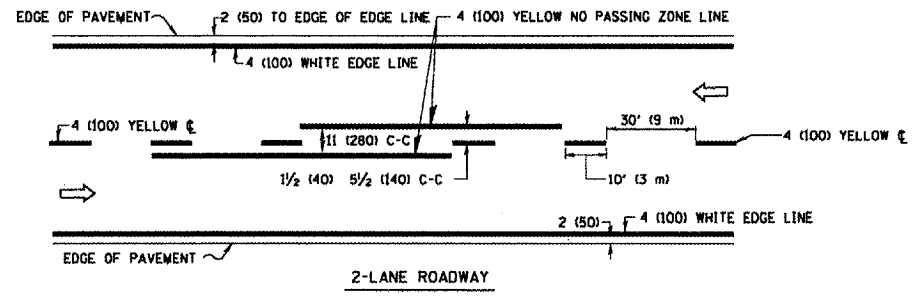

2-LANE ROADWAY

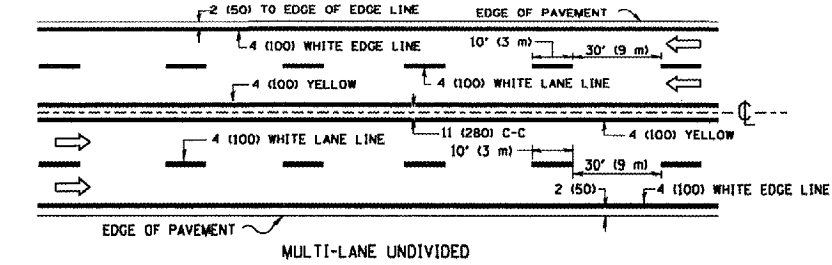

MULTI-LANE UNDIVIDED

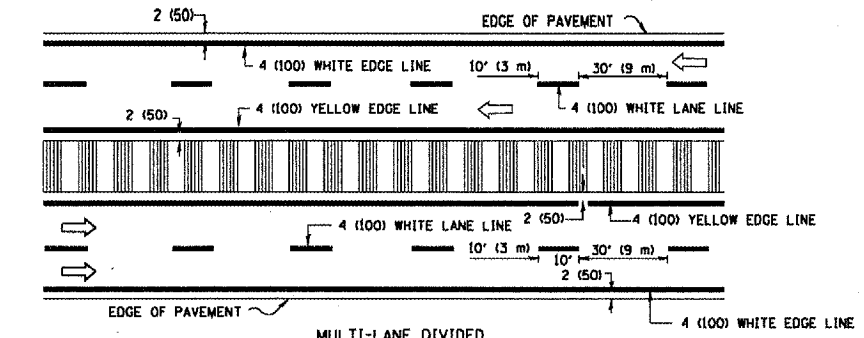

MULTI-LANE DIVIDED WITH MOUNTABLE MEDIAN

NOTE: MEDIANS WITH BARRIER CURB DO NOT REQUIRE AN EDGE LINE

TYPICAL LANE AND EDGE LINE MARKING

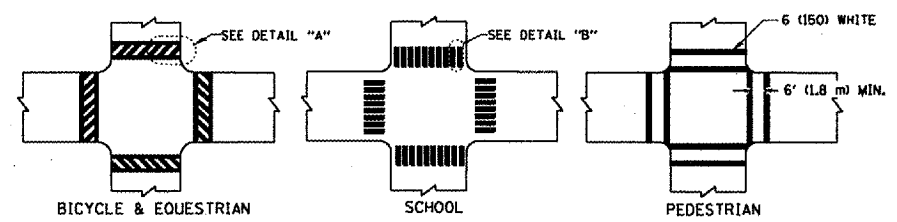

TYPICAL CROSSWALK MARKING

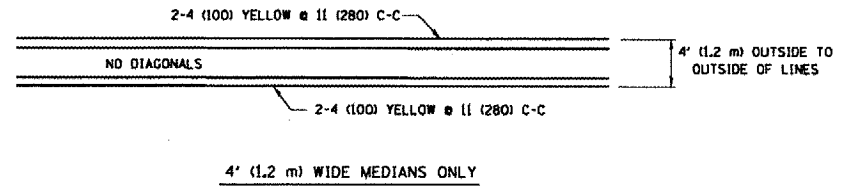

4' (1.2 m) WIDE MEDIANS ONLY

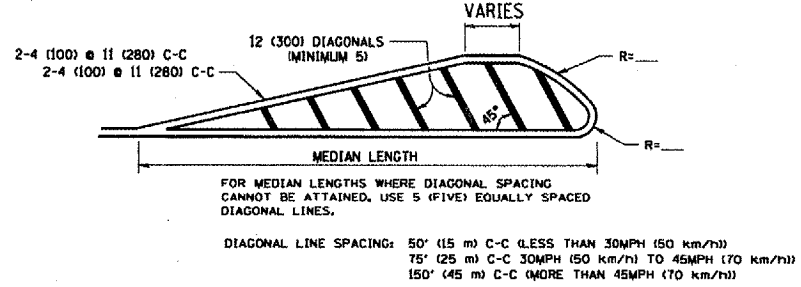

MEDIANS OVER 4' (1.2 m) WIDE

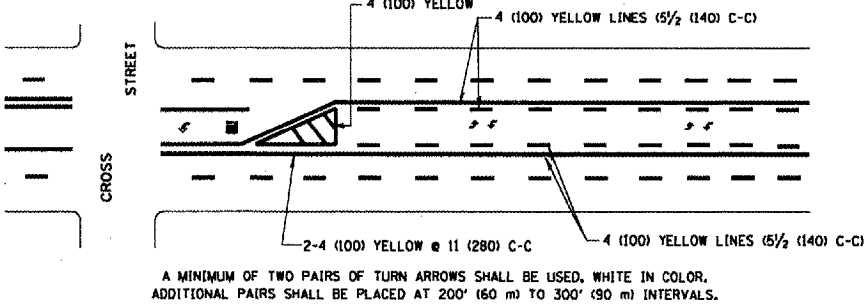

TYPICAL PAINTED MEDIAN MARKING

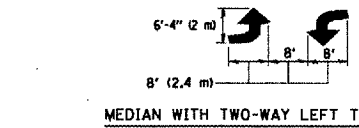

MEDIAN WITH TWO-WAY LEFT TURN LANE

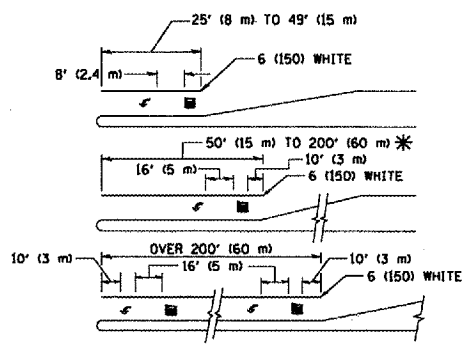

TYPICAL LEFT (OR RIGHT) TURN LANE

FULL SIZE LETTERS 8' (2.4 m) AND ARROWS SHALL BE USED.
AREA = 15.6 SQ. FT. (1.5 m²) () AREA = 20.8 SQ. FT. (1.9 m²)
* TURN LANES IN EXCESS OF 400' (120 m) IN LENGTH MAY HAVE AN ADDITIONAL SET OF ARROW - "ONLY" INSTALLED MIDWAY BETWEEN THE OTHER TWO SETS OF ARROW - "ONLY".

TYPICAL TURN LANE MARKING

8/20/2007
 FILE NAME: P:\Highway Standards\Standards\USA\103.dgn
 PLOT SCALE: 0.0000 7.7 IN.
 USER NAME:

F.A. RTE.	SECTION	COUNTY	TOTAL SHEETS	SHEET NO.
311	540 R-PCC-PP-1	COOK	19	16
STA.		TO STA.		
FED. ROAD DIST. NO.	ILLINOIS	FED. AID PROJECT		

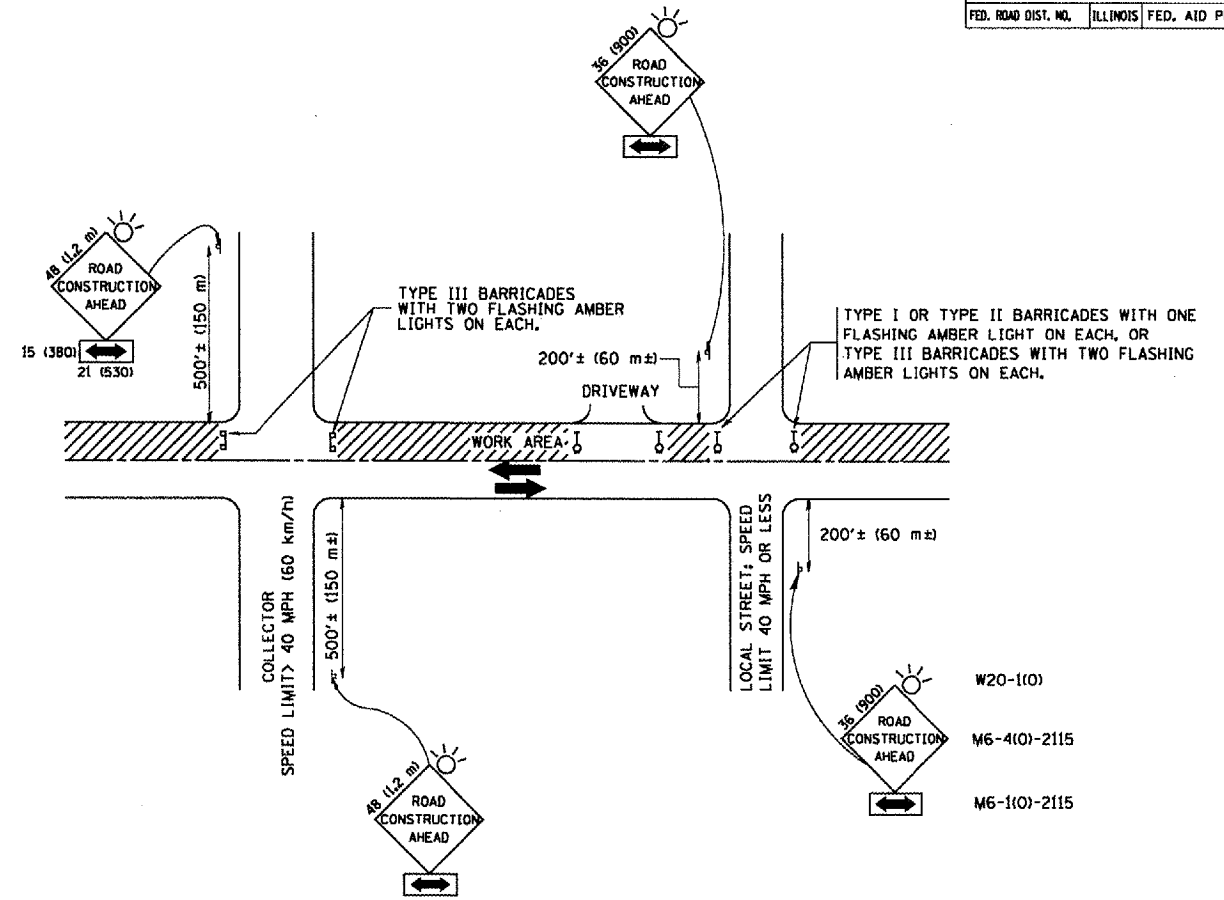

TRAFFIC CONTROL AND PROTECTION FOR SIDE ROADS, INTERSECTIONS, AND DRIVEWAYS

NOTES:

A. FOR NO LANE RESTRICTION ON THE SIDE ROAD OR DRIVEWAYS

- SIDE ROAD WITH A SPEED LIMIT OF 40 MPH (60 km/h) OR LESS AS SHOWN ON THE DRAWING AND AS DIRECTED BY THE ENGINEER:
 - ONE ROAD CONSTRUCTION AHEAD SIGN 36 x 36 (900x900) WITH A FLASHER AND FLAG MOUNTED ON IT APPROXIMATELY 200' (60 m) IN ADVANCE OF THE MAIN ROUTE.
 - THE CLOSED PORTION OF THE MAIN ROUTE SHALL BE PROTECTED BY BLOCKING WITH TYPE I, TYPE II OR TYPE III BARRICADES, 1/3 OF THE CROSS SECTION OF THE CLOSED PORTION.
- SIDE ROAD WITH A SPEED LIMIT GREATER THAN 40 MPH (60 km/h) AS SHOWN ON THE DRAWING AND AS DIRECTED BY THE ENGINEER:
 - ONE ROAD CONSTRUCTION AHEAD SIGN 48 x 48 (1.2 m x 1.2 m) WITH A FLASHER MOUNTED ON IT APPROXIMATELY 500' (150 m) IN ADVANCE OF THE MAIN ROUTE.
 - THE CLOSED PORTION OF THE MAIN ROUTE SHALL BE PROTECTED BY BLOCKING WITH TYPE III BARRICADES, 1/2 OF THE CROSS SECTION OF THE CLOSED PORTION.
- WHEN THE SIDE ROAD LIES BETWEEN THE BEGINNING OF THE MAINLINE SIGNING AND THE WORK ZONE, A SINGLE HEADED ARROW (M6-1) SHALL BE USED IN LIEU OF THE DOUBLE HEADED ARROW (M6-4).

B. FOR A LANE CLOSURE ON A SIDE ROAD OR DRIVEWAY:

USE APPLICABLE PORTIONS OF THE TYPICAL APPLICATION OF TRAFFIC CONTROL DEVICES (STD. 701501, STD. 701606 OR THE APPROPRIATE STANDARD). THE SPACING OF SIGNS AND BARRICADES SHALL BE ADJUSTED FOR FIELD CONDITIONS AS DIRECTED BY THE ENGINEER. THE DIRECTIONAL ARROW SHALL BE COVERED OR REMOVED WHEN NO LONGER CONSISTENT WITH THE SIDE ROAD LANE CLOSURE.

C. ADVANCE WARNING SIGNS ARE TO BE OMITTED ON DRIVEWAY UNLESS OTHERWISE NOTED.

D. THE TRAFFIC CONTROL AND PROTECTION FOR SIDE ROADS, INTERSECTIONS, AND DRIVEWAYS SHALL BE INCIDENTAL TO THE COST OF SPECIFIED TRAFFIC CONTROL STANDARDS OR ITEMS.

All dimensions are in millimeters (inches) unless otherwise shown.

REVISIONS	
NAME	DATE
LHA	6/89
T. RAMMACHER	09/08/94
J. OBERLE	10/18/95
A. HOUSEH	03/06/96
A. HOUSEH	10/15/96
T. RAMMACHER	01/06/00

ILLINOIS DEPARTMENT OF TRANSPORTATION
 TRAFFIC CONTROL AND PROTECTION
 FOR
 SIDE ROADS, INTERSECTIONS, AND
 DRIVEWAYS

SCALE: NONE

DRAWN BY
 CHECKED BY
 TC-10



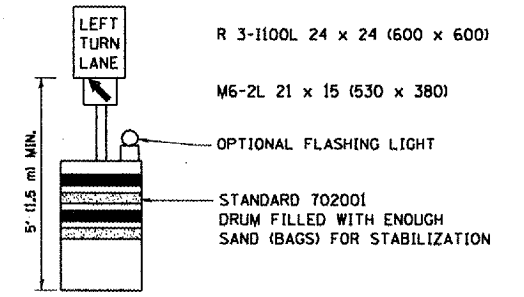
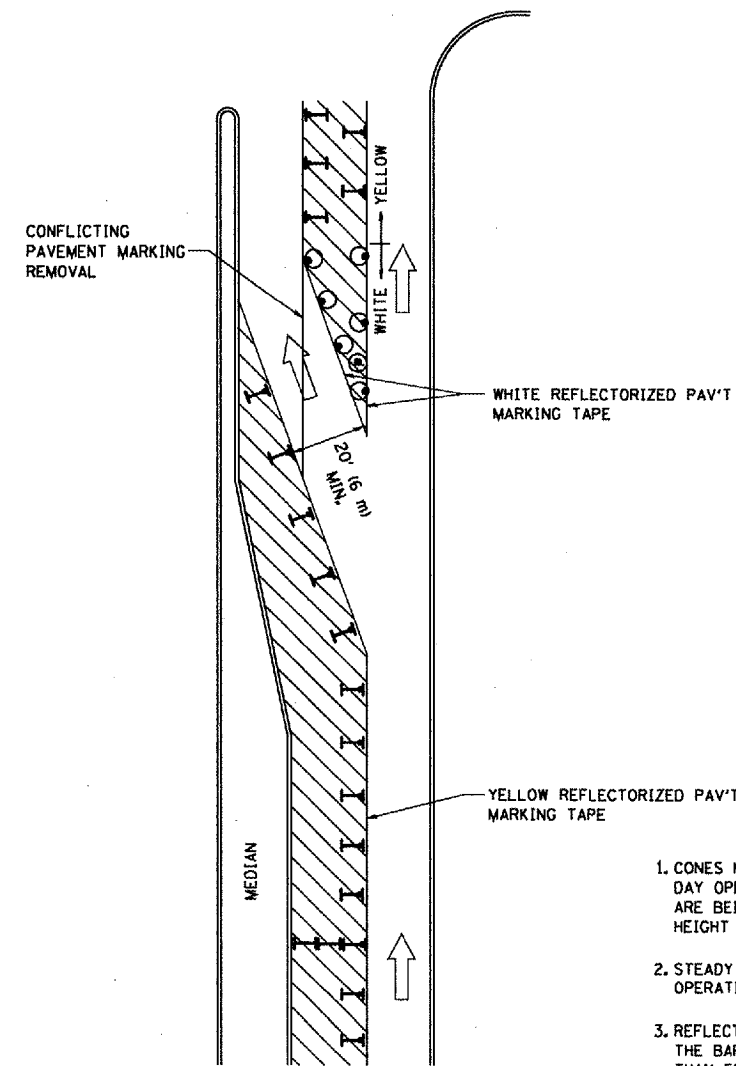

F.A. RTE.	SECTION	COUNTY	TOTAL SHEETS	SHEET NO.
311	540 R-PCC-PP-1	COOK	19	17
STA.		TO STA.		
FED. ROAD DIST. NO.	ILLINOIS	FED. AID PROJECT		

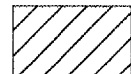
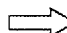

GENERAL NOTES

1. CONES MAY BE SUBSTITUTED FOR BARRICADES OR DRUMS AT HALF THE SPACING DURING DAY OPERATIONS. CONES SHALL BE A MINIMUM OF 28 (710) IN HEIGHT. WHEN CONES ARE BEING USED, THE "LEFT TURN LANE" SIGN MAY BE SKID MOUNTED AT A MINIMUM HEIGHT OF 5' (1.5 m).
2. STEADY BURNING LIGHTS WILL NOT BE REQUIRED ON BARRICADES OR DRUMS FOR DAY OPERATIONS. ALL LIGHTS SHALL BE MONODIRECTIONAL.
3. REFLECTORIZED TEMPORARY PAVEMENT MARKING TAPE SHALL BE PLACED THROUGHOUT THE BARRICADED AREA OF EACH TURN BAY WHERE THE CLOSURE TIME IS GREATER THAN FOURTEEN DAYS.
4. THIS APPLICATION ALSO APPLIES WHEN WORK IS BEING PERFORMED IN THE RIGHT LANE(S) AND THE RIGHT TURN BAY IS TO REMAIN OPEN. UNDER THIS CONDITION, "RIGHT TURN LANE" R3-100 24 x 24 (600 x 600) AND M6-2R 21 x 15 (530 x 380) SHALL BE USED.
5. THESE CONTROLS SHALL SUPPLEMENT MAINLINE TRAFFIC CONTROL FOR LANE CLOSURES.
6. LONGITUDINAL DIMENSIONS MAY BE ADJUSTED TO FIT FIELD CONDITIONS.
7. FORM BT 725 IS REQUIRED.
8. TRAFFIC CONTROL AND PROTECTION AT TURN BAYS (TO REMAIN OPEN TO TRAFFIC) SHALL BE INCLUDED IN THE COST SPECIFIED TRAFFIC CONTROL STANDARDS OR ITEMS.

LEGEND

-  WORK AREA
-  LANE OPEN TO TRAFFIC
-  TYPE I OR II BARRICADE WITH STEADY BURN LIGHT
-  DRUM WITH STEADY BURN LIGHT
-  DRUM WITH SIGN (WITH OPTIONAL FLASHING LIGHT) SEE DETAIL
-  TYPE I OR II CHECK BARRICADE WITH FLASHING LIGHT

All dimensions are in inches (millimeters) unless otherwise shown.

REVISIONS	
NAME	DATE
T. RAMMACHER	09/08/94
A. HOUSEH	11/07/95
A. HOUSEH	10/12/96
T. RAMMACHER	01/06/00

ILLINOIS DEPARTMENT OF TRANSPORTATION
**TRAFFIC CONTROL AND PROTECTION
 AT TURN BAYS
 (TO REMAIN OPEN TO TRAFFIC)**

SCALE: NONE
 DRAWN BY
 CHECKED BY LHA
 TC-14

PLOT DATE: 01/28/2007
 FILE NAME: P:\highway\standards\standards\turnbay\trc14.dgn
 PLOT SCALE: 1/8" = 1'-0"
 USER NAME: anand

F.A. RTE.	SECTION	COUNTY	TOTAL SHEETS	SHEET NO.
311	540 R-PCC-PP-1	COOK	19	18
STA.		TO STA.		
FED. ROAD DIST. NO.		ILLINOIS FED. AID PROJECT		

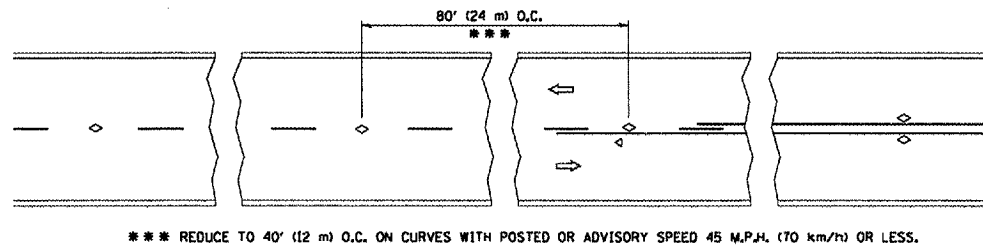

TWO-LANE/TWO-WAY

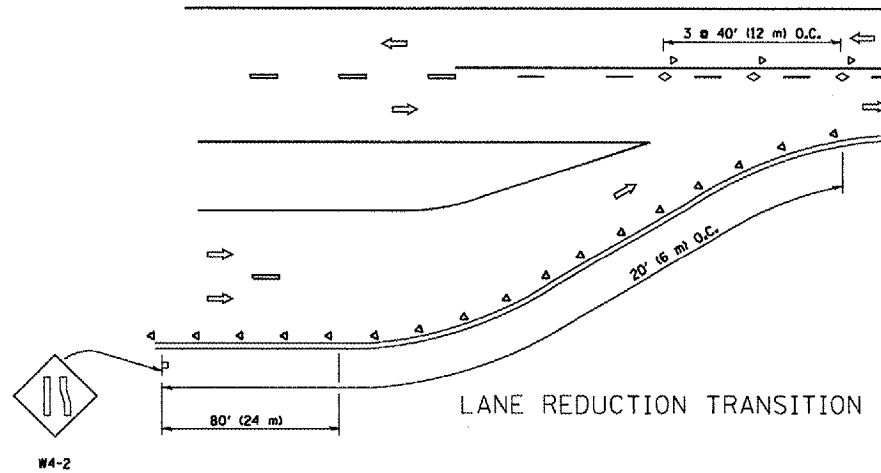

LANE REDUCTION TRANSITION

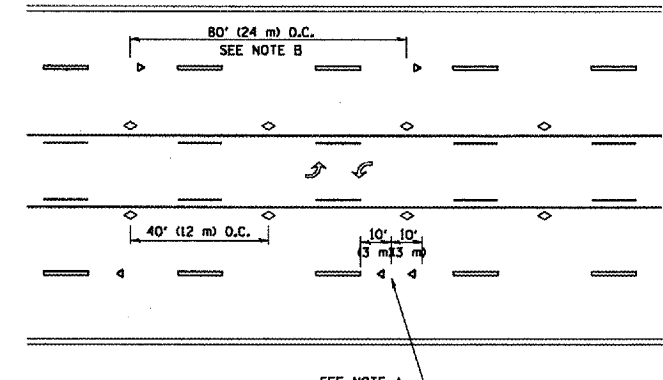

TWO-WAY LEFT TURN

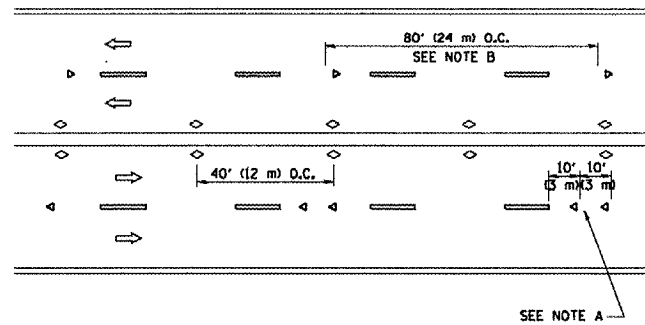

MULTI-LANE/UNDIVIDED

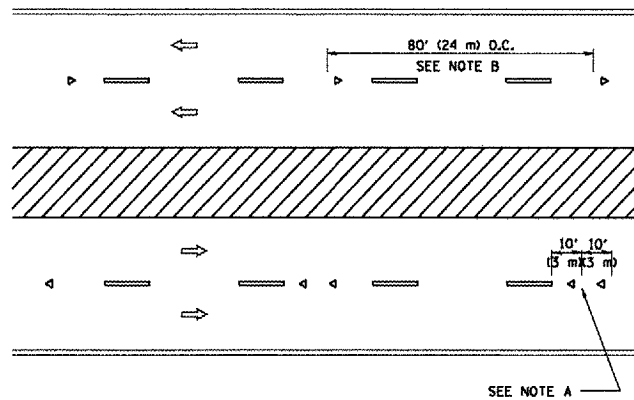

MULTI-LANE/DIVIDED

GENERAL NOTES

1. MARKERS USED WITH DASHED LINES SHALL BE CENTERED IN THE GAP BETWEEN SEGMENTS.
2. MARKERS USED ADJACENT TO SOLID LINES SHALL BE OFFSET 2 TO 3 (50 TO 75) TOWARD TRAFFIC AS SHOWN.
3. MARKERS THROUGH TANGENTS LESS THAN 500' (150 m) IN LENGTH BETWEEN CURVES SHALL BE INSTALLED AT THE LESSER OF THE TWO CURVE SPACINGS.

SYMBOLS

- YELLOW STRIPE
- WHITE STRIPE
- ◁ ONE-WAY AMBER MARKER
- ◁ ONE-WAY CRYSTAL MARKER (W/O)
- ◊ TWO-WAY AMBER MARKER

LANE MARKER NOTES

- A. USE DOUBLE LANE LINE MARKERS SPACED AS SHOWN.
- B. REDUCE TO 40' (12 m) O.C. ON CURVES WHERE ADVISORY SPEEDS ARE 10 M.P.H. (20 km/h) LOWER THAN POSTED SPEEDS.

DESIGN NOTES

1. DOUBLE LANE LINE MARKERS SHALL BE USED UNLESS SPECIFIED OTHERWISE.
2. EXCEPT AS SHOWN ON THE LANE REDUCTION TRANSITION AND FREEWAY EXIT RAMP DETAIL, MARKERS ARE NOT TO BE SPECIFIED ON RIGHT EDGE LINES.
3. THE EXACT MARKER LIMITS, SPACING, AND COLOR SHOULD BE INCLUDED IN THE PLANS.
4. MARKERS SHOULD NOT BE USED ALONGSIDE CURBS EXCEPT FOR EXTREMELY SHORT SECTIONS OF CURBS WHERE NOT MORE THAN TWO MARKERS WOULD BE INVOLVED.

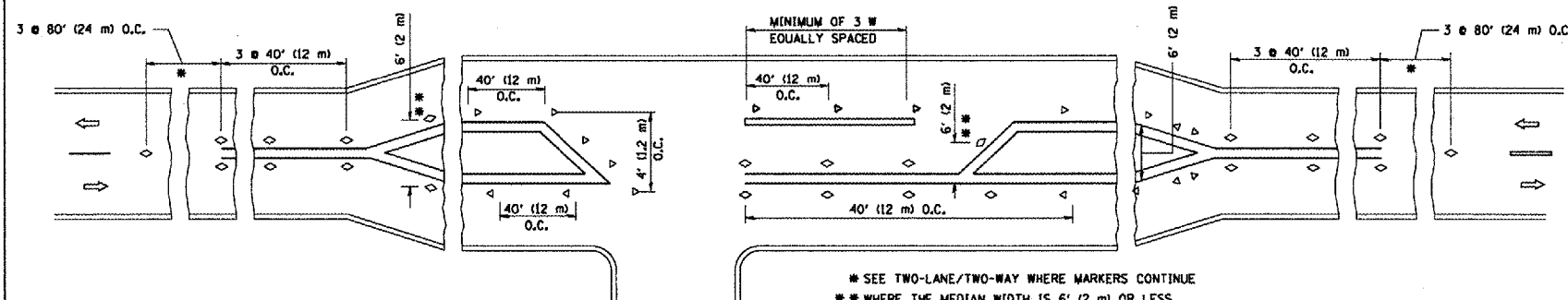

LEFT TURN

- * SEE TWO-LANE/TWO-WAY WHERE MARKERS CONTINUE
- ** WHERE THE MEDIAN WIDTH IS 6' (2 m) OR LESS USE TWO-WAY MARKERS.

All dimensions are in inches (millimeters) unless otherwise shown.

REVISIONS	
NAME	DATE
T. RAMMACHER	09-19-94
T. RAMMACHER	03-12-99
T. RAMMACHER	01-06-00

ILLINOIS DEPARTMENT OF TRANSPORTATION
TYPICAL APPLICATIONS
RAISED REFLECTIVE PAVEMENT
MARKERS (SNOW-PLOW RESISTANT)

SCALE: NONE

DRAWN BY CADD
CHECKED BY
TC-11

PLOT DATE: 8/28/2007
 FILE NAME: P:\working\15\order\m\1518181\11.dgn
 PLOT SCALE: 0.0000 7' IN.
 USER NAME: cadden

F.A. RTE.	SECTION	COUNTY	TOTAL SHEETS	SHEET NO.
311	540 R-PCC-PP-I	COOK	19	19
STA.		TO STA.		
FED. ROAD DIST. NO. 1		ILLINOIS FED. AID PROJECT		

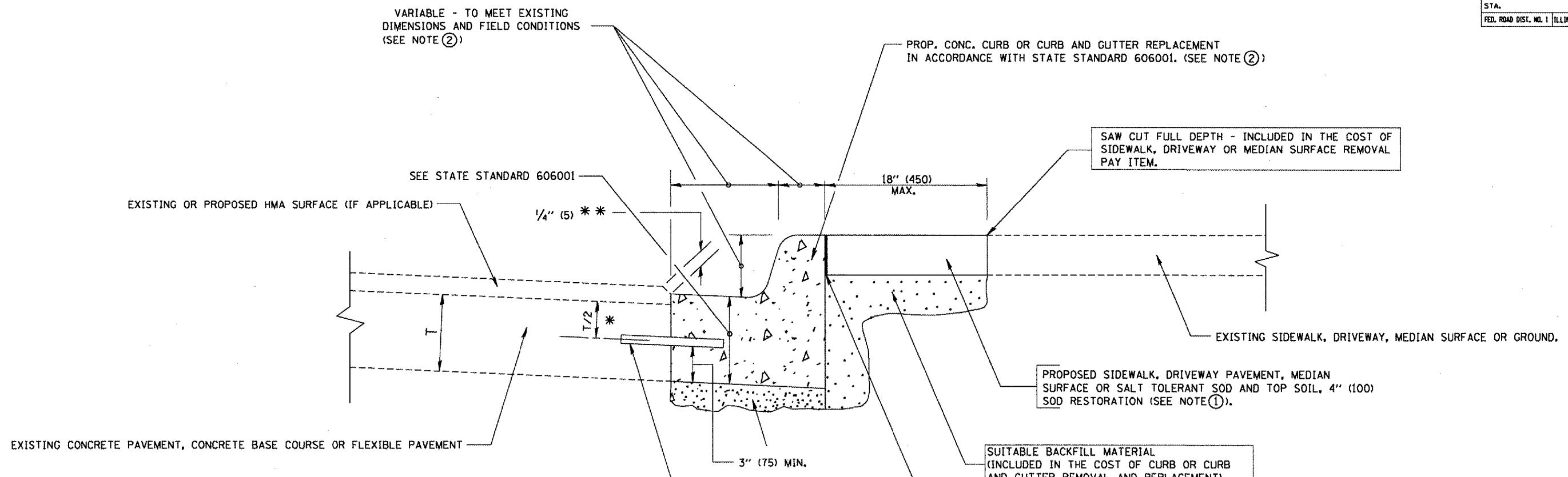

- * 3" (75) MINIMUM FROM TOP AND BOTTOM OF THE CONCRETE PAVEMENT OR BASE COURSE.
- ** IF THE FINAL SURFACE OF THE PAVEMENT IS CONCRETE, THE GUTTER IS TO BE FLUSH WITH THE PAVEMENT.

- NOTE: ① SIDEWALK, DRIVEWAY PAVEMENT OR MEDIAN SURFACE SHALL BE SIMILAR TO THE MATERIAL BEING REMOVED AND WILL BE PAID FOR SEPARATELY.
- SALT TOLERANT SOD AND TOP SOIL, 4" (100) RESTORATION WILL NOT BE PAID FOR SEPARATELY, BUT SHALL BE INCLUDED IN THE COST OF CURB OR CURB AND GUTTER REMOVAL AND REPLACEMENT.
- ② CURB OR CURB AND GUTTER REPLACEMENT SHALL MATCH THE SHAPE OF THE EXISTING CURB OR CURB AND GUTTER UNLESS OTHERWISE SPECIFIED.
- ③ FOR CURB OR CURB AND GUTTER REMOVAL AND REPLACEMENT ADJACENT TO FLEXIBLE PAVEMENT DELETE EPOXY COATED TIE BARS.
- ④ LONGITUDINAL BARS, IF ENCOUNTERED IN THE EXISTING CURB OR CURB AND GUTTER, ARE NOT TO BE REPLACED. CUTTING AND REMOVING LONGITUDINAL BARS SHALL BE INCLUDED IN THE COST OF CURB OR CURB AND GUTTER REMOVAL AND REPLACEMENT.
- ⑤ THE COST OF HMA SURFACE REMOVAL IN THE EXISTING GUTTER FLAG SHALL BE INCLUDED IN THE COST OF THE CURB AND GUTTER REMOVAL AND REPLACEMENT.
- ⑥ THE REMOVAL AND REPLACEMENT OF THE EXISTING CURB OR CURB AND GUTTER SHALL BE DONE IN ACCORDANCE WITH THE APPLICABLE PORTIONS OF SECTION 440 AND 606 OF THE STANDARD SPECIFICATIONS.
- ⑦ THE LOCATIONS OF REMOVAL AND REPLACEMENT OF EXISTING CURB OR CURB AND GUTTER SHALL BE DETERMINED BY THE RESIDENT ENGINEER AT THE TIME OF CONSTRUCTION.

UNSUITABLE SUB-BASE MATERIAL TO BE REMOVED, IF DIRECTED BY THE ENGINEER, SHALL BE REPLACED WITH EITHER SUB-BASE GRANULAR MATERIAL, TYPE B OR ADDITIONAL THICKNESS OF CONCRETE.

REMOVAL AND REPLACEMENT 4" (100) OR LESS IS INCLUDED IN THE COST OF CURB OR CURB AND GUTTER REMOVAL AND REPLACEMENT.

REMOVAL AND REPLACEMENT IN EXCESS OF 4" (100) WILL BE PAID FOR IN ACCORDANCE WITH ARTICLE 109.04 OF THE STANDARD SPECIFICATIONS.

PROPOSED #6 (20) EPOXY COATED TIE BARS 24" (600) LONG AT 24" (600) CENTERS WILL NOT BE PAID FOR SEPARATELY. DELETE EPOXY COATED TIE BARS IF EXISTING TIE BARS ARE USUABLE AS DETERMINED BY THE ENGINEER. (SEE NOTE ③).

BASIS OF PAYMENT:
THIS WORK WILL BE PAID FOR AT THE CONTRACT UNIT PRICE PER FOOT (METER) FOR "CURB REMOVAL AND REPLACEMENT" OR "COMBINATION CONCRETE CURB AND GUTTER REMOVAL AND REPLACEMENT".

ALL DIMENSIONS ARE IN INCHES (MILLIMETERS) UNLESS OTHERWISE SHOWN.

CURB OR CURB AND GUTTER REMOVAL AND REPLACEMENT

REVISIONS	
NAME	DATE
A. HOUSEH	03/11/94
R. SHAH	02/24/95
R. SHAH	03/02/95
R. SHAH	08/19/96
R. SHAH	09/12/96
R. SHAH	09/19/96
R. SHAH	10/03/96
A. ABBAS	03/21/97
M. GOMEZ	01/22/01
R. BORO	01/01/07

ILLINOIS DEPARTMENT OF TRANSPORTATION

CURB OR CURB AND GUTTER REMOVAL AND REPLACEMENT

SCALE: VERT. NONE
HORIZ. 1" = 10'

DRAWN BY
CHECKED BY
BD600-06 (BD-24)

PLOT DATE: 8/18/2007
 FILE NAME: P:\Highway\Standard\AS\Standard\AS\std24.dgn
 PLOT SCALE: 1/8" = 1'-0"
 USER NAME: amaria