

F.A.P. RTE.	SECTION	COUNTY	TOTAL SHEETS	SHEET NO.
374	G-B-I-1	COOK	15	6
STA.	TO STA.			
FED. ROAD DIST. NO.	ILLINOIS	FED. AID PROJECT		

CONTRACT NO. 60D59

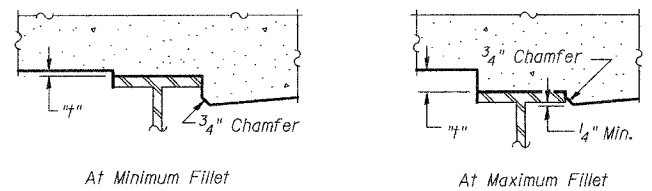

To determine fillet height "h", measure elevations at span quarter points as shown below after all steel has been erected. Add this number to the slab thickness and subtract the sum from the "Theoretical Grade Elev. Adjusted for Dead Load Deflection." This equals the fillet height above the beams.

**FILLET HEIGHTS**

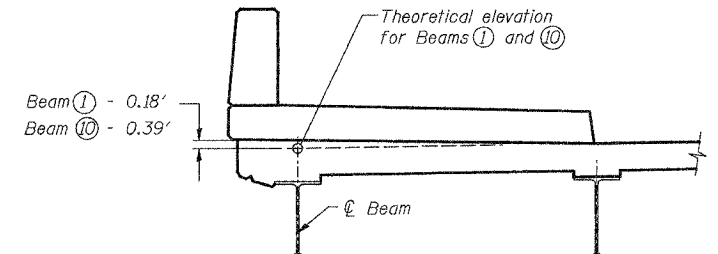

**SIDEWALK SECTION**

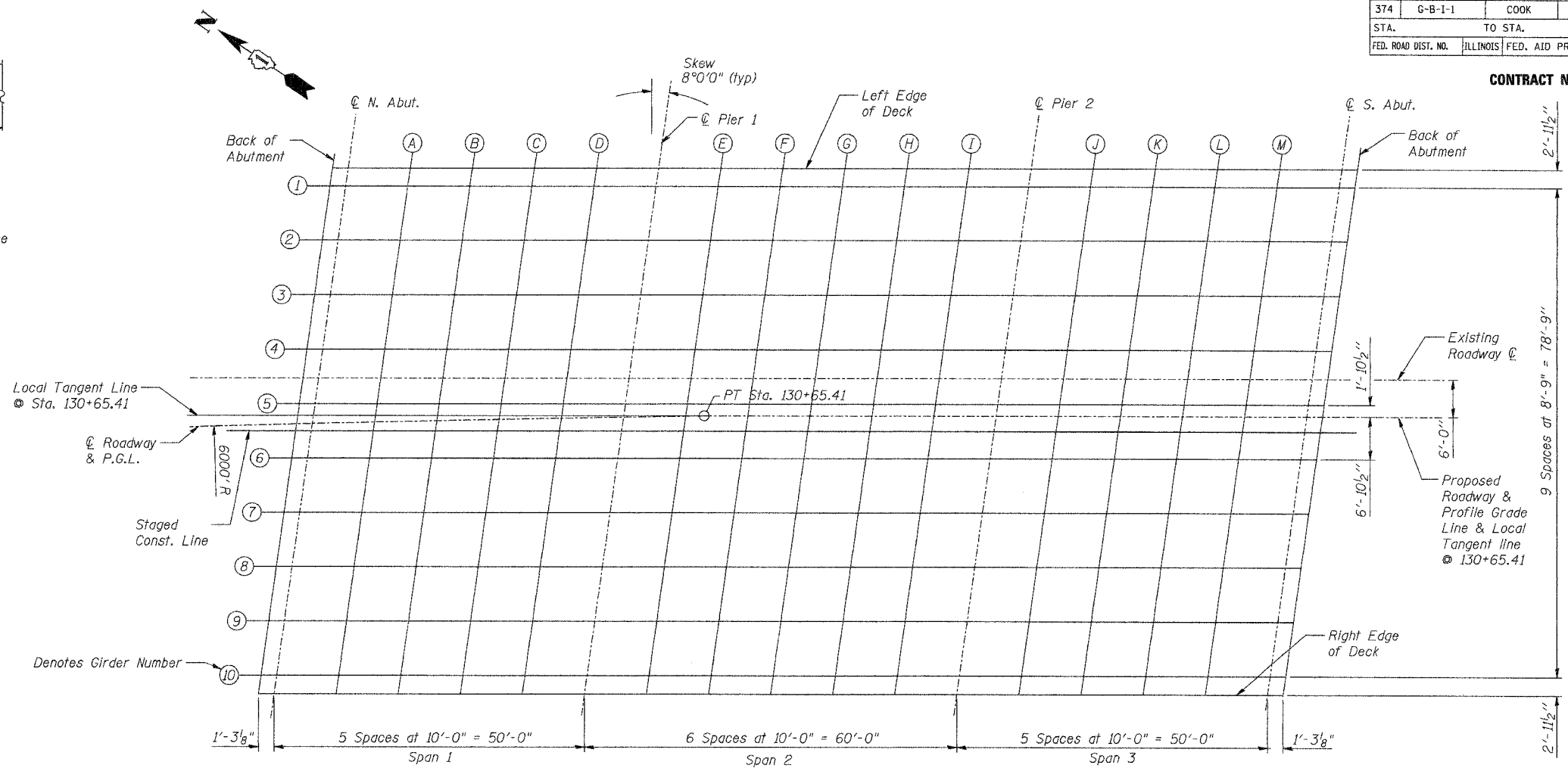

**PLAN**

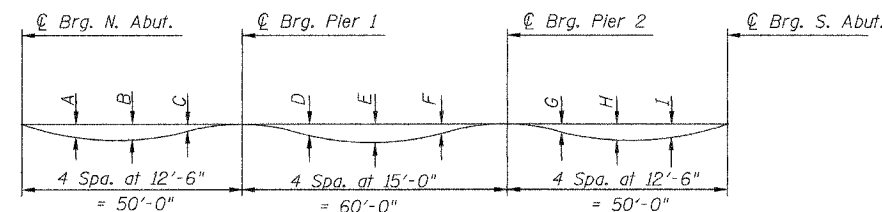

**DEAD LOAD DEFLECTION DIAGRAM**

(Includes weight of concrete only)

Note:  
The above deflections are not to be used in the field if the engineer is working from the grade elevations adjusted for dead load deflections as shown below. All dimensions are in inches except as noted. All offsets are in feet.

BEAM	A	B	C	D	E	F	G	H	I
Beams 1 through 10	0.34	0.42	0.20	0.22	0.39	0.22	0.20	0.42	0.34

FOR INFORMATION ONLY

Note:  
See Sheets 7 thru 10 for Deck Elevations.



REVISIONS	
NAME	DATE

ILLINOIS DEPARTMENT OF TRANSPORTATION  
ILLINOIS ROUTE 21  
MILWAUKEE AVE. OVER DES PLAINES RIVER  
F.A.P. ROUTE 374 SECTION G-B-I-1  
COOK COUNTY, SN 016-6566

SCREEN PLAN

DESIGN BY: AWH DRAWN BY: BTO  
DATE: 8/29/07 CHECKED BY: JAN CHECKED BY: JAN