

F.A.P. RTE.	SECTION	COUNTY	TOTAL SHEETS	SHEET NO.
846	4B-1-R	WILL	87	7
STA. 1301+00		TO STA. 1309+00		
FED. ROAD DIST. NO. 1 ILLINOIS FED. AID PROJECT				

CONTRACT No. 62269

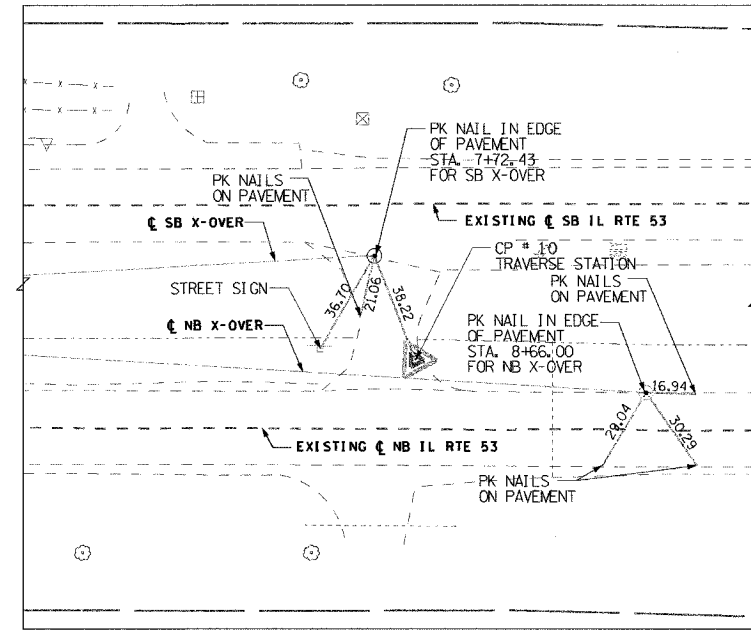
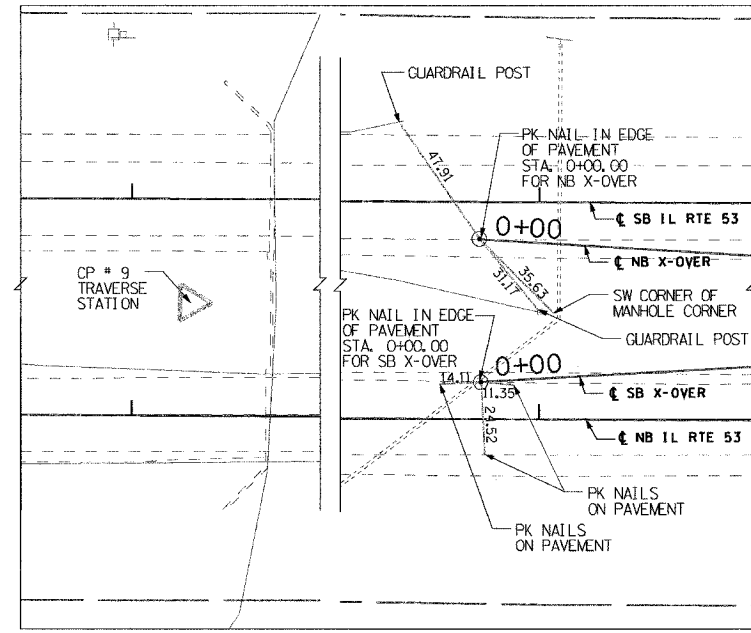
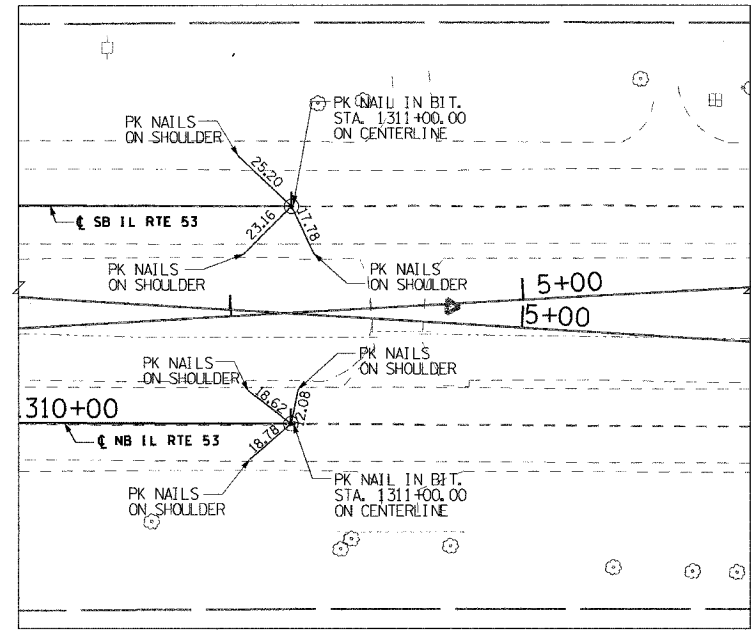
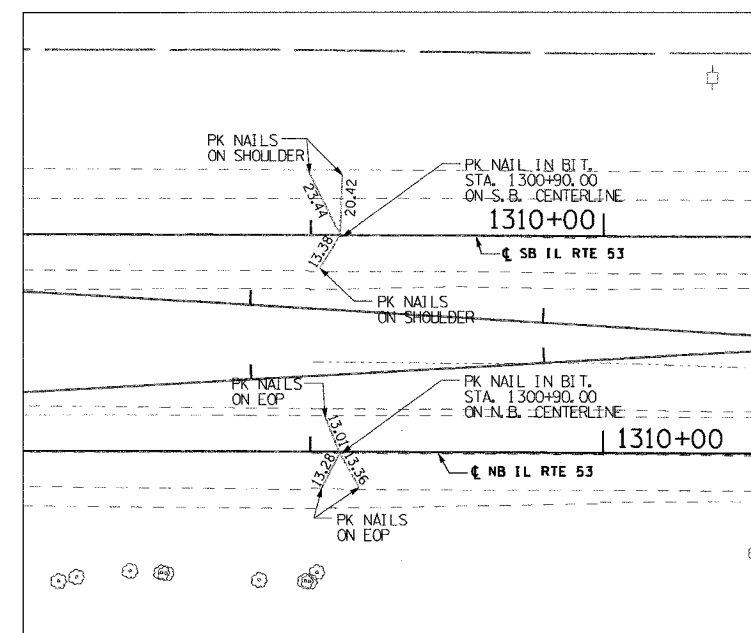
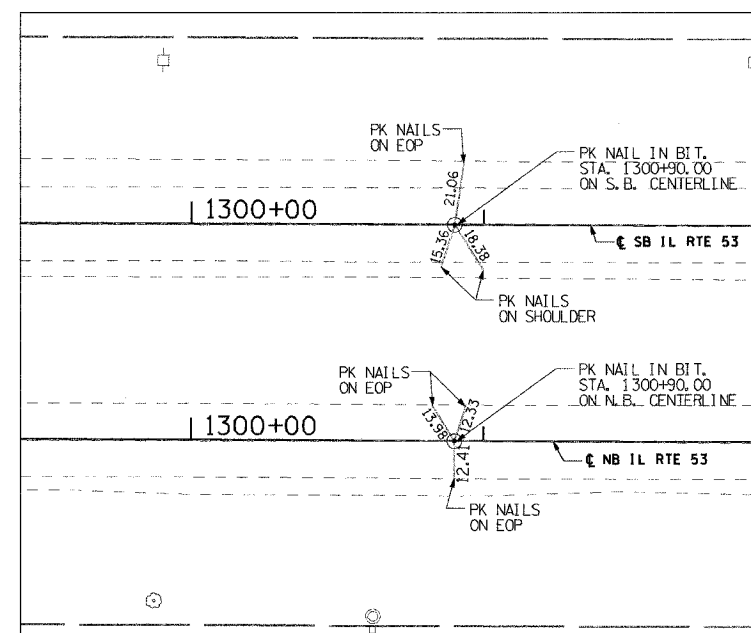
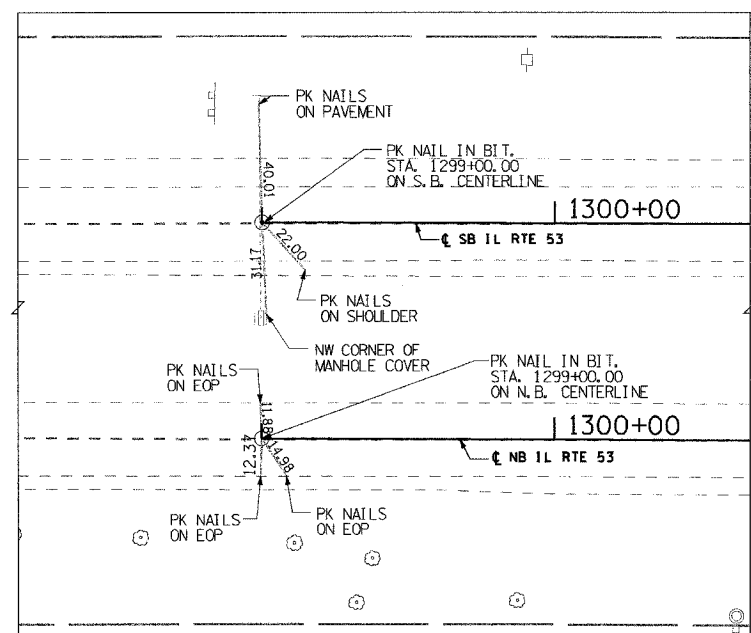

S.B.	Y	X
STA. 1299+00	1706900.329	1039024.937
STA. 1300+90	1707090.255	1039019.590
STA. 1309+10	1707909.933	1038996.514
STA. 1311+00	1708099.859	1038991.168

N.B.	Y	X
STA. 1299+00	1706902.502	1039098.814
STA. 1300+90	1707092.428	1039093.498
STA. 1309+10	1707912.110	1039070.554
STA. 1311+00	1708102.036	1039065.238

CROSS OVER NB	Y	X
STA. 0+00	1707680.035	1039015.680
STA. 8+66	1708545.683	1039040.434

CROSS OVER SB	Y	X
STA. 0+00	1707682.004	1039064.354
STA. 7+72.43	1708451.461	1038996.704

**STATE BENCHMARKS**

**BM#1**  
TOP CONCRETE R.O.W. MARKER @ NW CORNER OF N. RIVER RD. & IL53  
EL=562.77

**BM#2**  
A SQUARE CUT IN EAST EDGE OF PAVEMENT.  
N.B. IL53 @ STA 1295+00  
EL=568.72

**BM#3**  
A SQUARE CUT IN NORTHWEST WINGWALL OF SOUTHBOUND IL RT 53 BRIDGE  
EL=571.36

**BM#4**  
A SQUARE CUT IN EAST EDGE OF PAVEMENT.  
N.B. IL53 @ STA. 1311+00  
EL=573.39, OFFSET=12.27' (RT)

**BM#5**  
A SQUARE CUT IN TOP OF CONCRETE HEADWALL IN CENTER OF GRASS MEDIAN STA. 1315+15 SB IL53  
EL=573.65, OFFSET=44.0' (RT)

**BM#7**  
A CUT IN N/E CORNER OF WINGWALL ON NB IL RTE 53 BRIDGE STA. 1305+54.64'  
EL=570.41, OFFSET=18.10' (RT)

**CP#9**  
N = 1707421.097  
E = 1039045.760  
EL = 571.31

**CP#10**  
N = 1708466.577  
E = 1039031.733  
EL = 575.28

REVISIONS	
NAME	DATE

ILLINOIS DEPARTMENT OF TRANSPORTATION  
IL RTE 53 OVER PRAIRIE CREEK

ALIGNMENT, TIES AND BENCHMARKS

SCALE: \_\_\_\_\_  
DATE: AUGUST 2007

DRAWN BY: DK  
CHECKED BY: MK/SMK