

F.A.P. RTE.	SECTION	COUNTY	TOTAL SHEETS	SHEET NO.
846	4B-1-R	WILL	87	9
STA.	1301+00	TO STA.	1309+00	
FED. ROAD DIST. NO. 1	ILLINOIS	FED. AID PROJECT		

CONTRACT No. 62269

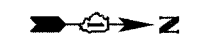

**NOTES:**

- PRIOR TO STAGE I OR II CONSTRUCTION, TEMPORARY WIDENING SHOULD BE CONSTRUCTED AND ADVANCE NOTICE CONSTRUCTION SIGNS INSTALLED. THE COST OF ADVANCE NOTICE CONSTRUCTION SIGNS WILL BE INCLUDED WITH THE TRAFFIC CONTROL AND PROTECTION (SPECIAL) PAY ITEM.
- ALL ADVANCE SIGNING, LANE CLOSURE, BARRICADING, PER STANDARD 701416-02.
- THE COST OF ADDITIONAL SIGNS AND SIGNS TO BE COVERED WILL BE INCLUDED WITH TRAFFIC CONTROL AND PROTECTION (SPECIAL) PAY ITEM.
- ALL TRAFFIC CONTROL FOR THIS PROJECT (STAGE I & II) WILL BE PAID AS TRAFFIC CONTROL AND PROTECTION (SPECIAL) PER LUMP SUM.
- IDOT SHALL BE NOTIFIED 72 HOURS PRIOR TO PUTTING THE TRAFFIC CONTROL IN EFFECT AND IMMEDIATELY AFTER THE TRAFFIC CONTROL HAS BEEN REMOVED.
- THE CONTRACTOR SHALL FURNISH, INSTALL, MAINTAIN AND REMOVE ALL TEMPORARY SIGN SUPPORTS. AFTER REMOVING THE SUPPORTS, THE CONTRACTOR SHALL FILL HOLES (IF ANY) AND RESTORE THE GROUND TO ITS ORIGINAL CONDITIONS AND ELEVATION. LACING OF GRAVEL, SOD OR SEED SHALL BE INCLUDED IN THE UNIT BID PRICE FOR "TRAFFIC & PROTECTION" (SPECIAL).
- ALL SIGNS, SUPPORTS AND POSITIONING SHALL BE IN ACCORDANCE WITH THE ILLINOIS MANUAL ON UNIFORM TRAFFIC CONTROL DEVICES, LATEST EDITION.
- ALL EXISTING SIGNS THAT CONFLICT WITH THE TRAFFIC CONTROL SHALL BE COVERED.
- THE CONTRACTOR SHALL MAINTAIN THE ACCESS TO THE DRIVEWAYS, SIDE STREETS AND OTHER ENTRANCES THROUGH OUT THE CONSTRUCTION PERIOD WITH PROPER SAFETY MEASURES.
- THE TEMPORARY FILL FURNISHED EXCAVATION WILL BE REMOVED AFTER WORK IS COMPLETED. ROADWAY, SLOPE AND SOD WILL BE RESTORED TO IT'S ORIGINAL CONDITION.

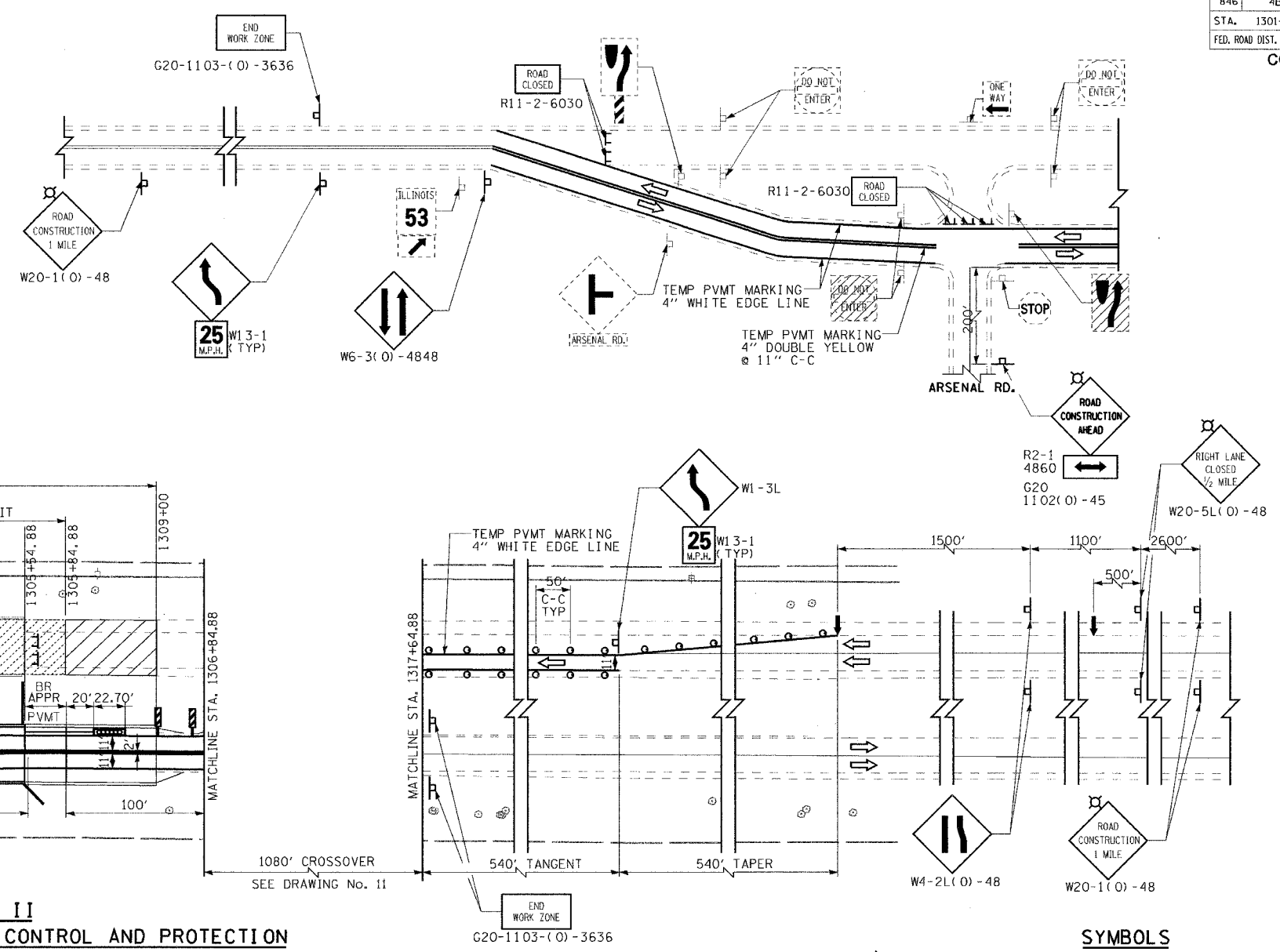

**STAGE II  
CONSTRUCTION AND TRAFFIC CONTROL AND PROTECTION**

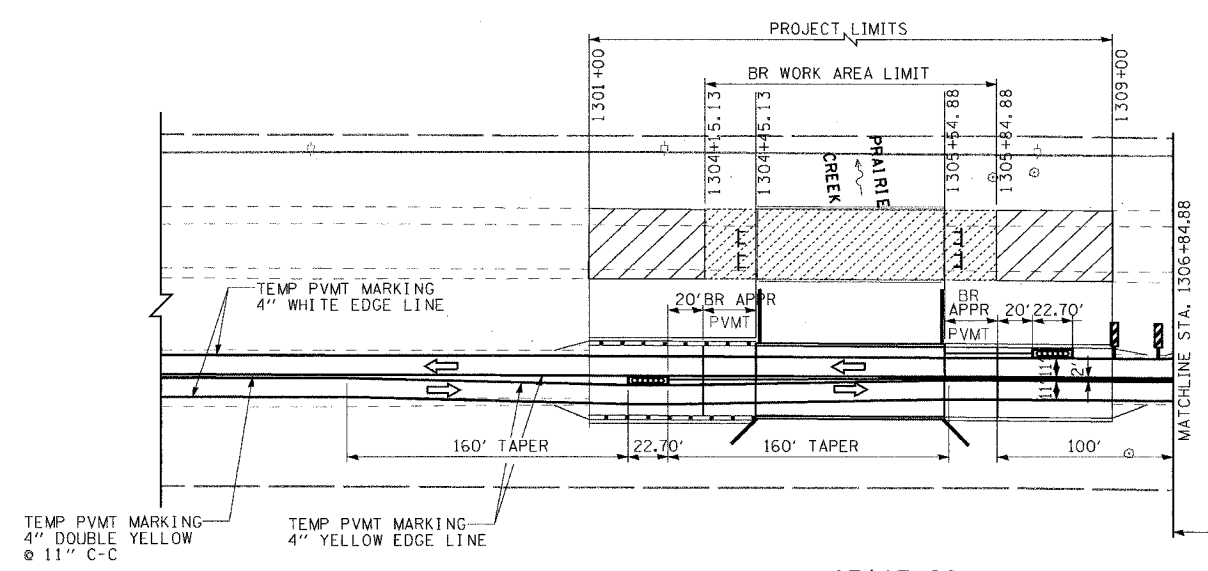

**TOTAL  
SCHEDULE OF QUANTITIES**

ITEM	UNIT	QUANT
REMOVAL AND DISPOSAL OF UNSUITABLE MATERIAL	CU YD	540
FURNISHED EXCAVATION (TEMP)	CU YD	12706
SEEDING, CLASS 4	ACRE	0.67
TEMPORARY EROSION CONTROL SEEDING	POUND	10
TEMPORARY AGGREGATE SHOULDER, TYPE B, 6"	SO YD	1440
TEMPORARY PIPE CULVERT, CLASS A, TYPE 2, 15" DIA	FOOT	440
TRAFFIC CONTROL AND PROTECTION (SPECIAL)	L SUM	1
TRAFFIC CONTROL SURVEILLANCE	CAL DA	316
TEMPORARY PAVEMENT MARKING LINE 4"	FOOT	146366
TEMPORARY CONCRETE BARRIER	FOOT	1370
RELOCATE TEMPORARY CONCRETE BARRIER	FOOT	760
MONODIRECTIONAL PRISMATIC BARRIER REFLECTOR	EACH	138
PAINT PAVEMENT MARKING LINE 4"	FOOT	4758
PAVEMENT MARKING REMOVAL (EXISTING)	SO FT	144644
TEMPORARY INFORMATION SIGNING	SO FT	55
HOT-MIX ASPHALT SURFACE COURSE, MIX D, N 50,	TON	222
HOT-MIX ASPHALT BINDER COURSE, IL-19, N 50,	TON	1552

**STAGE II  
SCHEDULE OF QUANTITIES**

ITEM	UNIT	QUANT
REMOVAL AND DISPOSAL OF UNSUITABLE MATERIAL	CU YD	270
FURNISHED EXCAVATION (TEMP)	CU YD	6353
SEEDING, CLASS 4	ACRE	-
TEMPORARY EROSION CONTROL SEEDING	POUND	5
TEMPORARY AGGREGATE SHOULDER, TYPE B, 6"	SO YD	720
TEMPORARY PIPE CULVERT, CLASS A, TYPE 2, 15" DIA	FOOT	-
TRAFFIC CONTROL AND PROTECTION (SPECIAL)	L SUM	0.5
TRAFFIC CONTROL SURVEILLANCE	CAL DA	158
TEMPORARY PAVEMENT MARKING LINE 4"	FOOT	73282
TEMPORARY CONCRETE BARRIER	FOOT	-
RELOCATE TEMPORARY CONCRETE BARRIER	FOOT	-
MONODIRECTIONAL PRISMATIC BARRIER REFLECTOR	EACH	-
PAINT PAVEMENT MARKING LINE 4"	FOOT	2160
PAVEMENT MARKING REMOVAL (EXISTING)	SO FT	71122
TEMPORARY INFORMATION SIGNING	SO FT	55
HOT-MIX ASPHALT SURFACE COURSE, MIX D, N 50,	TON	111
HOT-MIX ASPHALT BINDER COURSE, IL-19, N 50,	TON	776

**SYMBOLS**

- ↑ ARROW BOARD
- ▨ WORK AREA
- ⊥ SIGN ON PORTABLE OR PERMANENT SUPPORT
- ⊙ DRUM WITH STEADY BURNING MONODIRECTIONAL LIGHT
- ⊞ VERTICAL PANEL
- ⊞ TYPE III BARRICADE WITH FLASHING LIGHTS
- TEMPORARY CONCRETE BARRIER
- DIRECTION OF TRAFFIC
- ▬ IMPACT ATTENUATOR (TEMPORARY)
- ⊞ EXISTING SIGN
- ⊞ EXISTING SIGN TO BE COVERED WITH TARPS AND SECURED WITH BUNGEE CORDS
- ⊞ TRAFFIC CONTROL SIGN
- ⊞ MONODIRECTIONAL FLASHING BEACON

**NOTE**

- FOR CROSSOVER ROAD TYPICAL SECTION, SEE SHT. No. 6.
- 1s+ TWO WARNING SIGNS NEED MONODIRECTIONAL FLASHING BEACONS (TYP).

REVISIONS	DATE

ILLINOIS DEPARTMENT OF TRANSPORTATION  
 IL RTE 53 OVER PRAIRIE CREEK  
 SUGGESTED STAGES  
 OF CONSTRUCTION AND  
 TRAFFIC CONTROL  
 SOUTHBOUND

SCALE: 1"=50'  
 DATE: AUGUST 2007

DRAWN BY: JLA/RM/FZ  
 CHECKED BY: MK/SMK