

STATE OF ILLINOIS
DEPARTMENT OF TRANSPORTATION

ROUTE NO.	SECTION	COUNTY	FED. AID DIST. NO.	SHEET NO.	SHEET NO. S18 SHEETS S20
F. A. P. 846	4-RB	WILL	87	46	
FED. ROAD DIST. NO. 7		ILLINOIS	FED. AID PROJECT		

CONTRACT NO. 62269

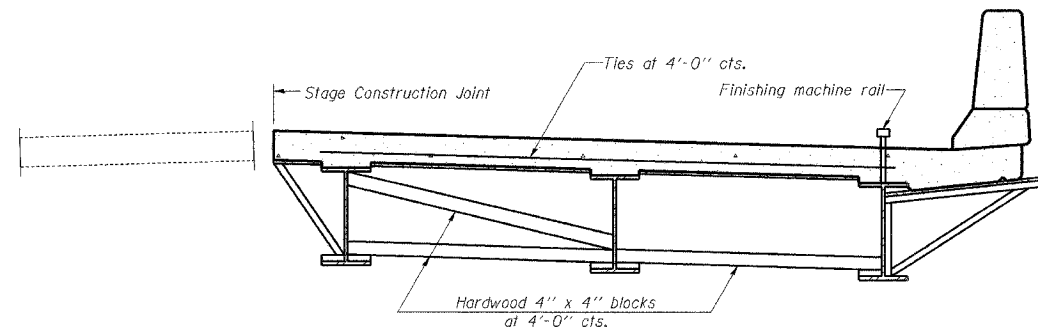

**FORM BRACES FOR
STAGE CONSTRUCTION**

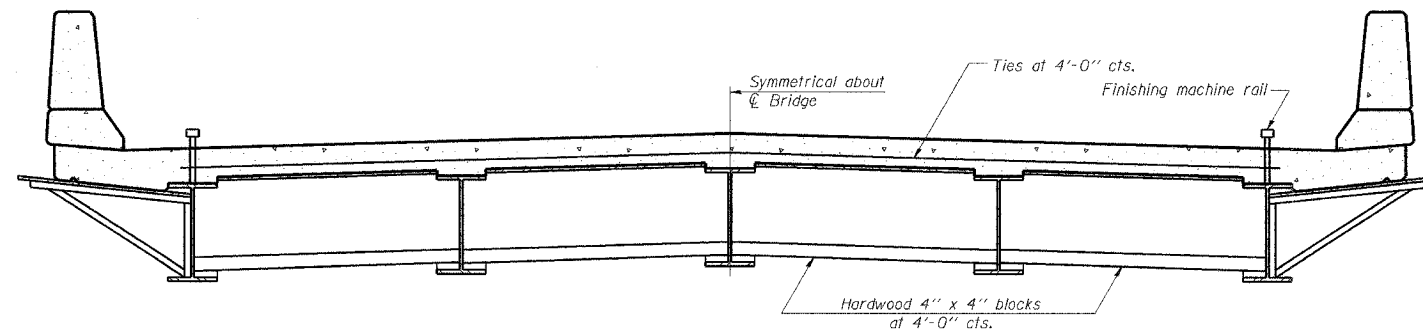

**FORM BRACES FOR
STANDARD CONSTRUCTION**

When cantilever forming brackets are used, the work shall be done according to Article 503.06(b) of the Standard Specifications, except as modified below and in the details shown on this sheet.

The finishing machine rails shall be placed on the top flange of the exterior beams.

The beams or girders, supporting cantilever forming brackets, shall be tied together at 4 foot intervals.

For Standard construction, or Stage Construction the Hardwood bracing materials shall be placed as shown between webs of beams in each bay.

DESIGNED	NDS/GMK
CHECKED	MTP/SMK/GBC
DRAWN	NDS/DCB
CHECKED	SMK/GBC

SB-1 11-1-06

ILLINOIS DEPARTMENT OF TRANSPORTATION

**CANTILEVER FORMING BRACKETS
FOR SUPERSTRUCTURES**

FAP 846
NB IL. ROUTE 53 OVER PRAIRIE CREEK
STATION 1305+00 SECTION 4-RB
WILL COUNTY

STRUCTURE NO. 099-0090

SCALE: NONE
DATE: AUGUST 2007

 DELTA ENGINEERING INC.
CONSULTING ENGINEERS, CHICAGO, ILLINOIS.