

STATE OF ILLINOIS
DEPARTMENT OF TRANSPORTATION

| | | | | | |
|-----------------------|----------|------------------|--------------------|-----------|----------------------------|
| ROUTE NO. | SECTION | COUNTY | TOTAL SHEETS | SHEET NO. | SHEET NO. 53 SHEETS 517 |
| F. A. P. 846 | 4B-1-R | WILL | 87 | 51 | |
| FED. ROAD DIST. NO. 7 | ILLINOIS | FED. AID PROJECT | CONTRACT NO. 62269 | | |

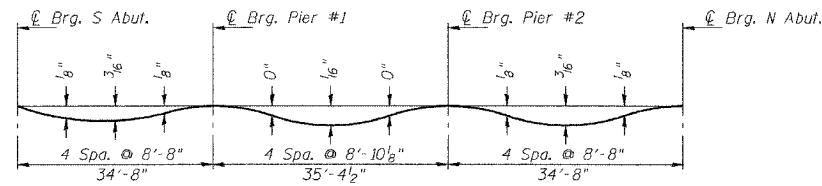

DEAD LOAD DEFLECTION DIAGRAM

(Includes weight of concrete only.)

Note: The above deflections are not to be used in the field if the engineer is working from the grade elevations adjusted for dead load deflections as shown below.

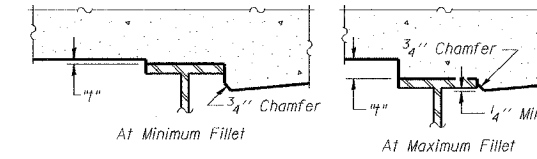

To determine "I": After all structural steel has been erected, elevations of the top flanges of the beams shall be taken at intervals shown below. These elevations subtracted from the "Theoretical Grade Elevations Adjusted for Dead Load Deflection" shown below, minus slab thickness, equals the fillet heights "I" above top flange of beams.

FILLET HEIGHTS

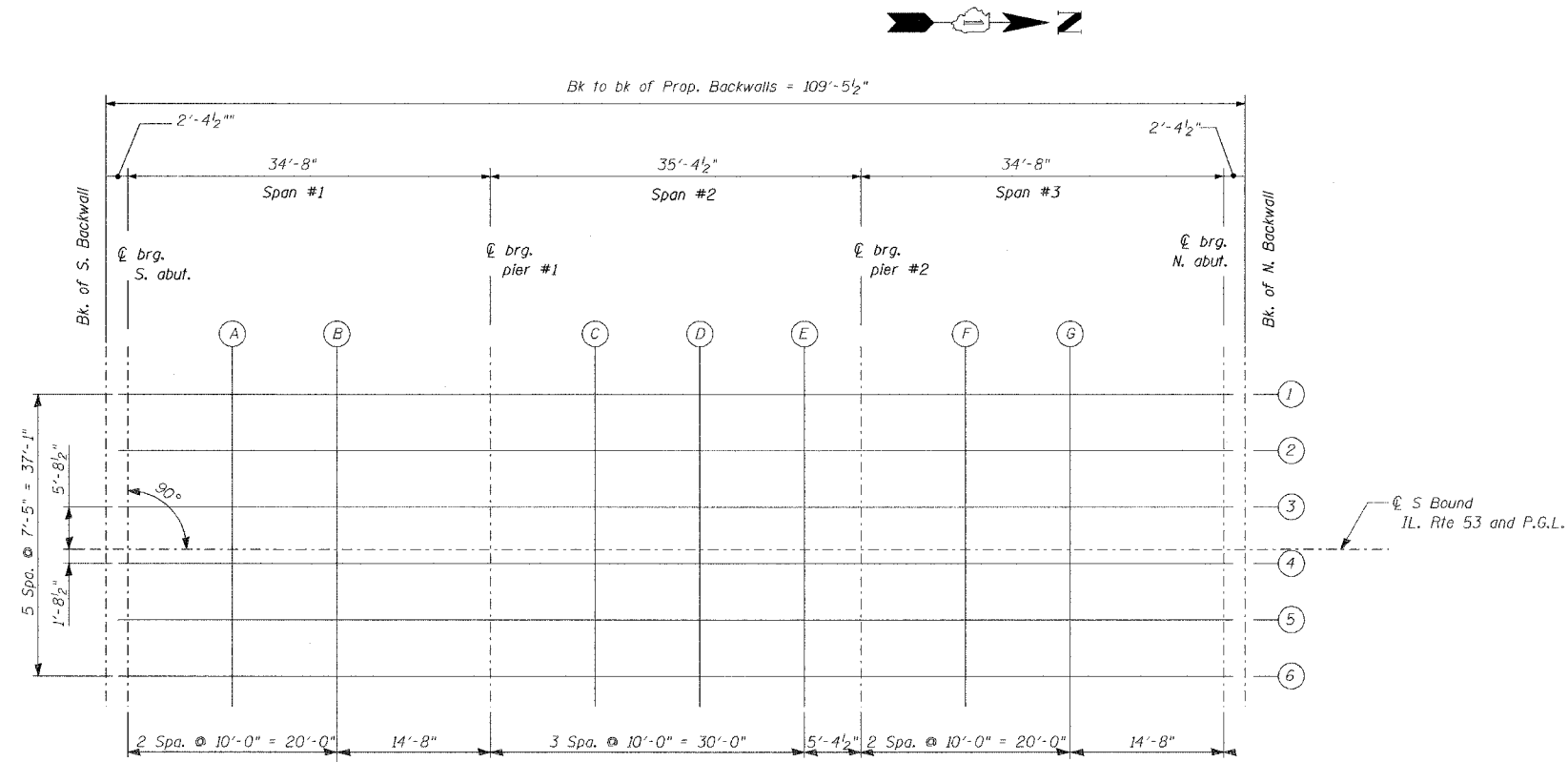

PLAN

| | |
|----------|-------------|
| DESIGNED | NDS/GMK |
| CHECKED | MTP/SMK/GBC |
| DRAWN | NDS/GMK |
| CHECKED | SMK/GBC |

ILLINOIS DEPARTMENT OF TRANSPORTATION

TOP OF DECK ELEVATION AND LAYOUT OF ELEVATION LINES

FAP 846
SB IL. ROUTE 53 OVER PRAIRIE CREEK
STATION 1305+00 SECTION 4B-1-R
WILL COUNTY
STRUCTURE NO. 099-0242

SCALE: NONE
DATE: AUGUST 2007

DEI DELTA ENGINEERING INC.
CONSULTING ENGINEERS, CHICAGO, ILLINOIS.