

STATE OF ILLINOIS  
DEPARTMENT OF TRANSPORTATION

ROUTE NO.	SECTION	COUNTY	SHEET NO.	SHEET NO. S16
F. A. P. 846	4B-1-R	WILL	87	64
FED. ROAD DIST. NO. 7	ILLINOIS	FED. AID PROJECT		SHEETS S17

CONTRACT NO. 62269

When cantilever forming brackets are used, the work shall be done according to Article 503.06(b) of the Standard Specifications, except as modified below and in the details shown on this sheet.  
The finishing machine rails shall be placed on the top flange of the exterior beams.  
The beams or girders, supporting cantilever forming brackets, shall be tied together at 4 foot intervals.  
For Standard construction, or Stage Construction the Hardwood bracing materials shall be placed as shown between webs of beams in each bay.

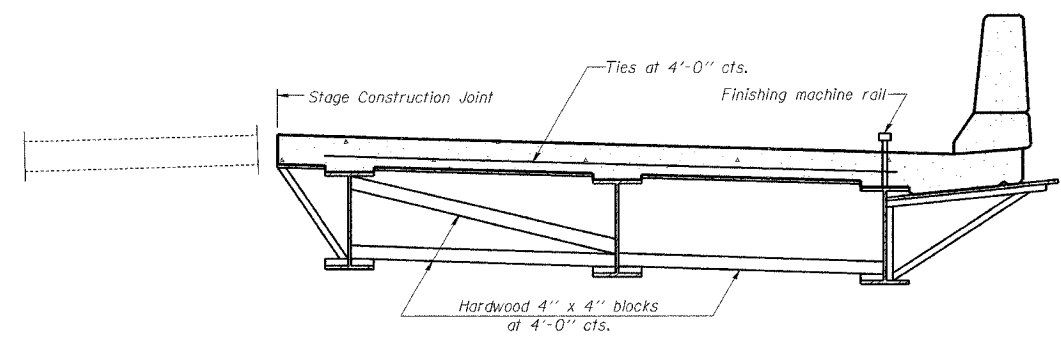

**FORM BRACES FOR  
STAGE CONSTRUCTION**

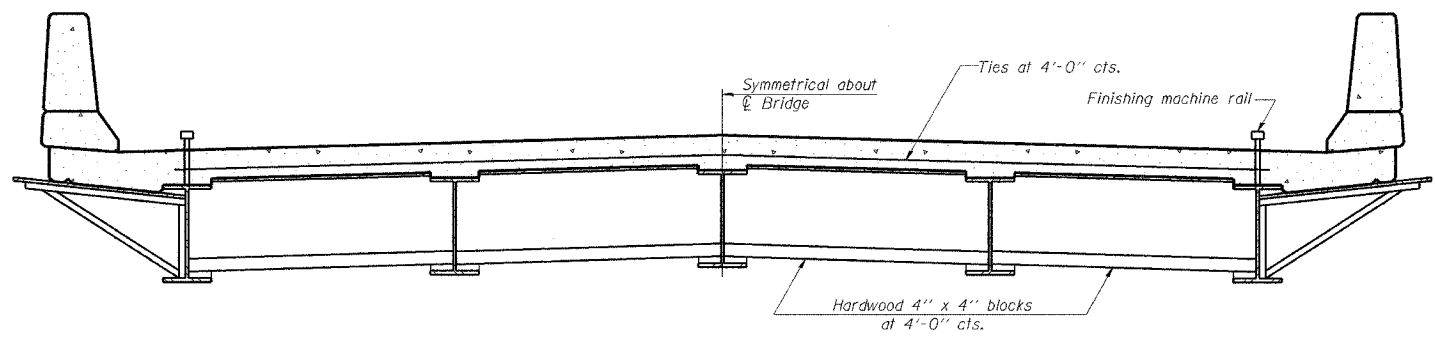

**FORM BRACES FOR  
STANDARD CONSTRUCTION**

DESIGNED	NDS/GMK
CHECKED	MTP/SMK/GBC
DRAWN	NDS/GMK
CHECKED	SMK/GBC
SB-1	11-1-06

ILLINOIS DEPARTMENT OF TRANSPORTATION

**CANTILEVER FORMING BRACKETS  
FOR SUPERSTRUCTURES**

FAP 846  
SB IL. ROUTE 53 OVER PRAIRIE CREEK  
STATION 1305+00 SECTION 4B-1-R  
WILL COUNTY

STRUCTURE NO. 099-0242

SCALE: NONE  
DATE: AUGUST 2007

**DEI** DELTA ENGINEERING INC.  
CONSULTING ENGINEERS, CHICAGO, ILLINOIS.