

STATE OF ILLINOIS
DEPARTMENT OF TRANSPORTATION

PROJECT NO.	SECTION	DATE	SHEET NO.	TOTAL SHEETS
99-0242	4B-1-R	WILL	32	5

SHEET NO. 65A
9 SHEETS

EXISTING STRUCTURE TO BE REMOVED AND REPLACED BY TWO 17'-0" WIDE ABUTMENTS WITH A 17'-0" WIDE PRECAST PRESTRESSED CONCRETE DECK BEAM BRIDGE. THE BRIDGE SHALL BE CONSTRUCTED WITH A 17'-0" CLEARANCE OVER THE EXISTING STRUCTURE. THE BRIDGE SHALL BE CONSTRUCTED WITH A 17'-0" CLEARANCE OVER THE EXISTING STRUCTURE. THE BRIDGE SHALL BE CONSTRUCTED WITH A 17'-0" CLEARANCE OVER THE EXISTING STRUCTURE.

GENERAL NOTES

- All structural steel shall be shop painted with two coats of basic lead silico chromate paint.
- It shall be the responsibility of the Contractor to verify all dimensions and conditions existing in the field prior to construction and ordering of materials.
- The top surface of the beams shall be finished in accordance with Article 505.06 of the Standard Specifications except that the surface shall not be roughened by brooming. The finished surface shall be free of depressions or high spots with sharp corners.
- The concrete rail section above the mandatory construction joint at the top of the slab shall be constructed of Class X Concrete, except the aggregates shall conform to the requirements of Handrail Concrete.
- Protective Coat shall not be applied to surfaces to which Waterproofing Membrane System is applied.
- The back face of closed abutments and wing walls shall be waterproofed according to Art. 503.11 of the Standard Specifications.
- Expansion bolts shall consist of self drilling expansion anchors and 3/4" x 12" hooked bolts.

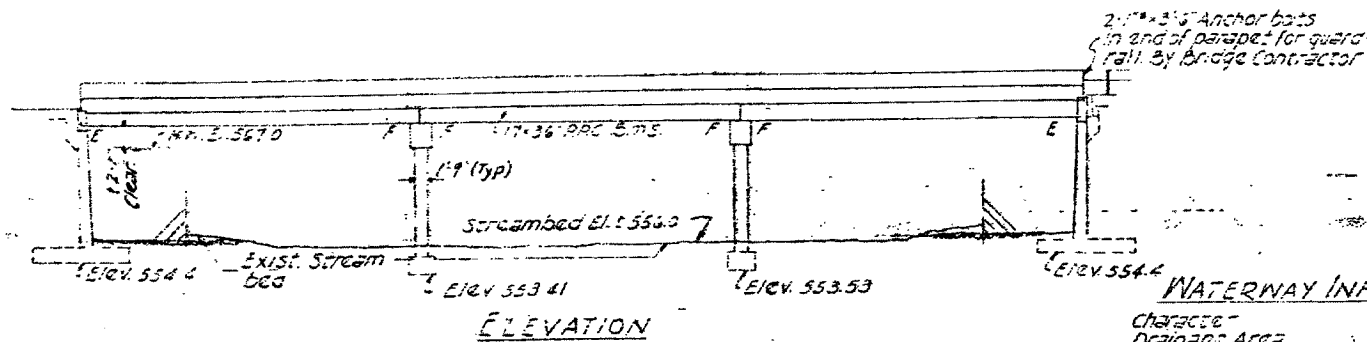

WATERWAY INFORMATION

Channel	Rating, Clay & cultivated
Drainage Area	45 Sq. Miles
Present Opening	450 Sq. Ft.
Required Opening	610 Sq. Ft.
Proposed Opening	1053 Sq. Ft.
Clear	2475 C.F.S.
Clear	2310 C.F.S.
Created Head	0.24 Single Struct.
Created Head	0.35 Dual Struct.
All Time H.W.E.C.	567.7

TOTAL BILL OF MATERIAL

Item	Unit	Super	Sub	Total
Bituminous Concrete Surface Course, Class I	Tons	54		54
Removal of Existing Structures	Each			1
Rock Excavation for Structures	Cu. Yds.		28	28
Protective Coat	Sq. Yds.	85		85
Precast Prestressed Concrete Deck Beams (17)	Sq. Ft.	4440		4440
Structural Steel	Lbs.	5680		5680
Class X Concrete	Cu. Yds.	261	317.7	578.7
Reinforcement Bars	Lbs.	2850	23020	25870
Name Plates	Each			1
Waterproofing Membrane System	Sq. Yds.	452		452
Preformed Joint Sealer (22)	Lin. Ft.	86		86
Portland Cement Mortar Finishing Course	Lin. Ft.	1374		1374
Concrete Removal	Cu. Yds.		10	10
Expansion Bolts 3/4"	Each		12	12
Structure Excavation	Cu. Yds.		520	520

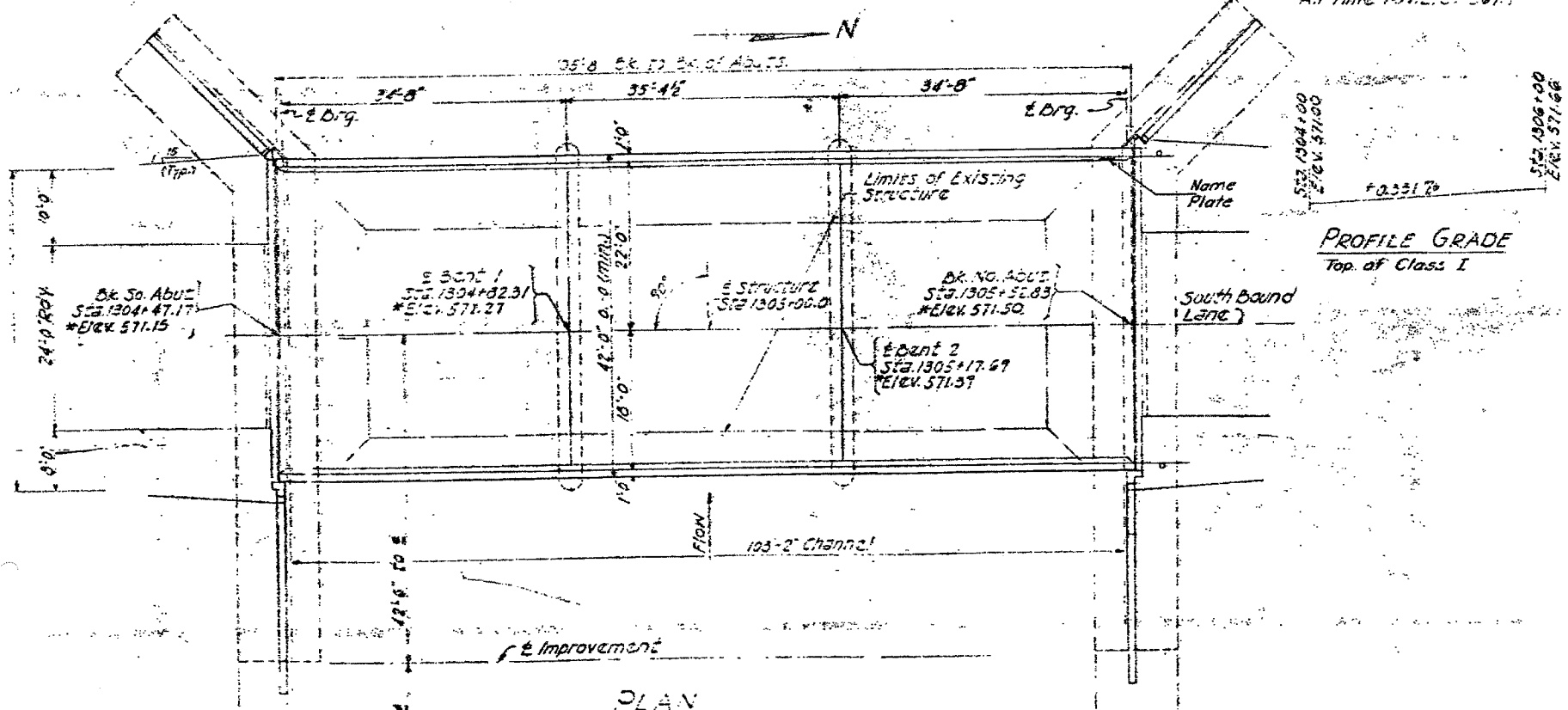

PROFILE GRADE
Top of Class I

PLAN

*Elevations are top of class I

DESIGN STRESSES

FIELD UNITS

Curb & Parapet
F_c = 1400 psi
F_s = 20,000 psi (Reinf.)
Aqueducts & Piers
(Load Factor 1.0)
F_c = 1500 psi
F_s = 20,000 psi (Reinf.)
n = 8.5

PRECAST PRESTRESSED UNITS

G 5000 psi
F 20,000 psi
F 20,000 psi
F 20,000 psi
F 20,000 psi

STATION 1305+00.00
BUILT 1978 BY
STATE OF ILLINOIS
FA. RT. 5 SEC. 4B-1-R
PROJ. F-846(11)
LOADING HS 20

NAME PLATE

See Std 2.13

DESIGNED	J. M. J. Lee
CHECKED	
DRAWN	
CHECKED	

EXAMINED	
PASSED	
APPROVED	

SOUTHBOUND BRIDGE
STRUCTURE NO. 099-0242
EXISTING PLANS

FOR REFERENCE ONLY