

DISTRICT ONE-PLAN PREPARATION ENGINEER K. ENG / LONG TRAN (847) 705-4240

F.A.P. RTE.	SECTION	COUNTY	TOTAL SHEETS	SHEET NO.
852	18 B-5-R-2	WILL	66	1
CONTRACT NO. 62845			67	

STATE OF ILLINOIS
DEPARTMENT OF TRANSPORTATION
DIVISION OF HIGHWAYS

PROPOSED HIGHWAY PLANS

FOR INDEX OF SHEETS, SEE SHEET NO. 2

D-91-010-05

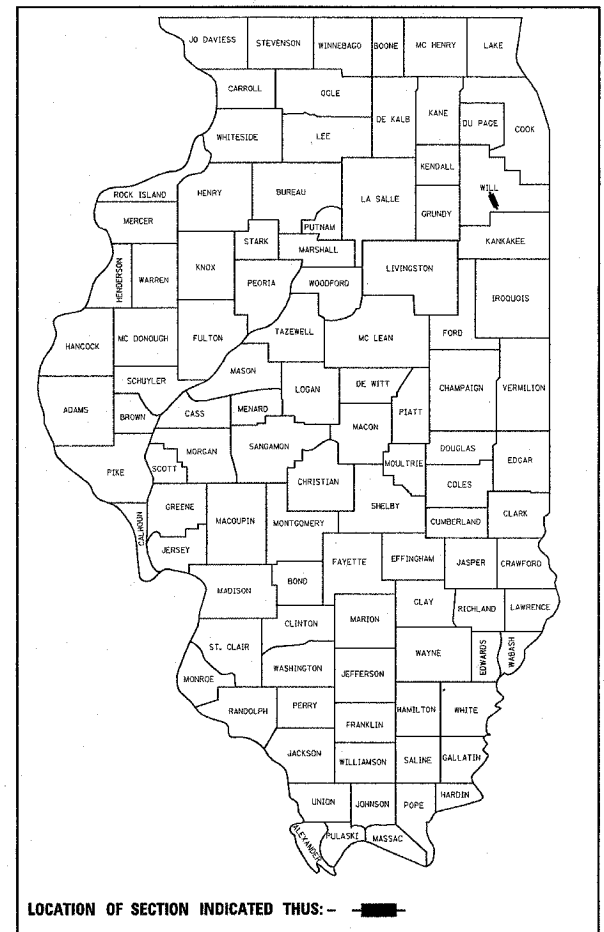

**F.A.P. ROUTE 852: US 52 (STATE STREET)
AT PRAIRIE CREEK
SECTION: 18 B-5-R-2
BRIDGE REPLACEMENT & ROADWAY REPROFILING
SN: 099-4643
PROJECT: ACBRF-0852(010)
WILL COUNTY
C-91-010-05**

PROJECT IS LOCATED IN
UNINCORPORATED MANHATTAN TOWNSHIP

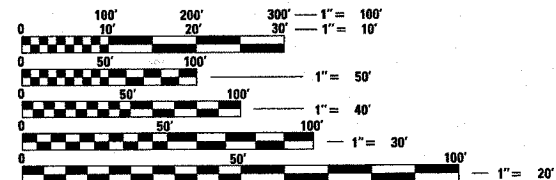

FULL SIZE PLANS HAVE BEEN PREPARED USING STANDARD ENGINEERING SCALES. REDUCED SIZED PLANS WILL NOT CONFORM TO STANDARD SCALES. IN MAKING MEASUREMENTS ON REDUCED PLANS, THE ABOVE SCALES MAY BE USED.

J.U.L.I.E.
JOINT UTILITY LOCATION INFORMATION FOR EXCAVATION
1-800-892-0123

CONTRACT NO. 62845

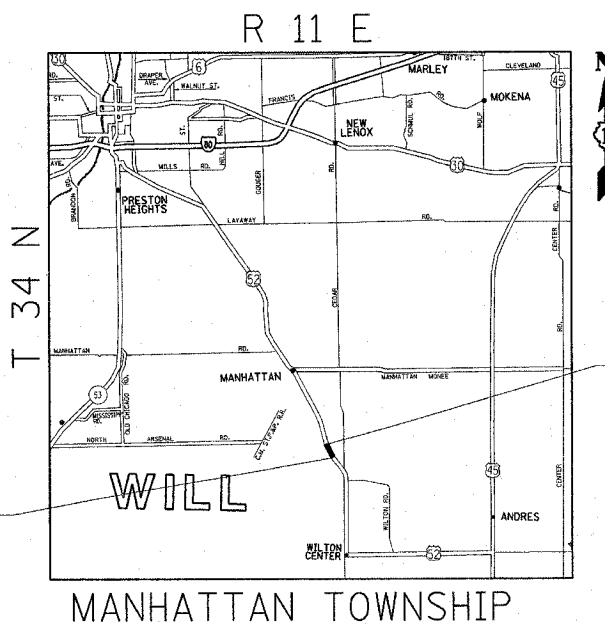

TRAFFIC DATA
SPEED LIMIT: 55 MPH
2005 ADT: 3650

PROJECT BEGINS
STA 1001+94

PROJECT ENDS
STA 1014+56

MANHATTAN TOWNSHIP

GROSS AND NET LENGTH OF PROJECT = 1262 FEET (0.2 MILES)

STATE OF ILLINOIS
DEPARTMENT OF TRANSPORTATION
DIVISION OF HIGHWAYS

SUBMITTED August 22 2007
Diane O'Keefe/cd
DEPUTY DIRECTOR OF HIGHWAYS, REGION ENGINEER

October 12, 2007
Eric S. Harms
INTERIM ENGINEER OF DESIGN AND ENVIRONMENT

October 12, 2007
Milton R. Sees, P.E.
DIRECTOR OF HIGHWAY, CHIEF ENGINEER

**PRINTED BY THE AUTHORITY
OF THE STATE OF ILLINOIS**