

F.A.P. RTE.	SECTION	COUNTY	TOTAL SHEETS	SHEET NO.
852	18-B-5-R-2	WILL	66	18
STA.		TO STA.		
FED. ROAD DIST. NO.		ILLINOIS FED. AID PROJECT		

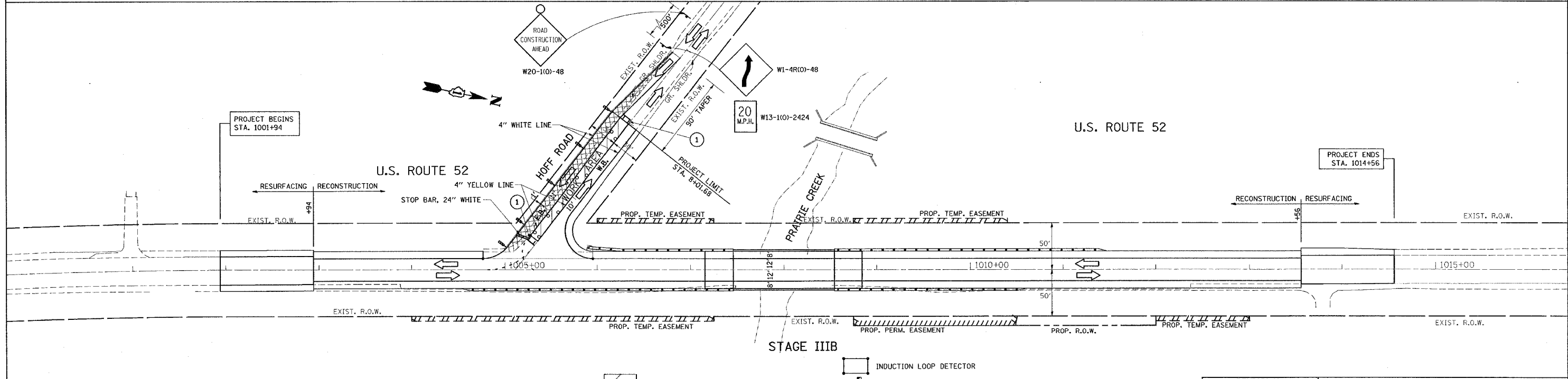
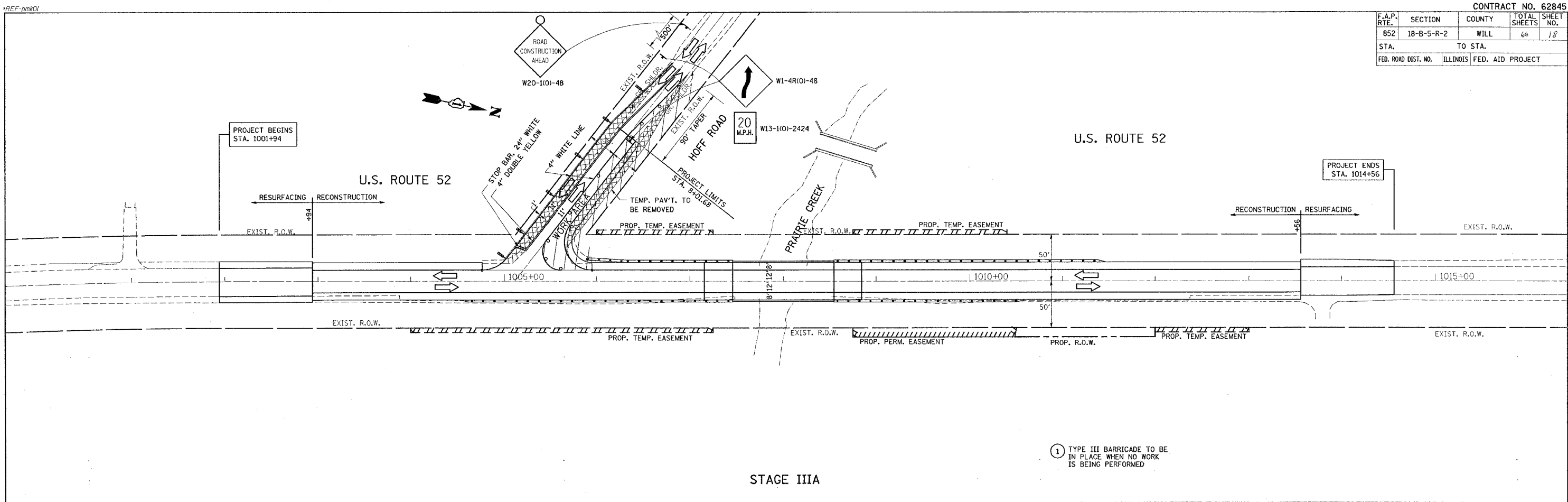

- WORK AREA
- SIGN
- TYPE III BARRICADE
- DRUM WITH STEADY BURNING LIGHT
- TRAFFIC SIGNAL
- TEMPORARY RUMBLE STRIP (WHEN SPECIFIED)
- INDUCTION LOOP DETECTOR
- DOUBLE VERTICAL PANEL
- TYPE C BIDIRECTIONAL REFLECTOR
- TEMPORARY CONCRETE BARRIER
- IMPACT ATTENUATOR
- STEADY BURNING LIGHTS AND DOUBLE VERTICAL PANELS
- TEMP. HMA PAVEMENT

NOTE:
 TEMPORARY PAVEMENT SHALL CONSIST OF
 1 3/4" HOT-MIX ASPHALT SURFACE COURSE, MIX. D, N50 (IL 9.5 mm)
 9 3/4" HOT-MIX ASPHALT BASE COURSE (HMA BINDER IL 19 mm)

REVISIONS	
NAME	DATE

ILLINOIS DEPARTMENT OF TRANSPORTATION
 SUGGESTED STAGING
 AND TRAFFIC CONTROL PLAN
 STAGE IIIA AND STAGE IIIB

SCALE: VERT. 1"=50'
 HORIZ. 1"=50'
 DATE 8/10/2007

DRAWN BY
 CHECKED BY

PLOT DATE = 8/10/2007
 FILE NAME = c:\projects\1419801\sh.stg\stagegn
 PLOT SCALE = 1/8"=1'-0"
 USER NAME = jsteeber