

F.A.U. RTE.	SECTION	COUNTY	TOTAL SHEETS	SHEET NO.
852	18-B-5-R-2	WILL	66	26
STA.		TO STA.		
FED. ROAD DIST. NO. 1		ILLINOIS FED. AID PROJECT		

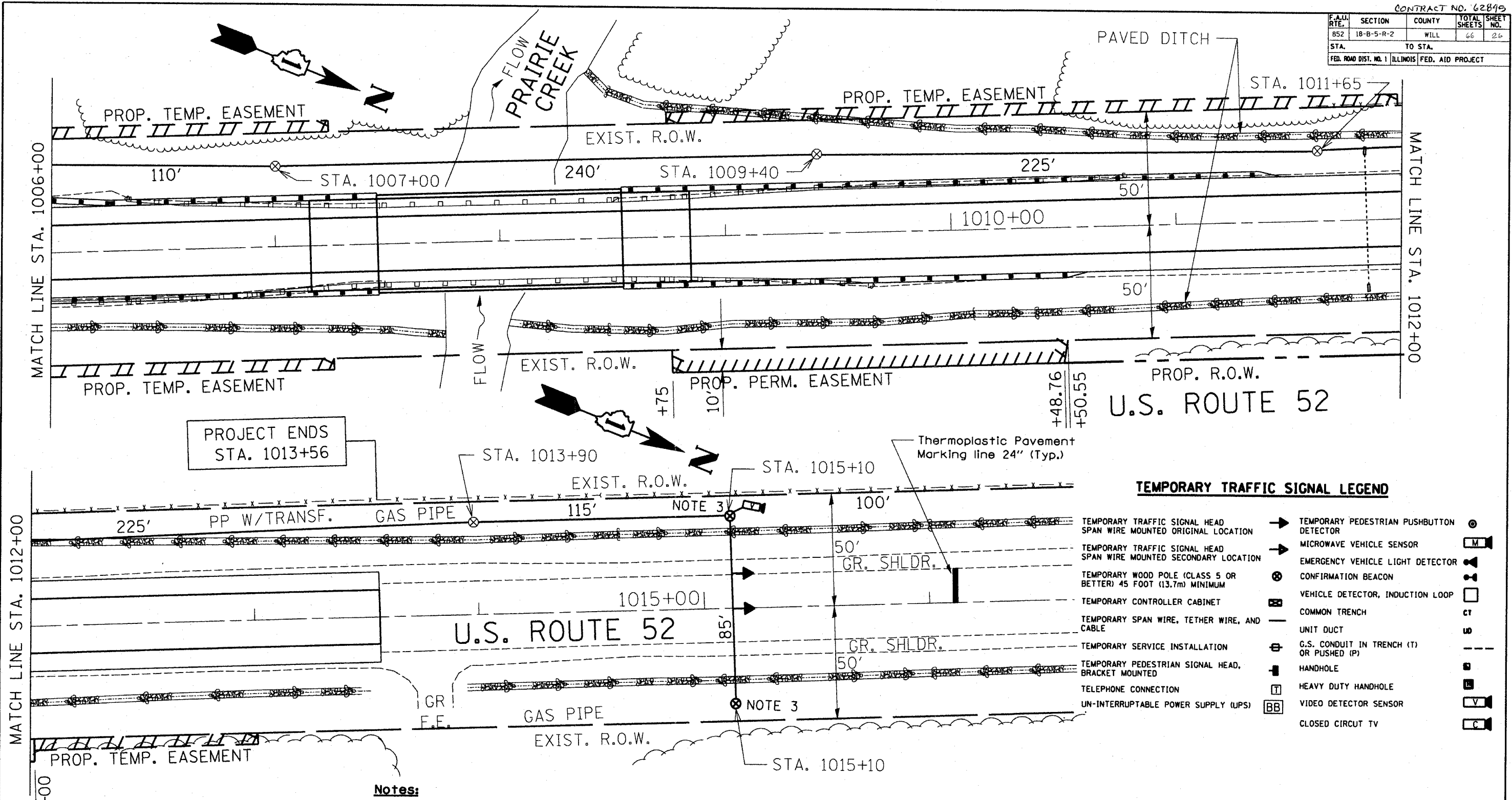

TEMPORARY TRAFFIC SIGNAL LEGEND

TEMPORARY TRAFFIC SIGNAL HEAD SPAN WIRE MOUNTED ORIGINAL LOCATION	→	TEMPORARY PEDESTRIAN PUSHBUTTON DETECTOR	⊙
TEMPORARY TRAFFIC SIGNAL HEAD SPAN WIRE MOUNTED SECONDARY LOCATION	→	MICROWAVE VEHICLE SENSOR	M
TEMPORARY WOOD POLE (CLASS 5 OR BETTER) 45 FOOT (13.7m) MINIMUM	⊙	EMERGENCY VEHICLE LIGHT DETECTOR	⚡
TEMPORARY CONTROLLER CABINET	⊙	CONFIRMATION BEACON	⊙
TEMPORARY SPAN WIRE, TETHER WIRE, AND CABLE	—	VEHICLE DETECTOR, INDUCTION LOOP	□
TEMPORARY SERVICE INSTALLATION	⊙	COMMON TRENCH	CT
TEMPORARY PEDESTRIAN SIGNAL HEAD, BRACKET MOUNTED	→	UNIT DUCT	U
TELEPHONE CONNECTION	⊙	G.S. CONDUIT IN TRENCH (T) OR PUSHED (P)	—
UN-INTERRUPTABLE POWER SUPPLY (UPS)	BB	HANDHOLE	H
		HEAVY DUTY HANDHOLE	HL
		VIDEO DETECTOR SENSOR	V
		CLOSED CIRCUIT TV	C

- Notes:**
- CONTROLLER WITH STEEL BASE CABINET AND BATTERY BACK-UP CABINET SHALL BE MOUNTED ON A WOOD STAND.
 - UN-INTERRUPTABLE POWER SUPPLY(UPS) SHALL BE INCLUDED IN "TEMPORARY BRIDGE TRAFFIC SIGNAL INSTALLATION" PAY ITEM.
 - 5 WOOD POLES INSTALLED BY THE TRAFFIC CONTRACTOR (SEE TEMPORARY TRAFFIC SIGNAL PLANS FOR LOCATIONS).
 - PROPOSED WOOD POLES FOR ROADWAY LIGHTING SHALL BE USED TO SUPPORT TRAFFIC SIGNAL CABLE.
 - TRAFFIC SIGNAL AND ROADWAY LIGHTING SHALL UTILIZE A COMBINATION ELECTRIC SERVICE BOX. (SEE DETAIL)
 - ALL SIGNAL HEADS SHALL BE L.E.D.

REVISIONS		ILLINOIS DEPARTMENT OF TRANSPORTATION
NAME	DATE	
		TEMPORARY TRAFFIC SIGNAL PLAN U.S. ROUTE 52 OVER PRAIRIE CREEK SCALE: VERT. N.T.S. HORIZ. DATE 8/6/2007 DRAWN BY: SN DESIGNED BY: DC CHECKED BY: DAD