

F.A.S. RTE.	SECTION	COUNTY	TOTAL SHEETS	SHEET NO.
•2079	**	CARROLL & OGLE	232	1
•(US 52) ••(16,17,18)RS-3 & (16BR)M-1				

STATE OF ILLINOIS
DEPARTMENT OF TRANSPORTATION
DIVISION OF HIGHWAYS

**PROPOSED
HIGHWAY PLANS**

FAS ROUTE 2079 (US 52)
SECTION (16, 17, 18)RS-3 & (16BR)M-1
PROJECT RS-2079 (105)
CARROLL & OGLE COUNTIES
C-92-012-07

D-92-026-85

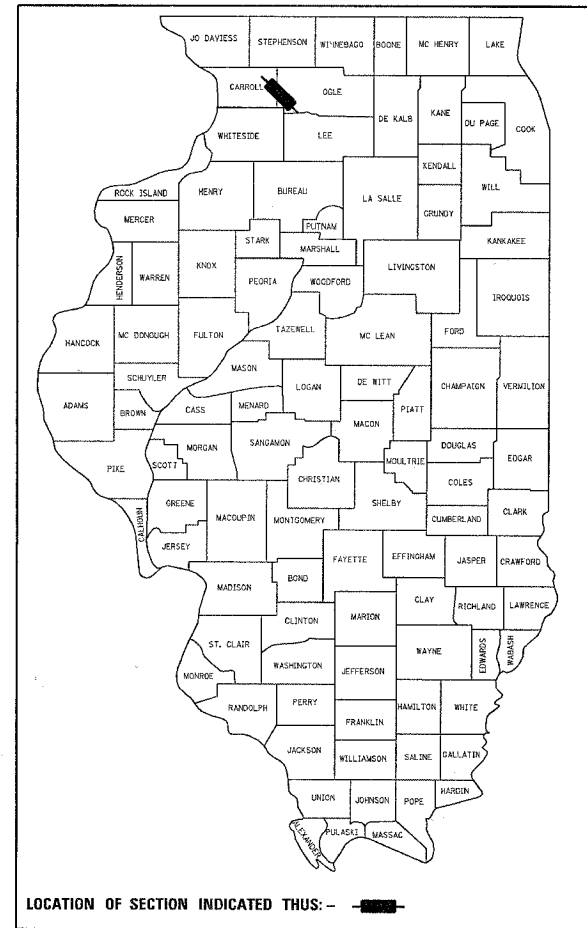

FOR INDEX OF SHEETS, SEE SHEET NO. 2
FOR STATE STANDARDS, SEE SHEET NO. 2

DESIGN DESIGNATION

US ROUTE 52: 115 (26) RURAL MAJOR COLLECTOR (FD-20) - IL 26 TO FREEPORT ROAD
US ROUTE 52: 80 (26) RURAL MAJOR COLLECTOR (FD-20) - FREEPORT ROAD TO BROOKVILLE
IL ROUTE 64: 100 (26) RURAL MAJOR COLLECTOR (FD-20)
BROOKVILLE RD: LOCAL ROAD
OGLE RD: LOCAL ROAD
US 52 ADT = 800 (2007)
MU = 7%
IL 64 ADT = 950 (2007)
MU = 16%

CARROLL COUNTY: LIMA TOWNSHIP - SECTIONS 21,28

OGLE COUNTY: BROOKVILLE TOWNSHIP - SECTIONS 27,34,35
EAGLE POINT TOWNSHIP: SECTIONS 1,2
BUFFALO TOWNSHIP - SECTIONS 5,6,7,8

IMPROVEMENT BEGINS STA 1495+60
SECTION BEGINS STA 1496+60 (US 52)

STA 1513+15 (CARROLL COUNTY)
= STA 0+00 (OGLE COUNTY)

SN 071-0070: STA 24+97 - 26+17
US 52 OVER ELKHORN CREEK
CONSISTS OF REMOVING AND
REPLACING DEFICIENT
PRESTRESSED CONCRETE DECK
BEAMS AT VARIOUS LOCATIONS
ON THE STRUCTURE

SECTION AND IMPROVEMENT
BEGINS STA. 1508+78.52 (IL 64)
IMPROVEMENT ENDS STA 4+00 (IL 64)
SECTION ENDS STA 4+50 (IL 64)

SN 071-1153 STA 178+82 (US 52)
TWIN PIPE CULVERTS, CLASS A, TYPE 2, 36";
DROP BOX NO. 3, GRATED CULVERT
EXTENSION NO. 2

SN 071-1155 STA 187+50 (US 52)
PIPE CULVERTS, CLASS A, TYPE 2, 36";
DROP BOX NO. 4, 1 - CAST-IN PLACE
REINFORCED CONCRETE END SECTION - 36"

SN 071-1154 STA 203+39 (US 52)
PIPE CULVERTS, CLASS A, TYPE 1, EQUIVALENT
ROUND-SIZE 60"; 2 - GRATED CULVERT
EXTENSION NO. 3

SN 071-1156 STA 327+833 (US 52)
PIPE CULVERTS, CLASS A, TYPE 1, 36";
2 - PRECAST REINFORCED CONCRETE
FLARED END SECTIONS - 36"

SECTION AND IMPROVEMENT
ENDS STA 335+25 (US 52)

OMISSIONS
OGLE COUNTY:
STA 24+04 TO STA 24+97
STA 26+17 TO STA 27+24
(BUFFALO BRIDGE)
STA 320+52.99 TO STA 321+92.59

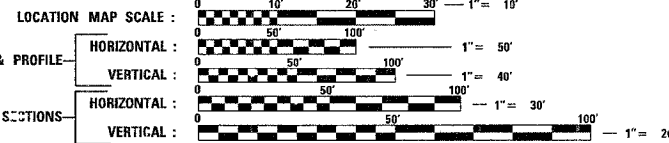
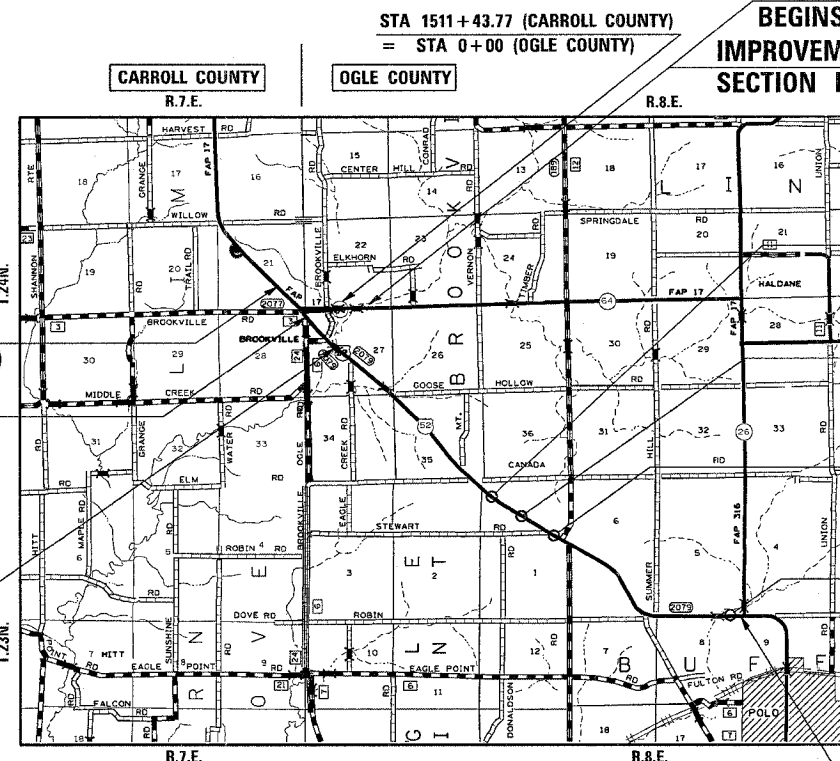

NET LENGTH OF PROJECT = 34,940 LIN FEET = 6.62 MILES
GROSS LENGTH OF PROJECT = 35,280 LIN FEET = 6.68 MILES

FULL SIZE PLANS HAVE BEEN PREPARED USING STANDARD
ENGINEERING SCALES. REDUCED SIZED PLANS WILL NOT
CONFORM TO STANDARD SCALES. IN MAKING MEASUREMENTS
ON REDUCED PLANS, THE ABOVE SCALES MAY BE USED.

J.U.L.I.E.
JOINT UTILITY LOCATION INFORMATION FOR EXCAVATION
1-800-892-0123

STATE OF ILLINOIS
DEPARTMENT OF TRANSPORTATION
DIVISION OF HIGHWAYS

SUBMITTED March 9th 20 07
Joseph E. Crown
DEPUTY DIRECTOR OF HIGHWAYS, REGION ENGINEER

October 12, 20 07
Eric E. Hauer
INTERIM ENGINEER OF DESIGN AND ENVIRONMENT

October 12, 20 07
Melton R. Seep, P.E.
DIRECTOR OF HIGHWAYS, CHIEF ENGINEER

**PRINTED BY THE AUTHORITY
OF THE STATE OF ILLINOIS**

CONTRACT NO. 64237

FAS ROUTE 2079 (US 52) - SECTION (16,17,18)RS-3 & (16BR)M-1 - CARROLL & OGLE COUNTIES

PROJECT ENGINEER: MASOOD AHMAD

SENIOR SQUAD LEADER: SAM ABDULLAH (815) 284-5935

SQUAD LEADER: CHAD SPREEMAN (815) 284-5934