

F.A.S. RTE.	SECTION	COUNTY	TOTAL SHEETS	SHEET NO.
2075 & 16522	116,17,18RS-3 & 16522-1	CARROLL & OGLE	232	64
STA.		TO STA.		
FED. ROAD DIST. NO.		ILLINOIS	FED. AID PROJECT	

### PE + 37.72

DALE D. & ANNETTE L. HARTMAN

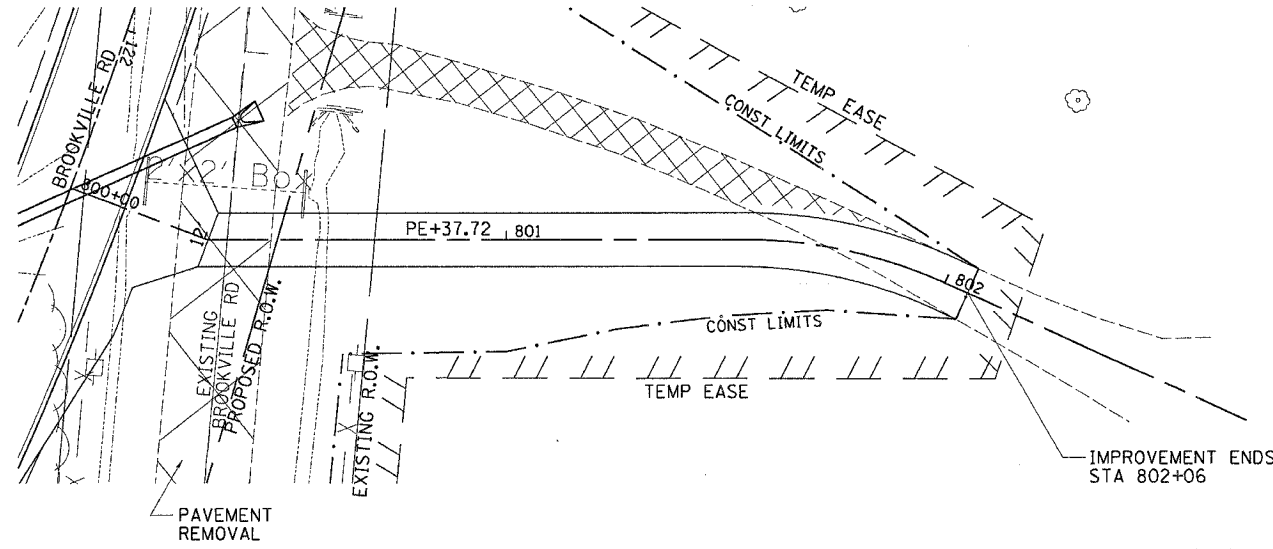

PROP. CURVE 50240  
 PI STA. = 801+77.41  
 $\Delta = 24^\circ 32' 14''$  (RT)  
 $D = 52^\circ 05' 13''$   
 $R = 110.00'$   
 $T = 23.92'$   
 $L = 47.11'$   
 $E = 2.57'$   
 $e = \text{---}$   
 $T.R. = \text{---}$   
 $S.E. RUN = \text{---}$   
 $P.C. STA = 801+53.49$   
 $P.T. STA = 802+00.59$



### FE + 45

DALE D. & ANNETTE L. HARTMAN

STA 124+44.42 - 29'LT  
 50' - PIPE CULV, CLASS D,  
 TYPE I - 15" W/END SECTIONS  
 INLET EL = 829.29  
 OUTLET EL = 826.89

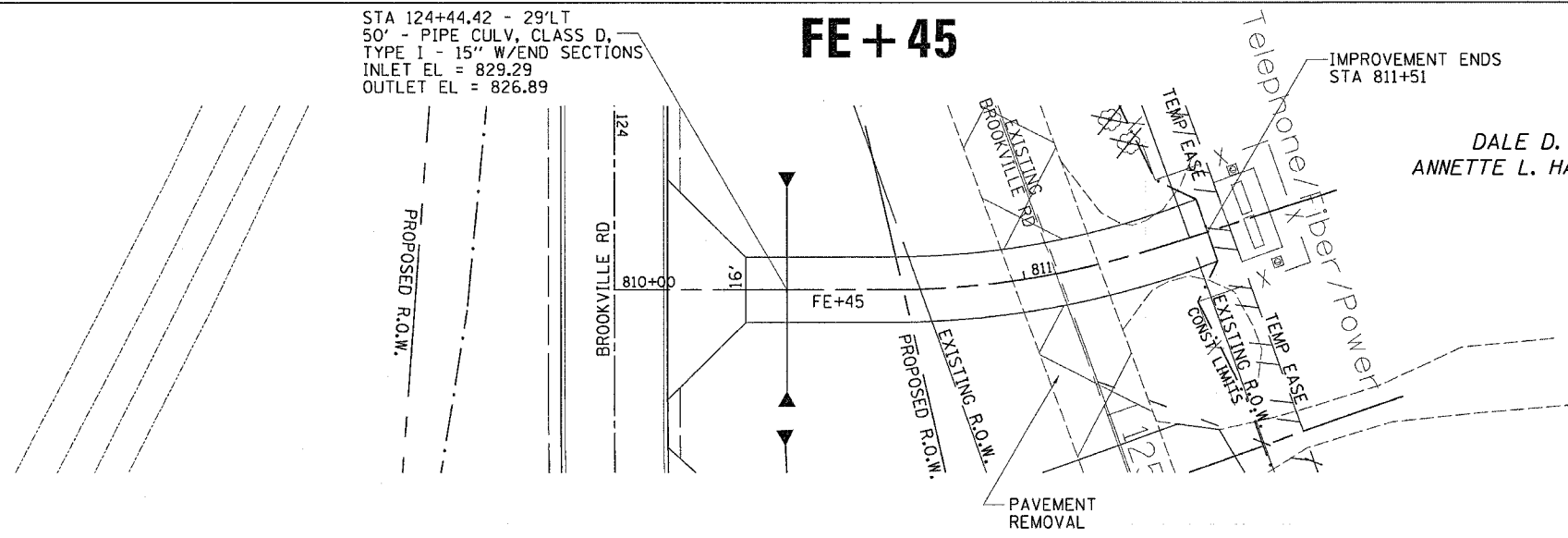

PROP. CURVE 50260  
 PI STA. = 811+00.32  
 $\Delta = 17^\circ 45' 10''$  (LT)  
 $D = 27^\circ 01' 35''$   
 $R = 212.00'$   
 $T = 33.11'$   
 $L = 65.69'$   
 $E = 2.57'$   
 $e = \text{---}$   
 $T.R. = \text{---}$   
 $S.E. RUN = \text{---}$   
 $P.C. STA = 810+67.21$   
 $P.T. STA = 811+32.89$



### FE + 15

DALE D. & ANNETTE L. HARTMAN

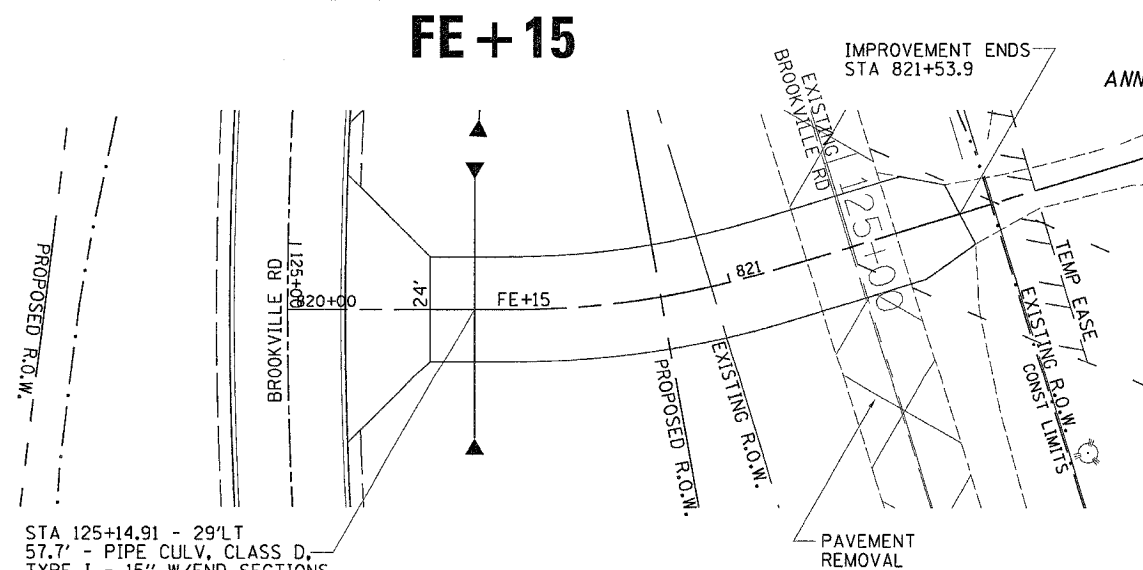

PROP. CURVE 50280  
 PI STA. = 820+79.90  
 $\Delta = 16^\circ 54' 58''$  (LT)  
 $D = 27^\circ 48' 49''$   
 $R = 206.00'$   
 $T = 30.63'$   
 $L = 60.82'$   
 $E = 2.27'$   
 $e = \text{---}$   
 $T.R. = \text{---}$   
 $S.E. RUN = \text{---}$   
 $P.C. STA = 820+49.27$   
 $P.T. STA = 821+10.09$



STA 125+14.91 - 29'LT  
 57.7' - PIPE CULV, CLASS D,  
 TYPE I - 15" W/END SECTIONS  
 INLET EL = 826.79  
 OUTLET EL = 824.14

RYAN WITHERS

X = TREE REMOVAL



PLOT DATE = Thu Mar 08 06:32:55 2007  
 FILE NAME = c:\prow\proj\12222685\ub2689.plt.dgn  
 USER NAME = / JN.  
 USER = 603008