

F.A.P. RTE.	SECTION	COUNTY	TOTAL SHEETS	SHEET NO.
553	120T-2	OGLE	59	18
STA. _____		TO STA. _____		
FED. ROAD DIST. NO. _____		ILLINOIS FED. AID PROJECT		

RED BIRD PARTNERS, LP

# SN 071-1160

RED BIRD PARTNERS, LP

PROPOSED STRUCTURE (SN 071-1160)  
 STA 2109+64.78  
 96' PRECAST CONCRETE BOX CULVERT  
 DOUBLE CELL 6'X5', 27° SKEW  
 2 EA. GRATED CULVERT EXTENSION NO. 1  
 U/S ELEV = 798.50  
 D/S ELEV = 797.60

STONE RIPRAP, CLASS A4  
 W/ FILTER FABRIC (24'X22')



IMPROVEMENT ENDS  
 STA 2112+20

IMPROVEMENT BEGINS  
 STA 2106+80

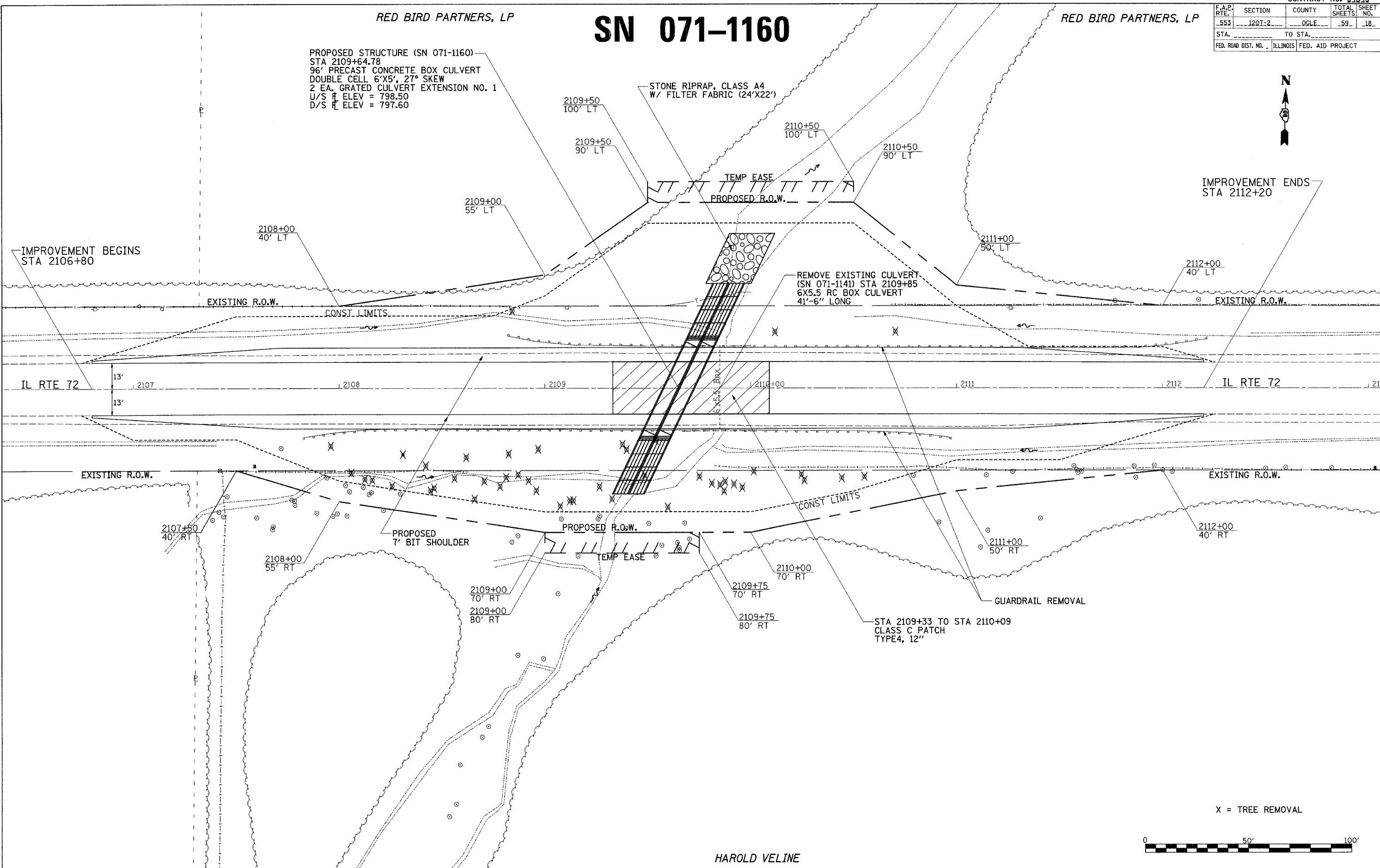

IL RTE 72

IL RTE 72

PLOT DATE = Mon Jul 30 11:45:29 2007  
 FILE NAME = c:\projects\sn0711160\080608.dwg  
 PLOT SCALE = 20.0000 / 1" = 40.0000'  
 USER NAME = dssidd

HAROLD VELINE

X = TREE REMOVAL

