

F.A.P. RTE.	SECTION	COUNTY	TOTAL SHEETS	SHEET NO.
553	120T-2	OGLE	59	22
STA.		TO STA.		
FED. ROAD DIST. NO.		ILLINOIS	FED. AID PROJECT	

RED BIRD PARTNERS, LP

STAGE 2

RED BIRD PARTNERS, LP

PROPOSED STRUCTURE (SN 071-1160)
 STA 2109+64.78
 96' PRECAST CONCRETE BOX CULVERT
 DOUBLE CELL 6'X5', 27° SKEW
 2 EA. GRATED CULVERT EXTENSION NO. 1
 U/S ELEV = 798.50
 D/S ELEV = 797.60

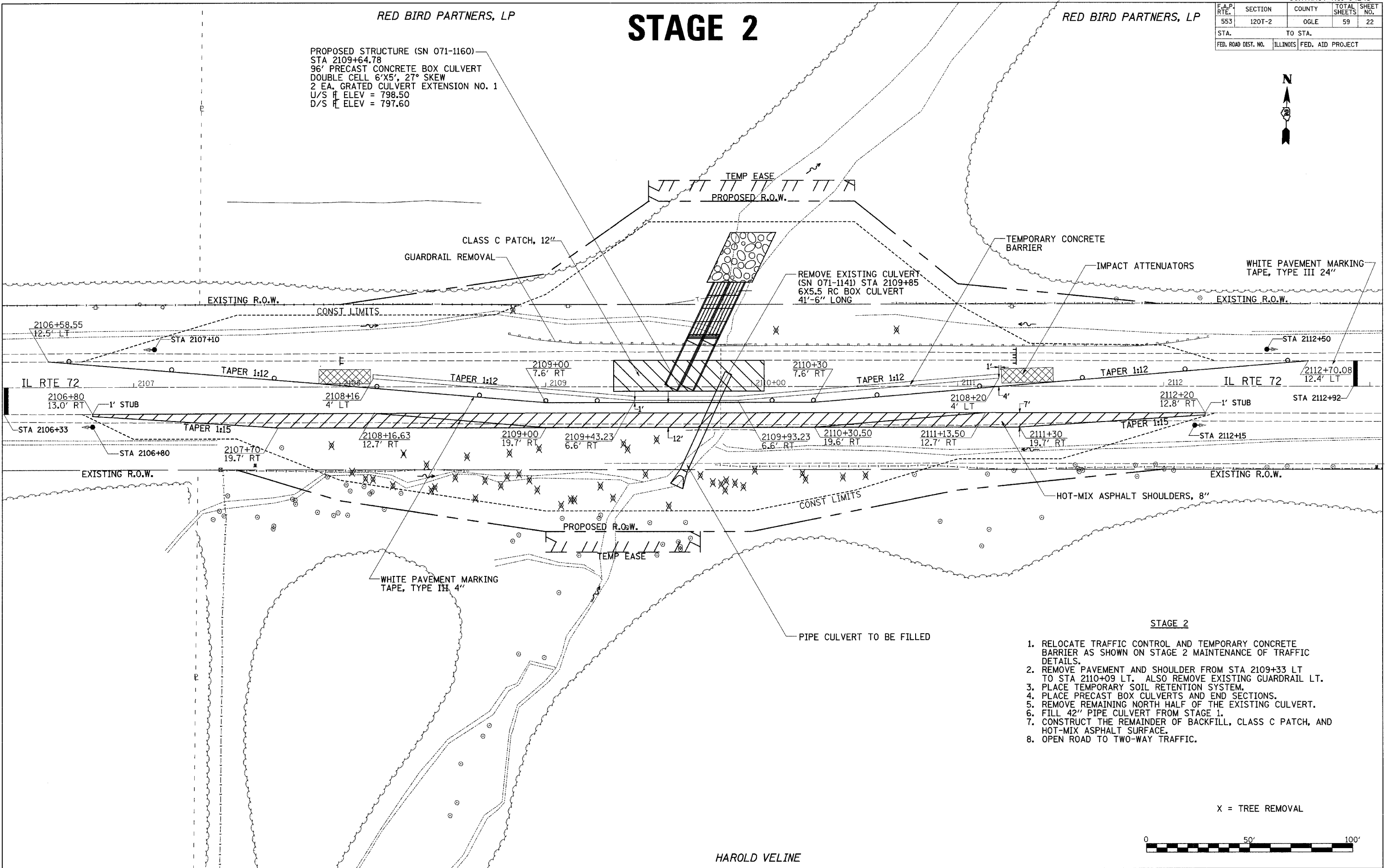

- STAGE 2**
1. RELOCATE TRAFFIC CONTROL AND TEMPORARY CONCRETE BARRIER AS SHOWN ON STAGE 2 MAINTENANCE OF TRAFFIC DETAILS.
 2. REMOVE PAVEMENT AND SHOULDER FROM STA 2109+33 LT TO STA 2110+09 LT. ALSO REMOVE EXISTING GUARDRAIL LT.
 3. PLACE TEMPORARY SOIL RETENTION SYSTEM.
 4. PLACE PRECAST BOX CULVERTS AND END SECTIONS.
 5. REMOVE REMAINING NORTH HALF OF THE EXISTING CULVERT.
 6. FILL 42" PIPE CULVERT FROM STAGE 1.
 7. CONSTRUCT THE REMAINDER OF BACKFILL, CLASS C PATCH, AND HOT-MIX ASPHALT SURFACE.
 8. OPEN ROAD TO TWO-WAY TRAFFIC.

X = TREE REMOVAL

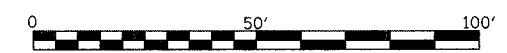

HAROLD VELINE

STAGE 2 DETAIL

PLOT DATE = Tue Aug 07 08:21:40 2007
 FILE NAME = c:\pcc\cadd\2007\64B43\120T-2\120T-2.dgn
 PLOT SCALE = 20.00000 / IN.
 USER NAME = dssidd