

F.A.P. RTE.	SECTION	COUNTY	TOTAL SHEETS	SHEET NO.
553	120T-2	OGLE	59	23
STA.		TO STA.		
FED. ROAD DIST. NO.		ILLINOIS	FED. AID PROJECT	

PATRICIA A. BOSETTI

STAGE 3

PATRICIA A. BOSETTI



PROPOSED STRUCTURE (SN 071-1161)
 STA 2131+60
 144' PRECAST CONCRETE BOX CULVERT
 DOUBLE CELL 6'X3', 45° SKEW
 1 EA. GRATED CULVERT EXTENSION NO. 2
 1 EA. GRATED DROP BOX NO. 1
 U/S ELEV = 789.85
 D/S ELEV = 788.80

REMOVE EXISTING CULVERT
 (SN 071-1140) STA 2131+98.8
 6X4 RC BOX CULVERT
 41'-6" LONG

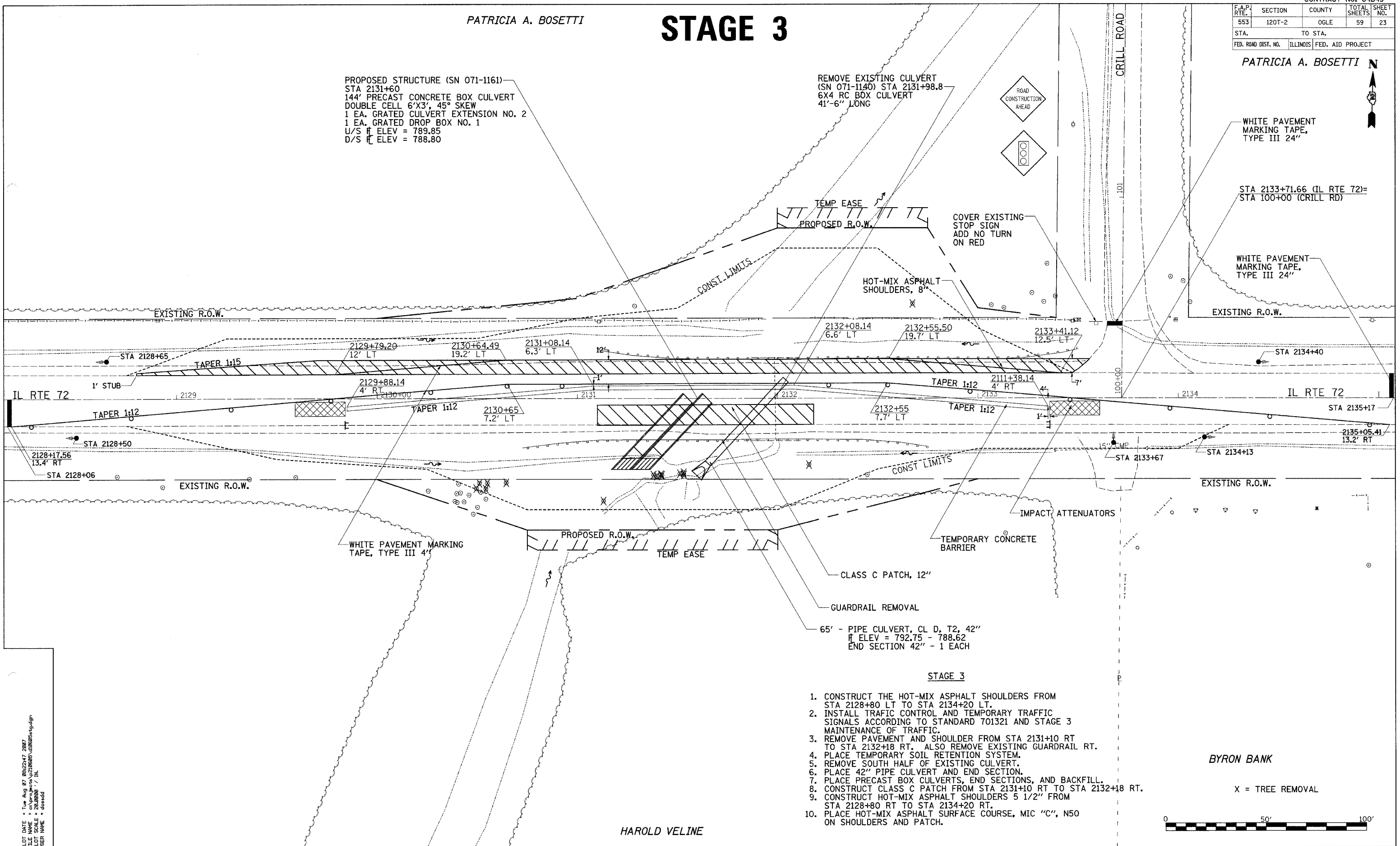

WHITE PAVEMENT MARKING TAPE, TYPE III 24"

STA 2133+71.66 (IL RTE 72)= STA 100+00 (CRILL RD)

WHITE PAVEMENT MARKING TAPE, TYPE III 24"

EXISTING R.O.W.

STA 2134+40

IL RTE 72

STA 2135+17

2135+05.41
13.2' RT

EXISTING R.O.W.

IMPACT ATTENUATORS

TEMPORARY CONCRETE BARRIER

CLASS C PATCH, 12"

GUARDRAIL REMOVAL

65' - PIPE CULVERT, CL D, T2, 42"
 ELEV = 792.75 - 788.62
 END SECTION 42" - 1 EACH

STAGE 3

1. CONSTRUCT THE HOT-MIX ASPHALT SHOULDERS FROM STA 2128+80 LT TO STA 2134+20 LT.
2. INSTALL TRAFFIC CONTROL AND TEMPORARY TRAFFIC SIGNALS ACCORDING TO STANDARD 701321 AND STAGE 3 MAINTENANCE OF TRAFFIC.
3. REMOVE PAVEMENT AND SHOULDER FROM STA 2131+10 RT TO STA 2132+18 RT. ALSO REMOVE EXISTING GUARDRAIL RT.
4. PLACE TEMPORARY SOIL RETENTION SYSTEM.
5. REMOVE SOUTH HALF OF EXISTING CULVERT.
6. PLACE 42" PIPE CULVERT AND END SECTION.
7. PLACE PRECAST BOX CULVERTS, END SECTIONS, AND BACKFILL.
8. CONSTRUCT CLASS C PATCH FROM STA 2131+10 RT TO STA 2132+18 RT.
9. CONSTRUCT HOT-MIX ASPHALT SHOULDERS 5 1/2" FROM STA 2128+80 RT TO STA 2134+20 RT.
10. PLACE HOT-MIX ASPHALT SURFACE COURSE, MIC "C", N50 ON SHOULDERS AND PATCH.

BYRON BANK

X = TREE REMOVAL

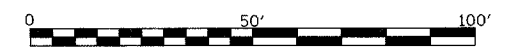

HAROLD VELINE

PLOT DATE = Tue Aug 07 08:22:47 2007
 PLOT SCALE = 1" = 20' (AS SHOWN) / 1/4"
 USER NAME = drossard