

F.A.P. RTE.	SECTION	COUNTY	TOTAL SHEETS	SHEET NO.
553	120T-2	OGLE	59	24

STA.	TO STA.
FED. ROAD DIST. NO.	ILLINOIS FED. AID PROJECT

PATRICIA A. BOSETTI

STAGE 4

PROPOSED STRUCTURE (SN 071-1161)
 STA 2131+60
 144' PRECAST CONCRETE BOX CULVERT
 DOUBLE CELL 6'X3', 45° SKEW
 1 EA. GRATED CULVERT EXTENSION NO. 2
 1 EA. GRATED DROP BOX NO. 1
 U/S # ELEV = 789.85
 D/S # ELEV = 788.80

REMOVE EXISTING CULVERT
 (SN 071-1140) STA 2131+98.8
 6X4 RC BOX CULVERT
 41'-6" LONG

PATRICIA A. BOSETTI

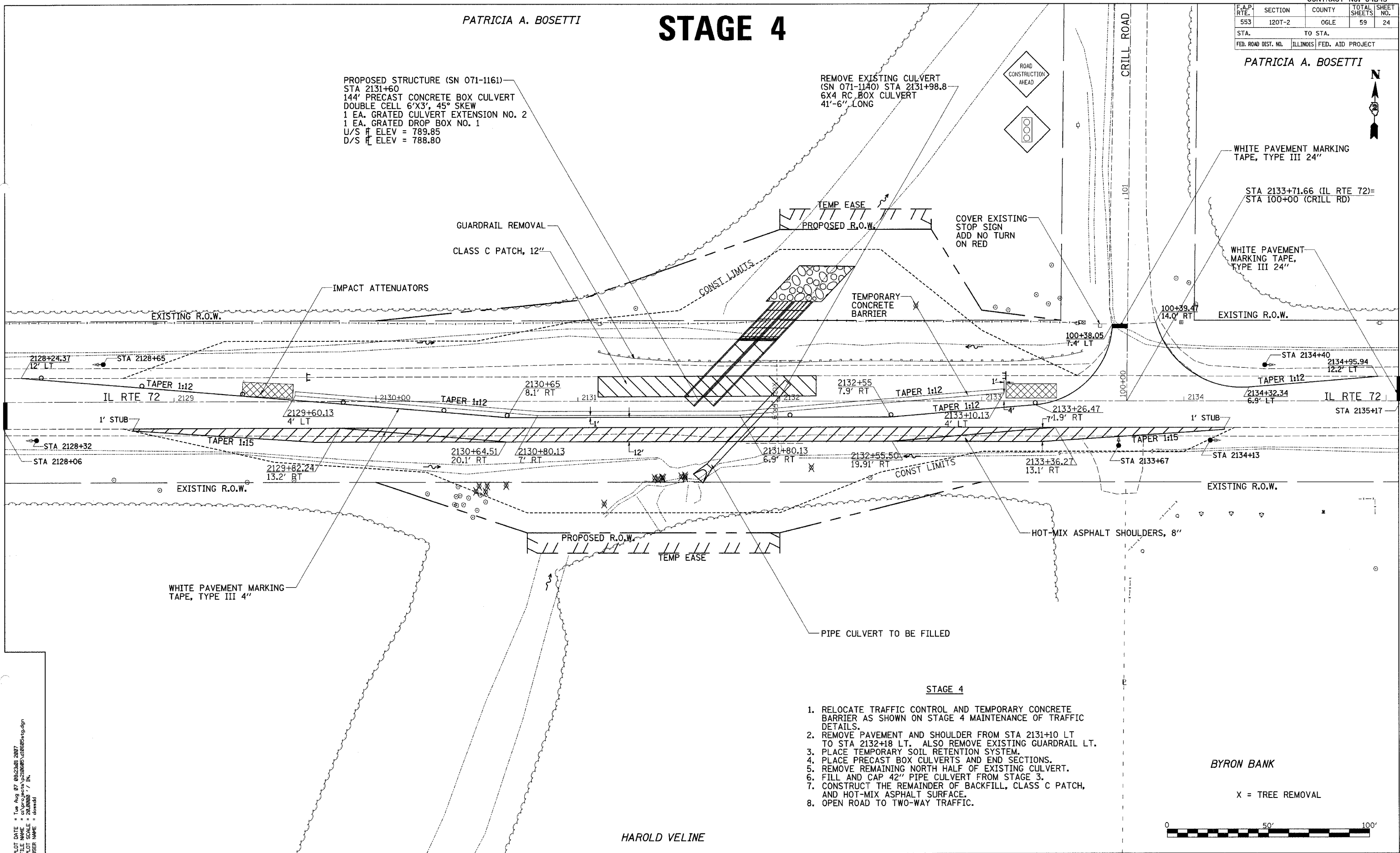

WHITE PAVEMENT MARKING TAPE, TYPE III 24"

STA 2133+71.66 (IL RTE 72)= STA 100+00 (CRILL RD)

WHITE PAVEMENT MARKING TAPE, TYPE III 24"

EXISTING R.O.W.

STA 2134+40 2134+95.94 12.2' LT

STA 2135+17

EXISTING R.O.W.

HOT-MIX ASPHALT SHOULDERS, 8"

WHITE PAVEMENT MARKING TAPE, TYPE III 4"

PIPE CULVERT TO BE FILLED

STAGE 4

1. RELOCATE TRAFFIC CONTROL AND TEMPORARY CONCRETE BARRIER AS SHOWN ON STAGE 4 MAINTENANCE OF TRAFFIC DETAILS.
2. REMOVE PAVEMENT AND SHOULDER FROM STA 2131+10 LT TO STA 2132+18 LT. ALSO REMOVE EXISTING GUARDRAIL LT.
3. PLACE TEMPORARY SOIL RETENTION SYSTEM.
4. PLACE PRECAST BOX CULVERTS AND END SECTIONS.
5. REMOVE REMAINING NORTH HALF OF EXISTING CULVERT.
6. FILL AND CAP 42" PIPE CULVERT FROM STAGE 3.
7. CONSTRUCT THE REMAINDER OF BACKFILL, CLASS C PATCH, AND HOT-MIX ASPHALT SURFACE.
8. OPEN ROAD TO TWO-WAY TRAFFIC.

BYRON BANK

X = TREE REMOVAL

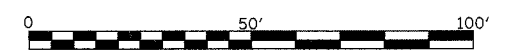

HAROLD VELINE

PLOT DATE = Tue Aug 07 09:23:01 2007
 FILE NAME = c:\projects\6210685\stage4.dgn
 USER NAME = dward