

F.A.I. RTE.	SECTION	COUNTY	TOTAL SHEETS	SHEET NO.
80	06-BHBR	BUREAU	165	18
STA. 232+00		TO STA. 238+00		
FED. ROAD DIST. NO. 3 ILLINOIS FED. AID PROJECT				

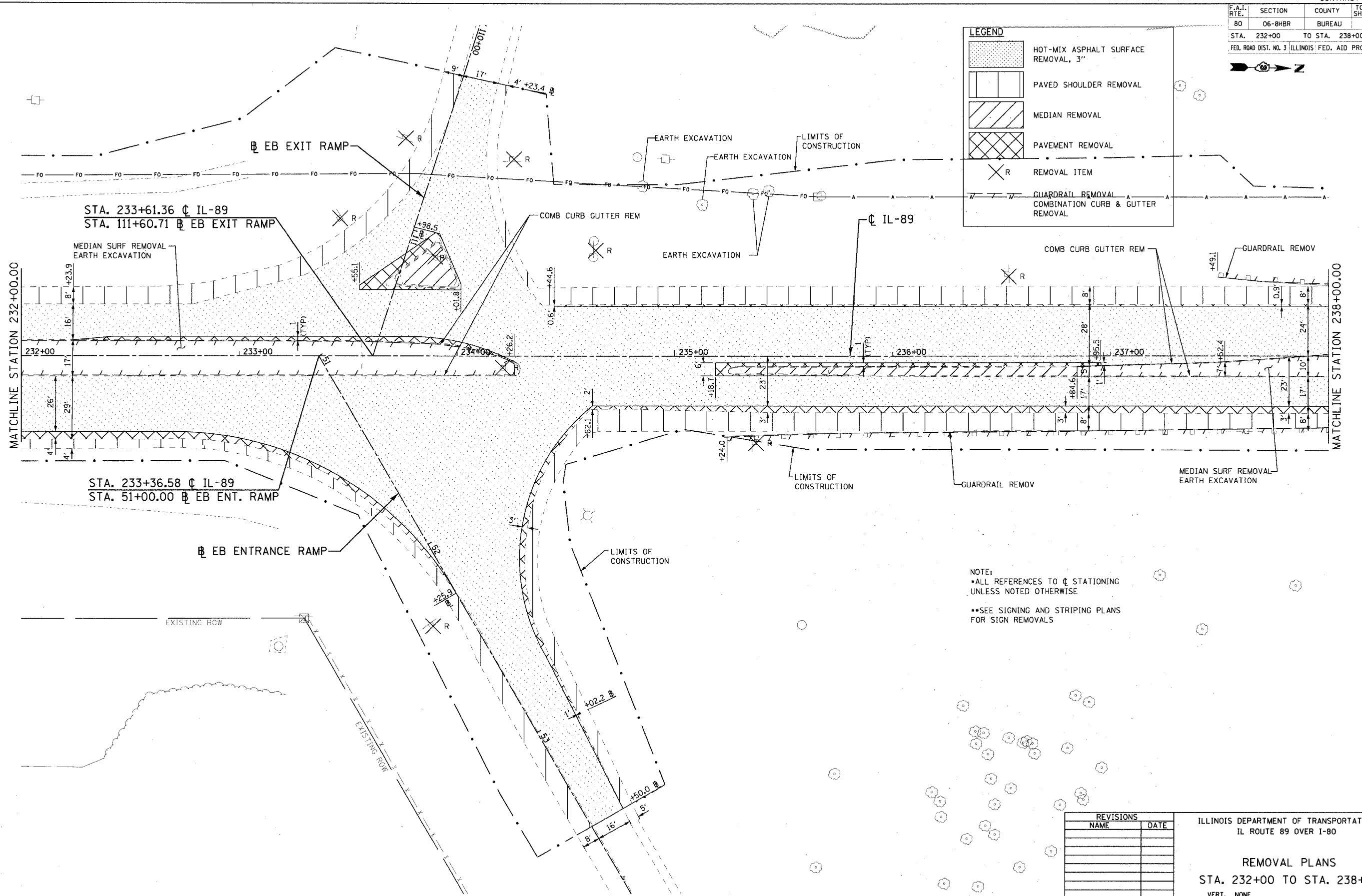

LEGEND

- HOT-MIX ASPHALT SURFACE REMOVAL, 3"
- PAVED SHOULDER REMOVAL
- MEDIAN REMOVAL
- PAVEMENT REMOVAL
- REMOVAL ITEM
- GUARDRAIL REMOVAL
- COMBINATION CURB & GUTTER REMOVAL



NOTE:
 • ALL REFERENCES TO @ STATIONING UNLESS NOTED OTHERWISE
 • SEE SIGNING AND STRIPING PLANS FOR SIGN REMOVALS

REVISIONS	
NAME	DATE

ILLINOIS DEPARTMENT OF TRANSPORTATION
 IL ROUTE 89 OVER I-80

REMOVAL PLANS
 STA. 232+00 TO STA. 238+00

SCALE: VERT. NONE
 HORIZ. 1" = 20'

DATE: 08/10/07

DRAWN BY ACE/CAD
 CHECKED BY TMH

PLOT DATE = 8/9/2007
 FILE NAME = g:\p\proj\232+00\89_02\road\091002.dwg
 PLOT SCALE = 20.000 / IN.
 USER NAME = ahenrod

