

F.A.I. RTE.	SECTION	COUNTY	TOTAL SHEETS	SHEET NO.
80	06-BHBR	BUREAU	165	48
STA. 238+00		TO STA. 244+00		
FED. ROAD DIST. NO. 3 ILLINOIS FED. AID PROJECT				

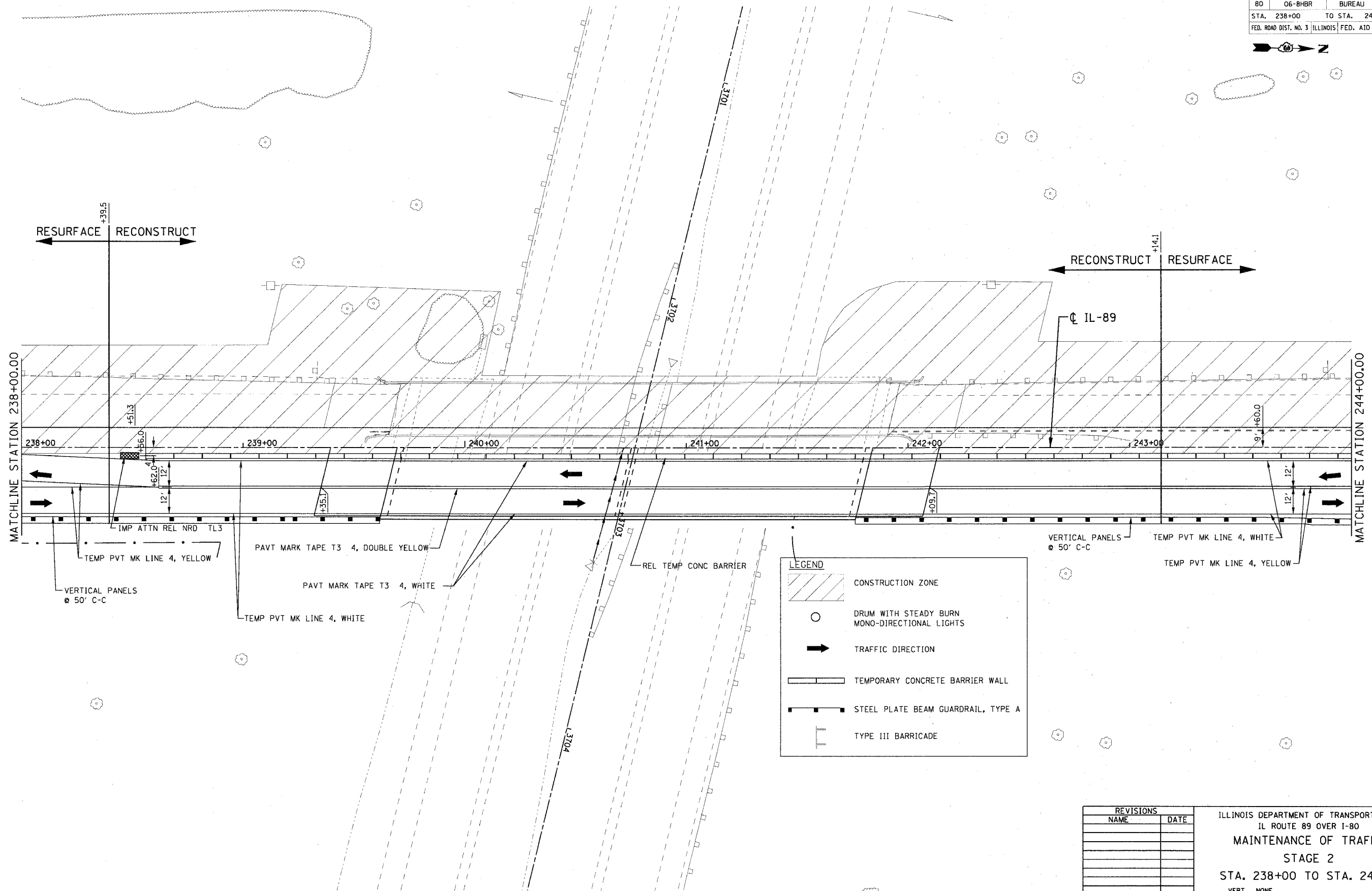
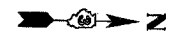

LEGEND	
	CONSTRUCTION ZONE
	DRUM WITH STEADY BURN MONO-DIRECTIONAL LIGHTS
	TRAFFIC DIRECTION
	TEMPORARY CONCRETE BARRIER WALL
	STEEL PLATE BEAM GUARDRAIL, TYPE A
	TYPE III BARRICADE

REVISIONS	
NAME	DATE

ILLINOIS DEPARTMENT OF TRANSPORTATION  
 IL ROUTE 89 OVER I-80  
 MAINTENANCE OF TRAFFIC  
 STAGE 2  
 STA. 238+00 TO STA. 244+00

VERT. NONE  
 SCALE: HORIZ. 1" = 20'  
 DATE: 08/10/07

DRAWN BY ACE/CAD  
 CHECKED BY TMH

PLOT DATE: 8/5/2007  
 FILE NAME: g:\projects\238+00\06-BHBR\02-Access\9911238.dwg  
 PLOT SCALE: 1/8" = 1'-0"  
 USER: jzbrand

